



fauntleroy latham  
weldon barré  
architects

a professional corporation in  
continuous practice since 1981

architecture  
planning  
interiors  
sustainable design  
consulting

229 ST. JOHN LANE  
COVINGTON, LA 70433  
985-893-4100



A NEW CHURCH BUILDING  
FOR:

REDEEMER  
LUTHERAN

22531 Hwy 1088  
Mandeville, LA 70471



THESE DRAWINGS ARE THE SOLE PROPERTY OF FAUNTLEROY LATHAM  
WELDON BARRÉ ARCHITECTS, APC, AND ARE ISSUED AS INSTRUMENTS  
OF SERVICE. THESE DRAWINGS SHALL NOT BE COPIED, REPRODUCED  
OR USED IN ANY MANNER WITHOUT WRITTEN CONSENT OF  
FAUNTLEROY LATHAM WELDON BARRÉ ARCHITECTS, APC.

Issue	Date	Remark

ELECTRICAL SITE PLAN

Job No.	214011.01	Sheet No.	E1.1
Drawn by			
Checked by			
Date	11.6.2014		

COPYRIGHT 2014, FAUNTLEROY LATHAM WELDON BARRÉ ARCHITECTS, APC

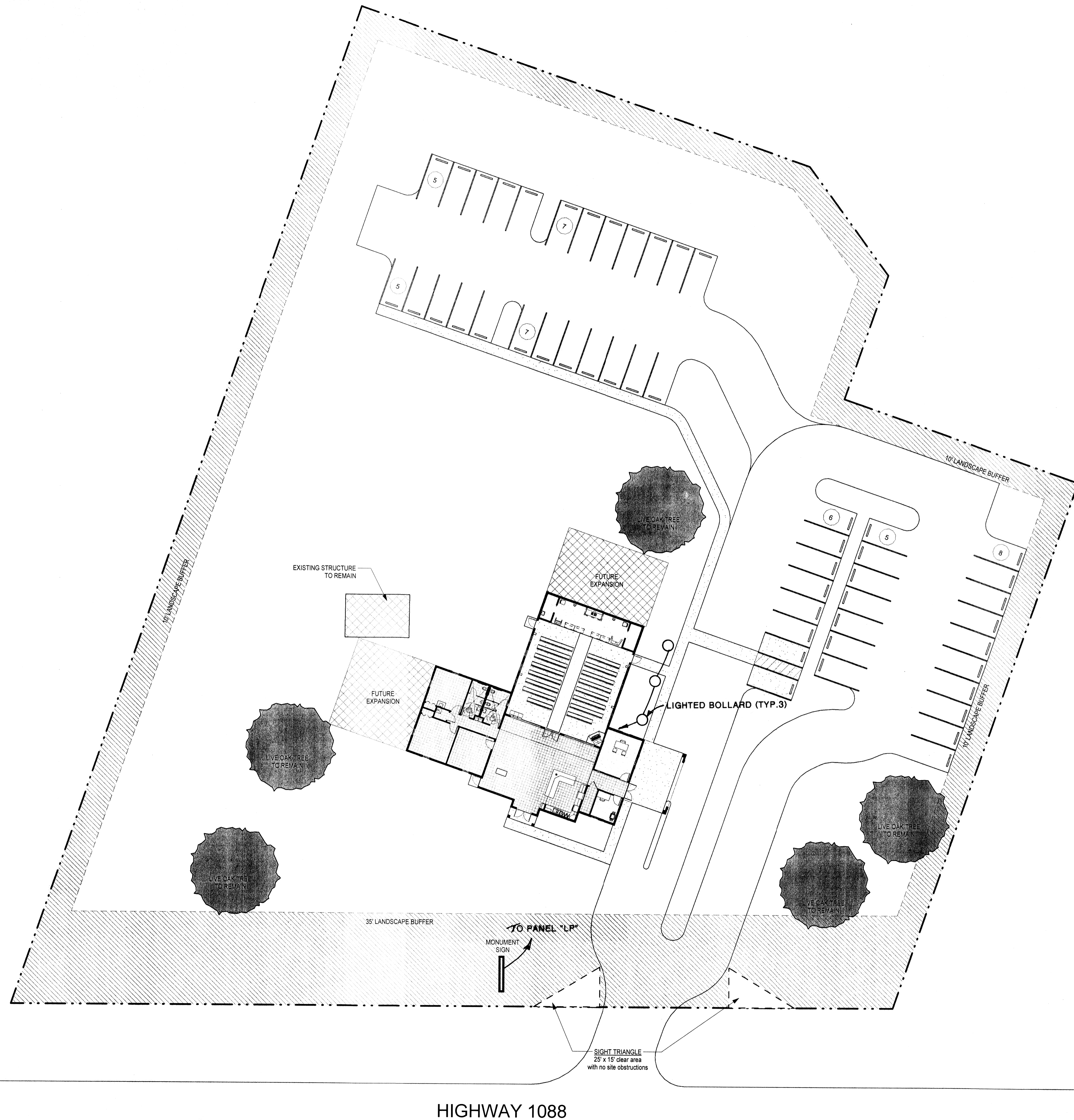

HIGHWAY 1088

1 SITE ELECTRICAL PLAN  
E1.1 1" = 20'-0"

12/1/2014  
BAM  
BRIAN A. MISTICH  
LICENSE NO. 30187

DAMMON ENGINEERING, INC.  
554 Old Spanish Trail  
Slidell, LA 70458  
985-649-5832