

A NEW CHURCH BUILDING  
FOR:

**REDEEMER  
LUTHERAN**

22531 Hwy 1088  
Mandeville, LA 70471

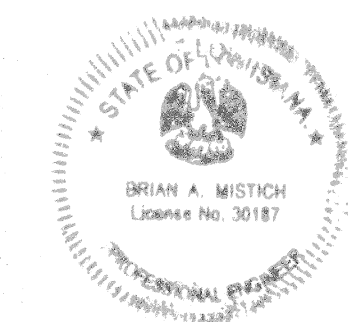

THESE DRAWINGS ARE THE SOLE PROPERTY OF FAUNTLEROY LATHAM WELDON BARRÉ ARCHITECTS, APC, AND ARE LOANED AS INSTRUMENTS OF SERVICE. THESE DRAWINGS SHALL NOT BE COPIED, REPRODUCED OR USED IN ANY MANNER WITHOUT WRITTEN CONSENT OF FAUNTLEROY LATHAM WELDON BARRÉ ARCHITECTS, APC.

| Issue | Date | Remark |
|-------|------|--------|
|       |      |        |
|       |      |        |
|       |      |        |
|       |      |        |
|       |      |        |
|       |      |        |
|       |      |        |
|       |      |        |
|       |      |        |

LIGHTING PLAN - FIRST FLOOR

|            |           |           |      |
|------------|-----------|-----------|------|
| Job No.    | 214011.01 | Sheet No. | E2.2 |
| Drawn by   |           |           |      |
| Checked by |           |           |      |
| Date       | 11.6.2014 |           |      |

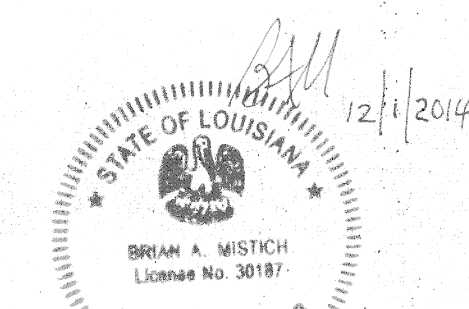

**DAMON ENGINEERING, INC.**  
554 Old Spanish Trail  
Slidell, LA 70458  
985-649-5832

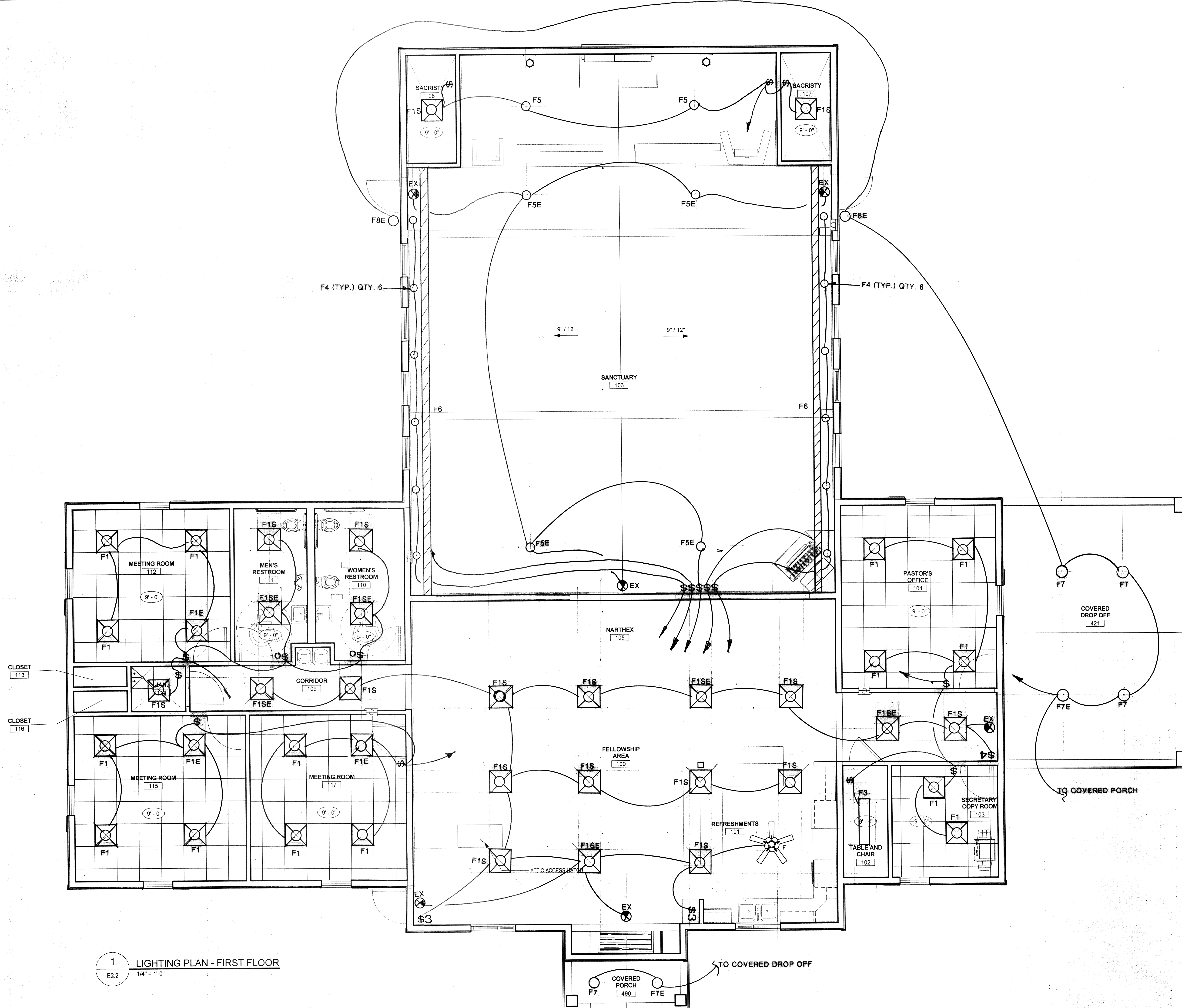

**1** LIGHTING PLAN - FIRST FLOOR  
E2.2 1/4" = 1'-0"