

PARKING CALCULATIONS

SCHEME: 1c

Tract	Tenant/Use	Land Area	Lease	Strictest Parking Ratio	Strictest Parking Required	Regular Parking Provided	Over/ (Under)	Parked Notes
	width of storefront			1 p.s./x s.f.				
	AutoZone							
	94'-8"		6,816 s.f.	250 s.f.	27.26	31	3.74	11
			(4/1000)					
		29,570 s.f.	6,816 s.f.					
	Lot Coverage:	0.6788 Ac.	23.05%					

Handicapped parking required/provided: 2 / 2 / 12
 Loading Spaces required/provided: 1 / 1 / 3
 Zoning: **B-2**

Notes:

- 1 Min. drive aisle is 28' for 90° parking.
- 2 Typical parking space is 8.5'x18.5' minimum.
- 3 Loading space is 12'x55', minimum of 1.
- 4 Minimum turn radius to face of curb at drives is 10' unless noted otherwise.
- 5 Minimum turn radius to face of curb at parking spaces is 2' unless noted otherwise.
- 6 This site drawing was made with in-house research or info provided to us, but does not include all boundary, improvements or other site data of unknown nature or known site data not made available to us. No warranties or guaranties are given or implied.
- 7 Confirm adjacent zoning, meets & bounds, utilities, drainage, CC&R's, easements & landscape reqmts.
- 8 Landscaping to be 25% of interior parking lot area.
- 9 The city parking ratio for Retail is 1 p.s. per 250 s.f. = 4/1000
- 10 ADA Accessible Parking Spaces required: 1-25=1, 26-50=2, 51-75=3, 76-100=4, 101-150=5, 151-200=6, 201-300=7, 301-400=8, 401-500=9, 501-1,000=2% of total, >1001=20+1 per ea. 100 over 1,000.



AREA MAP

0' 150' 300' 600'



SCALE: 1" = 300'-0"

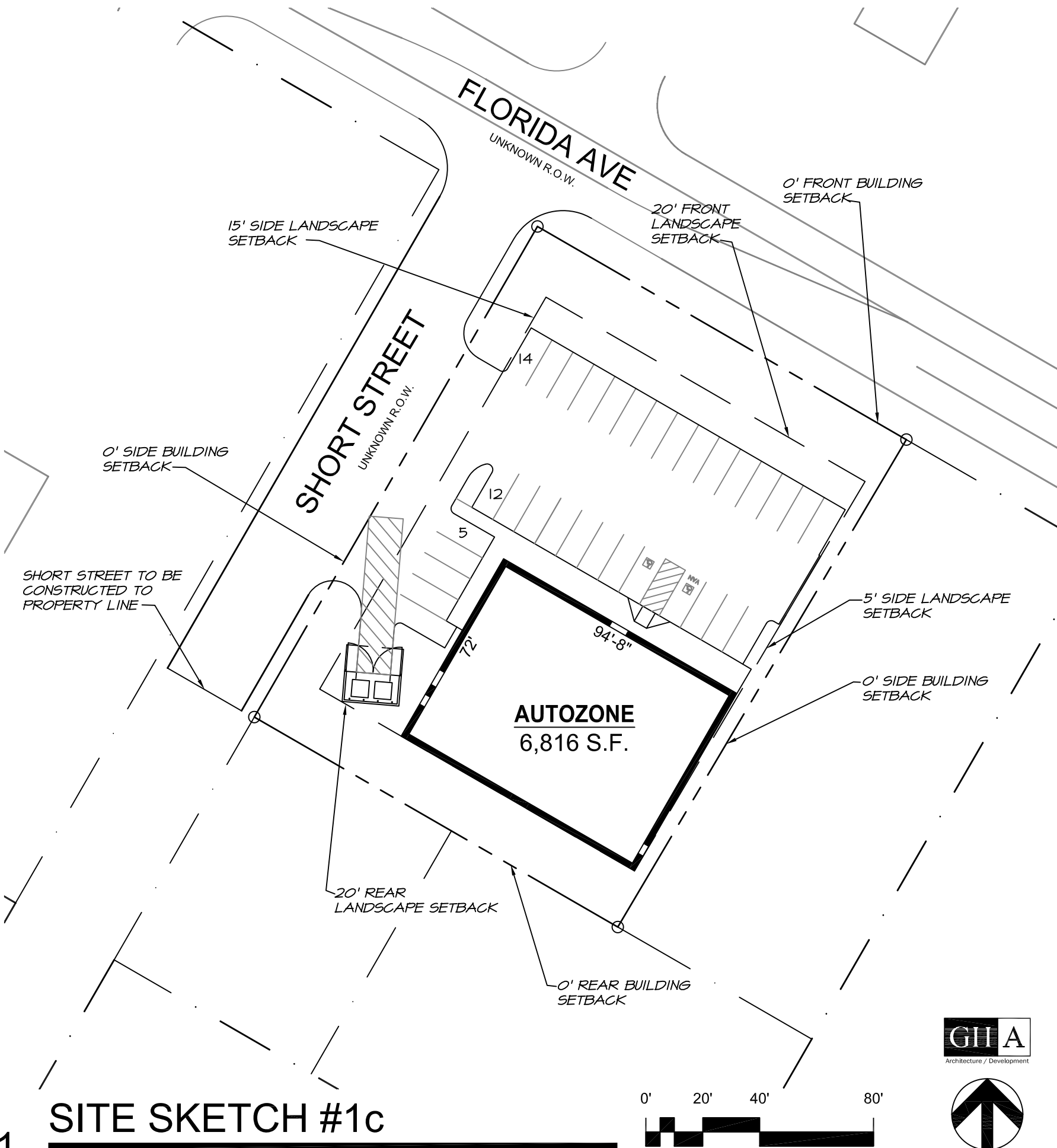

SITE SKETCH #1c

Mandeville, LA

Florida Avenue & Short Street

0' 20' 40' 80'



SCALE: 1" = 40'-0"



TRUE NORTH

ISSUED:

04/26/07

REVISIONS:

361 GROUP
 DESIGN SERVICES, INC.

AUTOZONE
 FLORIDA AVENUE & SHORT STREET
 MANDEVILLE, LA

DRAWN: SRM CHECKED: _____

JOB NO: 2006-

TITLE
 Site Sketch

Mandeville

SHEET
SS-1c
 1 of 1