



**DAMMON**  
ENGINEERING, INC.

CHIEF ENGINEER  
EMMETT  
DAMMON, P.E.

CHIEF ARCHITECT  
ROBERT  
WALTSE

1095 FLORIDA AVENUE  
SUDELL, LA. 70458  
OFFICE 985-649-5832  
FAX 985-641-5950

WWW.DAMMONENGINEERING.COM  
EMAIL:  
DAMMONENG@BLSOUTH.NET

ARCHITECTURE  
ENGINEERING  
STUDIES  
PLANNING  
INVESTIGATION  
EXPERT WITNESS

PRODUCTOS  
LATINOS  
BAKERY

2767

SGT ALFORD DRIVE  
SUDELL  
LOUISIANA

FRANCISCO  
BERMUNDEZ

REV: 4/30/08  
SCALE: 1/4" = 1"  
JOB#: 1940  
DATE: 4/30/08  
SUDELL

5 OF 10

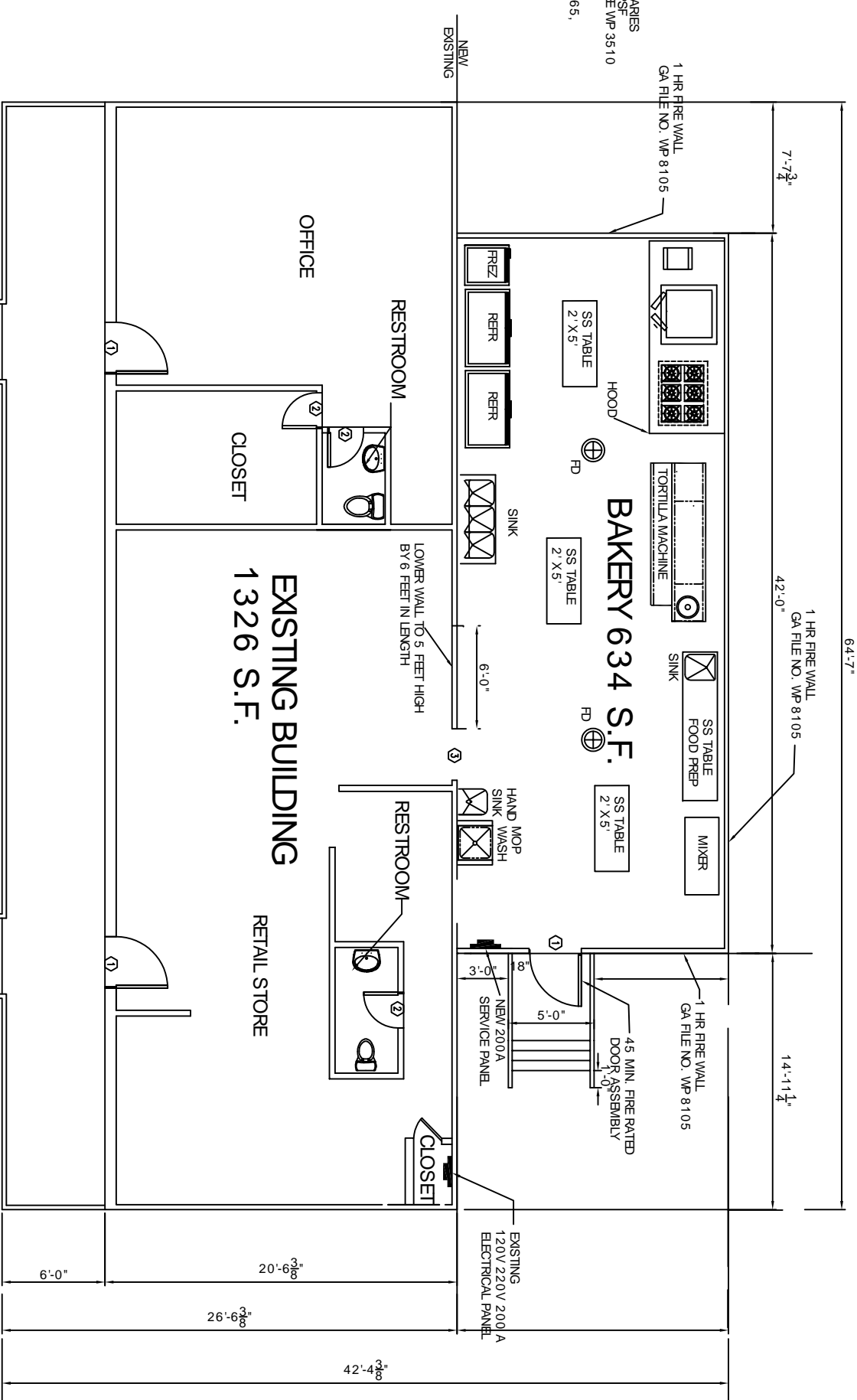

FLOOR PLAN  
SCALE 1/4" = 1'-0"

DOOR & HARDWARE SCHEDULE		REMARKS
NO.	SIZE	
•	HOLLOW METAL	
•	H/C WOOD	
•	CLAD/GLASS	
•	NONE	
•	STEEL	
•	ALUMINUM	
•	WOOD	
•	CASED OPENING	
•	DBL SWING	
•	BUTT	
•	BURGLERPRF	
•	SLIDING	
•	PASSAGE	
•	PRIVATE	
•	DEADBOLT	
•	KEYED HANDLE	
•	PUSH PULL	
•	PANIC	
•	THRESHOLD	
•	WEATHERSTRIP	
•	DOOR STOP	
•	FULL GLASS	
•	CLOSURE	
•	EXTERIOR	
•	EXTERIOR	

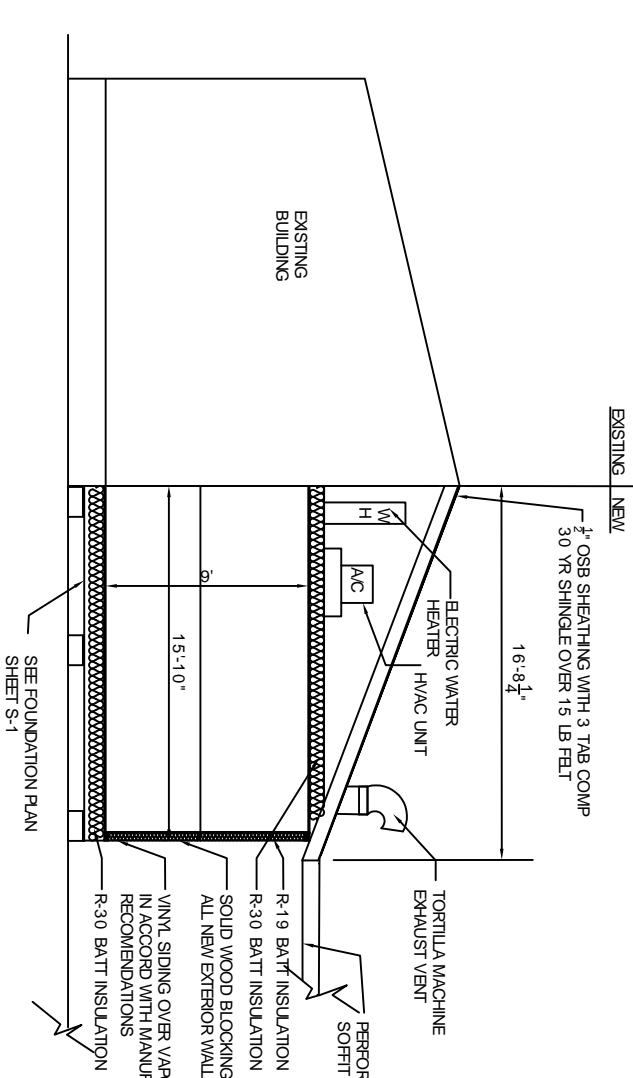

TYPICAL CROSS SECTION  
SCALE 1/4" = 1'-0"

GA FILE NO. WP 8105 GENERIC

EXTERIOR SIDE: ONE LAYER 48" WIDE 5/8" TYPE X GYPSUM SHEATHING APPLIED PARALLEL TO 2x4 WOOD STUDS 24" O.C. WITH 1-3/4" GALVANIZED ROOFING NAILS 4" O.C. AT VERTICAL JOINTS AND 7" O.C. AT INTERMEDIATE STUDS AND TOP AND BOTTOM PLATES. JOINTS OF GYPSUM SHEATHING MAY BE LEFT UNTREATED. EXTERIOR CLADDING TO BE ATTACHED THROUGH TO STUDS

INTERIOR SIDE: ONE LAYER 5/8" TYPE X GYPSUM WALLBOARD APPLIED PARALLEL TO 2x4 WOOD STUDS 24" O.C. WITH 1-3/4" GALVANIZED ROOFING NAILS 4" O.C. AT VERTICAL JOINTS AND 7" O.C. AT INTERMEDIATE STUDS AND TOP AND BOTTOM PLATES. JOINTS OF GYPSUM SHEATHING MAY BE LEFT UNTREATED. EXTERIOR CLADDING TO BE ATTACHED THROUGH TO STUDS

CONTRACTOR NOTES

1. CONTRACTOR IS TO VERIFY ALL MEASUREMENTS ON SITE
2. BAKERY FLOOR TO BE EVEN WITH EXISTING BUILDING FLOOR
3. FIRE PROTECTION SHALL BE ONE HOUR
4. INSTALL TWO FLOOR DRAINS SPACED EVENLY ALONG THE MIDDLE OF THE FLOOR
5. ALLOW 1/8" DROP PER FOOT FOR FLOOR DRAIN PIPING
6. FLOOR COVERING SHALL BE NON-SKID CERAMIC TILE
7. FLOOR JOIST TO BE 2"x12" @ 12" O.C.
8. CEILING JOIST TO BE 2"x8" @ 16" O.C.
9. ROOF RAFTERS TO BE 2"x8" @ 16" O.C.
10. CEILING AND FLOOR INSULATION TO BE R 30 WALL INSULATION TO BE R 19

GENERAL NOTES

1. INSULATION AND INSULATION ASSEMBLIES SHALL MEET THE REQUIREMENTS OF SECTION 7.19. INDEX OF 0-450, EXCEPT THAT IN COMBUSTIBLE (WOOD FRAMING) CONSTRUCTION.
  - A. CONCEALED INSULATION SHALL HAVE A FLAME SPREAD OF 0-25 AND SMOKE DEVELOPED INDEX OF 0-450, EXCEPT
  - B. FACINGS SHALL COMPLY WITH IBC 2006.
2. PROVIDE 5/8" LANDINGS, LEVEL WITH FINISHED FLOOR, OUTSIDE EXTERIOR DOORS. THRESHOLDS SHALL BE NOT MORE THAN 1/2" IN HEIGHT AND SHALL BE BEVELLED IF MORE THAN 1/4".
3. DIMENSIONS ARE TO CENTERLINE, FACE OF STUDS, CENTER OF COLUMNS, OR FACE OF VENEER.
4. CONTRACTOR TO VERIFY ALL SITE CONDITIONS, BUILDING LOCATIONS, AND DIMENSIONS PRIOR TO CONSTRUCTION.
5. MATERIALS SHALL BE NEW AND U.L. LISTED.
6. NO WORK SHALL BE CONCEALED UNTIL APPROVED BY LOCAL INSPECTORS.
7. CONSTRUCTION SHALL COMPLY WITH ALL PARISH, STATE AND LOCAL CODES.
8. CONTRACTOR TO GUARANTEE WORK FOR ONE YEAR.
9. CONTRACTOR SHALL FURNISH WATER AND POWER FROM EXISTING SOURCES.
10. EXTERIOR CAULK SHALL BE DOW CORNING 790 SILICONE, INSTALL IN ACCORDANCE WITH MANUFACTURER RECOMMENDATIONS. COORDINATE WITH ARCHITECT/OWNER AS TO COLOR INTERIOR CAULKING TO BE EQUAL TO DAP PAINTABLE LATEX WITH SILICONE
11. PAINT GRADE TO SHALL BE SHERWIN WILLIAMS OR EQUIVALENT. ALL WORK TO RECEIVE 3 COATS. COLOR SELECTION BY OWNER.
12. PROVIDE CLEANUP ON A REGULAR BASIS. NO TRASH STORED IN BUILDING.
13. ALL BATT INSULATION SHALL HAVE A CLASS "A" (0-25) FLAME SPREAD IN COMPLIANCE WITH APPLICABLE CODE
14. USE 6" STUDS, OR 4" STAGGERED STUDS AT ALL PLUMBING WALLS.
15. PROVIDE GALVANIZED METAL PAN WITH DRAIN AT WATER HEATER LOCATION.
16. ALL CORNERS SHALL BE PROPERLY BRACED FOR WIND LOADS. A 48" SHEATHING SHALL BE PROVIDED EVERY 20 FEET OF WALL LENGTH.
17. FLOORING SHALL BE NON-SLIP.
18. INTERIOR LOCKS ON DOORS IN MEANS OF EGRESS SHALL NOT REQUIRE THE USE OF A KEY, SPECIAL KNOWLEDGE, OR SPECIAL DEVICE TO OPEN IN THE DIRECTION OF EGRESS. ALL DOORS SHALL HAVE LEVER TYPE HANDLES.
19. INTERIOR WALLS AND CEILINGS SHALL HAVE A FLAME SPREAD OF 0-200 AND A SMOKE DEVELOPMENT RATING OF 0-450.
20. ALL WORK SHALL COMPLY WITH THE LATEST EDITION OF ALL LOCAL, STATE AND NATIONAL CODES COVERING THE TYPE OF WORK BEING PERFORMED.
21. PROVIDE PORTABLE FIRE EXTINGUISHERS IN ACCORDANCE WITH NFPA 101. SEE APPENDIX "E" OF NFPA 101 FOR DISTRIBUTION OF EXTINGUISHERS.
22. ALL FIRE WALLS SHALL EXTEND TIGHT TO ROOF SHEATHING, AND BE SEALED WITH AN APPROVED FIRE CAULK.
23. ALL ELECTRICAL, MECHANICAL, AND PLUMBING MATERIALS PENETRATING FIRE WALLS SHALL BE FIRE CALKED. PENETRATIONS THROUGH RATED CONSTRUCTION SHALL BE SEALED WITH A MATERIAL CAPABLE OF PREVENTING THE PASSAGE OF FLAMES AND HOT GASES WHEN TESTED IN ACCORDANCE WITH ASTM-E814.
24. SERVICE COUNTER SHALL HAVE A HCP ACCESSIBLE WRITING SURFACE, MAX. 36" FROM F.F. (ADAAG MANUAL 1998, PG.135)

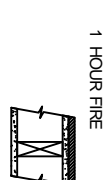

THICKNESS:  
APPROX. WEIGHT:  
FIRE TEST:  
VARIES  
7 PSF  
SEE WP 35110

(UL R3601 47, 48, 9-17-65,  
UL R3601 45, 46,  
UL R3601 42, 43, 44,  
UL R3601 41, 42, 43, 44,  
UL DESIGN U314)