

1 ELEVATION - AREAS 107 AND 109    2 ELEVATION - AREA 107    3 ELEVATION - AREAS 109 & 111    4 ELEVATION - AREA 108    5 ELEVATION - AREA 102    6 ELEVATION - AREA 101

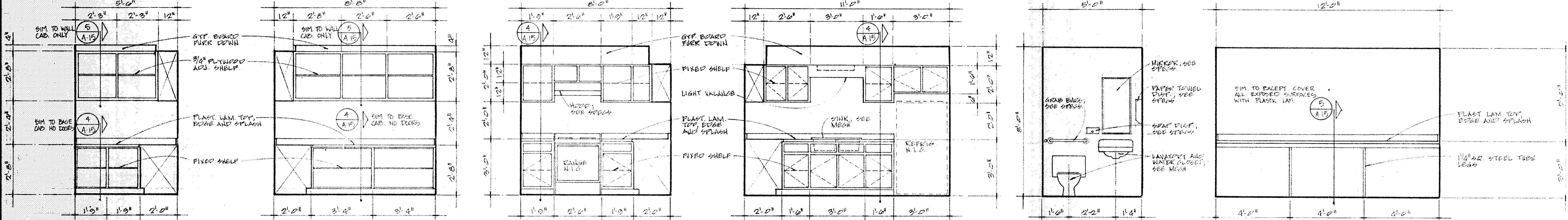

7 ELEVATION - AREA 105    8 ELEVATION - AREA 105    9 ELEVATION - AREA 112    10 ELEVATION - AREA 112    11 ELEVATION - AREA 116    12 ELEVATION - AREA 120

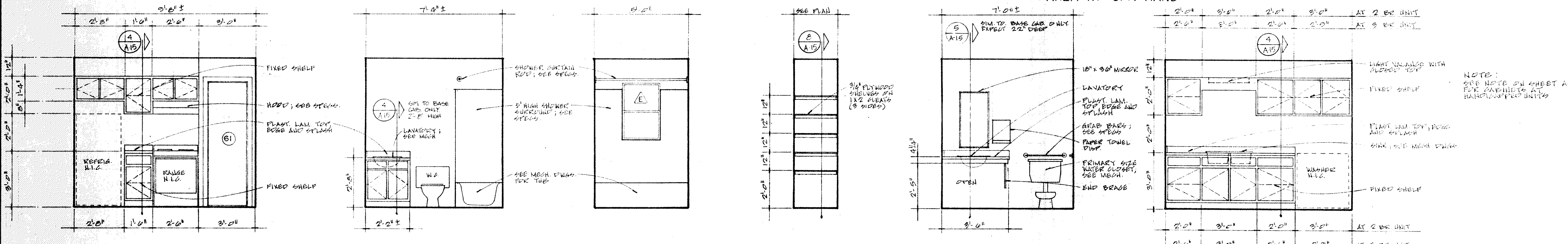

13 ELEVATION - KITCHEN - 1 BR. UNIT    14 TYPICAL BATH ELEVATION    15 TYP. BATH ELEV.    16 TYP. LINEN AND PANTY ELEV.    17 HANDICAPPED TOILET CHILD CARE CENTER    18 ELEVATION - KITCHEN 2 AND 3 BR. UNITS

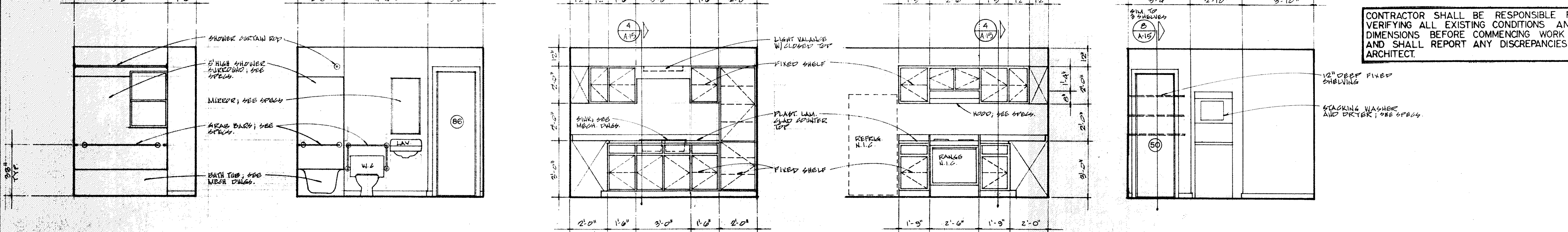

19 ELEV. - HANDICAPPED BATH 2 BR. UNIT    20 ELEV. - HANDICAPPED BATH 2 BR. UNIT    21 ELEV. - KITCHEN/DINING - CHILD CARE CENTER    22 ELEV. - KITCHEN/DINING - CHILD CARE CENTER    23 ELEVATION - KITCHEN/DINING - CHILD CARE CENTER

CONTRACTOR SHALL BE RESPONSIBLE FOR VERIFYING ALL EXISTING CONDITIONS AND DIMENSIONS BEFORE COMMENCING WORK AND SHALL REPORT ANY DISCREPANCIES TO ARCHITECT.