



Engberg Anderson Design Partnership, Inc.
MILWAUKEE • MADISON

AMERICAN DENTAL PARTNERS- METAIRIE

2400 VETERANS BOULEVARD SUITE 210
KENNER, LOUISIANA

Owner
American Dental Partners, Inc.
3000 W. Esplanade Ave. Suite 200
Metairie, LA 70002

Project No 071750

Issued For:

No.	Description	Date
01	ISSUED FOR BID	10-17-07

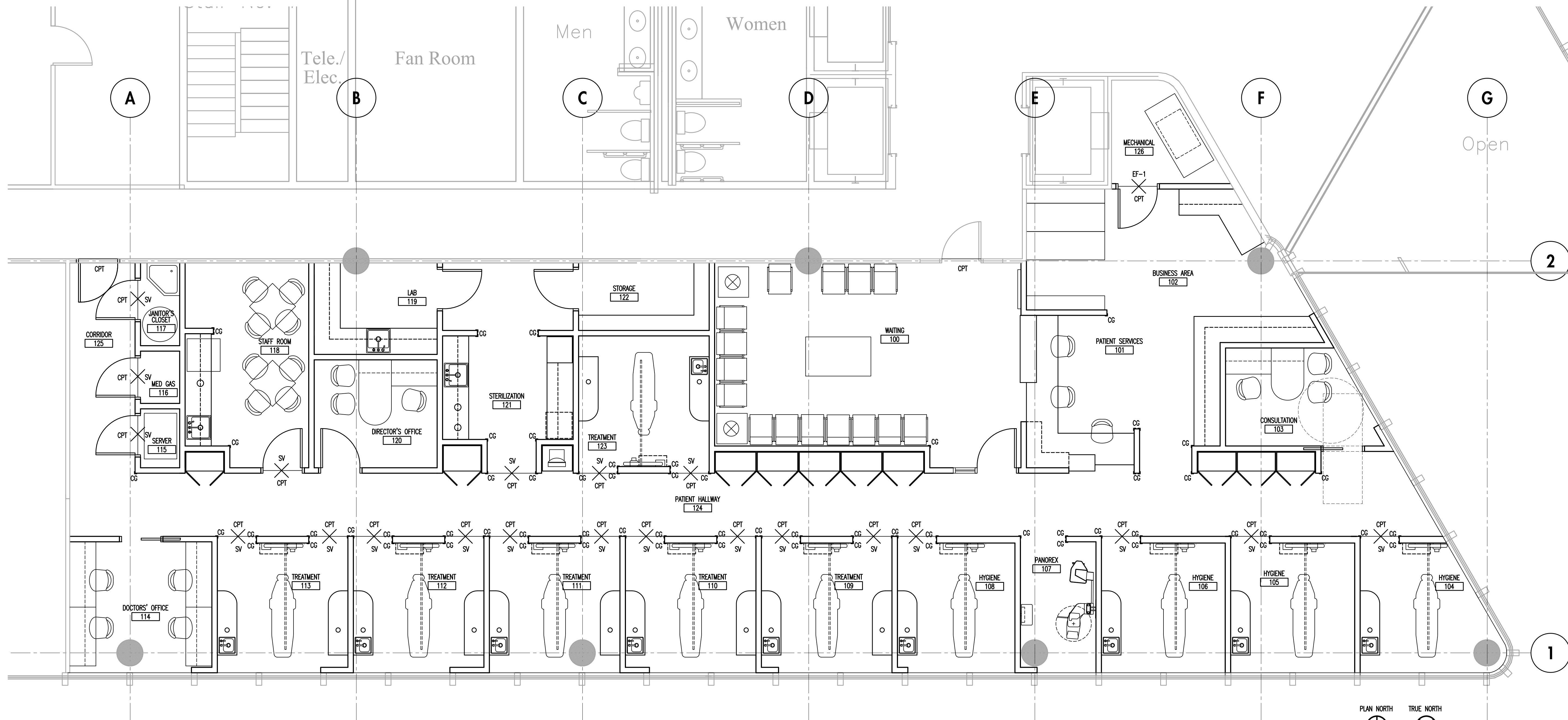

1 Floor Finishes Plan
A2.3 SCALE: 1/4"=1'-0"

ROOM FINISH SCHEDULE

ROOM #	ROOM NAME	NOTES	FLOOR	BASE	NORTH	EAST	SOUTH	WEST	CEILING
100	WAITING		CPT	RB	WVC-1	WVC-1	WVC-2	WVC-2	ACT
101	PATIENT SERVICES		CPT	RB	WVC-1	WVC-1	WVC-1	WVC-1	ACT
102	BUSINESS AREA		CPT	RB	WVC-1	WVC-1	WVC-1	WVC-1	ACT
103	CONSULTATION		CPT	RB	WVC-1	WVC-1	WVC-1	WVC-1	ACT
104	HYGIENE ROOM		SV	RB	WVC-1	WVC-1	WVC-1	WVC-1	ACT
105	HYGIENE ROOM		SV	RB	WVC-1	WVC-1	WVC-1	WVC-1	ACT
106	HYGIENE ROOM		SV	RB	WVC-1	WVC-1	WVC-1	WVC-1	ACT
107	PANOREX		CPT	RB	WVC-1	WVC-1	WVC-1	WVC-1	ACT
108	HYGIENE ROOM		SV	RB	WVC-1	WVC-1	WVC-1	WVC-1	ACT
109	TREATMENT ROOM		SV	RB	WVC-1	WVC-1	WVC-1	WVC-1	ACT
110	TREATMENT ROOM		SV	RB	WVC-1	WVC-1	WVC-1	WVC-1	ACT
111	TREATMENT ROOM		SV	RB	WVC-1	WVC-1	WVC-1	WVC-1	ACT
112	TREATMENT ROOM		SV	RB	WVC-1	WVC-1	WVC-1	WVC-1	ACT
113	TREATMENT ROOM		SV	RB	WVC-1	WVC-1	WVC-1	WVC-1	ACT
114	DOCTORS' OFFICE		CPT	RB	WVC-1	WVC-1	WVC-1	WVC-1	ACT
115	SERVER		SV	RB	P-1	P-1	P-1	P-1	ACT
116	MED GAS		SV	RB	P-1	P-1	P-1	P-1	ACT
117	JANITOR'S CLOSET		SV	RB	P-1	P-1	P-1	P-1	ACT
118	STAFF ROOM		SV	RB	WVC-1	WVC-1	WVC-1	WVC-1	ACT
119	LAB		SV	RB	WVC-1	WVC-1	WVC-1	WVC-1	ACT
120	DIRECTOR'S OFFICE		CPT	RB	WVC-1	WVC-1	WVC-1	WVC-1	ACT
121	STERILIZATION		SV	RB	WVC-1	WVC-1	WVC-1	WVC-1	ACT
122	STORAGE		SV	RB	WVC-1	WVC-1	WVC-1	WVC-1	ACT
123	TREATMENT ROOM		SV	RB	WVC-1	WVC-1	WVC-1	WVC-1	ACT
124	PATIENT HALLWAY		CPT	RB	WVC-1	WVC-1	WVC-1	WVC-1	ACT
125	CORRIDOR		CPT	RB	WVC-1	WVC-1	WVC-1	WVC-1	ACT
126	MECHANICAL		EF-1	RB	P-1	P-1	P-1	P-1	ACT

FINISH NOTES

- ALL EXTERIOR WINDOWS TO HAVE MANUALLY OPERATED 1" MINI BLIND. CLEAN ALL BLINDS AND REPLACE DAMAGED ONES.
- RESILIENT BASE TO BE 4" HIGH, TYPICAL.
- RESILIENT BASE AND CORNER GUARDS TO COORDINATE WITH WVC, TYPICAL.
- ALT BID #1 PROVIDE SS-1 IN LIEU OF PL-2 IN STERILIZATION 121

FINISH LIST

MATERIAL	DESIGNATION	NOTES
ACOUSTICAL CEILING TILE	ACT-1	MANUFACTURER: ARISTON STYLE: OPTIMA 24"X24", WHITE NUMBER: 350 SPE: 15/16"
CARPET	CPT-1	MANUFACTURER: PARSONS STYLE: 8015 BUCKLE COLOR: 15706 MOSING
PANT	PT-1	MANUFACTURER: BENJAMIN MOORE STYLE: INTERIOR READY-TO-PAINT COLOR: BONE WHITE F-151
PLASTIC LAMINATE	PL-1	MANUFACTURER: NEWARK COLOR: CLEAR MAPLE TEXTURED NUMBER: 98634T
PLASTIC LAMINATE	PL-2	MANUFACTURER: WILSONART COLOR: BURNISHED CHESTNUT NUMBER: 4796-60
PLASTIC LAMINATE	PL-3	MANUFACTURER: FORMICA COLOR: AUTE GAUZE NUMBER: 7709-58
PLASTIC LAMINATE	PL-4	MANUFACTURER: NEWARK COLOR: MORY ESSENCE TEXTURED NUMBER: E5301T
RESILIENT BASE	RB-1	MANUFACTURER: JOHNSONITE COLOR: BROWN NUMBER: 47
SOLID SURFACE	SS-1	MANUFACTURER: CORIAN COLOR: DELTA SAND
SHEET VINYL	SV-1	MANUFACTURER: FERRIS STYLE: SANAGED MARBLE COLOR: 6332 IMPER
VINYL WALLCOVERING	WVC-1	MANUFACTURER: KRODICAL STYLE: DESERT SAND COLOR: NEUTRAL BESE 5421-14
VINYL WALLCOVERING	WVC-2	MANUFACTURER: KRODICAL STYLE: DESERT SAND COLOR: SILVER GREEN 5421-48
TACKABLE FABRIC	TWC-1	MANUFACTURER: ESSENTIX STYLE: BRICKWORK COLOR: PARCHMENT 2890-101
CORNER GUARDS	CG	MANUFACTURER: PC COLOR: ORIGINAL, TEXTURE .000
EPOXY FLOOR	EF-1	MANUFACTURER: DOW-10-100 STYLE: REFORON COLOR: 431 GRE GRAY
WINDOW BLINDS	WB-1	MANUFACTURER: DRI STYLE: 1" HORIZONTAL, 8 GAUGE METAL MINI-BLINDS COLOR: 654 ALUMINUM

Drawn by RAF
Checked by TAS
File 1750 A2-3.dwg

Floor Finishes Plan

A2.3