



**DAMMON**  
ENGINEERING, INC.  
EMMETT  
DAMMON

ARCHITECT  
ROBERT  
WILTSE

1095 FLORIDA AVENUE  
SLIDELL, LA. 70458  
985-649-5832

WEBSITE:  
WWW.DAMMONENGINEERING.COM

EMAIL:  
DAMMONENG@BELL.SOUTH.NET

ARCHITECTURE  
ENGINEERING  
STUDIES  
PLANNING  
INVESTIGATION  
EXPERT WITNESS

PRECISION  
SEWING  
MACHINES  
II CO.

HWY 190  
MANDEVILLE, LA

SITE  
PLAN

REV:

SCALE: AS NOTED

JOB#: 1917

DATE: 12-19-07

SHEET

C-1

OF

**LEGEND**

———	PROPERTY LINE
—W—	NEW 3/4" WATER LINE
-S-----	NEW 1 1/4" FORCE MAIN
—P—	EXISTING PHONE LINE
—G—	EXISTING GAS LINE
—W—	EXISTING 6" WATER LINE
—S—	EXISTING 8" SEWER LINE

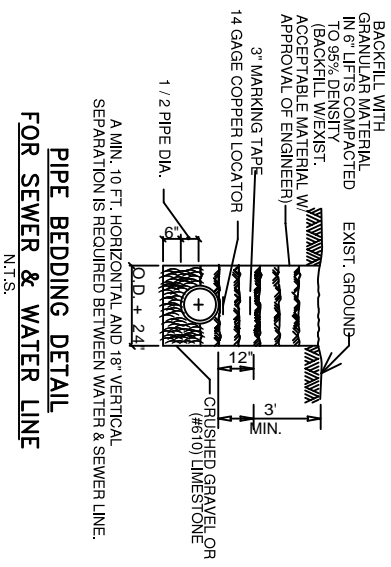
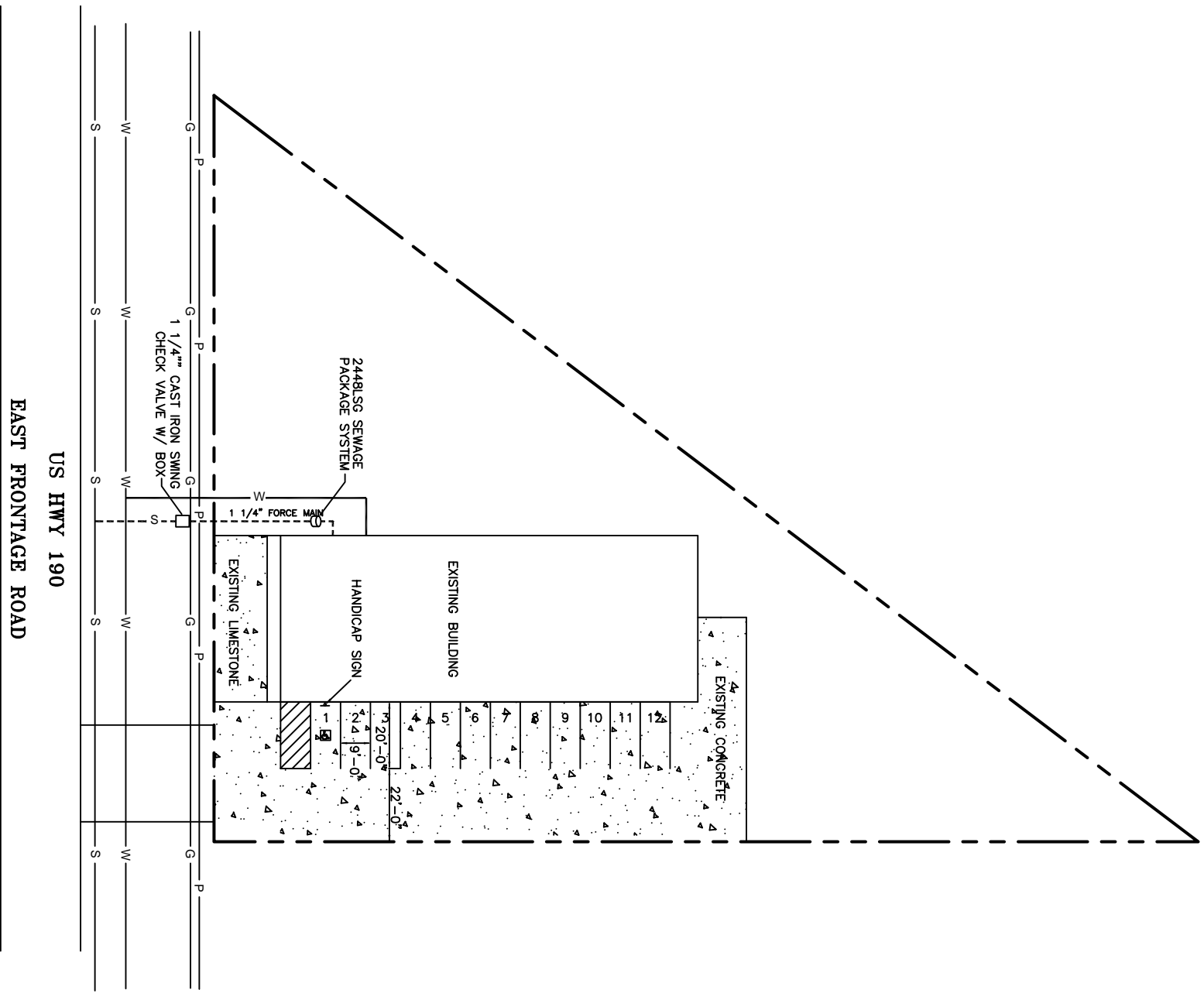

SITE PLAN  
SCALE: 1"=20'



EAST FRONTAGE ROAD

US HWY 190