

FINISH SCHEDULE					
NAME	FLOOR	BASE	WALLS	CEILING	REMARKS
OFFICE				CARPET	
BATHROOM				CONCRETE	
WAREHOUSE				CERAMIC TILE	
				WCT	
				CERAMIC TILE	
				NONE	
				CERAMIC TILE	
				RUBBER WALL BASE	
				WOOD BASE	
				NONE	
				CERAMIC TILE	
				5/8" GYPSUM BOARD	
				2'x2' LAY-IN PANELS	
				GYPSUM BOARD	
				CEILING HEIGHT...	
				OWNER TO SELECT STYLE, COLOR, AND BRAND	

WINDOW SCHEDULE							
MARK	SIZE	TYPE	FRAME	GLASS	UTILES	ACCESSORIES	REMARKS
A	3.0' x 5.0'	FIXED	ALUMINUM*	TINTED	2/2	SEE ELEV.	
		S. HUNG	WOOD	INSUL. LOW E	2/4	ALARM	
		D. HUNG		TEMPERED	6/6	SCREEN	
		HORIZ. SLIDE		WIREGLASS		SHUTTER	
		VERT. SLIDE					
		STEEL					
		ALUMINUM*					
		WOOD					

DOOR & HARDWARE SCHEDULE						
MARK	TYPE	FRAME	HINGE	LOCK	ACCESSORIES	REMARKS
1	DOOR - EXTERIOR	SOLID WOOD				
2	DOOR - EXTERIOR	HOLLOW METAL				
3	DOOR - EXTERIOR	SLIDING				
4	DOOR - EXTERIOR	STOREFRONT				
5	DOOR - EXTERIOR	OVERHEAD				
6	DOOR - INTERIOR	STEEL				
7	DOOR - INTERIOR	ALUMINUM				
8	DOOR - INTERIOR	WOOD				
9	DOOR - INTERIOR	CASED OPENING				
10	DOOR - INTERIOR	DBL SWING				
11	DOOR - INTERIOR	BUTT 1-1/2 PR				
12	DOOR - INTERIOR	BURGLERPRF				
13	DOOR - INTERIOR	FIXED				
14	DOOR - INTERIOR	PASSAGE				
15	DOOR - INTERIOR	KEYED HANDLE				
16	DOOR - INTERIOR	OFFICE/ENTRANCE				
17	DOOR - INTERIOR	STOREROOM				
18	DOOR - INTERIOR	PANIC BAR				
19	DOOR - INTERIOR	THRESHOLD				
20	DOOR - INTERIOR	WEATHERSTRIP				
21	DOOR - INTERIOR	DOOR STOP				
22	DOOR - INTERIOR	ALARM				
23	DOOR - INTERIOR	SILENCER				
24	DOOR - INTERIOR	CLOSER				

- DOOR & HARDWARE NOTES:**
1. ALL GLAZING TO BE LAMINATED SAFETY GLASS.
 2. DOOR HINGES TO BE STANLEY FULL MORSTICE STANDARD WEIGHT BALL BEARING HINGES. STAINLESS STEEL WITH DARK BRONZE FINISH @ EXTERIOR & MATCHING DARK BRONZE FINISH ON STANDARD STEEL @ INTERIOR
 3. PROVIDE LEVER HANDLE ADA APPROVED LOCKSETS WITH MATCHING DARK BRONZE FINISH. TO BE SELECTED BY OWNER.
 4. COORDINATE KEYS SCHEDULE WITH OWNER.
 5. DOOR STOPS TO BE EQUAL TO VES NO. 436 OR 437, AS REQUIRED IN MATCHING DARK BRONZE FINISH.
 6. WEATHER-STRIP & THRESHOLD FINISH TO COMPLEMENT OTHER HARDWARE
 7. WD, DOOR, TRIM, & BASE TO BE SELECTED BY OWNER.

**FOR GENERAL NOTES
SEE A-3**

- DOCKING NOTES:**
1. PROVIDE WALL MOUNTED DOCK LIGHT EQUAL TO LOADING DOCK SUPPLY WITH 40" ARM, WIRE GUARD, AND MOUNTING BRACKET SUITABLE FOR (UP TO) 300 WATT INCANDESCENT BULB. LOCATE SUITABLE OUTLET ADJACENT.
 2. PROVIDE PERMANENT DOCK BOARD LEVER EQUAL TO LOADING DOCK SUPPLY MODEL #25BP72 COMPLETE WITH BUMPERS, SELF STORING OPERATING HANDLE & LATCH ASSEMBLY.
 3. PROVIDE MECHANICAL TRUCK RESTRAINT EQUAL TO BEACON INDUSTRIES, INC. BM/R SERIES COMPLETE WITH OPTIONAL BLOCKOUT. (TO COORDINATE WITH DOCK LEVER), ACTIVATION BAR, AND OPTIONAL MANUAL OPERATED LIGHT SYSTEM AND SAFETY SIGNS.
 4. TRENCH DRAIN EQ. TO ZURN Z282 12" WIDE PRE-SLOPED SYSTEM W/ GALV. GRATINGS SLOPING TO SUMP PIT AND PUMP. PUMP TO DISCHARGE TO CLOSEST EXTERIOR DRAINAGE PATTERN.

GA FILE NO. WP 1072 GENERIC

ONE LAYER 5/8" TYPE X GYPSUM WALLBOARD OR GYPSUM VENEER BASE APPLIED PARALLEL OR AT RIGHT ANGLES TO EACH SIDE OF 3'-5/8" STEEL STUDS 24" O.C. WITH 1" TYPE S DRILL WALL SCREWS 8" O.C. AT VERTICAL JOINTS AND 12" O.C. AT FLOOR AND CEILING RUNNERS AND INTERMEDIATE STUDS.

JOINTS STAGGERED 24" ON EACH SIDE AND ON OPPOSITE SIDES. SOUND TESTED WITH 3'-12" GLASS FBRR FRICTION FIT IN STUD SPACE. (NON-LOAD BEARING)

1 HOUR FIRE 45 TO 49 STC SOUND

THICKNESS: 4-7/8"

APPROX WEIGHT: 6 PSF

FIRE TEST: SEE WP 1200 (FM WP-45, 6-19-68); OSU I-1770, 8-6-1; UIC 7 97484, 791500, 797497, 8-12-81, UIC DESIGN (W415) SOUND TEST: NCCG 816-1M, 2-3-81

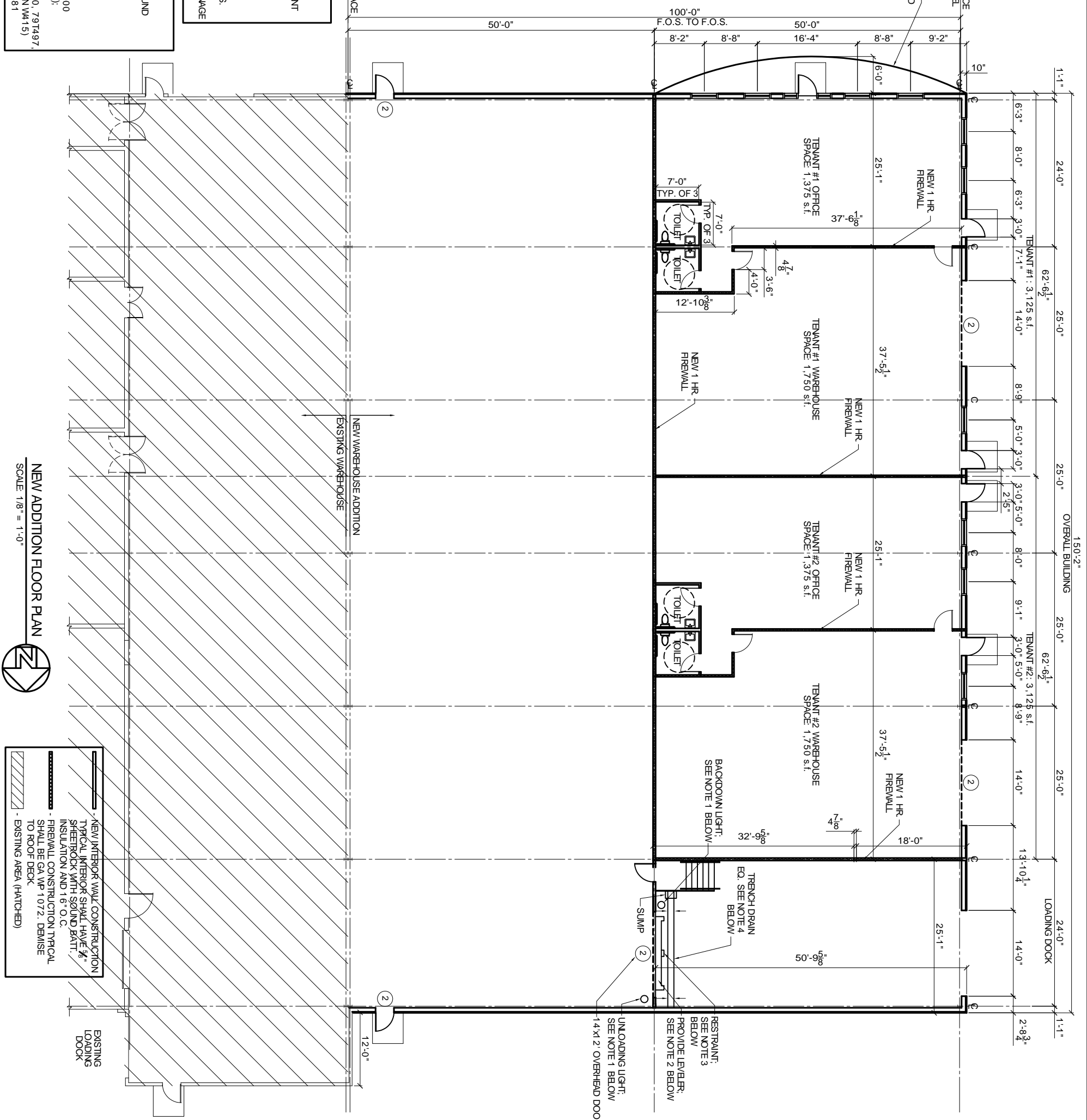

NEW ADDITION FLOOR PLAN
SCALE 1/8" = 1'-0"

NEW INTERIOR WALL CONSTRUCTION
TYPICAL INTERIOR SHALL HAVE 5/8" SHEETROCK WITH SOUND BATT INSULATION AND 16" O.C.

FIREWALL CONSTRUCTION
TYPICAL SHALL BE GA WP 1072. DEVISE TO ROOF DECK

EXISTING AREA (HATCHED)

<p>DAMMON ENGINEERING, INC. CHIEF ENGINEER EMMETT DAMMON, P.E. CHIEF ARCHITECT ROBERT WILTSE</p> <p>1095 FLORIDA AVENUE SUITE LL, LA 70458 OFFICE: 985-649-5932 FAX: 985-641-5950</p> <p>WWW.DAMMONENGINEERING.COM</p> <p>WEBSITE: EMAIL: DAMMONENG@BELLFLOWL.NET</p>	<p>ARCHITECTURE</p> <p>ENGINEERING</p> <p>STUDIES</p> <p>PLANNING</p> <p>INVESTIGATION</p> <p>EXPERT WITNESS</p>
	<p>SAL & JUDYS 501 J.F. SMITH AVE SUDELL, LA 70460</p>
<p>NEW ADDITION FLOOR PLAN</p>	<p>SCALE: AS NOTED</p> <p>JOB#: 1938</p> <p>DATE: 2-29-08</p> <p>SHEET</p>
<p>OF</p>	<p>A-2</p>