

**DAMMON**  
ENGINEERING, INC.

CHIEF ENGINEER  
EMMETT  
DAMMON, P.E.  
CHIEF ARCHITECT  
ROBERT  
WILTSE

1095 FLORIDA AVENUE  
SLIDELL, LA, 70458  
OFFICE: 985-649-5832  
FAX: 985-641-5950

WWW.DAMMONENGINEERING.COM  
EMAIL:  
DAMMONENG@BELLFLOWTH.NET

ARCHITECTURE  
ENGINEERING  
STUDIES  
PLANNING  
INVESTIGATION  
EXPERT WITNESS

**NEW**  
CREMATORY  
AND EMBALMING  
FACILITY

HONAKER FUNERAL  
HOME  
TERRY TRANCHINA  
1751 W. GAUSE BLVD  
SLIDELL, LA

FLOOR  
PLAN

REV: 12-04-09  
SCALE: AS NOTED  
JOB#: 1999  
DATE: 6-9-09  
SHEET 7

**A-1**

OF 19

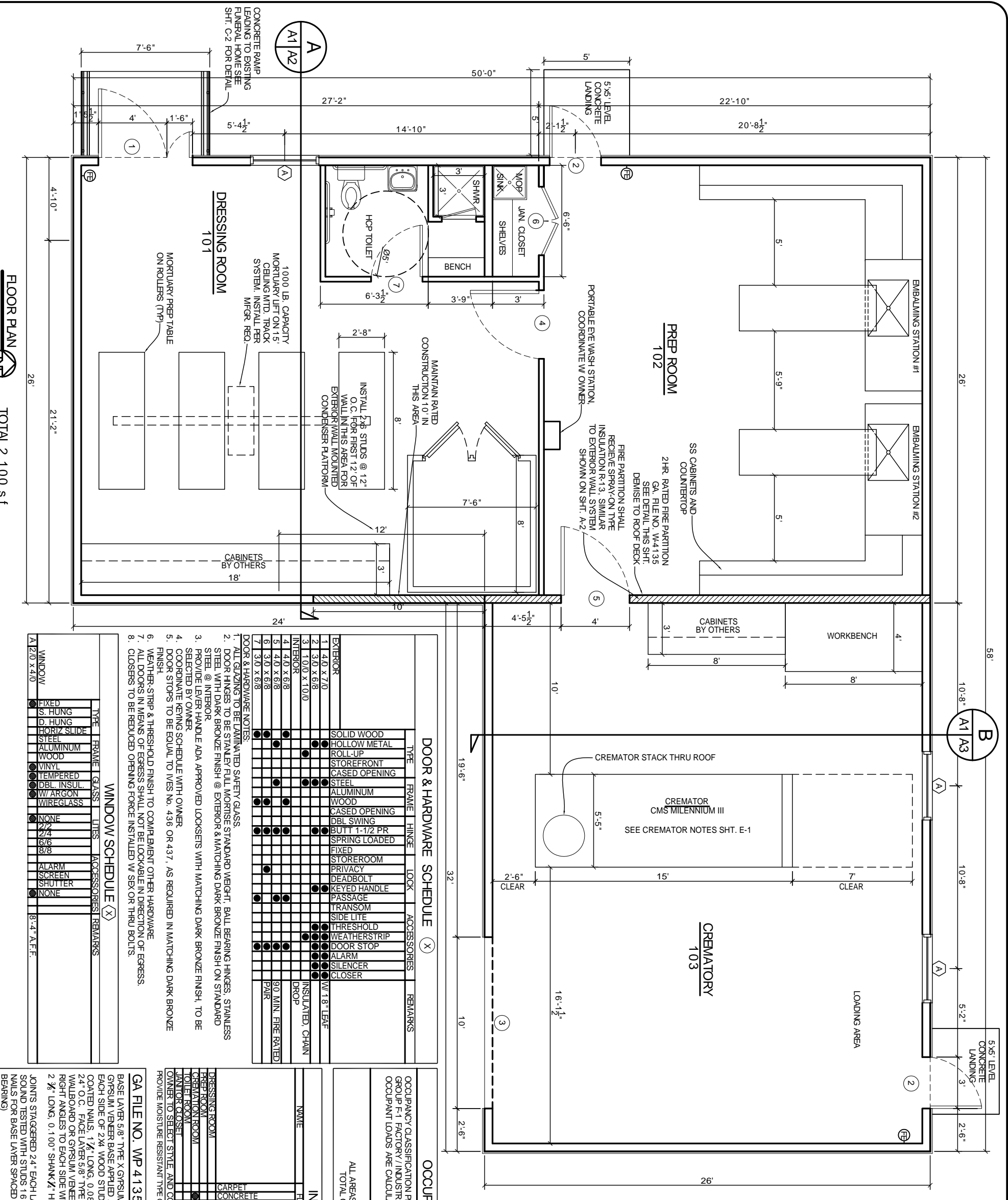

**DOOR & HARDWARE SCHEDULE (X)**

NO.	TYPE	FRAME	HINGE	LOCK	ACCESSORIES	REMARKS
1	EXTERIOR	4.0 x 7.0			SOLID WOOD	
2		3.0 x 6.8			HOLLOW METAL	
3		10.0 x 10.0			ROLL-UP	
4	INTERIOR	4.0 x 6.8			STOREFRONT	
5		4.0 x 6.8			CASED OPENING	
6		3.0 x 6.8			STEEL	
7		3.0 x 6.8			ALUMINUM	
8		3.0 x 6.8			WOOD	
9		3.0 x 6.8			CASED OPENING	
10		3.0 x 6.8			DBL SWING	
11		3.0 x 6.8			BUTT 1-1/2 PR	
12		3.0 x 6.8			SPRING LOADED	
13		3.0 x 6.8			FIXED	
14		3.0 x 6.8			STOREROOM	
15		3.0 x 6.8			PRIVACY	
16		3.0 x 6.8			DEADBOLT	
17		3.0 x 6.8			KEYED HANDLE	
18		3.0 x 6.8			PASSAGE	
19		3.0 x 6.8			TRANSOM	
20		3.0 x 6.8			SIDE LITE	
21		3.0 x 6.8			THRESHOLD	
22		3.0 x 6.8			WEATHERSTRIP	
23		3.0 x 6.8			DOOR STOP	
24		3.0 x 6.8			ALARM	
25		3.0 x 6.8			SILENCER	
26		3.0 x 6.8			CLOSER	
27		3.0 x 6.8			INSULATED CHAIN	
28		3.0 x 6.8			W/ 18" LEAF	
29		3.0 x 6.8			DROP	
30		3.0 x 6.8			90 MIN. FIRE RATED	
31		3.0 x 6.8			PAIR	

**OCCUPANT LOAD CALCULATIONS**

OCCUPANCY CLASSIFICATION PER IBC 2006 (SECTION 302)  
GROUP F-1, FACTORY/INDUSTRIAL, MODERATE HAZARD  
OCCUPANT LOADS ARE CALCULATED PER VALUES GIVEN BY NFPA 101, 2006, TABLE 7.3.1.2

TOTAL BUILDING: 2,100  
ALL AREAS: 2,100 S.F. / 100 S.F. PER OCC. = 21  
TOTAL OCCUPANT LOAD = 21 OCCUPANTS

**INTERIOR FINISH SCHEDULE**

NAME	FLOOR	BASE	WALLS	CEILING	REMARKS
DRESSING ROOM	1	1/2" GYPSUM	1/2" GYPSUM	1/2" GYPSUM	
PREP ROOM	1	1/2" GYPSUM	1/2" GYPSUM	1/2" GYPSUM	
CREMATORY ROOM	1	1/2" GYPSUM	1/2" GYPSUM	1/2" GYPSUM	
TOILET ROOM	1	1/2" GYPSUM	1/2" GYPSUM	1/2" GYPSUM	
JANITOR CLOSET	1	1/2" GYPSUM	1/2" GYPSUM	1/2" GYPSUM	
OWNER TO SELECT STYLE AND COLOR OF FINISH MATERIALS. PROVIDE MOISTURE RESISTANT THE GRP. BD. IN ALL DAMP AREAS.					

**GA FILE NO. WP 4135 GENERIC**

BASE LAYER 5/8" TYPE X GYPSUM WALLBOARD OR GYPSUM VENEER BASE APPLIED AT RIGHT ANGLES TO EACH SIDE OF 2x4 WOOD STUDS 24" O.C. WITH 6D COATED NAILS, 1 1/2" LONG, 0.085" SHANK, 1/2" HEADS, 24" O.C. FACE LAYER 5/8" TYPE X GYPSUM WALLBOARD OR GYPSUM VENEER BASE APPLIED AT RIGHT ANGLES TO EACH SIDE WITH 8D COATED NAILS, 2 1/2" LONG, 0.100" SHANK, 1/2" HEADS, 8" O.C.

2 HOUR FIRE  
40 TO 44 STC SOUND

THICKNESS: 6 1/8"  
APPROX. WEIGHT: 12 PSF  
FIRE TEST: FM WP 360, 9-27-74  
SOUND TEST: NCG 2363, 4-1-70



**LEGEND**

- 2HR. RATED FIRE PARTITION  
GA. FILE NO. W-4135  
SEE DETAIL THIS SHT.
- NEW FIRE EXTINGUISHER IN ACCORDANCE W/ NFPA 10
- 4" OR 6" (AS SHOWN) WALL W/ WOOD STUDS 16" O.C. SEE FINISH SCHEDULE

FLOOR PLAN  
SCALE: 3/8" = 1'-0"  
TOTAL 2,100 S.F.