

DAMMON
ENGINEERING, INC

CHIEF ENGINEER
EMMETT
DAMMON, P.E.
CHIEF ARCHITECT
ROBERT
WILTSE

1095 FLORIDA AVENUE
SUITE L.A. 7045B
OFFICE: 985-649-5832
FAX: 985-641-5950

WEBSITE:
WWW.DAMMONENGINEERING.COM
EMAIL:
DAMMONENG@BELLSOUTH.NET

ARCHITECTURE
ENGINEERING
STUDIES
PLANNING
INVESTIGATION
EXPERT WITNESS

CENTRAL ROCK
OF LA.
3855 FRANCE RO/
NEW ORLEANS
LA

SITE
PLAN

REV: 5-11-09

SCALE: AS NOTED

JOB#:

DATE: 05-06-09

SHEET

C-1

OF

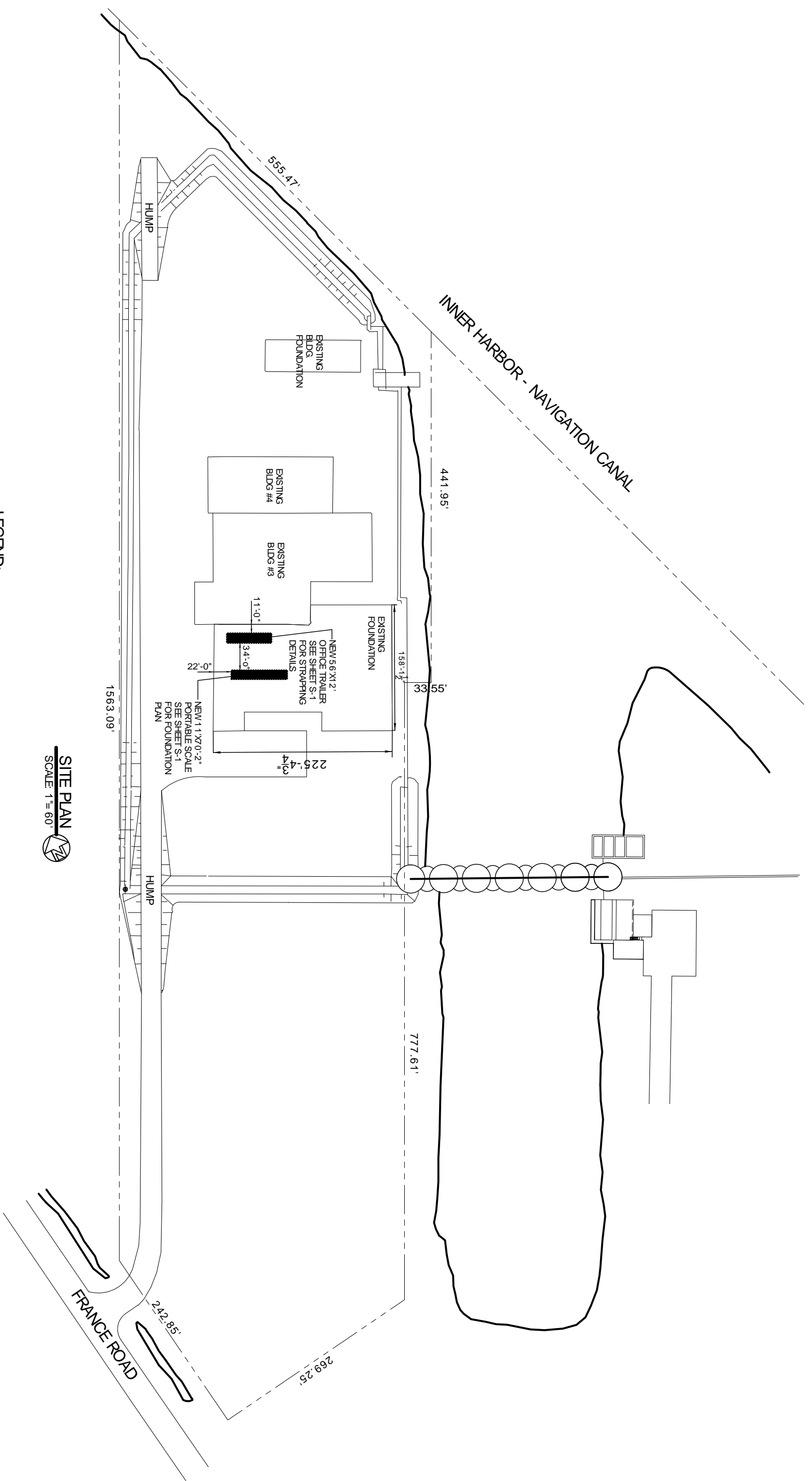

SITE PLAN
SCALE: 1" = 60'

LEGEND:

NEW 5/6'X12' OFFICE TRAILER LOCATION

NOTES:

1. CONTRACTOR SHALL CONTACT AND COORDINATE WITH THE APPROPRIATE DISCIPLINE FOR SEWER, WATER, GAS AND ELECTRICAL AND VERIFY THAT ALL SERVICES HAVE BEEN DISCONNECTED PRIOR TO DEMOLITION OF ANY BUILDINGS ON THIS SITE