

DUDLEY SMITH PRINTING

RENOVATION = 1375 SQ.FT.

TYLER SQUARE

SUITE #1

58465 TYLER STREET
SLIDELL, LA 70458

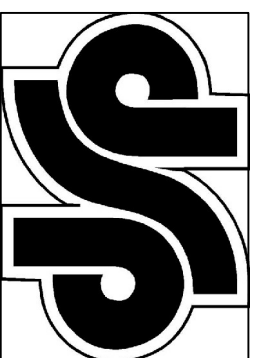

INTERNATIONAL BUILDING CODE 2009 SUMMARY

OCCUPANCY CLASSIFICATION:
BUSINESS GROUP - B (SEC 304.1)

OCCUPANT LOAD: (TBL 1004.1.1)
BUSINESS = 100 GROSS / OCCUPANT = 1,375/100 = 13.75 OCCUPANTS
TOTAL LOAD = 14,00 OCCUPANTS

EXIT ACCESS REQUIREMENTS: (SEC 1014)
EXIT REQUIRED FOR < 50 OCCUPANTS (TBL 1015.1)
EXIT PROVIDED
MAXIMUM COMMON PATH OF EGRESS TRAVEL = 200' (BUSINESS WITHOUT SPRINKLER, TBL 1016.1)
LONGEST EGRESS PATH IN AREA OF WORK = 44'

CONSTRUCTION CLASSIFICATION: (SEC 602.2)
TYPE IIB

ALLOWABLE HEIGHT AND BLDG. AREA: (TBL 503)
THREE STORY AND 23,000-50,000 SQ.FT. (BUSINESS)
THIS BLDG. = 11,000 SQ.FT. / 1 STORY

FIRE RESISTANCE RATING REQUIREMENTS FOR BLDG. ELEMENTS: (TBL 601)
STRUCTURAL FRAME = 0 HRS.
BEARING WALLS (INTERIOR AND EXTERIOR) = 0 HRS.
NON-BEARING WALLS = 0 HRS.
FLOOR CONSTRUCTION = 0 HRS.
ROOF CONSTRUCTION = 0 HRS.

FIRE RESISTANCE RATING REQUIREMENTS FOR EXTERIOR WALLS: (TBL 602)
EXTERIOR WALLS WITH \geq 30' FIRE SEPARATION DISTANCE = 0 HRS.
EXTERIOR WALLS WITH < 30' FIRE SEPARATION DISTANCE = 1 HR.

MAX. AREA OF EXTERIOR WALL OPENINGS: (TBL 705.8)
BLDG. WITH \geq 30' FIRE SEPARATION DISTANCE ALLOWED UNLIMITED PROTECTED AND UNPROTECTED OPENINGS

AUTOMATIC SPRINKLER SYSTEM REQUIREMENTS: (SEC 903)
THIS BLDG. DOES REQUIRE NOT AN AUTOMATIC SPRINKLER SYSTEM.

FIRE PROTECTION SYSTEM REQUIREMENTS: (SEC 907)
THIS BLDG. SHALL BE NOT REQUIRED TO HAVE AN APPROVED FIRE PROTECTION SYSTEM IN ACCORDANCE WITH SEC 907.2.2.

CONSTRUCTION DOCUMENTS: (SEC 1603)
THIS BLDG. SHALL BE DESIGNED IN ACCORDANCE WITH IBC SECTION 1609 AS A FULLY ENCLOSED BLDG. USING THE FOLLOWING INFORMATION:
WIND DESIGN DATA:
DETERMINATION OF WIND LOADS SHALL BE IN ACCORDANCE WITH IBC SEC 1609.4
BASIC WIND SPEED (3 SECOND GUSTS) = 130 MPH (FIG 1609)
IMPORTANCE FACTOR: CATEGORY II BLDG., IF = 1.00, IS = 1.0, IW = 1.00 (TBL 1604.5)
EXPOSURE B
DESIGN WIND PRESSURE (ASCE 7-05 FIG. 6-2): 33.6 PSF
INTERNAL PRESSURE COEFFICIENT (ASCE 7-05 FIG. 6-5): \pm 0.18
LIVE LOADS: (SEC 1607)
OFFICE (TBL 1607.1): 50 PSF
ROOF LIVE LOAD (TBL 1607.1) = 20 PSF UNIFORM, 300 LB. CONCENTRATED
GROUND SNOW LOAD (FIG. 1608.2) = 5 PSF

NATIONAL FIRE PROTECTION ASSOCIATION 2009 SUMMARY

BUILDING AREA:
TOTAL BUILDING AREA = 11,000 SQ.FT.
AREA TO BE RENOVATED = 1375 SQ.FT.

OCCUPANCY CLASSIFICATION:
EXISTING GROUP B (BUSINESS)

OCCUPANT LOAD: (TBL 7.3.1.2)
BUSINESS = 100 GROSS SQ.FT. / OCCUPANT = 1,375 / 100 = 14,00 OCCUPANTS

SPRINKLER SYSTEM: (SEC 39.2.5)
THIS BUILDING SHALL NOT BE REQUIRED TO HAVE AN AUTOMATIC SPRINKLER SYSTEM AT THIS TIME.

FIRE ALARM SYSTEM: (SEC 39.3.4.1)
A FIRE ALARM SYSTEM IS NOT REQUIRED.

EXIT ACCESS:
EXIT REQUIRED (SEC 39.2.4.1)
EXIT PROVIDED

ALLOWABLE EXIT ACCESS TRAVEL DISTANCE = 200' (SEC 39.2.6.2)
LONGEST EGRESS PATH IN AREA OF WORK = 50'

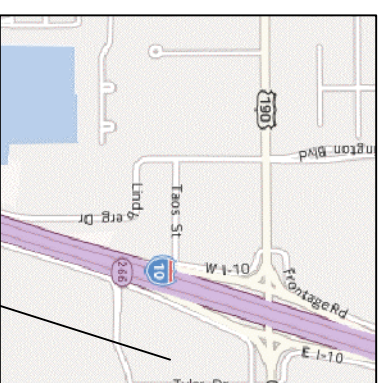

AREA OF WORK

VICINITY MAP
N.T.S.

INDEX OF DRAWINGS		
SHT#	DWG#	DRAWING NAME
1		COVERSHEET
2	A-1	FLOOR PLAN & REFLECTED CEILING PLAN
3	M-1	MECHANICAL PLAN
4	E-1	POWER AND LIGHTING PLAN

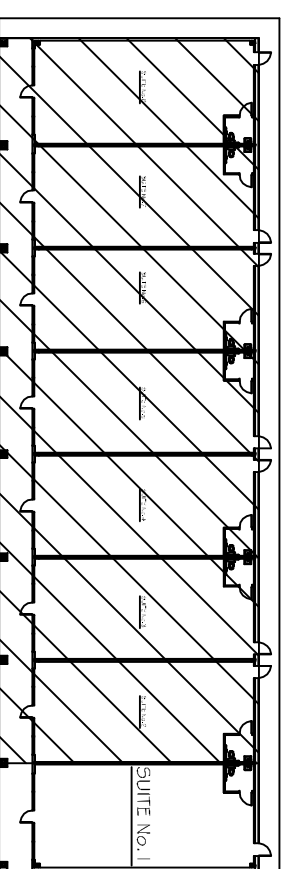

KEY PLAN
N.T.S.

CHIEF ENGINEER: EMMETT DAMMON, P.E.
CHIEF ARCHITECT: ROBERT WILTSE
554 OLD SFAWISH TRAIL
SLIDELL, LA 70458

www.dammonengr.com
dammoneng@bellsouth.net
PHONE: 985-649-5832
FAX: 985-641-5950

DAMMON
ENGINEERING, INC.
Architects & Engineers

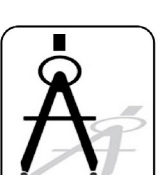

The above drawings and specifications, designs and arrangements represent the work of Dammon Engineering, Inc. and shall remain the property of Dammon Engineering, Inc. and no part thereof shall be copied, reproduced, or used in connection with any other project without the specific consent of Dammon Engineering, Inc. and no part thereof shall be used in connection with any other project without the specific consent of Dammon Engineering, Inc. and no part thereof shall be used in connection with any other project without the specific consent of Dammon Engineering, Inc. and no part thereof shall be used in connection with any other project without the specific consent of Dammon Engineering, Inc.

JOB No: 2152 DATE: 10/03/2012
DRAWN BY: BSN CHECKED BY: BSN

DUDLEY SMITH
PRINTING
TYLER SQUARE
58465 TYLER STREET SUITE #1
SLIDELL, LA

SHEET No: 1 OF 4