

**FX4C, FC4D**  
**Comfort™ Series Fan Coil**  
**Sizes 018 thru 060**



Turn to the Experts.™

## Product Data



### **AIR HANDLER TECHNOLOGY AT ITS FINEST**

The FX4C and FC4D fan coils combine the proven technology of Carrier fan coil units with either Puron®, the environmentally sound refrigerant, or R-22 refrigerant. Both fan coils are loaded with popular features. Factory-installed, refrigerant-specific thermostatic expansion valves (TXV) are standard with these fan coil designs. The designs feature contoured condensate pans with rugged, brass drain connections, ensuring that little water is left in the unit at the end of the cooling duty cycle. The lack of standing condensate and corrosion free pans improves IAQ and product life, features homeowners appreciate.

Standard features for both include grooved copper tubing and louvered aluminum fins. The large face areas of the refrigerant coils provide superior efficiency for high SEER and HSPF performance. Coil circuiting has also been updated to make the most of all Carrier heat pumps and air conditioners. Also units come with solid state fan controls, 1-inch thick insulation with R value of 4.2, super-quiet multi-speed motors, and fully-wettable coils. Units can accommodate factory- and/or field-installed heaters from 3 to 30 kW.

It also should be noted that the unique cabinet design of these fan coils meet new stringent regulations for cabinet air leakage - a requirement of 2% cabinet leakage rate when tested at 1.0 inches of static pressure.

The FX4C fan coil is the Puron® refrigeration design loaded with popular features. It comes in a pre-painted (taupe metallic) galvanized steel casing and is shipped with a cleanable, permanent framed filter, and a factory-supplied power plug. The units have full range of X13, high efficiency blower motors and are available in sizes 018 through 060.

The FC4D fan coil comes with the same features as the FX4C, but for use with R-22 refrigerant, also available in sizes 018 through 060.

## **STANDARD FEATURES**

- Super-high efficiency X13 motors - all sizes
- Simple control board with blower-off delay and internal thermostat wire junction box
- Large, grooved tube, louvered fin coils
- Dedicated refrigerant circuits
- Efficient, quiet, time-tested blower housings and diffusers
- Sturdy, drainable condensate pans
- Cabinet construction features innovations designed to prevent cabinet sweating
- Brass drain connections
- Tested for condensate disposal in much tougher conditions than Air Conditioning and Refrigeration Institute requirements
- Super-thick R-4.2 insulation with vapor barrier
- Pre-painted galvanized steel cabinet (taupe metallic)
- Cabinet design meets stringent regulations for 2% cabinet leakage rate when tested at 1.0 inches static pressure
- Installation-flexible, multipoise units
- Horizontal hanging provisions on cabinet
- No tools required to service filter
- Factory-supplied, cleanable and reusable filter
- Newly improved filter rack area filter door insulation added for improved air seal
- Factory-installed heater packages available (5- through 15-kW)
- 3- through 30-kW accessory heaters - field installed
- Factory-supplied power plug
- Easy plug-in provisions for heater installation
- Entry options for high and low voltage wiring hook-up
- Simple, 5-amp blade fuse (and a spare) to protect 40 VA transformer
- Easy coil inspection (removable, snap-in plug on A-coil models)
- Leak-preventing sweat connections

## **ADDITIONAL FEATURES**

### **FX4C**

- Puron®, environmentally sound refrigerant
- Factory-installed Puron® refrigerant thermostatic expansion valves (TXV)
- Factory-installed heater packages available

### **FC4D**

- R-22 refrigerant
- Factory-installed R-22 thermostatic expansion valves (TXV)
- Factory-installed heater packages available

# MODEL NUMBER NOMENCLATURE

## CARRIER FAN COILS

| 1            | 2  | 3              | 4      | 5                         | 6                               | 7-9  | 10-12   |
|--------------|--|----------------|--------|---------------------------|---------------------------------|--|---|
| F            | X  | 4              | C      | N                         | F                               | 018  | 000   |
| Product      | Type                                       | Position       | Series | Electrical                | Cabinet/<br>Insulation          | Capacity   | Heating<br>Size   |
| F = Fan Coil | X = Comfort™, Puron®<br>C = Comfort™, R-22 | 4 = Multipoise |        | N = 208/230v,<br>1ph-60hz | B = Modular<br>F = Single piece | 018 = 18,000<br>024 = 24,000<br>030 = 30,000<br>036 = 36,000<br>042 = 42,000<br>048 = 48,000<br>060 = 60,000 | 000 = No Heat<br>005 = 5kW<br>075 = 7.5kW<br>008 = 8 kW<br>010 = 10kW<br>011 = 11kW<br>015 = 15kW |



CERTIFICATION APPLIES ONLY WHEN THE COMPLETE SYSTEM IS LISTED WITH ARI

FX4C / FC4D



## SLOPE COIL

NOTES:  
1. CONDENSATE PAN DRAIN CAPS NOT SHOWN FOR CLARITY.

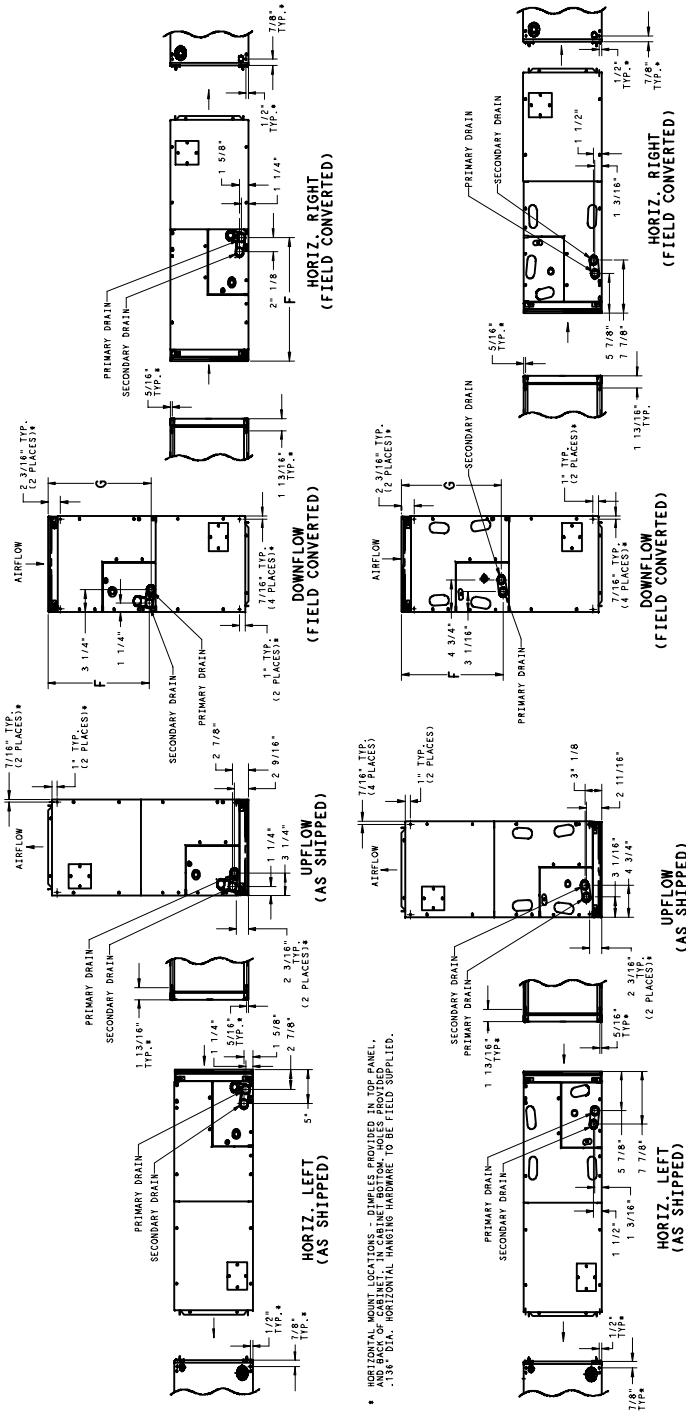

\* HORIZONTAL MOUNT LOCATIONS - DIMPLES PROVIDED IN TOP PANEL AND BACK OF CABINET. IN CABINET BOTTOM HOLES PROVIDED. .134" DIA. HORIZONTAL HANGING HARDWARE TO BE FIELD SUPPLIED.

## A-COIL

A05356

## DIMENSIONS (CONT.)

| UNIT SIZE<br>FX, FC | COIL TYPE |       | F        |       | G        |       |
|---------------------|-----------|-------|----------|-------|----------|-------|
|                     | IN.       | MM    | IN.      | MM    | IN.      | MM    |
| 018*                | Slope     | 460.4 | 18-1/8   | 460.4 | 18-5/8   | 473.1 |
| 024*                | Slope     | 587.4 | 23-1/8   | 587.4 | 23-5/8   | 600.0 |
| 030*                | Slope     | 587.4 | 23-1/8   | 587.4 | 23-5/8   | 600.0 |
| 036*                | Slope     | 684.2 | 26-15/16 | 684.2 | 27-1/2   | 698.5 |
| 042*                | A         | 593.3 | 23-7/16  | 593.3 | 23-1/8   | 587.4 |
| 048*                | A         | 692.2 | 27-1/4   | 692.2 | 26-15/16 | 684.2 |
| 060*                | A         | 836.6 | 32-15/16 | 836.6 | 32-5/8   | 828.7 |
| 036†                | A         | 684.2 | 26-15/16 | 684.2 | 27-1/2   | 698.5 |
| 042†                | A         | 692.2 | 27-1/4   | 692.2 | 26-15/16 | 684.2 |
| 048†                | A         | 692.2 | 27-1/4   | 692.2 | 26-15/16 | 684.2 |
| 060†                | A         | 836.6 | 32-15/16 | 836.6 | 32-5/8   | 828.7 |

\* Single piece cabinet

† Modular cabinet

FX4C / FC4D

## PHYSICAL DATA

| ODS CATALOG ORDERING NO. | FACTORY INSTALLED HEAT (KW) | NOMINAL COOLING CAPACITY (BTUH) | DIMENSIONS   |             |             | SHIPPING WEIGHT (LBS.) |
|--------------------------|-----------------------------|---------------------------------|--------------|-------------|-------------|------------------------|
|                          |                             |                                 | Height (In.) | Width (In.) | Depth (In.) |                        |
| FX4CNF018000             | –                           | 18,000                          | 42–11/16     | 14–5/16     | 22–1/16     | 100                    |
| FX4CNF018005             | 5                           |                                 |              |             |             |                        |
| FX4CNF024000             | –                           | 24,000                          | 47–11/16     | 17–5/8      | 22–1/16     | 117                    |
| FX4CNF024005             | 5                           |                                 |              |             |             |                        |
| FX4CNF030000             | –                           | 30,000                          | 49–5/8       | 17–5/8      | 22–1/16     | 122                    |
| FX4CNF030008             | 8                           |                                 |              |             |             |                        |
| FX4CNF036000             | –                           | 36,000                          | 53–7/16      | 21–1/8      | 22–1/16     | 144                    |
| FX4CNF036010             | 10                          |                                 |              |             |             |                        |
| FX4CNF042000             | –                           | 42,000                          | 49–5/8       | 21–1/8      | 22–1/16     | 150                    |
| FX4CNF042010             | 10                          |                                 |              |             |             |                        |
| FX4CNF048000             | –                           | 48,000                          | 53–7/16      | 21–1/8      | 22–1/16     | 170                    |
| FX4CNF048010             | 10                          |                                 |              |             |             |                        |
| FX4CNF060000             | –                           | 60,000                          | 59–3/16      | 24–11/16    | 22–1/16     | 198                    |
| FX4CNF060010             | 10                          |                                 |              |             |             |                        |
| FX4CNF060015             | 15                          |                                 |              |             |             |                        |
| FX4CNB036000             | –                           | 36,000                          | 53–7/16      | 21–1/8      | 22–1/16     | 144                    |
| FX4CNB042000             | –                           | 42,000                          | 53–7/16      | 21–1/8      | 22–1/16     | 170                    |
| FX4CNB048000             | –                           | 48,000                          | 53–7/16      | 21–1/8      | 22–1/16     | 170                    |
| FX4CNB060000             | –                           | 60,000                          | 59–3/16      | 24–11/16    | 22–1/16     | 198                    |

6th digit: B – Modular cabinet  
F – Single piece cabinet

| ODS CATALOG ORDERING NO. | FACTORY INSTALLED HEAT (KW) | NOMINAL COOLING CAPACITY (BTUH) | DIMENSIONS   |             |             | SHIPPING WEIGHT (LBS.) |
|--------------------------|-----------------------------|---------------------------------|--------------|-------------|-------------|------------------------|
|                          |                             |                                 | Height (In.) | Width (In.) | Depth (In.) |                        |
| FC4DNF018000             | –                           | 18,000                          | 42–11/16     | 14–5/16     | 22–1/16     | 100                    |
| FC4DNF018005             | 5                           |                                 |              |             |             |                        |
| FC4DNF024000             | –                           | 24,000                          | 47–11/16     | 17–5/8      | 22–1/16     | 117                    |
| FC4DNF024005             | 5                           |                                 |              |             |             |                        |
| FC4DNF030000             | –                           | 30,000                          | 49–5/8       | 17–5/8      | 22–1/16     | 122                    |
| FC4DNF030008             | 8                           |                                 |              |             |             |                        |
| FC4DNF036000             | –                           | 36,000                          | 53–7/16      | 21–1/8      | 22–1/16     | 144                    |
| FC4DNF036008             | 8                           |                                 |              |             |             |                        |
| FC4DNF036010             | 10                          |                                 |              |             |             |                        |
| FC4DNF042000             | –                           | 42,000                          | 49–5/8       | 21–1/8      | 22–1/16     | 150                    |
| FC4DNF042010             | 10                          |                                 |              |             |             |                        |
| FC4DNF042015             | 15                          |                                 |              |             |             |                        |
| FC4DNF048000             | –                           | 48,000                          | 53–7/16      | 21–1/8      | 22–1/16     | 170                    |
| FC4DNF048010             | 10                          |                                 |              |             |             |                        |
| FC4DNF048015             | 15                          |                                 |              |             |             |                        |
| FC4DNF060000             | –                           | 60,000                          | 59–3/16      | 24–11/16    | 22–1/16     | 198                    |
| FC4DNF060010             | 10                          |                                 |              |             |             |                        |
| FC4DNF060015             | 15                          |                                 |              |             |             |                        |
| FC4DNB036000             | –                           | 36,000                          | 53–7/16      | 21–1/8      | 22–1/16     | 144                    |
| FC4DNB042000             | –                           | 42,000                          | 53–7/16      | 21–1/8      | 22–1/16     | 170                    |
| FC4DNB048000             | –                           | 48,000                          | 53–7/16      | 21–1/8      | 22–1/16     | 170                    |
| FC4DNB060000             | –                           | 60,000                          | 59–3/16      | 24–11/16    | 22–1/16     | 198                    |

6th digit: B – Modular cabinet  
F – Single piece cabinet

FX4C / FC4D

# SPECIFICATIONS

| MODEL FX4C                           | 018  | 024     | 030     | 036                | 042                | 048                | 060                |
|--------------------------------------|--|---------|---------|--------------------|--------------------|--------------------|--------------------|
| <b>COIL</b>                          |  |         |         |                    |                    |                    |                    |
| Puron® Refrigerant Metering Device   | TXV – factory installed hard–shutoff, bi–flow type for heat pump application |         |         |                    |                    |                    |                    |
| TXV                                  | 2 ton  |         | 3 ton   |                    |                    | 4 ton              |                    |
| Rows/Fins Per In.                    | 3 / 14.5   |         |         |                    |                    |                    |                    |
| Face Area (Sq. Ft.)                  | 2.23   | 2.97    |         | 3.46               | 4.45               | 5.93               | 7.42               |
| Configuration                        | Slope  |         |         |                    | A                  |                    |                    |
| <b>FAN</b>                           |  |         |         |                    |                    |                    |                    |
| CFM (Nominal)                        | 600  | 800     | 1000    | 1200               | 1400               | 1600               | 2000               |
| Motor Type                           | X13  | X13     | X13     | X13                | X13                | X13                | X13                |
| Motor Hp                             | 1/3  | 1/3     | 1/3     | 1/2                | 1/2                | 3/4                | 3/4                |
| Filter (In.)                         | 21–1/2 x 13  | 16–3/8  |         | 19–7/8             |                    |                    | 23–5/16            |
| <b>CABINET CONFIGURATION OPTIONS</b> |  |         |         |                    |                    |                    |                    |
|                                      | 1–piece  | 1–piece | 1–piece | 1–piece or Modular | 1–piece or Modular | 1–piece or Modular | 1–piece or Modular |

| MODEL FC4D                           | 018  | 024     | 030     | 036                | 042                | 048                | 060                |
|--------------------------------------|--|---------|---------|--------------------|--------------------|--------------------|--------------------|
| <b>COIL</b>                          |  |         |         |                    |                    |                    |                    |
| R–22 Refrigerant Metering Device     | TXV – factory installed hard–shutoff, bi–flow type for heat pump application |         |         |                    |                    |                    |                    |
| TXV                                  | 3 ton  |         |         | 5 ton              |                    | 6 ton              |                    |
| Rows/Fins Per In.                    | 3 / 14.5   |         |         |                    |                    |                    |                    |
| Face Area (Sq. Ft.)                  | 2.23   | 2.97    |         | 3.46               | 4.45               | 5.93               | 7.42               |
| Configuration                        | Slope  |         |         |                    | A                  |                    |                    |
| <b>FAN</b>                           |  |         |         |                    |                    |                    |                    |
| CFM (Nominal)                        | 600  | 800     | 1000    | 1200               | 1400               | 1600               | 2000               |
| Motor Type                           | X13  | X13     | X13     | X13                | X13                | X13                | X13                |
| Motor Hp                             | 1/3  | 1/3     | 1/3     | 1/2                | 1/2                | 3/4                | 3/4                |
| FILTER (In.)                         | 21–1/2 x 13  | 16–3/8  |         | 19–7/8             |                    |                    | 23–5/16            |
| <b>CABINET CONFIGURATION OPTIONS</b> |  |         |         |                    |                    |                    |                    |
|                                      | 1–piece  | 1–piece | 1–piece | 1–piece or Modular | 1–piece or Modular | 1–piece or Modular | 1–piece or Modular |

FX4C / FC4D

## PERFORMANCE DATA

### AIRFLOW PERFORMANCE (CFM)

| MODEL & SIZE      | BLOWER SPEED | TOTAL EXTERNAL STATIC PRESSURE |      |      |      |      |      |
|-------------------|--------------|--------------------------------|------|------|------|------|------|
|                   |              | 0.10                           | 0.20 | 0.30 | 0.40 | 0.50 | 0.60 |
| FX4C, FC4D<br>018 | High         | 766                            | 739  | 706  | 666  | 619  | 566  |
|                   | Medium       | 701                            | 659  | 619  | 578  | 538  | 499  |
|                   | Low          | 614                            | 572  | 530  | 486  | 441  | 396  |
| FX4C, FC4D<br>024 | High         | 941                            | 905  | 868  | 830  | 792  | 753  |
|                   | Medium       | 823                            | 786  | 747  | 707  | 665  | 622  |
|                   | Low          | 633                            | 583  | 533  | 482  | 431  | 378  |
| FX4C, FC4D<br>030 | High         | 1130                           | 1097 | 1063 | 1028 | 992  | 955  |
|                   | Medium       | 1033                           | 1000 | 965  | 928  | 888  | 846  |
|                   | Low          | 840                            | 802  | 760  | 713  | 663  | 609  |
| FX4C, FC4D<br>036 | High         | 1437                           | 1398 | 1354 | 1308 | 1257 | 1204 |
|                   | Medium       | 1282                           | 1238 | 1192 | 1142 | 1090 | 1036 |
|                   | Low          | 1168                           | 1118 | 1067 | 1014 | 959  | 903  |
| FX4C, FC4D<br>042 | High         | 1616                           | 1578 | 1533 | 1480 | 1420 | 1353 |
|                   | Medium       | 1479                           | 1437 | 1392 | 1344 | 1293 | 1240 |
|                   | Low          | 1303                           | 1258 | 1211 | 1161 | 1108 | 1054 |
| FX4C, FC4D<br>048 | High         | 1805                           | 1772 | 1739 | 1704 | 1669 | 1632 |
|                   | Medium       | 1652                           | 1617 | 1581 | 1543 | 1504 | 1463 |
|                   | Low          | 1458                           | 1418 | 1377 | 1335 | 1292 | 1248 |
| FX4C, FC4D<br>060 | High         | 2057                           | 2024 | 1989 | 1954 | 1916 | 1878 |
|                   | Medium       | 1799                           | 1766 | 1731 | 1695 | 1658 | 1618 |
|                   | Low          | 1667                           | 1633 | 1596 | 1558 | 1517 | 1475 |

**NOTES:**

- Airflow based upon dry coil at 230v with factory–approved filter and electric heater (2 element heater sizes 018 through 036, 3 element heater sizes 042 through 060).
- To avoid potential for condensate blowing out of drain pan prior to making drain trap:  
Return static pressure must be less than 0.40 in. wc.  
Horizontal applications of 042 – 060 sizes must have supply static greater than 0.20 in. wc.
- Shading – Airflow outside 450 cfm/ton.
- Airflow above 400 cfm/ton on 048–060 size could result in condensate blowing off coil or splashing out of drain pan.

**PERFORMANCE DATA (CONT)**

**GROSS COOLING CAPACITIES (mbh) - Puron® Refrigerant**

**FX4C / FC4D**

| UNIT SIZE | INDOOR COIL AIR |     | SATURATED TEMPERATURE LEAVING EVAPORATOR (°F) |     |      |     |     |      |     |     |      |    |     |      |    |     |      |
|-----------|-----------------|-----|---|-----|------|-----|-----|------|-----|-----|------|----|-----|------|----|-----|------|
|           |                 |     | 35  |     |      | 40  |     |      | 45  |     |      | 50 |     |      | 55 |     |      |
|           | CFM             | EWB | TC  | SHC | BF   | TC  | SHC | BF   | TC  | SHC | BF   | TC | SHC | BF   | TC | SHC | BF   |
| FX4C 018  | 525             | 72  | 40  | 20  | 0.00 | 36  | 18  | 0.00 | 32  | 16  | 0.00 | 27 | 14  | 0.02 | 21 | 11  | 0.02 |
|           |                 | 67  | 33  | 20  | 0.02 | 29  | 18  | 0.02 | 24  | 16  | 0.03 | 20 | 14  | 0.03 | 14 | 12  | 0.03 |
|           |                 | 62  | 26  | 21  | 0.03 | 22  | 18  | 0.03 | 18  | 16  | 0.03 | 14 | 14  | 0.08 | 12 | 12  | 0.22 |
|           | 600             | 72  | 44  | 22  | 0.00 | 40  | 20  | 0.00 | 35  | 17  | 0.01 | 30 | 15  | 0.02 | 24 | 13  | 0.03 |
|           |                 | 67  | 36  | 22  | 0.03 | 32  | 20  | 0.03 | 27  | 18  | 0.03 | 22 | 15  | 0.04 | 16 | 13  | 0.04 |
|           |                 | 62  | 29  | 23  | 0.04 | 25  | 21  | 0.04 | 20  | 18  | 0.04 | 16 | 16  | 0.10 | 13 | 13  | 0.24 |
|           | 675             | 72  | 48  | 24  | 0.00 | 43  | 22  | 0.00 | 38  | 19  | 0.02 | 32 | 17  | 0.03 | 26 | 14  | 0.04 |
|           |                 | 67  | 40  | 25  | 0.04 | 35  | 22  | 0.04 | 29  | 20  | 0.04 | 24 | 17  | 0.04 | 17 | 14  | 0.05 |
|           |                 | 62  | 32  | 25  | 0.05 | 27  | 23  | 0.05 | 22  | 20  | 0.05 | 17 | 17  | 0.11 | 15 | 15  | 0.26 |
| FX4C 024  | 700             | 72  | 51  | 25  | 0.00 | 46  | 23  | 0.00 | 40  | 20  | 0.02 | 34 | 17  | 0.03 | 27 | 15  | 0.03 |
|           |                 | 67  | 42  | 26  | 0.04 | 37  | 23  | 0.04 | 31  | 20  | 0.04 | 25 | 18  | 0.04 | 18 | 15  | 0.04 |
|           |                 | 62  | 34  | 26  | 0.04 | 28  | 24  | 0.04 | 23  | 21  | 0.05 | 18 | 18  | 0.10 | 15 | 15  | 0.25 |
|           | 800             | 72  | 56  | 28  | 0.00 | 51  | 25  | 0.00 | 44  | 22  | 0.03 | 37 | 19  | 0.04 | 30 | 16  | 0.05 |
|           |                 | 67  | 46  | 29  | 0.05 | 40  | 26  | 0.05 | 34  | 23  | 0.05 | 27 | 20  | 0.05 | 20 | 17  | 0.06 |
|           |                 | 62  | 37  | 29  | 0.06 | 31  | 26  | 0.06 | 25  | 23  | 0.06 | 20 | 20  | 0.13 | 17 | 17  | 0.27 |
|           | 900             | 72  | 61  | 30  | 0.00 | 55  | 27  | 0.01 | 48  | 24  | 0.04 | 40 | 21  | 0.05 | 32 | 18  | 0.06 |
|           |                 | 67  | 50  | 31  | 0.06 | 44  | 28  | 0.06 | 37  | 25  | 0.06 | 29 | 21  | 0.06 | 21 | 18  | 0.07 |
|           |                 | 62  | 40  | 32  | 0.07 | 34  | 29  | 0.07 | 27  | 25  | 0.07 | 22 | 22  | 0.15 | 18 | 18  | 0.29 |
| FX4C 030  | 875             | 72  | 61  | 30  | 0.01 | 55  | 27  | 0.00 | 48  | 24  | 0.02 | 41 | 21  | 0.03 | 33 | 18  | 0.03 |
|           |                 | 67  | 50  | 31  | 0.04 | 44  | 28  | 0.04 | 37  | 25  | 0.04 | 30 | 21  | 0.04 | 22 | 18  | 0.05 |
|           |                 | 62  | 41  | 32  | 0.04 | 34  | 29  | 0.04 | 28  | 25  | 0.05 | 22 | 22  | 0.11 | 18 | 18  | 0.25 |
|           | 1000            | 72  | 68  | 33  | 0.00 | 61  | 30  | 0.00 | 53  | 27  | 0.03 | 45 | 23  | 0.04 | 36 | 19  | 0.05 |
|           |                 | 67  | 56  | 34  | 0.05 | 49  | 31  | 0.05 | 41  | 27  | 0.05 | 33 | 24  | 0.05 | 24 | 20  | 0.06 |
|           |                 | 62  | 45  | 35  | 0.06 | 38  | 32  | 0.06 | 30  | 28  | 0.06 | 24 | 24  | 0.13 | 20 | 20  | 0.27 |
|           | 1125            | 72  | 73  | 36  | 0.00 | 66  | 33  | 0.02 | 58  | 29  | 0.04 | 48 | 25  | 0.05 | 39 | 21  | 0.06 |
|           |                 | 67  | 60  | 38  | 0.06 | 53  | 34  | 0.06 | 45  | 30  | 0.06 | 36 | 26  | 0.06 | 26 | 22  | 0.07 |
|           |                 | 62  | 49  | 39  | 0.07 | 41  | 35  | 0.07 | 33  | 31  | 0.08 | 27 | 27  | 0.16 | 23 | 23  | 0.29 |
| FX4C 036  | 1050            | 72  | 79  | 39  | 0.00 | 71  | 35  | 0.00 | 62  | 31  | 0.02 | 52 | 27  | 0.03 | 42 | 23  | 0.04 |
|           |                 | 67  | 65  | 40  | 0.04 | 57  | 36  | 0.04 | 48  | 32  | 0.04 | 38 | 28  | 0.04 | 28 | 23  | 0.05 |
|           |                 | 62  | 52  | 41  | 0.05 | 44  | 37  | 0.05 | 36  | 33  | 0.05 | 28 | 28  | 0.11 | 24 | 24  | 0.26 |
|           | 1200            | 72  | 87  | 43  | 0.00 | 78  | 39  | 0.00 | 68  | 34  | 0.03 | 57 | 30  | 0.04 | 46 | 25  | 0.05 |
|           |                 | 67  | 72  | 44  | 0.05 | 63  | 40  | 0.05 | 53  | 35  | 0.06 | 42 | 31  | 0.06 | 31 | 26  | 0.06 |
|           |                 | 62  | 58  | 46  | 0.06 | 49  | 41  | 0.06 | 39  | 36  | 0.07 | 31 | 31  | 0.14 | 26 | 26  | 0.28 |
|           | 1350            | 72  | 95  | 47  | 0.00 | 85  | 42  | 0.02 | 74  | 37  | 0.05 | 62 | 32  | 0.06 | 50 | 28  | 0.06 |
|           |                 | 67  | 78  | 49  | 0.06 | 68  | 44  | 0.06 | 57  | 39  | 0.07 | 46 | 34  | 0.07 | 33 | 29  | 0.07 |
|           |                 | 62  | 63  | 50  | 0.07 | 53  | 45  | 0.07 | 43  | 40  | 0.08 | 35 | 35  | 0.16 | 29 | 29  | 0.30 |
| FX4C 042  | 1225            | 72  | 93  | 46  | 0.00 | 83  | 41  | 0.00 | 73  | 37  | 0.01 | 62 | 32  | 0.03 | 49 | 27  | 0.03 |
|           |                 | 67  | 76  | 47  | 0.03 | 67  | 42  | 0.03 | 57  | 37  | 0.04 | 45 | 32  | 0.04 | 33 | 27  | 0.04 |
|           |                 | 62  | 61  | 48  | 0.04 | 52  | 43  | 0.04 | 42  | 38  | 0.04 | 33 | 33  | 0.10 | 28 | 28  | 0.24 |
|           | 1400            | 72  | 102   | 51  | 0.00 | 92  | 46  | 0.00 | 80  | 40  | 0.02 | 68 | 35  | 0.04 | 54 | 30  | 0.04 |
|           |                 | 67  | 84  | 52  | 0.04 | 74  | 47  | 0.04 | 62  | 42  | 0.05 | 50 | 36  | 0.05 | 36 | 31  | 0.05 |
|           |                 | 62  | 68  | 53  | 0.05 | 57  | 48  | 0.05 | 46  | 43  | 0.06 | 37 | 37  | 0.12 | 31 | 31  | 0.26 |
|           | 1575            | 72  | 111   | 55  | 0.00 | 100 | 50  | 0.01 | 87  | 44  | 0.04 | 74 | 38  | 0.05 | 59 | 32  | 0.05 |
|           |                 | 67  | 92  | 57  | 0.05 | 80  | 51  | 0.06 | 68  | 46  | 0.06 | 54 | 40  | 0.06 | 39 | 34  | 0.06 |
|           |                 | 62  | 74  | 59  | 0.06 | 62  | 53  | 0.06 | 50  | 47  | 0.07 | 41 | 41  | 0.14 | 34 | 34  | 0.28 |
| FX4C 048  | 1400            | 72  | 109   | 54  | 0.00 | 98  | 49  | 0.00 | 86  | 43  | 0.00 | 73 | 37  | 0.02 | 58 | 31  | 0.02 |
|           |                 | 67  | 90  | 55  | 0.02 | 79  | 49  | 0.02 | 67  | 44  | 0.03 | 53 | 38  | 0.03 | 39 | 32  | 0.03 |
|           |                 | 62  | 72  | 56  | 0.03 | 61  | 50  | 0.03 | 49  | 44  | 0.03 | 38 | 38  | 0.08 | 32 | 32  | 0.22 |
|           | 1600            | 72  | 121   | 60  | 0.00 | 109 | 54  | 0.00 | 95  | 48  | 0.01 | 81 | 41  | 0.02 | 65 | 35  | 0.03 |
|           |                 | 67  | 100   | 61  | 0.03 | 87  | 55  | 0.03 | 74  | 49  | 0.03 | 59 | 42  | 0.04 | 43 | 36  | 0.04 |
|           |                 | 62  | 80  | 63  | 0.04 | 68  | 56  | 0.04 | 55  | 50  | 0.04 | 43 | 43  | 0.10 | 36 | 36  | 0.24 |
|           | 1800            | 72  | 132   | 65  | 0.00 | 119 | 59  | 0.00 | 104 | 52  | 0.02 | 88 | 45  | 0.03 | 70 | 38  | 0.04 |
|           |                 | 67  | 109   | 67  | 0.04 | 95  | 61  | 0.04 | 81  | 54  | 0.04 | 64 | 47  | 0.04 | 47 | 39  | 0.05 |
|           |                 | 62  | 88  | 69  | 0.05 | 74  | 62  | 0.05 | 60  | 55  | 0.05 | 48 | 48  | 0.11 | 40 | 40  | 0.26 |

**PERFORMANCE DATA (CONT)**

**GROSS COOLING CAPACITIES (mbh) - Puron® Refrigerant**

| UNIT SIZE | INDOOR COIL AIR |     | SATURATED TEMPERATURE LEAVING EVAPORATOR (°F) |     |      |     |     |      |     |     |      |     |     |      |    |     |      |
|-----------|-----------------|-----|---|-----|------|-----|-----|------|-----|-----|------|-----|-----|------|----|-----|------|
|           |                 |     | 35  |     |      | 40  |     |      | 45  |     |      | 50  |     |      | 55 |     |      |
|           | CFM             | EWB | TC  | SHC | BF   | TC  | SHC | BF   | TC  | SHC | BF   | TC  | SHC | BF   | TC | SHC | BF   |
| FX4C 060  | 1600            | 72  | 132   | 65  | 0.00 | 119 | 59  | 0.00 | 104 | 52  | 0.00 | 89  | 45  | 0.01 | 71 | 38  | 0.02 |
|           |                 | 67  | 108   | 67  | 0.02 | 95  | 60  | 0.02 | 81  | 53  | 0.02 | 65  | 46  | 0.02 | 48 | 39  | 0.02 |
|           |                 | 62  | 87  | 68  | 0.02 | 74  | 61  | 0.02 | 60  | 54  | 0.03 | 47  | 47  | 0.06 | 39 | 39  | 0.21 |
|           | 1750            | 72  | 141   | 70  | 0.00 | 127 | 63  | 0.00 | 112 | 56  | 0.00 | 95  | 48  | 0.02 | 76 | 41  | 0.02 |
|           |                 | 67  | 116   | 72  | 0.02 | 102 | 64  | 0.02 | 87  | 57  | 0.03 | 70  | 49  | 0.03 | 51 | 42  | 0.03 |
|           |                 | 62  | 94  | 73  | 0.03 | 80  | 66  | 0.03 | 64  | 58  | 0.03 | 50  | 50  | 0.08 | 42 | 42  | 0.22 |
|           | 2000            | 72  | 156   | 77  | 0.01 | 141 | 70  | 0.00 | 124 | 62  | 0.01 | 105 | 54  | 0.02 | 84 | 46  | 0.03 |
|           |                 | 67  | 129   | 80  | 0.03 | 113 | 72  | 0.03 | 96  | 64  | 0.03 | 77  | 55  | 0.04 | 57 | 47  | 0.04 |
|           |                 | 62  | 104   | 82  | 0.04 | 88  | 73  | 0.04 | 71  | 65  | 0.04 | 57  | 57  | 0.10 | 48 | 48  | 0.24 |

**GROSS COOLING CAPACITIES (MBH) - R-22 Refrigerant**

| UNIT SIZE | INDOOR COIL AIR |     | SATURATED TEMPERATURE LEAVING EVAPORATOR (°F) |      |      |    |      |      |    |      |      |    |      |      |    |      |      |
|-----------|-----------------|-----|---|------|------|----|------|------|----|------|------|----|------|------|----|------|------|
|           |                 |     | 35  |      |      | 40 |      |      | 45 |      |      | 50 |      |      | 55 |      |      |
|           | CFM             | EWB | TC  | SHC  | BF   | TC | SHC  | BF   | TC | SHC  | BF   | TC | SHC  | BF   | TC | SHC  | BF   |
| FC4D 018  | 525             | 72  | 38  | 19   | 0.00 | 35 | 17   | 0.00 | 30 | 15   | 0.01 | 26 | 13   | 0.02 | 21 | 11   | 0.02 |
|           |                 | 67  | 32  | 20   | 0.02 | 28 | 18   | 0.02 | 24 | 16   | 0.03 | 19 | 14   | 0.03 | 13 | 12   | 0.03 |
|           |                 | 62  | 26  | 20   | 0.03 | 22 | 18   | 0.03 | 18 | 16   | 0.04 | 14 | 14   | 0.11 | 12 | 12   | 0.26 |
|           | 600             | 72  | 42  | 21   | 0.00 | 38 | 19   | 0.00 | 33 | 17   | 0.02 | 28 | 15   | 0.02 | 23 | 13   | 0.03 |
|           |                 | 67  | 35  | 22   | 0.03 | 30 | 20   | 0.03 | 26 | 18   | 0.03 | 21 | 15   | 0.03 | 15 | 13   | 0.04 |
|           |                 | 62  | 28  | 22   | 0.04 | 24 | 20   | 0.04 | 19 | 18   | 0.05 | 16 | 16   | 0.13 | 13 | 13   | 0.28 |
|           | 675             | 72  | 45  | 22   | 0.00 | 41 | 20   | 0.02 | 36 | 18   | 0.03 | 30 | 16   | 0.03 | 24 | 14   | 0.04 |
|           |                 | 67  | 37  | 24   | 0.04 | 33 | 21   | 0.04 | 28 | 19   | 0.04 | 22 | 17   | 0.04 | 16 | 14   | 0.05 |
|           |                 | 62  | 30  | 25   | 0.05 | 26 | 22   | 0.05 | 21 | 20   | 0.06 | 17 | 17   | 0.15 | 14 | 14   | 0.30 |
| FC4D 024  | 700             | 72  | 49  | 24   | 0.00 | 44 | 22   | 0.00 | 38 | 19   | 0.02 | 32 | 17   | 0.03 | 26 | 14   | 0.03 |
|           |                 | 67  | 40  | 25   | 0.04 | 35 | 23   | 0.04 | 30 | 20   | 0.04 | 23 | 17   | 0.04 | 16 | 14   | 0.05 |
|           |                 | 62  | 32  | 26   | 0.04 | 27 | 23   | 0.04 | 22 | 21   | 0.05 | 18 | 18   | 0.14 | 15 | 15   | 0.29 |
|           | 800             | 72  | 53  | 26   | 0.00 | 48 | 24   | 0.02 | 42 | 21   | 0.04 | 35 | 18   | 0.04 | 28 | 16   | 0.05 |
|           |                 | 67  | 44  | 27   | 0.05 | 38 | 25   | 0.05 | 32 | 22   | 0.05 | 26 | 19   | 0.05 | 18 | 16   | 0.06 |
|           |                 | 62  | 35  | 29   | 0.05 | 30 | 26   | 0.06 | 24 | 23   | 0.07 | 20 | 20   | 0.17 | 16 | 16   | 0.31 |
| 900       | 72              | 57  | 28  | 0.00 | 51   | 26 | 0.03 | 45   | 23 | 0.05 | 38   | 20 | 0.05 | 30   | 17 | 0.06 |      |
|           | 67              | 47  | 30  | 0.06 | 41   | 27 | 0.06 | 35   | 24 | 0.06 | 28   | 21 | 0.06 | 20   | 18 | 0.08 |      |
|           | 62              | 38  | 31  | 0.07 | 32   | 28 | 0.07 | 26   | 25 | 0.08 | 22   | 22 | 0.19 | 18   | 18 | 0.33 |      |
| FC4D 030  | 875             | 72  | 62  | 30   | 0.00 | 55 | 27   | 0.01 | 48 | 24   | 0.02 | 41 | 21   | 0.03 | 32 | 18   | 0.04 |
|           |                 | 67  | 51  | 32   | 0.04 | 44 | 28   | 0.04 | 37 | 25   | 0.04 | 29 | 22   | 0.04 | 20 | 18   | 0.05 |
|           |                 | 62  | 41  | 33   | 0.04 | 34 | 29   | 0.05 | 27 | 26   | 0.06 | 22 | 22   | 0.15 | 18 | 18   | 0.30 |
|           | 1000            | 72  | 67  | 33   | 0.00 | 60 | 30   | 0.02 | 52 | 27   | 0.04 | 44 | 23   | 0.04 | 35 | 20   | 0.05 |
|           |                 | 67  | 55  | 35   | 0.05 | 48 | 31   | 0.05 | 41 | 28   | 0.05 | 32 | 24   | 0.05 | 22 | 20   | 0.07 |
|           |                 | 62  | 44  | 36   | 0.06 | 38 | 33   | 0.06 | 30 | 29   | 0.07 | 25 | 25   | 0.18 | 20 | 20   | 0.32 |
|           | 1125            | 72  | 72  | 36   | 0.01 | 65 | 32   | 0.04 | 57 | 29   | 0.05 | 47 | 25   | 0.05 | 38 | 22   | 0.06 |
|           |                 | 67  | 60  | 38   | 0.06 | 52 | 34   | 0.06 | 44 | 30   | 0.06 | 35 | 27   | 0.07 | 24 | 22   | 0.08 |
|           |                 | 62  | 48  | 39   | 0.07 | 41 | 36   | 0.07 | 33 | 32   | 0.09 | 27 | 27   | 0.20 | 23 | 23   | 0.34 |
| FC4D 036  | 1050            | 72  | 72  | 36   | 0.00 | 65 | 32   | 0.01 | 57 | 29   | 0.03 | 48 | 25   | 0.03 | 38 | 21   | 0.04 |
|           |                 | 67  | 59  | 37   | 0.04 | 52 | 34   | 0.04 | 44 | 30   | 0.04 | 34 | 26   | 0.04 | 24 | 21   | 0.06 |
|           |                 | 62  | 48  | 39   | 0.05 | 40 | 35   | 0.05 | 32 | 31   | 0.06 | 26 | 26   | 0.16 | 22 | 22   | 0.31 |
|           | 1200            | 72  | 79  | 39   | 0.00 | 71 | 35   | 0.03 | 62 | 31   | 0.04 | 52 | 27   | 0.05 | 41 | 23   | 0.05 |
|           |                 | 67  | 65  | 41   | 0.05 | 57 | 37   | 0.05 | 48 | 33   | 0.06 | 38 | 29   | 0.06 | 26 | 24   | 0.07 |
|           |                 | 62  | 52  | 43   | 0.06 | 44 | 39   | 0.06 | 36 | 34   | 0.08 | 29 | 29   | 0.18 | 24 | 24   | 0.33 |
| 1350      | 72              | 85  | 42  | 0.01 | 76   | 38 | 0.04 | 66   | 34 | 0.05 | 56   | 30 | 0.06 | 45   | 25 | 0.06 |      |
|           | 67              | 70  | 45  | 0.06 | 61   | 40 | 0.06 | 51   | 36 | 0.07 | 41   | 31 | 0.07 | 29   | 26 | 0.09 |      |
|           | 62              | 56  | 46  | 0.07 | 48   | 42 | 0.07 | 39   | 38 | 0.09 | 32   | 32 | 0.20 | 27   | 27 | 0.34 |      |
| FC4D 042  | 1225            | 72  | 85  | 42   | 0.00 | 77 | 38   | 0.01 | 67 | 34   | 0.02 | 57 | 30   | 0.03 | 46 | 25   | 0.03 |
|           |                 | 67  | 70  | 44   | 0.03 | 62 | 40   | 0.03 | 52 | 36   | 0.04 | 42 | 31   | 0.04 | 30 | 26   | 0.04 |
|           |                 | 62  | 57  | 46   | 0.04 | 48 | 42   | 0.04 | 39 | 37   | 0.05 | 32 | 32   | 0.14 | 27 | 27   | 0.28 |
|           | 1400            | 72  | 92  | 46   | 0.00 | 83 | 42   | 0.02 | 73 | 37   | 0.03 | 62 | 33   | 0.04 | 50 | 28   | 0.04 |
|           |                 | 67  | 76  | 48   | 0.04 | 67 | 44   | 0.04 | 57 | 39   | 0.05 | 46 | 35   | 0.05 | 33 | 29   | 0.06 |
|           |                 | 62  | 62  | 51   | 0.05 | 53 | 46   | 0.05 | 43 | 41   | 0.06 | 36 | 36   | 0.16 | 30 | 30   | 0.30 |
|           | 1575            | 72  | 99  | 49   | 0.01 | 89 | 45   | 0.03 | 79 | 40   | 0.04 | 67 | 36   | 0.05 | 53 | 30   | 0.05 |
|           |                 | 67  | 82  | 52   | 0.05 | 72 | 48   | 0.05 | 61 | 43   | 0.06 | 49 | 38   | 0.06 | 36 | 32   | 0.07 |
|           |                 | 62  | 67  | 55   | 0.06 | 57 | 50   | 0.06 | 47 | 45   | 0.08 | 39 | 39   | 0.18 | 33 | 33   | 0.32 |

**FX4C / FC4D**

# PERFORMANCE DATA (CONT)

## GROSS COOLING CAPACITIES (mbh) - R-22 Refrigerant

FX4C / FC4D

| UNIT SIZE | INDOOR COIL AIR |     | SATURATED TEMPERATURE LEAVING EVAPORATOR (°F) |     |      |     |     |      |     |     |      |    |     |      |    |     |      |
|-----------|-----------------|-----|---|-----|------|-----|-----|------|-----|-----|------|----|-----|------|----|-----|------|
|           |                 |     | 35  |     |      | 40  |     |      | 45  |     |      | 50 |     |      | 55 |     |      |
|           | CFM             | EWB | TC  | SHC | BF   | TC  | SHC | BF   | TC  | SHC | BF   | TC | SHC | BF   | TC | SHC | BF   |
| FC4D 048  | 1400            | 72  | 89  | 44  | 0.00 | 81  | 40  | 0.00 | 72  | 36  | 0.01 | 61 | 32  | 0.02 | 50 | 28  | 0.02 |
|           |                 | 67  | 74  | 47  | 0.02 | 66  | 43  | 0.02 | 56  | 38  | 0.03 | 46 | 34  | 0.03 | 34 | 29  | 0.03 |
|           |                 | 62  | 60  | 49  | 0.03 | 52  | 45  | 0.03 | 43  | 40  | 0.04 | 35 | 35  | 0.11 | 29 | 29  | 0.26 |
|           | 1600            | 72  | 96  | 48  | 0.00 | 87  | 44  | 0.01 | 78  | 40  | 0.02 | 67 | 35  | 0.03 | 54 | 30  | 0.03 |
|           |                 | 67  | 80  | 51  | 0.03 | 71  | 47  | 0.03 | 61  | 42  | 0.03 | 50 | 37  | 0.03 | 37 | 32  | 0.04 |
|           |                 | 62  | 65  | 54  | 0.04 | 56  | 49  | 0.04 | 47  | 45  | 0.05 | 39 | 39  | 0.14 | 33 | 33  | 0.28 |
|           | 1800            | 72  | 103   | 51  | 0.01 | 94  | 47  | 0.02 | 83  | 43  | 0.03 | 72 | 38  | 0.03 | 58 | 33  | 0.04 |
|           |                 | 67  | 86  | 55  | 0.04 | 76  | 51  | 0.04 | 66  | 46  | 0.04 | 53 | 41  | 0.04 | 40 | 36  | 0.05 |
|           |                 | 62  | 70  | 59  | 0.04 | 60  | 54  | 0.05 | 50  | 49  | 0.06 | 43 | 43  | 0.16 | 36 | 36  | 0.29 |
| FC4D 060  | 1600            | 72  | 118   | 58  | 0.00 | 107 | 53  | 0.00 | 94  | 48  | 0.01 | 81 | 42  | 0.01 | 66 | 36  | 0.01 |
|           |                 | 67  | 98  | 61  | 0.02 | 86  | 55  | 0.02 | 74  | 50  | 0.02 | 60 | 44  | 0.02 | 43 | 37  | 0.03 |
|           |                 | 62  | 79  | 63  | 0.02 | 68  | 58  | 0.02 | 55  | 52  | 0.03 | 45 | 45  | 0.10 | 37 | 37  | 0.25 |
|           | 1750            | 72  | 125   | 62  | 0.00 | 113 | 56  | 0.00 | 100 | 51  | 0.01 | 86 | 45  | 0.02 | 69 | 38  | 0.02 |
|           |                 | 67  | 103   | 65  | 0.02 | 92  | 59  | 0.02 | 78  | 53  | 0.03 | 64 | 47  | 0.03 | 46 | 40  | 0.03 |
|           |                 | 62  | 84  | 68  | 0.03 | 72  | 62  | 0.03 | 59  | 56  | 0.04 | 48 | 48  | 0.11 | 40 | 40  | 0.26 |
|           | 2000            | 72  | 135   | 67  | 0.00 | 123 | 62  | 0.01 | 109 | 56  | 0.02 | 93 | 49  | 0.03 | 76 | 42  | 0.03 |
|           |                 | 67  | 113   | 71  | 0.03 | 100 | 65  | 0.03 | 85  | 59  | 0.03 | 69 | 52  | 0.03 | 51 | 45  | 0.04 |
|           |                 | 62  | 92  | 75  | 0.04 | 79  | 69  | 0.04 | 65  | 62  | 0.05 | 54 | 54  | 0.13 | 45 | 45  | 0.27 |

CFM – Cubic Ft. per Minute      EWB – Entering Wet Bulb (°F)      LWB – Leaving Wet Bulb (°F)      TC – Gross Cooling Capacity 1000 Btuh  
 SHC – Gross Sensible Capacity 1000 Btuh      BF – Bypass Factor      MBH – 1000 Btuh

**NOTES:**

- Contact manufacturer for cooling capacities at conditions other than shown in table.
- Formulas:  
 Leaving db = entering db –  $\frac{\text{sensible heat cap.}}{1.09 \times \text{CFM}}$   
 Leaving wb = wb corresponding to enthalpy of air leaving coil ( $h_{lwb}$ )  
 $h_{lwb} = h_{ewb} - \frac{\text{total capacity (Btuh)}}{4.5 \times \text{CFM}}$   
 where  $h_{ewb}$  = enthalpy of air entering coil. Direct interpolation is permissible. Do not extrapolate.
- SHC is based on 80°F db temperature of air entering coil. Below 80°F db, subtract (Correction Factor x CFM) from SHC. Above 80°F db, add (Correction Factor x CFM) to SHC.
- Bypass Factor = 0 indicates no psychometric solution. Use bypass factor of next lower EWB for approximation.

Interpolation is permissible.

Correction Factor =  $1.09 \times (1 - BF) \times (db - 80)$

**SHC CORRECTION FACTOR**

| BYPASS FACTOR | ENTERING AIR DRY-BULB TEMPERATURE (°F) |      |      |      |      |                         |
|---------------|--|------|------|------|------|-------------------------|
|               | 79                                     | 78   | 77   | 76   | 75   | Under 75                |
|               | 81                                     | 82   | 83   | 84   | 85   | Over 85                 |
|               | <b>Correction Factor</b>               |      |      |      |      |                         |
| 0.10          | .098                                   | 1.96 | 2.94 | 3.92 | 4.91 | Use formula shown below |
| 0.20          | 0.87                                   | 1.74 | 2.62 | 3.49 | 4.36 |                         |
| 0.30          | 0.76                                   | 1.53 | 2.29 | 3.05 | 3.82 |                         |

### MINIMUM CFM AND MOTOR SPEED SELECTION

| FAN COIL SIZES<br>FX, FC | HEATER KW |      |      |      |      |      |      |       |      |      |
|--------------------------|-----------|------|------|------|------|------|------|-------|------|------|
|                          | 3         | 5    | 8    | 9    | 10   | 15   | 18   | 20    | 24   | 30   |
| 018                      | 525       | 525  | 525  | —    | 600* | —    | —    | —     | —    | —    |
| 024                      | 700       | 700  | 700  | —    | 700  | 775* | —    | —     | —    | —    |
| 030                      | —         | 875  | 875  | —    | 875  | 875  | —    | 1060* | —    | —    |
| 036                      | —         | 1050 | 970  | 970  | 970  | 920  | —    | 1040  | —    | —    |
| 042                      | —         | —    | 1225 | 1225 | 1225 | 1225 | 1225 | 1225  | —    | —    |
| 048                      | —         | —    | 1400 | 1400 | 1400 | 1400 | 1400 | 1400  | 1400 | 1400 |
| 060                      | —         | —    | 1750 | 1750 | 1750 | 1750 | 1750 | 1750  | 1750 | 1750 |

\*Indicates medium speed (blue). All other motor speeds at low tap.

### AIR DELIVERY PERFORMANCE CORRECTION COMPONENT PRESSURE DROP (IN. WC) AT INDICATED AIRFLOW (DRY-TO-WET COIL)

| FX, FC SIZE | CFM   |       |       |       |       |       |       |       |       |       |       |       |       |       |       |       |
|-------------|-------|-------|-------|-------|-------|-------|-------|-------|-------|-------|-------|-------|-------|-------|-------|-------|
|             | 500   | 600   | 700   | 800   | 900   | 1000  | 1100  | 1200  | 1300  | 1400  | 1500  | 1600  | 1700  | 1800  | 1900  | 2000  |
| 018         | 0.034 | 0.049 | 0.063 | —     | —     | —     | —     | —     | —     | —     | —     | —     | —     | —     | —     | —     |
| 024         | 0.016 | 0.027 | 0.038 | 0.049 | 0.059 | —     | —     | —     | —     | —     | —     | —     | —     | —     | —     | —     |
| 030         | —     | —     | —     | 0.049 | 0.059 | 0.070 | 0.080 | —     | —     | —     | —     | —     | —     | —     | —     | —     |
| 036         | —     | —     | —     | —     | —     | 0.055 | 0.064 | 0.073 | 0.081 | —     | —     | —     | —     | —     | —     | —     |
| 042         | —     | —     | —     | —     | —     | —     | —     | 0.049 | 0.056 | 0.063 | 0.070 | —     | —     | —     | —     | —     |
| 048         | —     | —     | —     | —     | —     | —     | —     | —     | —     | 0.038 | 0.043 | 0.049 | 0.054 | 0.059 | —     | —     |
| 060         | —     | —     | —     | —     | —     | —     | —     | —     | —     | —     | —     | 0.027 | 0.031 | 0.035 | 0.039 | 0.043 |

## PERFORMANCE DATA (CONT)

### FACTORY-INSTALLED FILTER STATIC PRESSURE DROP (IN. WC)

| UNIT SIZE<br>FX, FC | CFM  |       |       |       |       |       |       |       |       |
|---------------------|------|-------|-------|-------|-------|-------|-------|-------|-------|
|                     | 400  | 600   | 800   | 1000  | 1200  | 1400  | 1600  | 1800  | 2000  |
| 018                 | 0.02 | 0.044 | 0.075 | —     | —     | —     | —     | —     | —     |
| 024, 030            | —    | 0.022 | 0.048 | 0.072 | 0.100 | —     | —     | —     | —     |
| 036, 042, 048       | —    | —     | —     | 0.051 | 0.070 | 0.092 | 0.120 | 0.152 | —     |
| 060                 | —    | —     | —     | —     | —     | —     | 0.086 | 0.105 | 0.130 |

### ELECTRIC HEATER STATIC PRESSURE DROP (IN. WC)

| 018 – 036       |       |                                     | 042 – 060       |            |                                     |
|-----------------|-------|-------------------------------------|-----------------|------------|-------------------------------------|
| HEATER ELEMENTS | KW    | EXTERNAL STATIC PRESSURE CORRECTION | HEATER ELEMENTS | KW         | EXTERNAL STATIC PRESSURE CORRECTION |
| 0               | 0     | +.02                                | 0               | 0          | +.04                                |
| 1               | 3, 5  | +.01                                | 2               | 8, 10      | +.02                                |
| 2               | 8, 10 | 0                                   | 3               | 9, 15      | 0                                   |
| 3               | 9, 15 | -.02                                | 4               | 20         | -.02                                |
| 4               | 20    | -.04                                | 6               | 18, 24, 30 | -.10                                |

The airflow performance data was developed using fan coils with 10-kW electric heaters (2 elements) in the 018 through 036 size units and 15-kW heaters (3 elements) in the 042 through 060 size units. For fan coils with heaters of a different number of elements, the external available static at a given CFM from the curve may be corrected by adding or subtracting available external static pressure as indicated above.

FX4C / FC4D

### ACCESSORY ELECTRIC HEATERS

| HEATER PART NO. | KW @ 240V | VOLTS/PH | STAGES (KW OPERATING) | INTERNAL CIRCUIT PROTECTION | FAN COIL SIZE USED WITH | HEATING CAP.** @ 230V |
|-----------------|-----------|----------|-----------------------|-----------------------------|-------------------------|-----------------------|
| KFCEH0401N03    | 3         | 230/1    | 3                     | None                        | 018-024                 | 9,400                 |
| KFCEH0501N05    | 5         | 230/1    | 5                     | None                        | 018-060                 | 15,700                |
| KFCEH0801N08    | 8         | 230/1    | 8                     | None                        | 018-060                 | 25,100                |
| KFCEH0901N10    | 10        | 230/1    | 10                    | None                        | 018-060                 | 31,400                |
| KFCEH3201F20    | 20        | 230/1    | 5, 20                 | Fuse ‡                      | 030-060                 | 62,800                |
| KFCEH1601315    | 15        | 230/3    | 5, 15                 | None                        | 036-060                 | 47,100                |
| KFCEH2001318    | 18        | 230/3    | 6, 12, 18             | None                        | 042-060                 | 56,500                |
| KFCEH3401F24    | 24        | 230/3*   | 8, 16, 24             | Fuse                        | 048, 060                | 78,300                |
| KFCEH3501F30    | 30        | 230/3*   | 10, 20, 30            | Fuse                        | 048, 060                | 94,100                |
| KFCEH2401C05    | 5         | 230/1    | 5                     | Circuit Breaker             | 018-060                 | 15,700                |
| KFCEH2501C08    | 8         | 230/1    | 8                     | Circuit Breaker             | 018-060                 | 25,100                |
| KFCEH2601C10    | 10        | 230/1    | 10                    | Circuit Breaker             | 018-060                 | 31,400                |
| KFCEH3301C20    | 20        | 230/1    | 5, 20                 | Circuit Breaker             | 030-060                 | 62,800                |
| KFCEH2901N09    | 9         | 230/1 †  | 3, 9                  | None                        | 036-060                 | 28,200                |
| KFCEH3001F15    | 15        | 230/1    | 5, 15                 | Fuse ‡                      | 024-060                 | 47,100                |
| KFCEH3101C15    | 15        | 230/1    | 5, 15                 | Circuit Breaker             | 024-060                 | 47,100                |

\* Field convertible to 1 phase.

† Field convertible to 3 phase.

‡ Single point wiring kit required for these heaters in Canada.

\*\* Blower Motor heat not included.

### ESTIMATED SOUND POWER LEVEL (dBA)

| UNIT SIZE<br>FX, FC | CONDITIONS |                     | OCTAVE BAND CENTER FREQUENCY* |      |      |      |      |      |      |
|---------------------|------------|---------------------|-------------------------------|------|------|------|------|------|------|
|                     | CFM        | Ext Static Pressure | 63                            | 125  | 250  | 500  | 1000 | 2000 | 4000 |
| 018                 | 600        | 0.25                | 64.7                          | 60.7 | 56.7 | 53.7 | 51.7 | 49.7 | 45.7 |
| 024                 | 800        | 0.25                | 66.0                          | 62.0 | 58.0 | 55.0 | 53.0 | 51.0 | 47.0 |
| 030                 | 1000       | 0.25                | 67.0                          | 63.0 | 59.0 | 56.0 | 54.0 | 52.0 | 48.0 |
| 036                 | 1200       | 0.25                | 67.8                          | 63.8 | 59.8 | 56.8 | 54.8 | 52.8 | 48.8 |
| 042                 | 1400       | 0.25                | 68.4                          | 64.4 | 60.4 | 57.4 | 55.4 | 53.4 | 49.4 |
| 048                 | 1600       | 0.25                | 69.0                          | 65.0 | 61.0 | 58.0 | 56.0 | 54.0 | 50.0 |
| 060                 | 2000       | 0.25                | 70.0                          | 66.0 | 62.0 | 59.0 | 57.0 | 55.0 | 51.0 |

\* Estimated sound power levels have been derived using the method described in the 1987 ASHRAE HVAC Systems & Applications Handbook, Chapter 52, p. 52.7.

## ELECTRICAL DATA FOR UNITS WITH FACTORY-INSTALLED HEAT

| MODEL NO.    | MTR HP | MTR FLA | VOLTS/PH/HZ  | HEAT PACK INSTALLED | SINGLE CIRCUIT |           |                        | DUAL CIRCUIT |           |                        |           |           |                        |     |
|--------------|--------|---------|--------------|---------------------|----------------|-----------|------------------------|--------------|-----------|------------------------|-----------|-----------|------------------------|-----|
|              |        |         |              |                     | Heater Amps    | MCA       | Max. Overcur. Protect. | Htr. Amps    | MCA       | Max. Overcur. Protect. | Htr. Amps | MCA       | Max. Overcur. Protect. |     |
|              |        |         |              |                     |                |           |                        | L1/L2        | L1/L2     | L1/L2                  | L3/L4     | L3/L4     | L3/L4                  |     |
| FX4CNF018005 | 1/3    | 2.8     | 208/230/1/60 | MKFCEH0501N05       | 18.1/20.0      | 26.1/28.5 | 30/30                  | N/A          | N/A       | N/A                    | N/A       | N/A       | N/A                    | N/A |
| FX4CNF024005 | 1/3    | 2.8     | 208/230/1/60 | MKFCEH0501N05       | 18.1/20.0      | 26.1/28.5 | 30/30                  | N/A          | N/A       | N/A                    | N/A       | N/A       | N/A                    | N/A |
| FX4CNF030008 | 1/3    | 2.8     | 208/230/1/60 | MKFCEH0801N08       | 28.9/32.0      | 39.6/43.5 | 40/45                  | N/A          | N/A       | N/A                    | N/A       | N/A       | N/A                    | N/A |
| FX4CNF036010 | 1/2    | 4.1     | 208/230/1/60 | MKFCEH0901N10       | 36.2/40.0      | 50.4/55.1 | 60/60                  | N/A          | N/A       | N/A                    | N/A       | N/A       | N/A                    | N/A |
| FX4CNF042010 | 1/2    | 4.1     | 208/230/1/60 | MKFCEH0901N10       | 36.2/40.0      | 50.4/55.1 | 60/60                  | N/A          | N/A       | N/A                    | N/A       | N/A       | N/A                    | N/A |
| FX4CNF048010 | 3/4    | 6.0     | 208/230/1/60 | MKFCEH0901N10       | 36.2/40.0      | 52.8/57.5 | 60/60                  | N/A          | N/A       | N/A                    | N/A       | N/A       | N/A                    | N/A |
| FX4CNF060010 | 3/4    | 6.0     | 208/230/1/60 | MKFCEH0901N10       | 36.2/40.0      | 52.8/57.5 | 60/60                  | N/A          | N/A       | N/A                    | N/A       | N/A       | N/A                    | N/A |
| FX4CNF060015 | 3/4    | 6.0     | 208/230/1/60 | MKFCEH1501F15       | 54.2/59.9      | 75.3/82.4 | 80/90                  | 36.2/40.0    | 52.8/57.5 | 60/60                  | 18.1/20.0 | 22.6/25.0 | 25/25                  |     |

| MODEL NO.    | MTR HP | MTR FLA | VOLTS/PH/HZ  | HEAT PACK INSTALLED | SINGLE CIRCUIT |           |                        | DUAL CIRCUIT |           |                        |           |           |                        |     |
|--------------|--------|---------|--------------|---------------------|----------------|-----------|------------------------|--------------|-----------|------------------------|-----------|-----------|------------------------|-----|
|              |        |         |              |                     | Heater Amps    | MCA       | Max. Overcur. Protect. | Htr. Amps    | MCA       | Max. Overcur. Protect. | Htr. Amps | MCA       | Max. Overcur. Protect. |     |
|              |        |         |              |                     |                |           |                        | L1/L2        | L1/L2     | L1/L2                  | L3/L4     | L3/L4     | L3/L4                  |     |
| FC4DNF018005 | 1/3    | 2.8     | 208/230/1/60 | MKFCEH0501N05       | 18.1/20.0      | 26.1/28.5 | 30/30                  | N/A          | N/A       | N/A                    | N/A       | N/A       | N/A                    | N/A |
| FC4DNF024005 | 1/3    | 2.8     | 208/230/1/60 | MKFCEH0501N05       | 18.1/20.0      | 26.1/28.5 | 30/30                  | N/A          | N/A       | N/A                    | N/A       | N/A       | N/A                    | N/A |
| FC4DNF030008 | 1/3    | 2.8     | 208/230/1/60 | MKFCEH0801N08       | 28.9/32.0      | 39.6/43.5 | 40/45                  | N/A          | N/A       | N/A                    | N/A       | N/A       | N/A                    | N/A |
| FC4DNF036008 | 1/2    | 4.1     | 208/230/1/60 | MKFCEH0801N08       | 28.9/32.0      | 41.3/45.1 | 45/45                  | N/A          | N/A       | N/A                    | N/A       | N/A       | N/A                    | N/A |
| FC4DNF036010 | 1/2    | 4.1     | 208/230/1/60 | MKFCEH0901N10       | 36.2/40.0      | 50.4/55.1 | 60/60                  | N/A          | N/A       | N/A                    | N/A       | N/A       | N/A                    | N/A |
| FC4DNF042010 | 1/2    | 4.1     | 208/230/1/60 | MKFCEH0901N10       | 36.2/40.0      | 50.4/55.1 | 60/60                  | N/A          | N/A       | N/A                    | N/A       | N/A       | N/A                    | N/A |
| FC4DNF042015 | 1/2    | 4.1     | 208/230/1/60 | MKFCEH1501F15       | 54.2/59.9      | 72.9/80.0 | 80/90                  | 36.2/40.0    | 50.4/55.1 | 60/60                  | 18.1/20.0 | 22.6/25.0 | 25/25                  |     |
| FC4DNF048010 | 3/4    | 6.0     | 208/230/1/60 | MKFCEH0901N10       | 36.2/40.0      | 52.8/57.5 | 60/60                  | N/A          | N/A       | N/A                    | N/A       | N/A       | N/A                    | N/A |
| FC4DNF048015 | 3/4    | 6.0     | 208/230/1/60 | MKFCEH1501F15       | 54.2/59.9      | 75.3/82.4 | 80/90                  | 36.2/40.0    | 52.8/57.5 | 60/60                  | 18.1/20.0 | 22.6/25.0 | 25/25                  |     |
| FC4DNF060010 | 3/4    | 6.0     | 208/230/1/60 | MKFCEH0901N10       | 36.2/40.0      | 52.8/57.5 | 60/60                  | N/A          | N/A       | N/A                    | N/A       | N/A       | N/A                    | N/A |
| FC4DNF060015 | 3/4    | 6.0     | 208/230/1/60 | MKFCEH1501F15       | 54.2/59.9      | 75.3/82.4 | 80/90                  | 36.2/40.0    | 52.8/57.5 | 60/60                  | 18.1/20.0 | 22.6/25.0 | 25/25                  |     |

MCA – Minimum Circuit Amps

FX4C / FC4D

## ELECTRICAL DATA FOR UNITS WITHOUT ELECTRICAL HEAT

| MODEL NO.    | MTR HP | MTR FLA | VOLTS/PH/HZ  | SINGLE CIRCUIT |                                | BRANCH CIRCUIT MIN WIRE SIZE* AWG |
|--------------|--------|---------|--------------|----------------|--------------------------------|-----------------------------------|
|              |        |         |              | MCA            | MAXIMUM OVERCURRENT PROTECTION |                                   |
| FX4CNF018000 | 1/3    | 2.8     | 208/230/1/60 | 3.5            | 15                             | 14                                |
| FX4CNF024000 | 1/3    | 2.8     | 208/230/1/60 | 3.5            | 15                             | 14                                |
| FX4CNF030000 | 1/3    | 2.8     | 208/230/1/60 | 3.5            | 15                             | 14                                |
| FX4CNF036000 | 1/2    | 4.1     | 208/230/1/60 | 5.1            | 15                             | 14                                |
| FX4CNF042000 | 1/2    | 4.1     | 208/230/1/60 | 5.1            | 15                             | 14                                |
| FX4CNF048000 | 3/4    | 6.0     | 208/230/1/60 | 7.5            | 15                             | 14                                |
| FX4CNF060000 | 3/4    | 6.0     | 208/230/1/60 | 7.5            | 15                             | 14                                |
| FX4CNB036000 | 1/2    | 4.1     | 208/230/1/60 | 5.1            | 15                             | 14                                |
| FX4CNB042000 | 1/2    | 4.1     | 208/230/1/60 | 5.1            | 15                             | 14                                |
| FX4CNB048000 | 3/4    | 6.0     | 208/230/1/60 | 7.5            | 15                             | 14                                |
| FX4CNB060000 | 3/4    | 6.0     | 208/230/1/60 | 7.5            | 15                             | 14                                |

| MODEL NO.    | MTR HP | MTR FLA | VOLTS/PH/HZ  | SINGLE CIRCUIT |                                | BRANCH CIRCUIT MIN WIRE SIZE* AWG |
|--------------|--------|---------|--------------|----------------|--------------------------------|-----------------------------------|
|              |        |         |              | MCA            | MAXIMUM OVERCURRENT PROTECTION |                                   |
| FC4DNF018000 | 1/3    | 2.8     | 208/230/1/60 | 3.5            | 15                             | 14                                |
| FC4DNF024000 | 1/3    | 2.8     | 208/230/1/60 | 3.5            | 15                             | 14                                |
| FC4DNF030000 | 1/3    | 2.8     | 208/230/1/60 | 3.5            | 15                             | 14                                |
| FC4DNF036000 | 1/2    | 4.1     | 208/230/1/60 | 5.1            | 15                             | 14                                |
| FC4DNF042000 | 1/2    | 4.1     | 208/230/1/60 | 5.1            | 15                             | 14                                |
| FC4DNF060000 | 3/4    | 6.0     | 208/230/1/60 | 7.5            | 15                             | 14                                |
| FC4DNB036000 | 1/2    | 4.1     | 208/230/1/60 | 5.1            | 15                             | 14                                |
| FC4DNB042000 | 1/2    | 4.1     | 208/230/1/60 | 5.1            | 15                             | 14                                |
| FC4DNB048000 | 3/4    | 6.0     | 208/230/1/60 | 7.5            | 15                             | 14                                |
| FC4DNB060000 | 3/4    | 6.0     | 208/230/1/60 | 7.5            | 15                             | 14                                |

\* Use copper wire only. Use 75°C only in this application. When using non-metallic (NM) sheathed cable, wire size required should be based on that of 60°C conductors, instead of wire sizes shown in table above per NEC Article 336-26.

**NOTE:** If branch circuit wire length exceeds 100 ft, consult NEC 215-2 to determine maximum wire length. Use 2% voltage drop.

**FLA** – Full Load Amps

# ACCESSORY ELECTRIC HEATER ELECTRICAL DATA

| HEATER PART NO.           | KW   |      | INTERNAL CIRCUIT PROTECTION | HEATER AMPS 208/230V |             |              |           | Min Ampacity 208/230V** |    |              |           | Min Wire Size (AWG) 208/230V†† |     |              |       | Min Gnd Wire Size 208/230V |       |              |         | Max Fuse/Ckt Bkr Amps 208/230V |       |              |        | Max Wire Length 208/230V (Ft)‡‡ |         |       |    |
|---------------------------|------|------|-----------------------------|----------------------|-------------|--------------|-----------|-------------------------|----|--------------|-----------|--------------------------------|-----|--------------|-------|----------------------------|-------|--------------|---------|--------------------------------|-------|--------------|--------|---------------------------------|---------|-------|----|
|                           | 240V | 208V |                             | Dual Circuit         |             | Dual Circuit |           | Dual Circuit            |    | Dual Circuit |           | Dual Circuit                   |     | Dual Circuit |       | Dual Circuit               |       | Dual Circuit |         | Dual Circuit                   |       | Dual Circuit |        | Dual Circuit                    |         |       |    |
|                           |      |      |                             | L1                   | L2          | L1           | L2        | L1                      | L2 | L1           | L2        | L1                             | L2  | L1           | L2    | L1                         | L2    | L1           | L2      | L1                             | L2    | L1           | L2     | L1                              | L2      | L3    | L4 |
| KFCEH0401N03              | 3    | 2.3  | 1                           | None                 | 10.9/12.0   | —            | —         | —                       | —  | 15.9/17.3    | —         | —                              | —   | —            | 12/12 | —                          | —     | —            | —       | 20/20                          | —     | —            | —      | —                               | 67/68   | —     | —  |
| KFCEH0501N05 <sup>1</sup> | 5    | 3.8  | 1                           | None                 | 18.1/20.0   | —            | —         | —                       | —  | 26.0/28.4    | —         | —                              | —   | —            | 10/10 | —                          | —     | —            | —       | 30/30                          | —     | —            | —      | —                               | 66/66   | —     | —  |
| KFCEH0501N05 <sup>2</sup> | 5    | 3.8  | 1                           | None                 | 18.1/20.0   | —            | —         | —                       | —  | 31.2/33.5    | —         | —                              | —   | —            | 10/10 | —                          | —     | —            | —       | 35/35                          | —     | —            | —      | —                               | 85/88   | —     | —  |
| KFCEH2401C05 <sup>1</sup> | 5    | 3.8  | 1                           | Ckt Bkr              | 18.1/20.0   | —            | —         | —                       | —  | 26.0/28.4    | —         | —                              | —   | —            | 10/10 | —                          | —     | —            | —       | 30/30                          | —     | —            | —      | —                               | 66/66   | —     | —  |
| KFCEH2401C05 <sup>2</sup> | 5    | 3.8  | 1                           | Ckt Bkr              | 18.1/20.0   | —            | —         | —                       | —  | 31.2/33.5    | —         | —                              | —   | —            | 10/10 | —                          | —     | —            | —       | 35/35                          | —     | —            | —      | —                               | 85/88   | —     | —  |
| KFCEH0801N08              | 8    | 6.0  | 1                           | None                 | 28.9/32.0   | —            | —         | —                       | —  | 44.7/48.5    | —         | —                              | —   | —            | 10/10 | —                          | —     | —            | —       | 45/50                          | —     | —            | —      | —                               | 59/60   | —     | —  |
| KFCEH2501C08              | 8    | 6.0  | 1                           | Ckt Bkr              | 28.9/32.0   | —            | —         | —                       | —  | 44.7/48.5    | —         | —                              | —   | —            | 10/10 | —                          | —     | —            | —       | 45/50                          | —     | —            | —      | —                               | 59/60   | —     | —  |
| KFCEH2901N09*             | 9    | 6.8  | 1                           | None                 | 32.9/36.0   | —            | —         | —                       | —  | 49.5/53.5    | —         | —                              | —   | —            | 10/10 | —                          | —     | —            | —       | 50/60                          | —     | —            | —      | —                               | 54/57   | —     | —  |
| KFCEH2901N09*             | 9    | 6.8  | 3                           | None                 | 18.8/20.8   | —            | —         | —                       | —  | 32.0/34.5    | —         | —                              | —   | —            | 10/10 | —                          | —     | —            | —       | 35/35                          | —     | —            | —      | —                               | 83/85   | —     | —  |
| KFCEH0901N10              | 10   | 7.5  | 1                           | None                 | 36.2/40.0   | —            | —         | —                       | —  | 53.8/58.5    | —         | —                              | —   | —            | 10/10 | —                          | —     | —            | —       | 60/60                          | —     | —            | —      | —                               | 78/80   | —     | —  |
| KFCEH2601C10              | 10   | 7.5  | 1                           | Ckt Bkr              | 36.2/40.0   | —            | —         | —                       | —  | 53.8/58.5    | —         | —                              | —   | —            | 10/10 | —                          | —     | —            | —       | 60/60                          | —     | —            | —      | —                               | 78/80   | —     | —  |
| KFCEH3001F15*             | 15   | 11.3 | 1                           | Fuse                 | 54.2/59.9   | 36.2/40.0    | 18.1/20.0 | —                       | —  | 76.3/83.4    | 53.8/58.5 | 22.7/25.0                      | 4/4 | 6/6          | 10/10 | 8/8                        | 10/10 | 10/10        | 10/10   | 80/90                          | 60/60 | 25/25        | 88/89  | 78/80                           | 75/76   | —     |    |
| KFCEH3101C15*             | 15   | 11.3 | 1                           | Ckt Bkr              | 36.2/40.0   | —            | —         | —                       | —  | 53.8/58.5    | —         | —                              | —   | —            | 10/10 | —                          | —     | —            | —       | 60/60                          | —     | —            | —      | —                               | 78/80   | 75/76 | —  |
| KFCEH1601315              | 15   | 11.3 | 3                           | None                 | 31.3/34.6   | —            | —         | —                       | —  | 47.7/51.8    | —         | —                              | —   | —            | 10/10 | —                          | —     | —            | —       | 50/60                          | —     | —            | —      | —                               | 56/60   | —     | —  |
| KFCEH2001318              | 18   | 13.5 | 3                           | None                 | 37.6/41.5   | —            | —         | —                       | —  | 55.6/60.4    | —         | —                              | —   | —            | 10/8  | —                          | —     | —            | —       | 60/70                          | —     | —            | —      | —                               | 76/77   | —     | —  |
| KFCEH3201F20*             | 20   | 15.0 | 1                           | Fuse                 | 72.3/79.9   | 36.2/40.0    | 36.2/40.0 | —                       | —  | 98.9/108.4   | 53.8/58.5 | 45.3/50.0                      | 3/2 | 6/6          | 8/8   | 8/8                        | 10/10 | 10/10        | 100/110 | 60/60                          | 50/60 | 50/60        | 85/109 | 78/80                           | 59/59   | —     |    |
| KFCEH3301C20*             | 20   | 15.0 | 1                           | Ckt Bkr              | 36.2/40.0   | —            | —         | —                       | —  | 53.8/58.5    | —         | —                              | —   | —            | 10/10 | —                          | —     | —            | —       | 60/60                          | —     | —            | —      | —                               | 78/80   | 59/59 | —  |
| KFCEH3401F24†*            | 24   | 18.0 | 3                           | Fuse                 | 50.1/55.4   | —            | —         | —                       | —  | 71.2/77.8    | —         | —                              | —   | —            | 8/8   | —                          | —     | —            | —       | 80/80                          | —     | —            | —      | —                               | 94/95   | —     | —  |
|                           | 24   | 18.0 | 1                           | Fuse                 | 86.7/95.5   | —            | —         | —                       | —  | 116.9/127.9  | —         | —                              | —   | —            | 6/6   | —                          | —     | —            | —       | 125/150                        | —     | —            | —      | —                               | 115/116 | —     | —  |
|                           | 30   | 22.5 | 3                           | Fuse                 | 62.6/68.2   | —            | —         | —                       | —  | 88.8/95.0    | —         | —                              | —   | —            | 8/8   | —                          | —     | —            | —       | 90/100                         | —     | —            | —      | —                               | 97/98   | —     | —  |
| KFCEH3501F30†*            | 30   | 22.5 | 1                           | Fuse                 | 108.0/120.0 | —            | —         | —                       | —  | 144.8/158.5  | —         | —                              | —   | —            | 0/00  | —                          | —     | —            | —       | 150/175                        | —     | —            | —      | —                               | 117/150 | —     | —  |

## FIELD MULTIPPOINT WIRING OF 24-AND 30-KW SINGLE PHASE

| HEATER PART NO. | KW   |      | P H A S E | HEATER AMPS 208/230V |           |           |           |           |           | MIN AMPACITY 208/230V** |           |           |           |     |     | MIN WIRE SIZE (AWG) 208/230V†† |     |     |     |     |       | MIN GND WIRE SIZE 208/230V |       |       |       |       |       | MAX FUSE/CKT BKR AMPS 208/230V |    |    |    |    |    | MAX WIRE LENGTH 208/230V (Ft)‡‡ |  |  |  |  |  |
|-----------------|------|------|-----------|----------------------|-----------|-----------|-----------|-----------|-----------|-------------------------|-----------|-----------|-----------|-----|-----|--------------------------------|-----|-----|-----|-----|-------|----------------------------|-------|-------|-------|-------|-------|--------------------------------|----|----|----|----|----|---------------------------------|--|--|--|--|--|
|                 | 240V | 208V |           | L1                   | L2        | L3        | L4        | L5        | L6        | L1                      | L2        | L3        | L4        | L5  | L6  | L1                             | L2  | L3  | L4  | L5  | L6    | L1                         | L2    | L3    | L4    | L5    | L6    | L1                             | L2 | L3 | L4 | L5 | L6 |                                 |  |  |  |  |  |
| KFCEH3401F24†*  | 24   | 18.0 | 1         | 28.9/32.0            | 28.9/32.0 | 28.9/32.0 | 28.9/32.0 | 28.9/32.0 | 28.9/32.0 | 28.9/32.0               | 44.7/48.5 | 36.2/40.0 | 36.2/40.0 | 8/8 | 8/8 | 8/8                            | 8/8 | 8/8 | 8/8 | 8/8 | 10/10 | 45/50                      | 40/40 | 40/40 | 59/60 | 73/73 | 73/73 | —                              | —  | —  | —  | —  | —  |                                 |  |  |  |  |  |
| KFCEH3501F30†*  | 30   | 22.5 | 1         | 36.2/40.0            | 36.2/40.0 | 36.2/40.0 | 36.2/40.0 | 36.2/40.0 | 36.2/40.0 | 53.8/58.5               | 45.3/50.0 | 45.3/50.0 | 6/6       | 6/6 | 6/6 | 6/6                            | 6/6 | 6/6 | 6/6 | 6/6 | 6/6   | 60/60                      | 50/50 | 50/50 | 78/80 | 59/59 | 59/59 | —                              | —  | —  | —  | —  | —  |                                 |  |  |  |  |  |

\* Heaters are intelligent Heat capable when used with the FE, FK and FV fan coils and corporate 2-speed programmable thermostat (TSTATCCP2S01-B), Thermidistat™ Control (TSTATCCPRH01-B), Comfort Zone II™ or Infinity Control™.

† Field convertible to 1 phase, single or multiple supply circuit.

‡ Field convertible to 3 phase.

\*\* Includes blower motor amps of largest fan coil used with heater.

†† Copper wire must be used. If other than uncoated (non-plated), 75°C ambient, copper wire (solid wire for 10 AWG and smaller, stranded wire for larger than 10 AWG) is used, consult applicable tables of the National Electric Code (ANSI/NFPA 70).

‡‡ Length shown is as measured 1 way along wire path between unit and service panel for a voltage drop not to exceed 2%.

### NOTES:

- For fan coil sizes 018-036.
- For fan coil sizes 042-060 and all FK4D, FV4B sizes.
- Single circuit application of F15 and F20 heaters require single-point wiring kit accessory.



# HEATER ELECTRICAL DATA

## FACTORY-INSTALLED HEATER OPTIONS\*

| MODEL  | 018 | 024 | 030 | 036   | 042    | 048    | 060    |
|--------|-----|-----|-----|-------|--------|--------|--------|
| FC4DNF | 5   | 5   | 8   | 8, 10 | 10, 15 | 10, 15 | 10, 15 |
| FX4CNF | 5   | 5   | 8   | 10    | 10     | 10     | 10, 15 |

\* For field-installed heater/fan coil combinations, see Accessory Electric Heaters on page 11.

## ELECTRIC HEATER INTERNAL PROTECTION

| HEATER KW | PHASE | FUSE QTY/SIZE | CKT BKR* QTY/SIZE |
|-----------|-------|---------------|-------------------|
| 5         | 1     | —             | 1/60              |
| 8         | 1     | —             | 1/60              |
| 9         | 1/3   | —             | —                 |
| 10        | 1     | —             | 1/60              |
| 15        | 1     | 2/30-2/60     | 2/60              |
| 15        | 3     | —             | —                 |
| 18        | 3     | —             | —                 |
| 20        | 1     | 4/60          | 2/60              |
| 24        | 1/3   | 6/60          | —                 |
| 30        | 1/3   | 6/60          | —                 |

\*All circuit breakers are 2 pole.

When using units with 20-, 24-, and 30-kW electric heaters, maintain a 1-in. clearance from combustible materials to discharge plenum and ductwork and maintain a distance of 36 in. from the unit. Use an accessory downflow base to maintain proper clearance on downflow installations. Use flexible connectors between ductwork and unit to prevent transmission of vibration. When electric heater is installed, use heat resistant material for flexible connector between ductwork and unit at discharge connection. Ductwork passing through unconditioned space must be insulated and covered with vapor barrier

FX4C / FC4D

## ACCESSORIES

|    | ITEM  | ACCESSORY PART NO.* | FAN COIL SIZE USED WITH                       |
|----|---|---------------------|---|
| 1. | Disconnect Kit                              | KFADK0201DSC        | Cooling controls and heaters 3– through 10–kW |
| 2. | Downflow Base Kit                           | KFACB0101CFB        | 018   |
|    |   | KFACB0201CFB        | 024, 030                                      |
|    |   | KFACB0301CFB        | 036, 042, 048                                 |
|    |   | KFACB0401CFB        | 060   |
| 3. | Downflow Conversion Kit †                   | KFADC0201SLP        | Slope Coil Units—018, 024, 030, 036           |
|    |   | KFADC0401ACL        | A–Coil Units—042, 048, 060                    |
| 4. | Downflow/Horizontal Conversion Gasket Kit   | KFAHD0101SLP        | All   |
| 5. | Horizontal Water Management Kit (25 pack) ‡ | KFAHC0125AAA        | All   |
| 6. | Single–Point Wiring Kit                     | KFASP0101SPK        | Only with 15– and 20–kW Fused Heaters         |
| 7. | Filter Kit (12 Pack)                        | KFAFK0112SML        | 018   |
|    |   | KFAFK0212MED        | 024, 030                                      |
|    |   | KFAFK0312LRG        | 036, 042, 048                                 |
|    |   | KFAFK0412XXL        | 060   |
| 8. | PVC Condensate Trap Kit (50 pack)           | KFAET0150ETK        | All   |
| 9. | Air Cleaner 240–volt Conversion Kit         | KEAVC0201240        | All   |

\* Factory authorized and listed, field–installed.

† KFAHD0101SLP must also be purchased for downflow applications.

‡ KFAHC0125AAA must also be purchased for downflow or horizontal applications.

### Accessory Kits Description Suggested and Required Use

#### 1. Disconnect Kit

The kit is used to disconnect electrical power to the fan coil so service or maintenance may be performed safely.

SUGGESTED USE: Units for 3– through 10–kW electric resistance heaters and cooling controls.

#### 2. Downflow Base Kit

This kit is designed to provide a 1-in. minimum clearance between unit discharge plenum, ductwork, and combustible materials. It also provides a gap–free seal with the floor.

REQUIRED USE: This kit must be used whenever fan coils are used in downflow applications.

#### 3. Downflow Conversion Kit

Fan coils are shipped from the factory for upflow or horizontal–left applications. Downflow conversion kits provide proper condensate water drainage and support for the coil when used in downflow applications. Separate kits are available for slope coils and A–coils.

REQUIRED USE: This kit must be used whenever fan coils are used in downflow applications.

#### 4. Downflow/Horizontal Conversion Gasket Kit

This kit provides the proper gasketing of units when applied in either a downflow or horizontal application.

REQUIRED USE: Fan coils in either downflow or horizontal applications.

#### 5. Horizontal Applications – Water Management Kit

This kit provides proper installation of fan coils under conditions of high static pressure and high relative humidity.

SUGGESTED USE: All fan coils.

#### 6. Single Point Wiring Kit

The single point wiring kit acts as a jumper between L1 and L3 lugs, and between the L2 and L4 lugs. This allows the installer to run two heavy–gauge, high–voltage wires into the fan coil rather than 4 light–gauge, high–voltage wires.

SUGGESTED USE: Fan coils with 15– and 20–kW fused heaters only.

#### 7. Filter Kit (12 pack)

The kit consists of 12 fan coil framed filters. These filters collect large dust particles from the return air entering the fan coil and prevents them from collecting on the coil. This process helps to keep the coil clean, which increases heat transfer and, in turn, the efficiency of the system.

SUGGESTED USE: To replace filters in fan coils.

REQUIRED USE: All units unless a filter grille is used.

#### 8. Condensate Drain Trap Kit

This kit consists of 50 PVC condensate traps. Each trap is pre–formed and ready for field installation. This deep trap helps the system make and hold proper condensate flow even during blower initiation.

SUGGESTED USE: All fan coils.

#### 9. Air Cleaner 240–volt Conversion Kit

The AIRA electronic air cleaner comes ready for 115–v operation.

REQUIRED USE: This kit is required when running 240–volt circuit to air cleaner.

