

BELOW GROUND TANKS
 ALL suction lines must NEVER slope down and then back up again (Air Trap).

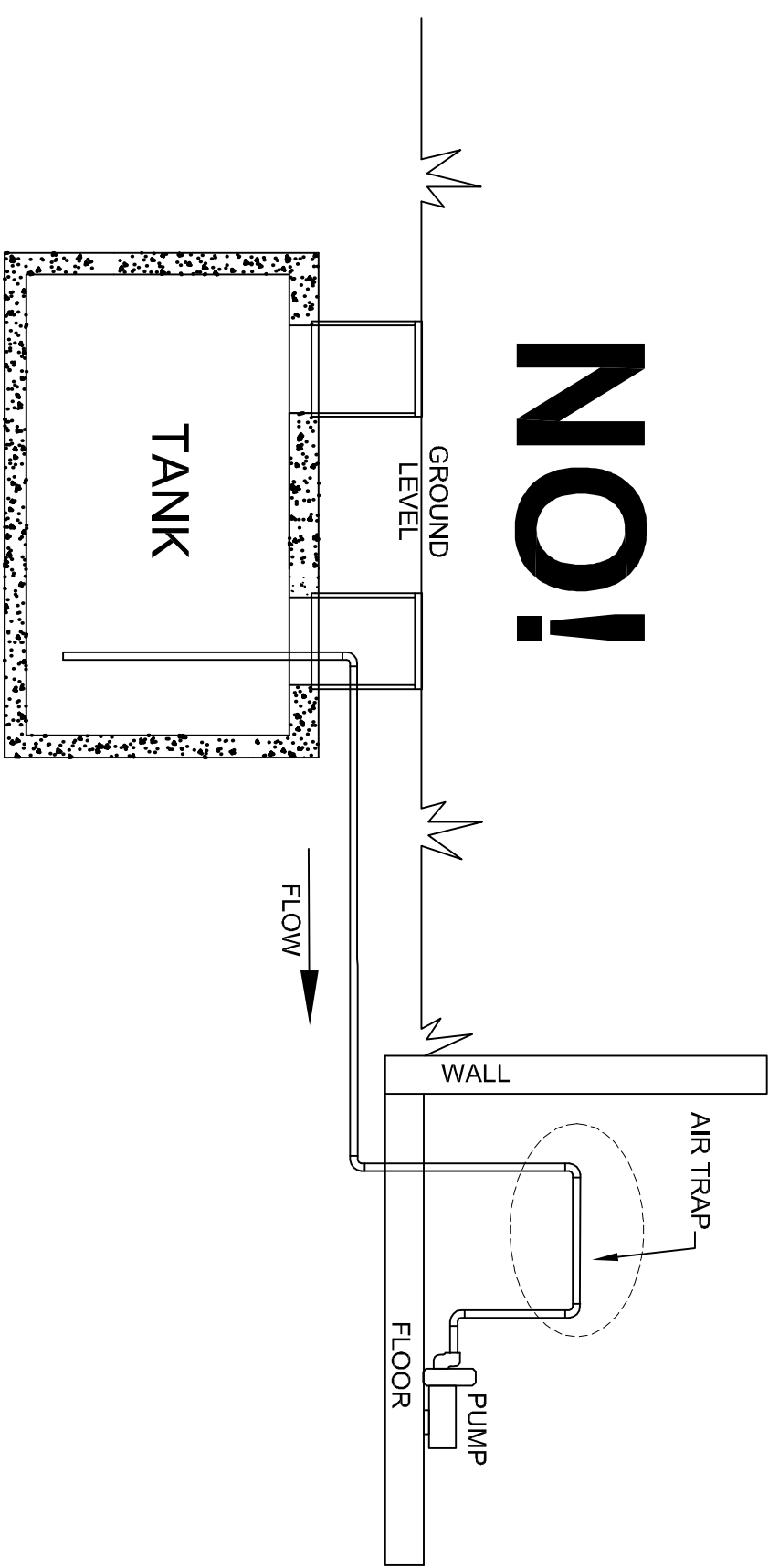

BELOW GROUND TANKS
 ALL suction lines must NEVER slope up and then back down again (Air Trap).
 ANY QUESTIONS CONTACT SONNY'S

NOTE:
 FIELD VERIFY ALL PLUMBING REQUIREMENTS WITH CARWASH MFG.

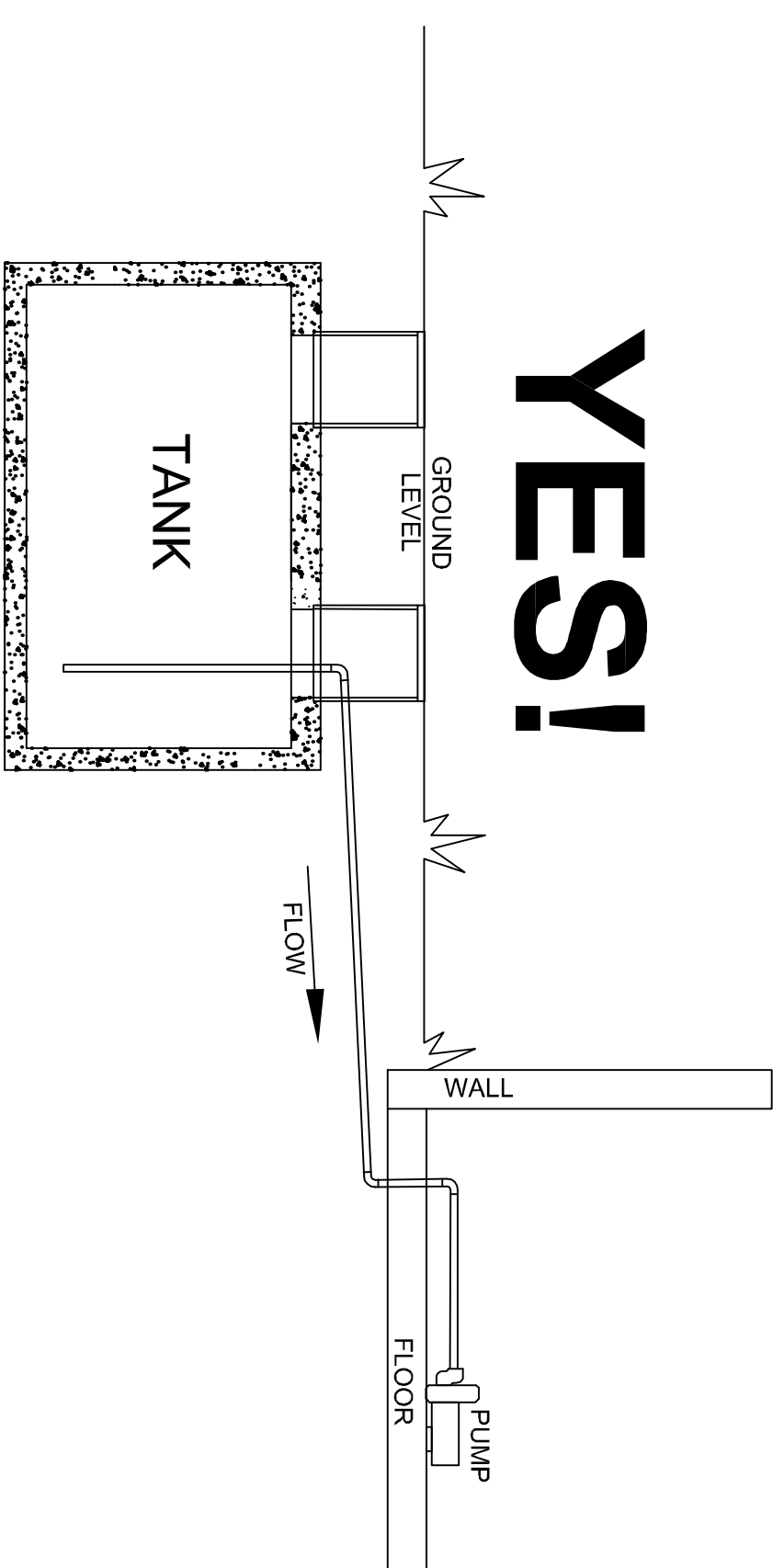
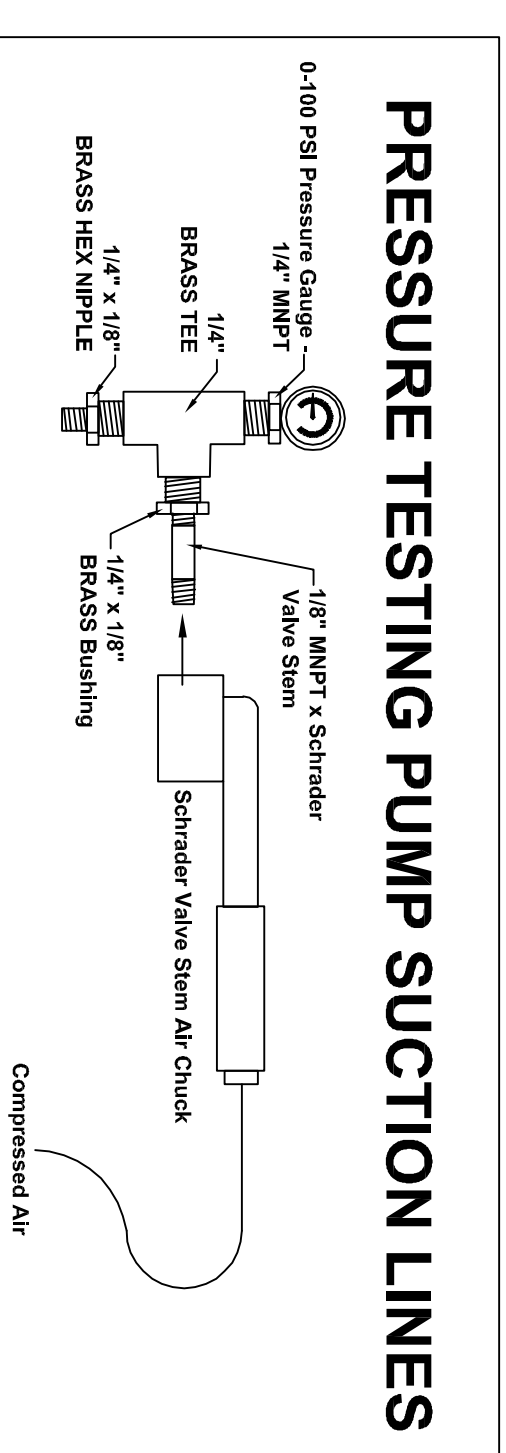
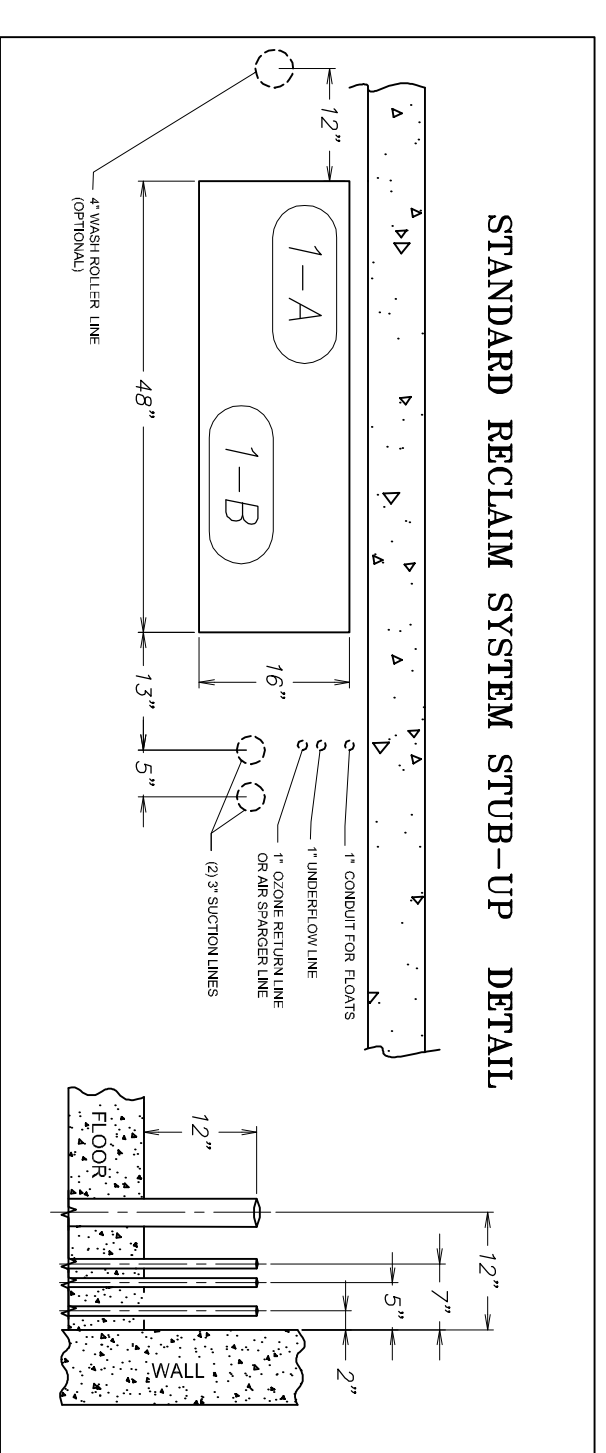

BELOW GROUND TANKS
 ALL suction lines require a continuous upward slope to the Equipment Room.

YES!

RAINFOREST CARWASH

5026 HARDY ST.
 HATTIESBURG, MISSISSIPPI

JOB No: 2176 DATE: 06-28-2013
 DRAWN BY: JCT CHECKED BY: CD

The above drawings and specifications, design and materials represented hereby are and shall remain the property of Dammon Engineering, and no part thereof shall be copied, disclosed to others, or used in connection with any work or project other than the specific project for which they have been prepared and approved without written consent of Dammon Engineering. Visual contact with these drawings or specifications shall constitute conclusive evidence of acceptance of these restrictions.

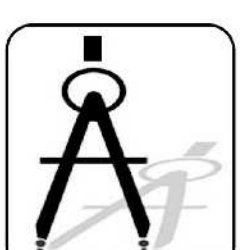

DAMMON
 ENGINEERING, INC.

CHIEF ENGINEER, EMMETT DAMMON, P.E.
 554 OLD SPANISH TRAIL
 SLIDELL, LA 70458

dammonengincnna.com
 dammoneng@bellsouth.net
 PHONE: 985-649-5832
 FAX: 985-641-5960

| REVISIONS | | |
|-----------|-----------------|----------|
| # | DESCRIPTION | DATE |
| A | ADDED RESTROOMS | 07-19-13 |
| | | |
| | | |
| | | |
| | | |
| | | |

CARWASH
 TANK
 PUMP
 DETAILS

SHEET No: 22 OF 22

P-3