

# BUILDING CODE INFORMATION

**BUILDING CODE**  
 IBC (INTERNATIONAL BUILDING CODE) 2009  
 OCCUPANCY TYPE OF GROUP(S) (IBC 2009 CHAPTER 3):  
 MERCANTILE (M)  
 CONSTRUCTION TYPE(S):  
 VB - 8,000 S.F. GROSS  
 MAXIMUM AREA (S.F.):  
 MERCANTILE (M) 9,000 S.F.  
 REQUIRED SEPARATION OF OCCUPANCIES (TABLE 508.2.5):  
 N/A  
 MAXIMUM AREA OF EXTERIOR WALL OPENINGS:  
 UNLIMITED  
 OCCUPANT LOAD CALCULATIONS BY OCCUPANCY:  
 MERCANTILE (M) TOTAL = 267  
 EXIT REQUIREMENTS:  
 FIRST FLOOR - 2 EXITS  
 MAXIMUM EXIT ACCESS TRAVEL DISTANCE (TABLE 1016.1):  
 M - 200'  
 MINIMUM CORRIDOR WIDTH (SECTION 1018.1 & SECTION 1005.1):  
 44"  
 MAXIMUM DEAD END CORRIDOR (SECTION 1018.4):  
 50'  
 MAXIMUM COMMON PATH OF TRAVEL (1014.3):  
 M - 75'  
 FIRE RESISTANCE RATING REQUIREMENTS FOR BLDG. ELEMENTS: (TBL 601)  
 STRUCTURAL FRAME = 0 HRS.  
 BEARING WALLS (INTERIOR AND EXTERIOR) = 0 HRS.  
 NON-BEARING WALLS = 0 HRS.  
 FLOOR CONSTRUCTION = 0 HRS.  
 ROOF CONSTRUCTION = 0 HRS.  
 FIRE ALARM SYSTEM REQUIREMENTS: (SEC 907)  
 THIS BLDG. DOES NOT REQUIRE A FIRE ALARM SYSTEM  
 FIRE PROTECTION SYSTEM REQUIREMENTS: (SEC 903)  
 THIS BLDG. REQUIRES A FIRE PROTECTION SYSTEM IN ACCORDANCE WITH SEC 903.2.9

# LIFE-SAFETY INFORMATION

**LIFE SAFETY CODE:**  
 NFPA 101 LIFE SAFETY CODE 2009  
 OCCUPANCY:  
 MERCANTILE 8,000 S.F.  
 REQUIRED SEPARATION:  
 N/A  
 CLASSIFICATION OF HAZARD OF CONTENTS:  
 N/A  
 OCCUPANT LOAD CALCULATIONS BY OCCUPANCY:  
 MERCANTILE TOTAL = 237  
 MEANS OF EGRESS:  
 NUMBER OF EXITS - M-2  
 MINIMUM EXIT SEPARATION DISTANCE FOR REMOTELY LOCATED EXITS  
 1/3 DIAGONAL - 20'-0" & 28'-8"  
 MAXIMUM DEAD-END CORRIDOR TRAVEL DISTANCE: 50'-0"  
 MAXIMUM COMMON PATH OF TRAVEL DISTANCE: M - 75'  
 MAXIMUM TRAVEL DISTANCE TO EXITS: M - 150'  
 STAIR WIDTH REQUIREMENTS: 44"  
 HORIZONTAL EXIT:  
 NONE  
 EXTINGUISHMENT REQUIREMENTS:  
 SPRINKLER (NOT REQUIRED)  
 SUBDIVISION OF BUILDING SPACE:  
 NONE  
 DETECTION/ALARM:  
 NONE  
 EXIT REQUIREMENTS:  
 2 EXITS  
 MAXIMUM EXIT ACCESS TRAVEL DISTANCE (TABLE 1016.1):  
 M - 200'  
 MINIMUM CORRIDOR WIDTH (SECTION 1018.1 & SECTION 1005.1):  
 44"  
 MAXIMUM DEAD END CORRIDOR (SECTION 1018.4):  
 20'  
 MAXIMUM COMMON PATH OF TRAVEL (1014.3):  
 M - 75'

# LEGEND

- SYMBOLS**
- ➔ EXITS
  - (45) DOOR FIRE RATING (MINUTES)
  - 34/170 DOOR WIDTH/EGRESS CAPACITY
  - ⊗ EXIT LIGHT
  - FE FIRE EXTINGUISHER CABINET
  - FE FIRE EXTINGUISHER W/ WALL MOUNTED BRACKET
  - COMMON PATH OF TRAVEL/TRAVEL DISTANCE
  - TRAVEL DISTANCE
  - DECISION POINT

**DAMMON ENGINEERING, INC.**  
*Architects & Engineers*

ADMINISTRATIVE: CON  
 dammoneng@bellsouth.net  
 PHONE: 985-649-5432  
 FAX: 985-641-5950

CHIEF ENGINEER: DAMON DAMMON, P.E.  
 CHIEF ARCHITECT: KEVIN KITCHEN, NCARB  
 554 OLD SPANISH TRAIL  
 SUITE 100, LA 70455

NEW COMMERCIAL BUILDING  
**DR. FARHAD ADULI**  
 LOT 288 MARGOLD DRIVE  
 COVINGTON, LA

JOB No: 2178 DATE: 09-03-2013  
 DRAWN BY: KJK CHECKED BY: KJK

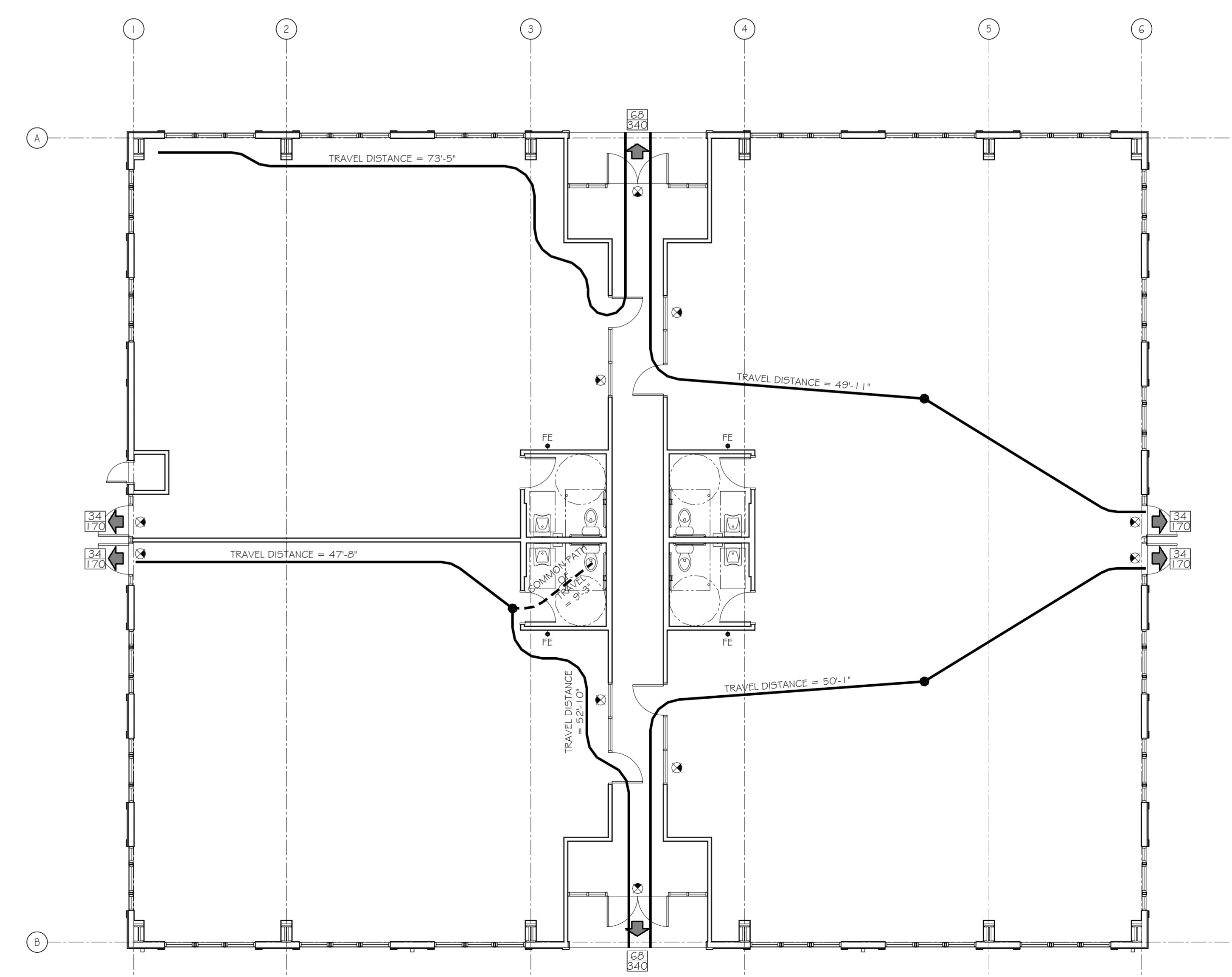

**LIFE-SAFETY PLAN**  
 SCALE: 1/8" = 1'-0"

#	DESCRIPTION	REVISIONS	DATE

# LIFE-SAFETY PLANS

SHEET No: 3 of 22

**G2**