

FILE NAME: J:\Projects\2022\12 - Welcome Center\1206 - Welcome Center\1206.dwg DATE: 04/11/2022 8:38:34 AM

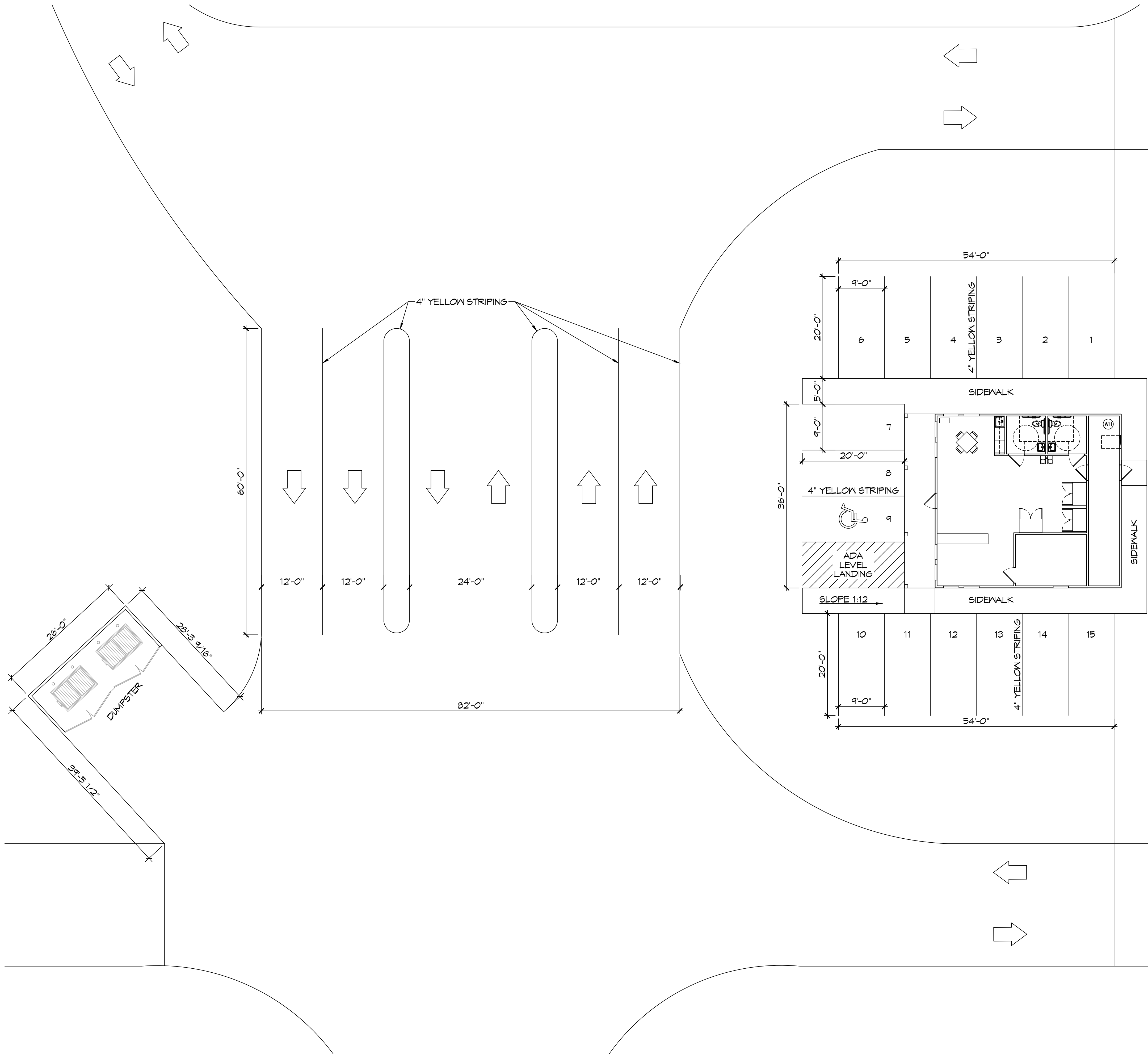

**PARKING**  
1 - WELCOME OFFICE 1,400 SQ. FT. WITH 15 PARKING PLACES

**DAMMON ENGINEERING, INC.**  
LOUISIANA & MISSISSIPPI

Chief Engineer: Brian Watch, PE  
www.dammonengineering.com  
554 Old Spanish Trail  
Sibley, LA 70468  
info@dammonengineering.com  
PH: 985.649.9832

#	DESCRIPTION	DATE



NEW RECREATIONAL RV SITE  
**EXIT 1 R.V. RESORT, LLC.**

CLYDE WEITZER ROAD  
NICHOLSON MS 39555  
JOB No: 2456 DATE: 04-11-2022  
DRAWN BY: BAW CHECKED BY: CKD

SHEET TITLE:  
WELCOME CENTER  
PARKING PLAN

DRAWING NUMBER:  
**C106**

SHEET No: 8 of 14

**12 WELCOME CENTER PARKING PLAN**  
SCALE: 1" = 10'-0"