

### LIFE-SAFETY INFORMATION

<b>APPLICABLE CODES</b>	
NFPA 101 LIFE-SAFETY CODE 2015	
OCCUPANCY TYPE(S) AND CHAPTER(S)	
ASSEMBLY (CHAPTER 12)	
<b>OCCUPANT LOAD FACTOR</b>	(REFERENCE TABLE 7.3.1.2)
ASSEMBLY (Concentrated use, without fixed seating)	7 NET / PERSON 2074 S.F. / 7 S.F. / PERSON = 241 OCCUPANTS
<b>CLASSIFICATION OF HAZARD OF CONTENTS</b>	
(REFERENCE: OCCUPANCY CHAPTER AND 6.2.2; SPECIFY LOW, ORDINARY, OR HIGH)	
CONST. TYPE = B(200) (REFERENCE: CHAPTERS, TABLE A.8.2.1.2 AND COMMENTARY TABLE 8.1 IN HANDBOOK)	
MINIMUM EXIT SEPARATION DISTANCE FOR REMOTELY LOCATED EXITS	
(REFERENCE: SECTION 7.5; SPECIFY 1/2 OR 1/3 DIAGONAL DISTANCE OF AREA SERVED)	
1/3 DIAGONAL =	107 FT / 3 = 35.6 FT
<b>MAXIMUM DEAD-END CORRIDORS</b>	(REFERENCE: OCCUPANCY CHAPTER AND TABLE A.7.6)
20 FEET	
<b>MAXIMUM COMMON PATH OF TRAVEL DISTANCE</b>	(REFERENCE: OCCUPANCY CHAPTER AND TABLE A.7.6)
20 FEET	
<b>MAXIMUM TRAVEL DISTANCE TO EXITS</b>	(REFERENCE: OCCUPANCY CHAPTER AND TABLE A.7.6)
250 FEET	
*MAIN ENTRANCE MUST BE SIGNED TO ACCOMMODATE 1/2 OCCUPANT LOAD OF BUILDING	
<b>EXTINGUISHMENT REQUIREMENTS</b>	THIS BUILDING IS FULLY SPRINKLERED
<b>DETECTION, ALARM, AND COMMUNICATION SYSTEMS</b>	MONITORED FIRE ALARM SYSTEM
<b>ALLOWABLE HEIGHT AND BUILDING AREA</b>	PER IBC EQUIVALENT CONSTRUCTION TYPE

### BUILDING CODE INFORMATION

<b>APPLICABLE CODES</b>	
IBC 2015	
<b>ASSEMBLY GROUP A2 &amp; A5</b>	(IBC 2015 CHAPTER 10)
<b>OCCUPANT LOAD CALCULATIONS</b>	(TABLE 1004.1.2)
ASSEMBLY A-3 (CONSECRATED NON-FIXED SEATING) = 7 S.F. NET / PERSON	2074 S.F. / 7 S.F. / PERSON = 241 OCCUPANTS
<b>TOTAL OCCUPANTS</b>	241 OCCUPANTS
<b>CONSTRUCTION TYPE(S)</b>	3 B (SECTION 602)
<b>ALLOWABLE HEIGHT AND BUILDING AREA LIMITED BY TYPE OF CONSTRUCTION</b>	
MAXIMUM HEIGHT IN STORIES (SECTION 503 & 504, TABLE 504.4)	2
MAXIMUM AREA IN SQUARE FEET (SECTION 503, 506 & 507, TABLE 506.2)	39,000 SF
ACTUAL BUILDING FIRE AREA IN SQUARE FEET	18,000 SF

### WIND SPEED DESIGN REQUIREMENTS

IMPROVEMENTS TO THIS BUILDING SHALL BE DESIGNED WITH IBC SEC 1609 AS A FULLY ENCLOSED BLDG USING THE FOLLOWING INFORMATION:

WIND DESIGN DATA: DETERMINATION OF WIND LOADS SHALL BE IN ACCORDANCE WITH IBC SEC 1609.3 (A), (B), OR (C) DEPENDING ON THE RISK CATEGORY			
ULTIMATE WIND SPEED =	142 MPH (IBC FIG 1609C)	NOMINAL WIND SPEED =	V <sub>ref</sub> = 110 MPH
RISK FACTOR:	CATEGORY II	SURFACE ROUGHNESS =	B
TOPOGRAPHIC FACTOR =	1	EXPOSURE =	B
INTERNAL PRESSURE COEFFICIENT (ASCE 7-10 TABLE 26.11-1): ± 0.18			
<b>LIVE LOADS (IBC SEC 1607)</b>			
ASSEMBLY MOVEABLE SEATING (IBC TABLE 1607.1):	100 PSF		
PLATFORMS (ASSEMBLY) (IBC TABLE 1607.1):	100 PSF		
LOBBIES (IBC TABLE 1607.1):	100 PSF		
CLASSROOMS (IBC TABLE 1607.1):	40 PSF UNIFORM, 1,000 LB CONCENTRATED		
ROOF LIVE LOADS (IBC TABLE 1607.1):	20 PSF UNIFORM, 300 LB CONCENTRATED		
SNOW LOADS (IBC TABLE 1608):			
GROUND SNOW LOAD (IBC FIG 1608.2):	5 PSF		

### FLOOD ZONE INFORMATION

BASED ON THE LSU FLOOD MAP PROPERTY IS IN ZONE AE, EL. 19 BASE FLOOD.

FLOOD ZONE:	AE	BASE FLOOD ELEVATION:	19.0'
FIRM, COMMUNITY NUMBER 2201C0695F	DATE: 04/30/2008		

### LIFE-SAFETY LEGEND

SYMBOL	DESCRIPTION
	EXITS
	DOOR FIRE RATING (MINUTES)
	DOOR WIDTH/EGRESS CAPACITY
	EXIT LIGHT
	FIRE EXTINGUISHER W/ WALL MTD BRACKET
	COMMON PATH OF TRAVEL
	TRAVEL DISTANCE
	DECISION POINT

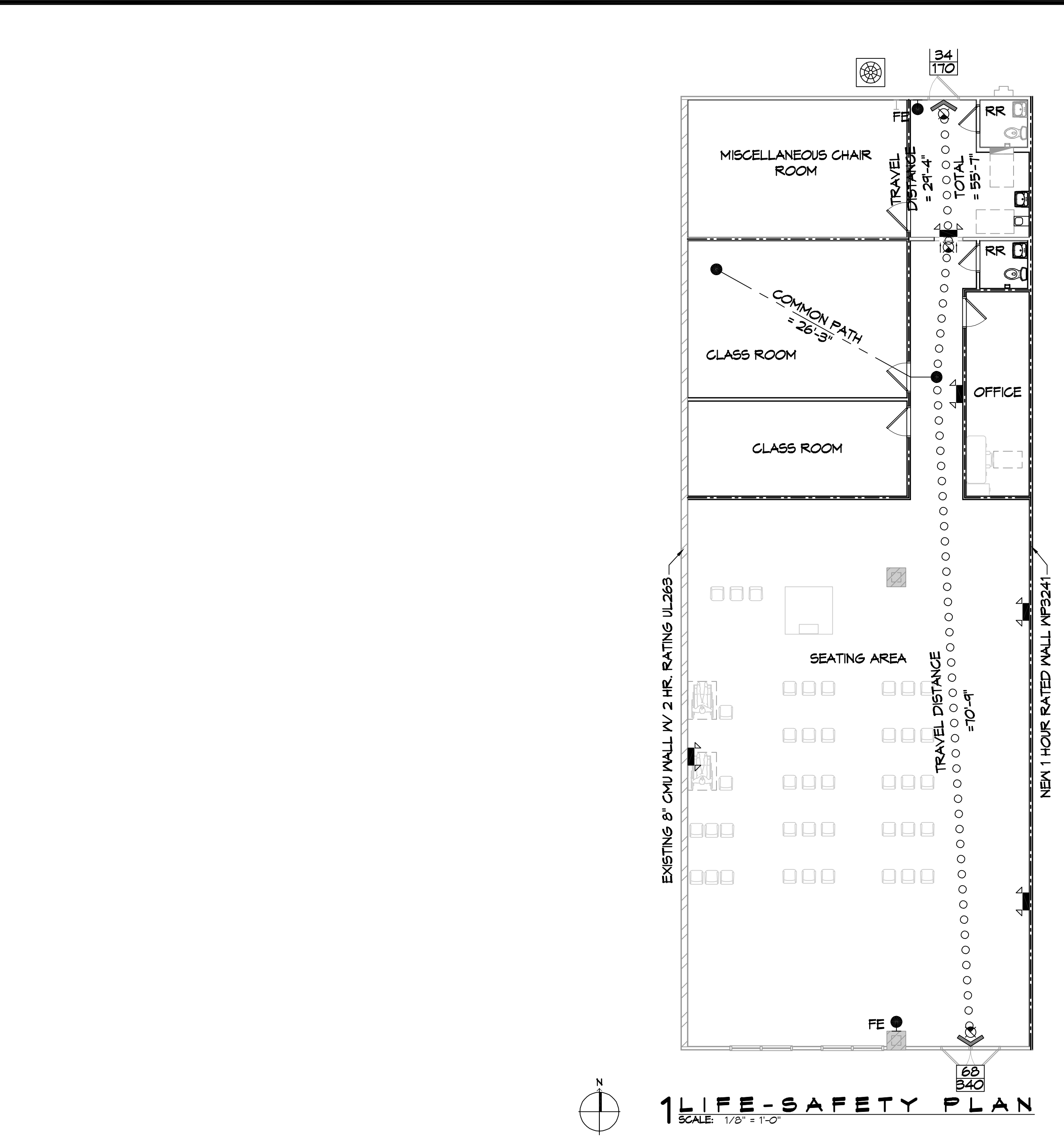

**BUILDING INFORMATION:**  
TOTAL S.F. = 87,583 S.F.  
SPRINKLED = YES  
ALARMED = YES

**FIRE AREA INFORMATION:**  
2 HR CMU FIREWALL AREA = 18,000 S.F.

**SUITE INFORMATION:**  
TOTAL SUITE = 3,800 S.F.  
WORSHIP AREA = 2,079 S.F.  
NEITHER CLASSROOMS NOR MISCELLANEOUS ROOM WILL BE OCCUPIED WHILE WORSHIP SERVICE IS BEING HELD.

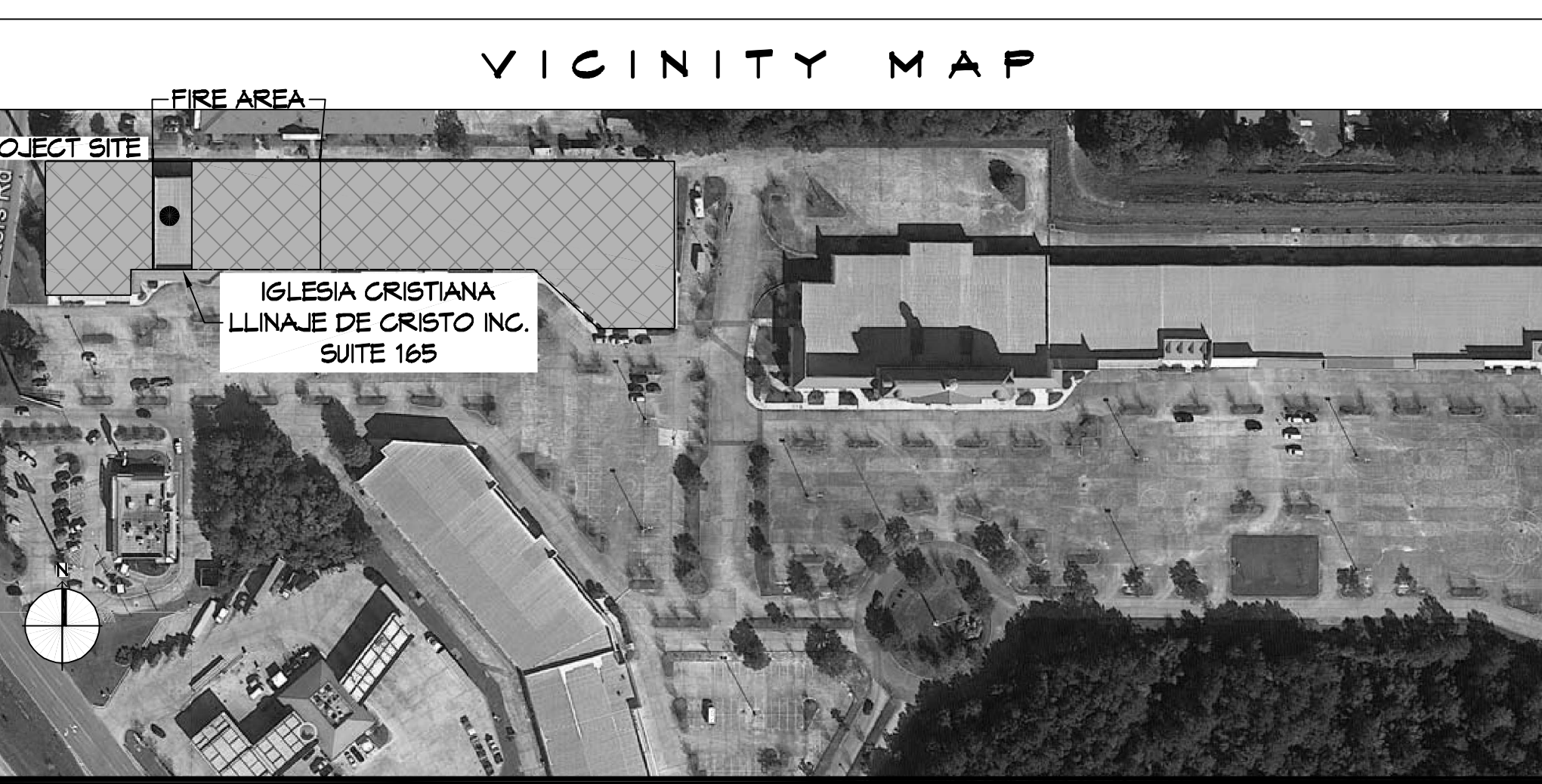

### SHEET INDEX

SHEET #	SHEET TITLE
G101	GENERAL INFORMATION SHEET
C101	SITE PLAN
A101	FLOOR AND REFLECTED CEILING PLAN
PM101	PLUMBING AND MECHANICAL PLAN
E101	POWER AND LIGHTING PLAN

- ### GENERAL NOTES
- ALL MATERIALS AND WORK, INCIDENTAL TO THE CONSTRUCTION OF THIS PROJECT, SHALL CONFORM TO ALL GOVERNING CODES, AND REGULATIONS OF AGENCIES IN AUTHORITY.
  - CONTRACTOR SHALL PROVIDE ALL PUBLIC PROTECTIONS NECESSARY AS REQUIRED BY LAW.
  - THE DRAWINGS, SPECIFICATIONS AND ANY SUBSEQUENTLY ISSUED ADDENDA, AMENDMENTS OR SUCH CHANGE ORDERS APPROVED BY THE OWNER AND THE CONTRACTOR ARE PART OF THESE CONTRACT DOCUMENTS.
  - DO NOT SCALE DRAWINGS. CONSULT WITH THE ARCHITECT REGARDING ANY ITEMS IN THE CONTRACT DOCUMENTS THAT REQUIRE CLARIFICATION.
  - TRASH SHALL BE REMOVED FROM THE SITE NOT LESS THAN TWICE MONTHLY.
  - THE GENERAL CONTRACTOR SHALL VERIFY EXISTING CONDITIONS PRIOR TO COMMENCING WORK AND REPORT ANY AND ALL DISCREPANCIES TO THE ARCHITECT.
  - CONTRACTOR VEHICLES AND EQUIPMENT NECESSARY FOR CONSTRUCTION MAY BE PARKED ON THE SITE. OTHER VEHICLES PARKED ON THE SITE REQUIRE THE OWNER'S PERMISSION.
  - NAMING A CERTAIN BRAND, MAKE OR MANUFACTURER IS TO DESIGNATE THE GENERAL STYLE, TYPE, CHARACTER AND QUALITY STANDARD OF THE PRODUCT DESIRED. SUBSTITUTION REQUESTS MUST BE SUBMITTED PRIOR TO BIDDING.
  - ALL MATERIALS/EQUIPMENT SHALL BE INSTALLED PER MANUFACTURER'S RECOMMENDATIONS. WORK NOT CONSISTENT WITH MANUFACTURER'S RECOMMENDATIONS WILL BE REJECTED BY OWNER/ARCHITECT.

# DAMMON

## ENGINEERING, INC.

LOUISIANA & MISSISSIPPI

www.dammonengineering.com  
info@dammonengineering.com  
PH: 985.649.5832 F: 985.641.5950

Chief Engineer: Brian Mistic, PE  
554 Old Spanish Trail  
Slidell, LA 70458

# DESCRIPTION	DATE

## LESIA CRISTIANO

## LAJE DE CRISTO

1000 CARUSO BLVD.  
BUILDING 1 UNIT 165  
SLIDELL, LA 70461

JOB No: 2454 DATE: 12/09/2021  
RJD CHECKED BY: JMS  
DRAWN BY: JMS

# 001

SHEET No: 1 of 5