

GENERAL NOTES: DEMOLITION PLANS

1. FIELD VERIFY ALL DIMENSIONS
2. ALL WORK TO BE PERFORMED IN ACCORDANCE WITH ALL APPLICABLE BUILDING CODES.
3. AT AREAS OF DEMOLITION REPAIR ALL EXISTING CONSTRUCTION TO REMAIN

SYMBOLS: DEMOLITION PLANS

- ==== REMOVE EXISTING CONSTRUCTION
- EXISTING PARTITION TO REMAIN
- ⌒ REMOVE EXISTING DOOR
- ⌒ EXISTING DOOR TO REMAIN

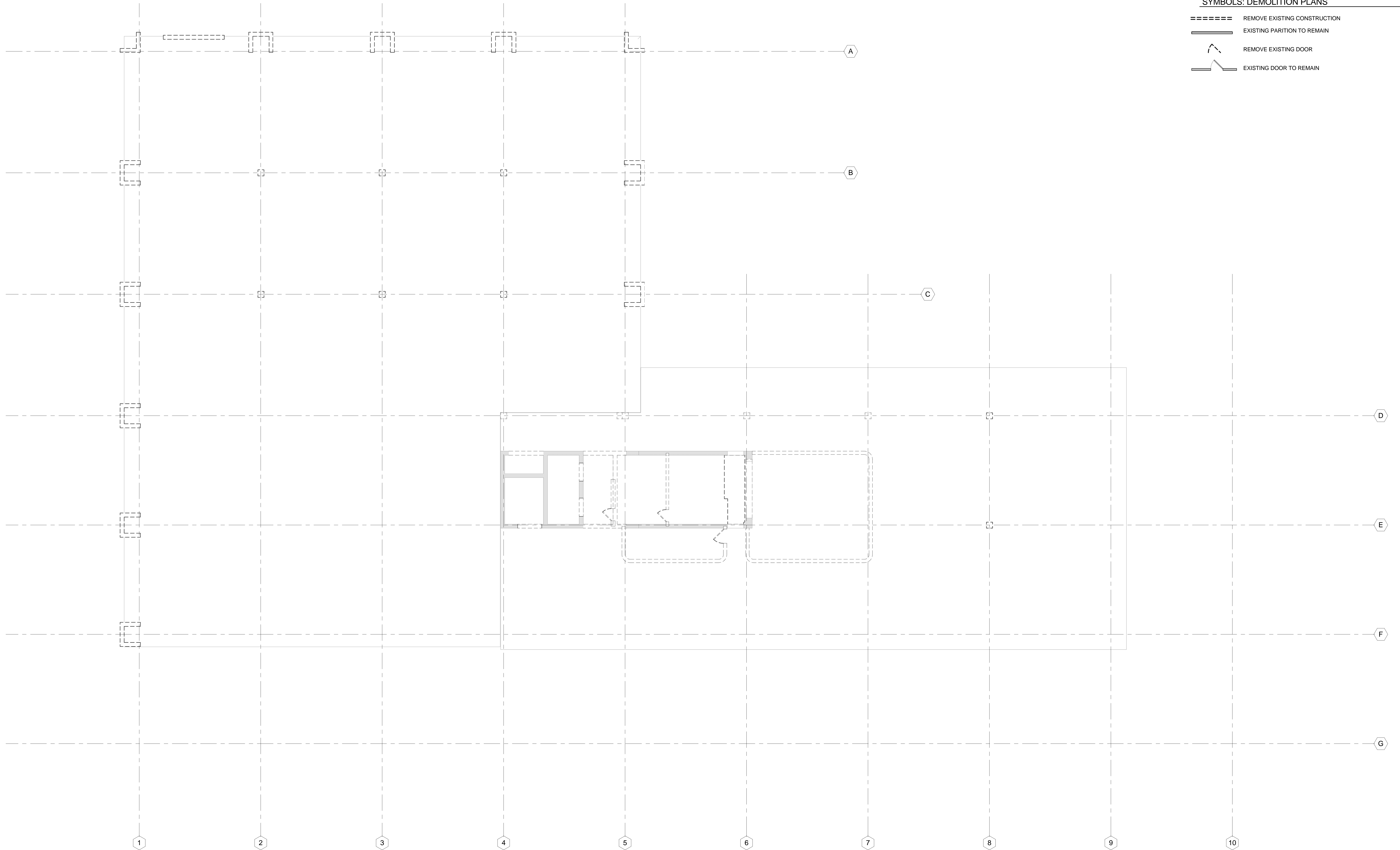

1 600 LEVEL DEMOLITION PLAN
DA2-6 1/8" = 1'-0" (REF: 8 / A6-1)

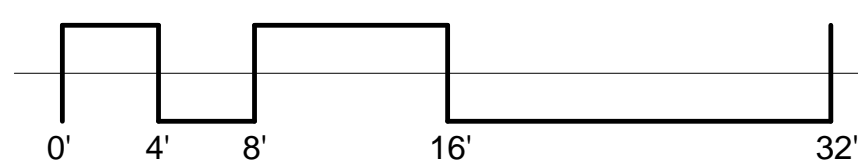

| No. | Date | Issue | No. | Date | Issue |
|-----|------------|-----------------------|-----|------|-------|
| 1 | 12.23.2010 | SD PRICING SET | | | |
| 2 | 01.18.2011 | 100% SD SET | | | |
| 3 | 09.15.2011 | 100% DD / PRICING SET | | | |

Holabird & Root / Holly & Smith LLC expressly disclaims any responsibility arising from any unauthorized use of these plans, drawings, and notes. Any authorization must be in writing.
This drawing copy may have been reproduced at a size different than originally drawn. The Owner and Architect assume no responsibility for use of incorrect scale. Drawings are not to be scaled.
Not published - All rights reserved.

HOLABIRD & ROOT | **HOLLY & SMITH LLC**
140 South Dearborn Avenue Suite 500 Chicago, IL 60660
312.357.1771 (tel) 312.357.1909 (fax) www.holabird.com
2302 Magazine Street New Orleans, LA 70130
985.345.5210 (tel) www.hollyandsmith.com

| | |
|------------------|----------|
| Project Number | 15248.00 |
| Drawn | Author |
| Checked | Checker |
| Proj. Arch./Eng. | Approver |



600 LEVEL DEMOLITION ROOF PLAN
Sheet Name
Drawing No. **DA2-6**