

vicinity map

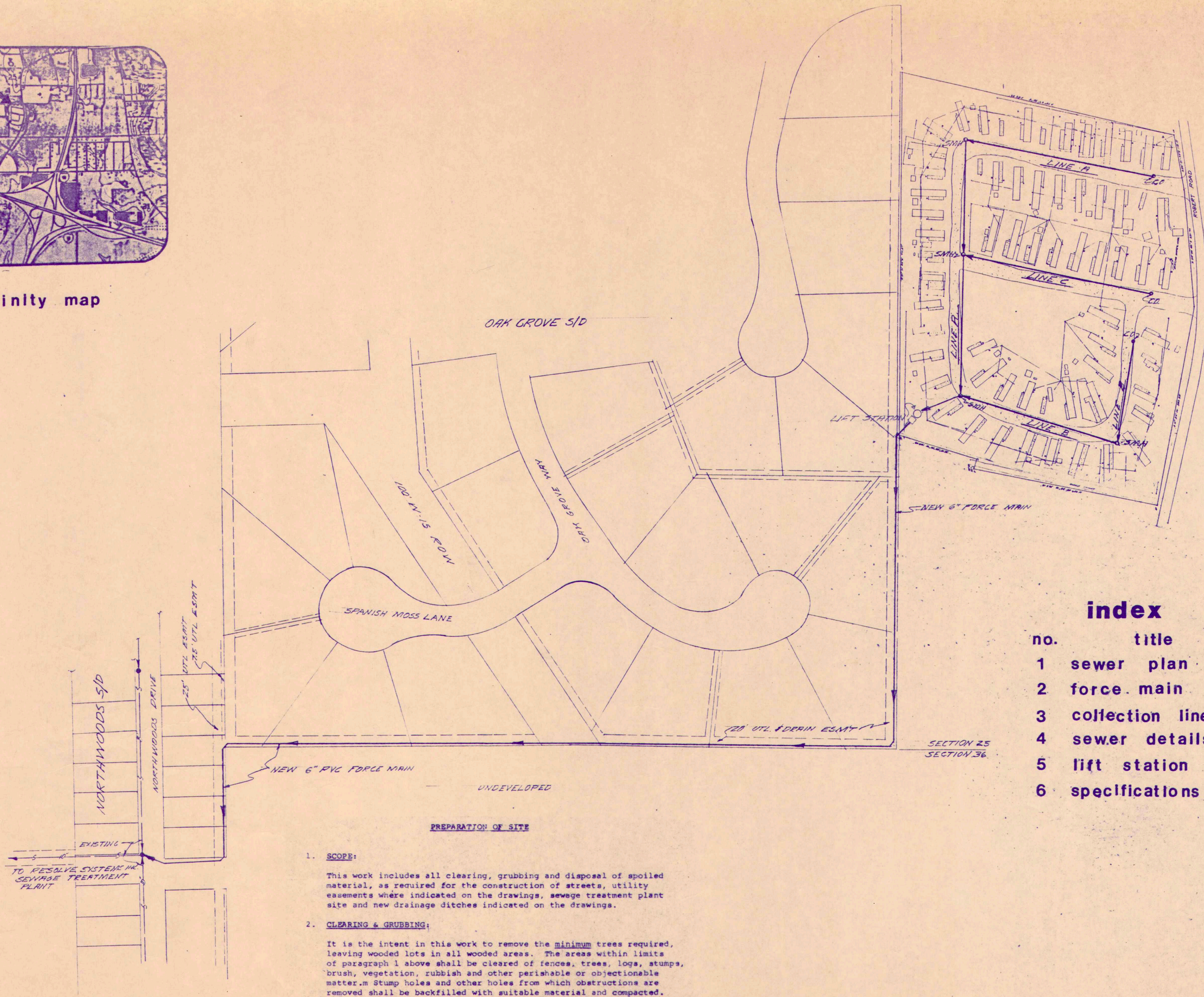

**index**

no.	title
1	sewer plan
2	force main
3	collection lines
4	sewer details
5	lift station
6	specifications

- 1. SCOPE:**  
This work includes all clearing, grubbing and disposal of spoiled material, as required for the construction of streets, utility easements where indicated on the drawings, sewage treatment plant site and new drainage ditches indicated on the drawings.
- 2. CLEARING & GRUBBING:**  
It is the intent in this work to remove the minimum trees required, leaving wooded lots in all wooded areas. The areas within limits of paragraph 1 above shall be cleared of fences, trees, logs, stumps, brush, vegetation, rubbish and other perishable or objectionable matter. Stump holes and other holes from which obstructions are removed shall be backfilled with suitable material and compacted.

APPROVED:  
  
 OWNER - DEBORAH B. RAINEY  
  
 UTILITY - RESOLVE SYSTEMS, INC.  
 DEPARTMENT OF HEALTH & HUMAN RESOURCES  
 STATE OF LOUISIANA

**sewer plan**

DATE	BY	DESCRIPTION OF REVISION	DATE	BY	DESCRIPTION OF REVISION

DATE: 2/28/85  
 DRAWN BY: R.S.  
 SCALE: Hor. 1" = 100'  
 Vert. 1" = 10'  
 JOB NO. 85-6

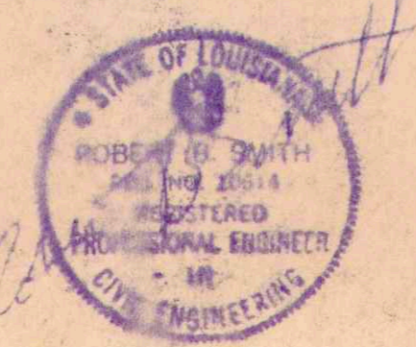

**SMITH & ASSOCIATES**  
 Consulting Engineers & Planners  
 122 chamale drive  
 slidell, la 70460 641-5432

country club  
 mobile home park  
 st. tammany parish louisiana