

CLASS 'A' TREE = 10-12' ht + 2-2 1/2" CALIPER
 CLASS 'B' TREE = 8-10' ht + 1-1 1/2" CALIPER
 SHRUBS = 2' TALL EVERGREEN

* SHOW PARKING + DRIVES
 DRIVES = 24-35' MAX WIDTH

PARKING = 9x18
 w/ 22' backing space
 + WHEEL STOPS

NEED (12) SPACES

SHOW TYPE/SPECIES OF TREES

EXAMPLE

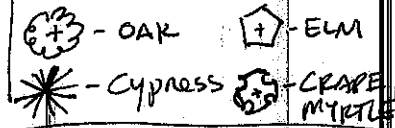

LAND DESCRIPTION

FROM THE CORNER COMMON TO SECTIONS 23, 24, 25 & 26, T 9 S - R 14 E 80 WEST 10', 007.23 FEET, SOUTH 8568.99 FEET AND S 26° 10' 48" W 994.20 FEET TO THE POINT OF BEGINNING.

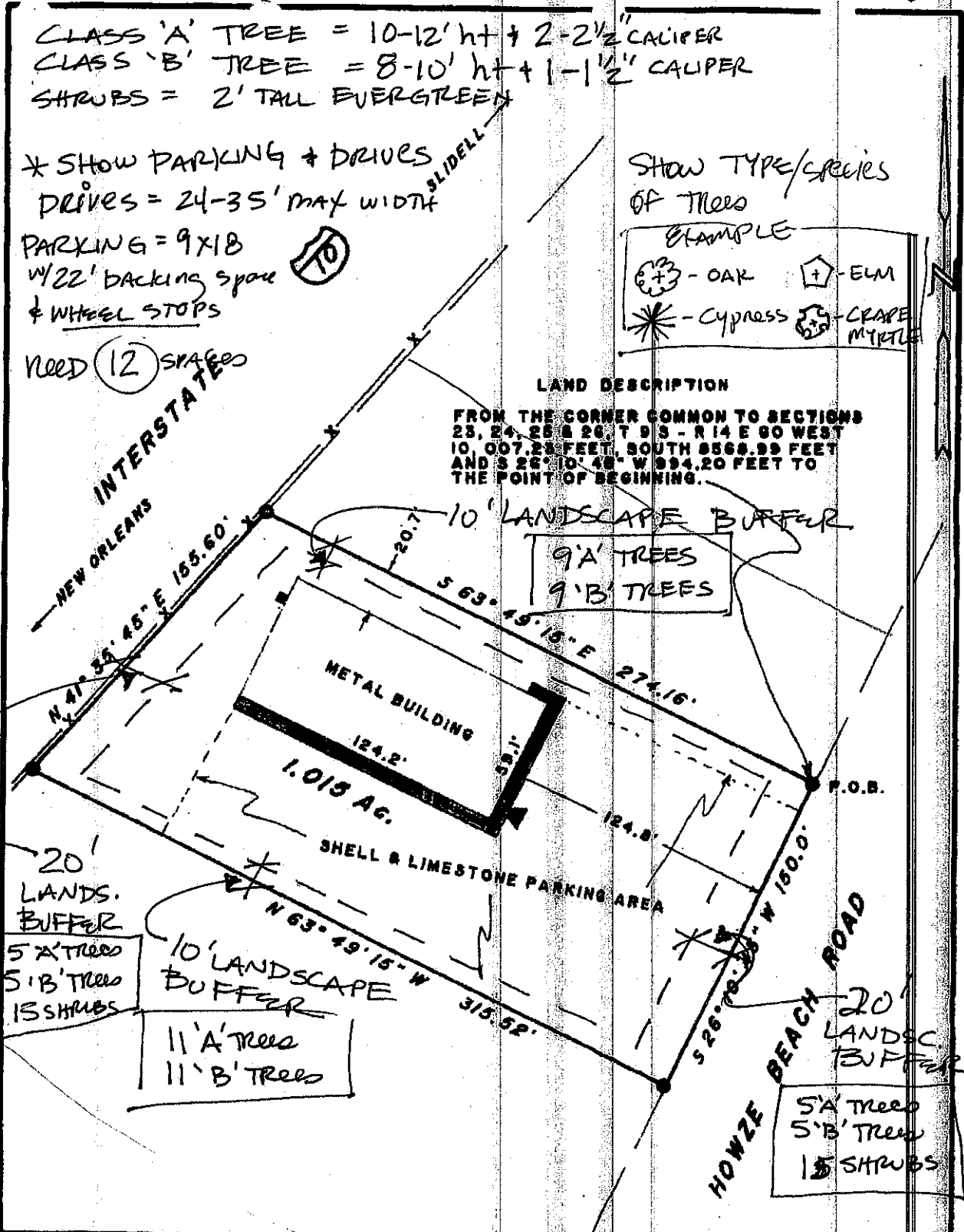

—X— EXISTING FENCE ■ PAVED AREA ● IRON ROD OR PIPE IN PLACE

THIS PLAT REPRESENTS AN ACTUAL ON - THE - GROUND SURVEY, AND NO ENCROACHMENTS EXIST ACROSS ANY PROPERTY LINES.

PRECISION SURVEYS
 EDWARD L. JONES - P.L.S.

PLAT OF SURVEY CERTIFIED CORRECT TO