

GENERAL NOTES (THIS SHEET ONLY):

- FOR PARTITION TAGS SEE PARTITION TYPES SHEET A707
- FOR DOOR, WINDOW, AND LOUVER TAGS SEE OPENING SCHEDULE SHEET A702
- FOR ADDITIONAL DIMENSIONS SEE DIMENSION PLAN 1/A204
- ALL COLUMNS ARE SHOWN AT LOCATION WHERE THEY MEET THE SLAB
- ALL WALLS, WINDOWS, DOORS, AND STAIRS ARE SHOWN AS CUT 3" ABOVE THE SLAB

SPECIFIC NOTES (THIS SHEET ONLY):

- | | | | |
|--|--|---|--|
| 1 HDCP RAMP | 8 PROVIDE LEVEL LANDING, MAX. SLOPE 1:50 IN ALL DIRECTIONS, W/ A 1/2" MAX. THRESHOLD HEIGHT AT ALL ENTRANCES AND EXITS. | 15 FLOOR DRAIN (RE: MECHANICAL DRAWINGS) | 22 PROXIMITY CARD READER (NIC) AT EXTERIOR SIDE OF DOOR. COORDINATE WITH OWNER VENDOR. |
| 2 HDCP ACCESSIBLE PARKING SPACE, MAXIMUM SLOPE 1:50 IN ALL DIRECTIONS | 9 CONCRETE COLUMN, TYPICAL (RE: STRUCTURAL DRAWINGS) | 16 ALUMINUM CURTAIN WALL SYSTEM, 8" DEEP FRAME, TYPICAL | 23 WALL MOUNTED DIRECTORY |
| 3 HDCP ACCESSIBLE SIGNAGE MOUNTED TO CMU WALL; SIGN BOTTOM SHALL BE MOUNTED @ 84" ABOVE THE PARKING SURFACE. | 10 STRUCTURAL STEEL COLUMN (RE: STRUCTURAL DRAWINGS); ONE-HOUR FIRE-PROTECTED W/ INTUMESCENT PAINT; SHOWN AT SLAB LOCATION. PROVIDE 2 PIECE ALUMINUM (CLEAR ANODIZED) COLUMN COVER FROM FLOOR TO CEILING | 17 8" Ø METAL DOWNSPOUT, COLOR TO MATCH METAL PANELS | 24 FLAGPOLES, 3 TOTAL; CENTER POLE TO BE 30 FEET ABOVE GRADE AND 2 ADDITIONAL POLES TO BE 25 FEET ABOVE GRADE (RE: STRUCTURAL DRAWINGS FOR FOUNDATION) |
| 4 *VAN ACCESSIBLE* HDCP AISLE, MAXIMUM SLOPE 1:50 IN ALL DIRECTIONS; PROVIDE 4" WIDE BLUE STRIPING OR AS REQUIRED BY LOCAL JURISDICTION. | 11 CONCRETE SIDEWALK 5'-0" (RE: CIVIL DRAWINGS); SLOPE AWAY FROM BUILDING 1:50 TYPICAL | 18 FUTURE LANDSCAPE AREA; NIC | 25 PROVIDE RIGID INSULATION BOARD AT INTERIOR SIDE OF ALL LOUVERS NOT DUCTED TO MECHANICAL EQUIPMENT (RE: MECHANICAL DRAWINGS) |
| 5 4"x4" PAINTED HDCP SYMBOL OF ACCESSIBILITY ON CONTRASTING BACKGROUND | 12 TRELIS FENCE | 19 CONCRETE SIDEWALK 11'-7" (RE: CIVIL DRAWINGS); SLOPE AWAY FROM BUILDING 1:50 TYPICAL | |
| 6 FIRE EXTINGUISHER AND CABINET | 13 PARKING SPACE STRIPING, TYPICAL; 4" WIDE | 20 NOMINAL 6" CMU WALL WITH ALUCCOMBOND ON EXTERIOR AND PAINTED INTERIOR | |
| 7 CONCRETE BUMPER, TYPICAL | 14 NO PARKING, STRIPED AREA; 4" WIDE | 21 PROVIDE RACEWAY FOR CONTROL ACCESS WIRE FOR PROXIMITY CARD READERS (NIC) AT INTERIOR AND EXTERIOR SIDES OF ENTRANCE DOORS IN MULLION OF CURTAIN WALL SYSTEM. COORDINATE WITH OWNER VENDOR. | |

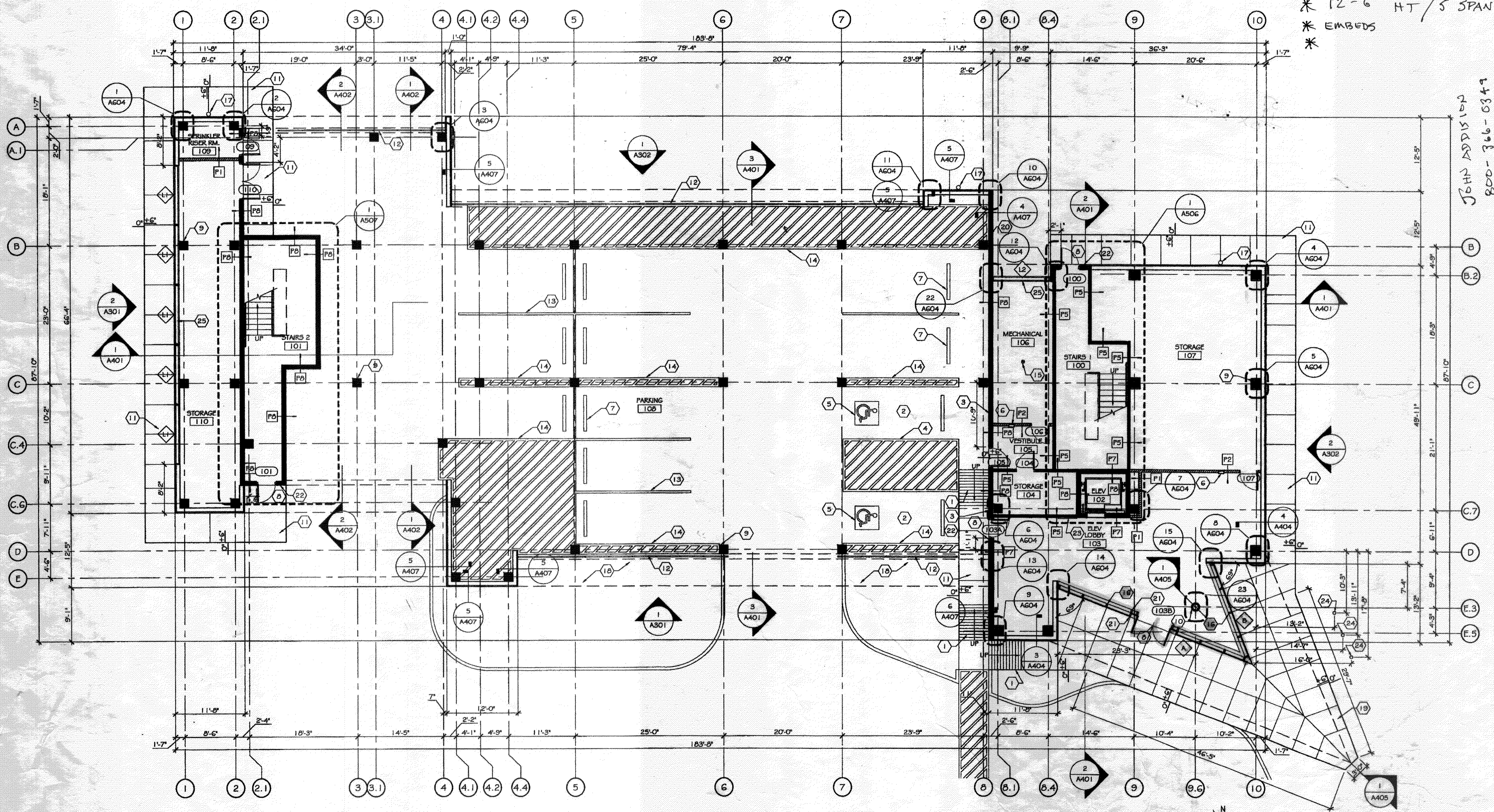
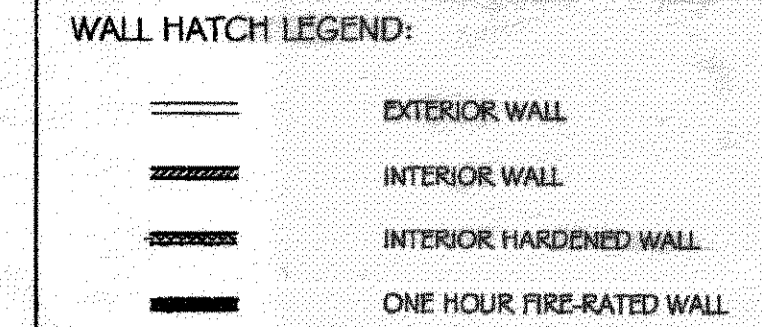

* 12'-6" HT / 5' SPAN
* EMBEDS
*

JOHN ADDISON
800-366-0349

1ST FLOOR PLAN
SCALE: 1/8" = 1'-0"



BID SET

project architect	BAS
architect by BAS	
checked by BAS	
With Project Number	108008.00
03-10-08	MS schematic design
04-07-08	MS design development
06-08-08	MS for bid
	for construction
AUGUST 8, 2008	