

LOT F, ARCADE NOS. 1 & 2
 SQUARE 126
 SECOND DISTRICT
 CITY OF NEW ORLEANS
 ORLEANS PARISH
 LOUISIANA

LEGEND			
---	EXIST. GUY WIRE	AC	EXIST. AC UNIT
---	EXIST. DRAIN LINE	RCP	REINFORCED CONC. PIPE
---	EXIST. CONC. AREA	CMP	CORRUGATED METAL PIPE
---	OVERHEAD UTILITY	EL.	ELEVATION
---	EXIST. BOUNDARY LINE	EXIST.	EXISTING
---	CONC.	SMH	SEWER MANHOLE
---	WATER METER	⊙	EXIST. SEWER MANHOLE
---	GAS METER	⊙	EXIST. DRAIN MANHOLE
---	GAS VALVE	⊙	EXIST. SIGN
---	WATER VALVE	⊙	EXIST. POWER OR TELEPHONE POLE
---	DENOTES PKNAIL FOUND	⊙	EXIST. TREE OR SHRUB
---	DENOTES IRON ROD FOUND	⊙	HOSE BIB
---	DENOTES 1/2" IRON ROD SET	⊙	LIGHT POLE
---	EXIST. UG ELECTRIC LINE	⊙	EXIST. DITCH
---	EXIST. UG TELEPHONE LINE	⊙	EXIST. MAILBOX
---	EXIST. GRAVITY SEWER LINE	⊙	EXIST. TRAFFIC LIGHT
---	EXIST. WATER LINE	⊙	EXIST. FIRE HYDRANT
---	EXIST. GAS LINE	⊙	EXIST. DROP INLET
---	EXIST. CHAIN LINK FENCE	⊙	EXIST. SEWER CLEAN OUT
		+	DENOTES CROSS CUT
		(D)	DEED
		(M)	MEASURED

- NOTES:
- THE LOCATIONS OF UNDERGROUND AND OTHER NONVISIBLE UTILITIES SHOWN HEREON HAVE BEEN PLOTTED BASED UPON DATA EITHER FURNISHED BY THE AGENCIES CONTROLLING SUCH DATA AND/OR OBTAINED FROM RECORDS MADE AVAILABLE TO US BY THE AGENCIES CONTROLLING SUCH RECORDS. WHERE FOUND, THE SURFACE FEATURES OF UTILITIES ARE SHOWN. THE ACTUAL NONVISIBLE LOCATIONS MAY VARY FROM THOSE SHOWN HEREON. EACH AGENCY SHOULD BE CONTACTED RELATIVE TO THE PRECISE LOCATION OF ITS UNDERGROUND INSTALLATIONS PRIOR TO ANY RELIANCE UPON THE ACCURACY OF SUCH LOCATIONS SHOWN HEREON. PRIOR TO EXCAVATION AND DIGGING CALL LA ONE CALL (1-800-272-3020).
 - THIS IS A CLASS B BOUNDARY SURVEY.
 - NO TITLE RESEARCH OR UTILITY SERVITUDE RESEARCH WAS PERFORMED BY THE SURVEYOR.
 - AS PER FLOOD INSURANCE RATE MAP, COMMUNITY-PANEL NUMBER 2252030160E, EFFECTIVE DATE MARCH 1, 1984: THE SITE IS IN ZONE A1, B.F.E.=4.0'
 - THE SURVEY SHOWN HEREON IS MADE IN ACCORDANCE TO THE MINIMUM STANDARDS FOR THE PROPERTY BOUNDARY SURVEYS AS ADOPTED BY THE LOUISIANA STATE BOARD OF REGISTRATION FOR PROFESSIONAL ENGINEERS AND LAND SURVEYORS.
 - ANGLES SHOWN ARE REFERENCED FROM REFERENCE PLAT NO. 1.
 - ALL ELEVATIONS SHOWN ARE IN CAIRO DATUM. (SUBTRACT 20.43 TO ACHIEVE NAVD88)
 - REFERENCE BENCHMARK USED: ALCO 2004.61 EPOCH.
 - SITE TBM IS CROSS CUT IN NORTHERN MEDIAN OF THE INTERSECTION OF N. RAMPART ST. AND CANAL ST., LOCATED 9.22' FROM THE SOUTHWEST BACK OF CURB, 13.8' FROM THE SOUTHEAST BACK OF CURB, AND 5.16' NORTHWEST OF THE POWER POLE.

- REFERENCE PLATS:
- SURVEY BY GANDOLFO, KUHN, LUECKE, & ASSOCIATES ENTITLED "LOT F, ARCADES 1 & 2, SQ. NO. 126, SECOND DISTRICT, NEW ORLEANS, LA" DATED FEBRUARY 21, 1978, REVISED MAY 24, 1985.
 - SURVEY BY GILBERT, KELLY & COUTURIE, INC., ENTITLED "LOTS A & B, SQ. NO. 126, SECOND DISTRICT, NEW ORLEANS, LA" DATED DECEMBER 5, 1998.
 - SURVEY BY GILBERT, KELLY & COUTURIE, INC., ENTITLED "LOTS C,D,&E, SQ. NO. 126, SECOND DISTRICT, NEW ORLEANS, LA" DATED FEBRUARY 27, 2004.
- PROPERTY OWNERS:
 1101 CANAL - RESTAURANT DEVELOPMENT CORP. OF LA LLC
 1113 CANAL - THE HARRAL CO. INC.
- ZONING:
 LOT A-F, ARCADE NO. 1, ARCADE NO. 2: CBD-3
- BUILDING SETBACKS:
 REQ'D FRONT YARD: 0'
 REQ'D SIDE YARD: 0'
 REQ'D REAR YARD: 0'

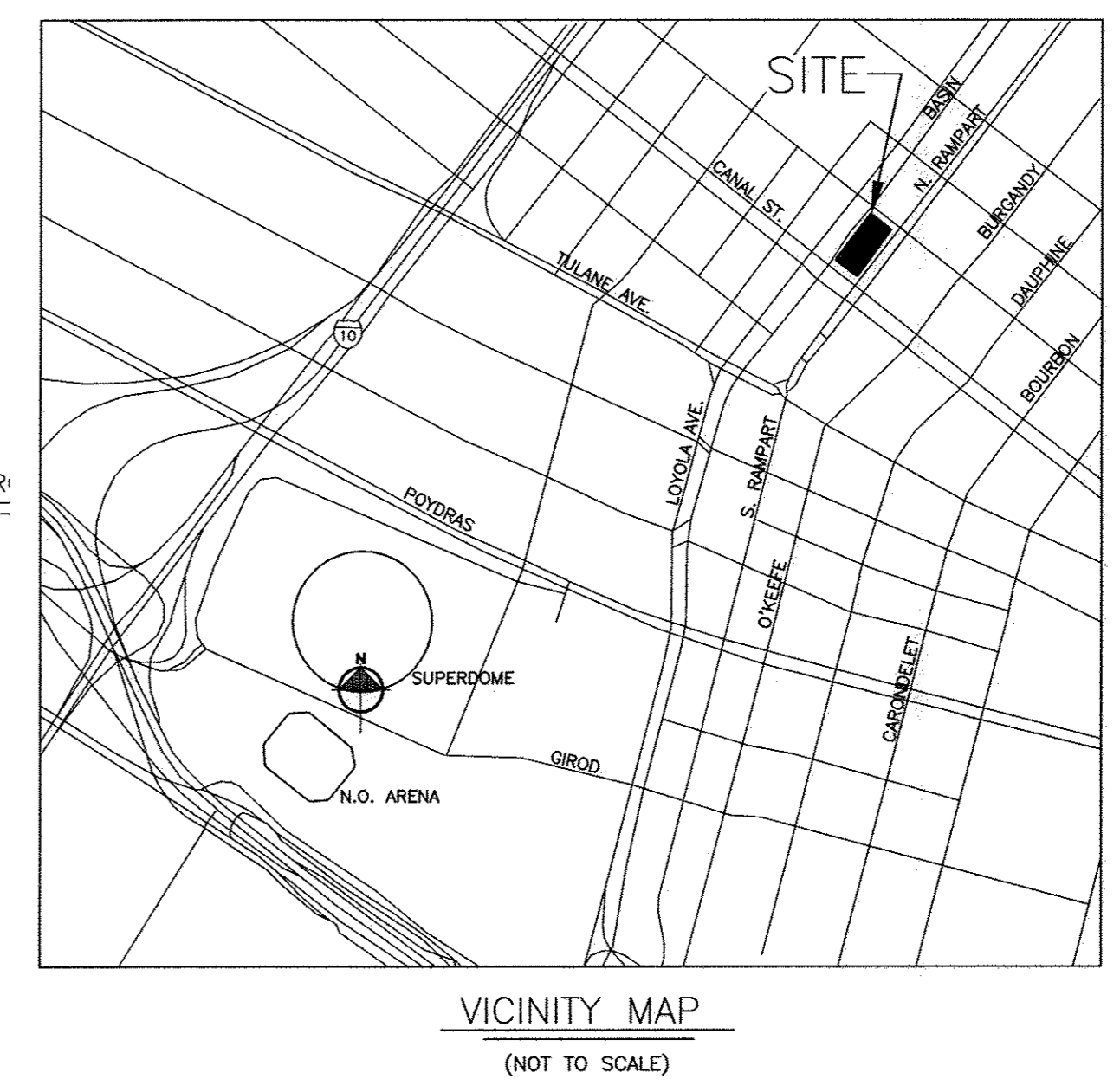
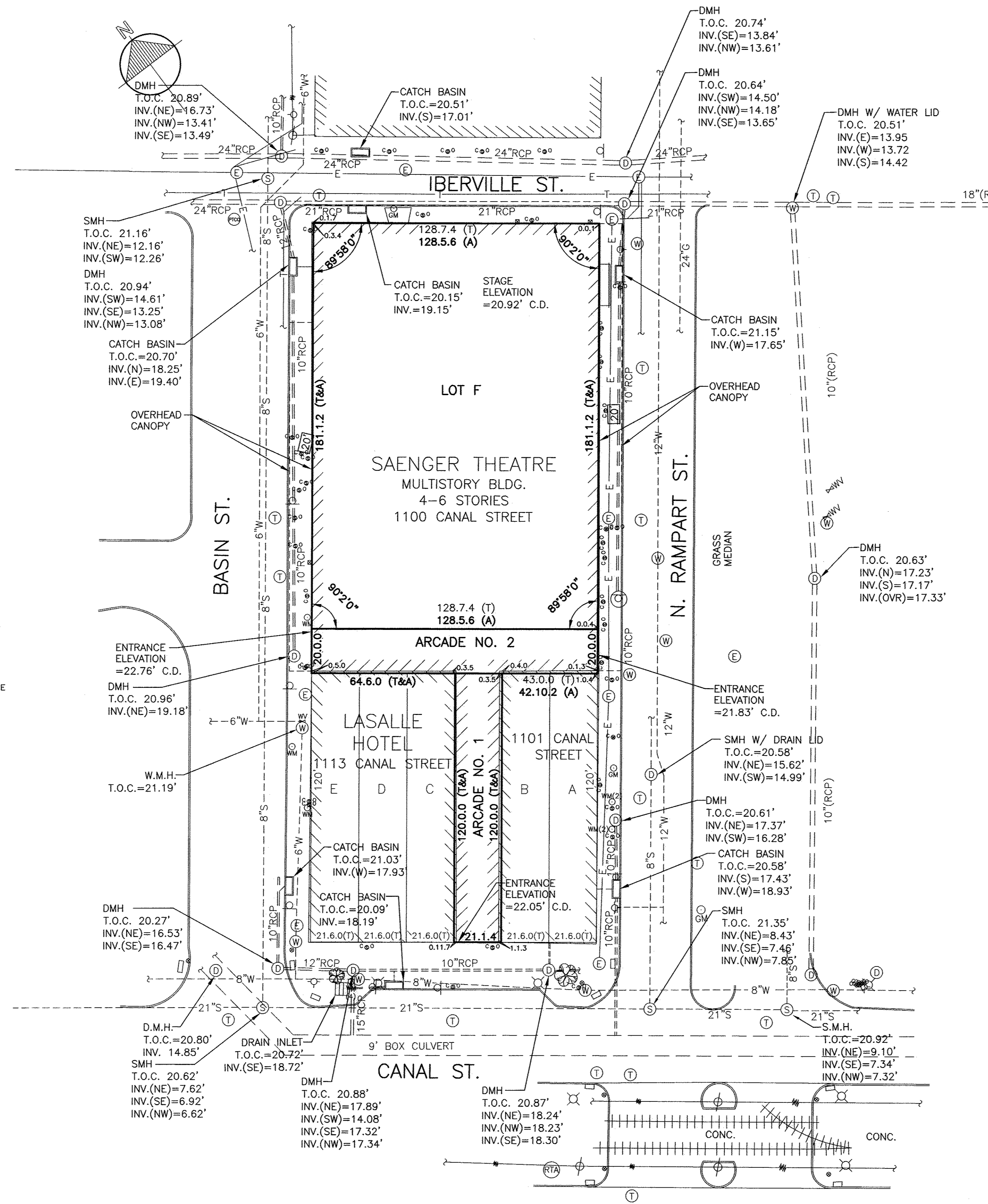

UTILITY INFORMATION:
 SEWER AND WATER:
 SEWERAGE AND WATER BOARD
 OF NEW ORLEANS
 BRIAN JONES
 (504) 865-0652

TELEPHONE:
 AT&T
 KELLY WATTIGNY
 (504) 364-6804

GAS:
 ENTERGY NEW ORLEANS
 DAVE WILLIAMS
 (504) 595-3826

ELECTRIC
 ENTERGY NEW ORLEANS
 ERICK ARTEAGA
 (504) 595-3701

THE SAENGER
 THEATRE RENEWAL
 PROJECT

142 North Rampart Street
 New Orleans, LA

Client
 Saenger Theatre Redevelopment Company
 200 West Loop South, Suite
 1040 Houston TX 77027

Architect
MARTINEZ+JOHNSON
 ARCHITECTURE

1412 Eye St., NW
 Washington, DC 20005
 202.333.4480

Structural Engineer
 Shawn J. Franke, P.E.
 540 Helmer Road, Suite
 Antonio TX 78232
 210.979.7900

Theatre Consultant
 Schuler Shook
 123 Third Street North #210
 Minneapolis, MN 55401
 612.338.6580

Acoustical Engineer
 Akustiks
 93 North Main Street South
 Norwalk, CT 06854
 202.299.1904

MEP Engineer
 JBA Consulting Engineers, Inc.
 3525 N. Causeway Blvd., Suite
 500 Metairie, LA 70002
 504.830.0139

Civil Engineer
 Linfield, Hunter, & Junius, Inc.
 3608 18th Street Suite 200
 Metairie, LA 70002
 504.833.6300

Architectural Historian
 EHT Traceries, Inc.
 1121 Fifth Street NW
 Washington, DC 20001
 202.393.1199

THESE DRAWINGS, SPECIFICATIONS, AND OTHER DOCUMENTS, COLLECTIVELY, "THE DOCUMENTS", INCLUDING WITHOUT LIMITATION ELECTRONIC VERSIONS THEREOF AND THE IDEAS, DESIGNS, AND ARRANGEMENTS REPRESENTED THEREBY, ARE AND SHALL REMAIN THE PROPERTY OF MARTINEZ+JOHNSON ARCHITECTURE PC, AS DEFINED BY APPLICABLE CONTRACTUAL AGREEMENTS ("THE AGREEMENTS") AND AS PROTECTED BY THE COPYRIGHT STATUTES OF THE UNITED STATES. USE OF THE DOCUMENTS SHALL BE STRICTLY LIMITED TO THE PROJECT FOR WHICH THEY WERE PREPARED AND DEVELOPED ("THE PROJECT") FOR THE TERMS OF THE AGREEMENTS. NO PART OF THE DOCUMENTS SHALL BE COPIED, DISCLOSED TO OTHERS, OR USED IN CONNECTION WITH ANY OTHER WORK OR PROJECT, OR BY ANY OTHER PERSONS FOR ANY PURPOSES, OTHER THAN THE COMPLETION OF THE PROJECT, WITHOUT THE SPECIFIC WRITTEN AUTHORIZATION OF MARTINEZ+JOHNSON ARCHITECTURE PC. THE DOWNLOADING, OPENING, OR VIEWING OF ELECTRONIC VERSIONS OF THE DOCUMENTS OR VISUAL CONTACT WITH ANY PRINTED FORM THEREOF, SHALL CONSTITUTE CONCLUSIVE EVIDENCE OF ACCEPTANCE OF THESE RESTRICTIONS.

7502

DATE:	No.:	ISSUE:
02.19.10	1	PERMIT SET
04.02.10	2	GMP CONTRACT SET
11.11.10	-	CONTRACT SET

DATE:	No.:	REVISION:

SHEET TITLE:
 SITE-LAND TITLE SURVEY
 PLAN

C-0.01

SITE-LAND TITLE SURVEY PLAN

1" = 30'

1