

**THE SAENGER  
THEATRE RENEWAL  
PROJECT**

142 North Rampart Street  
New Orleans, LA

Client  
Saenger Theatre Redevelopment Company  
200 West Loop South, Suite  
1040 Houston TX 77027

Architect  
**MARTINEZ+JOHNSON**  
ARCHITECTURE

1412 Eye St. NW  
Washington, DC 20005  
202.333.4480

Structural Engineer  
Shawn J. Franke, P.E.  
549 Helmer Road San  
Antonio TX 78232  
210.979.7900

Theatre Consultant  
Schuler Shook  
123 Third Street North #210  
Minneapolis, MN 55401  
612.333.9598

Acoustical Engineer  
Akustiks  
93 North Main Street South  
Norwalk, CT 06854  
202.299.1904

MEP Engineer  
JBA Consulting Engineers, Inc.  
3525 N. Causeway Blvd. Suite  
500 Metairie, LA 70002  
504.830.0139

Civil Engineer  
Linfield, Hunter, & Junius, Inc.  
3608 18th Street Suite 200  
Metairie, LA 70002  
504.333.3300

Architectural Historian  
EHT Traceries, Inc.  
1121 Fifth Street NW  
Washington, DC 20001  
202.393.1199

THESE DRAWINGS, SPECIFICATIONS, AND OTHER DOCUMENTS, COLLECTIVELY, THE "DOCUMENTS" INCLUDING WITHOUT LIMITATION ELECTRONIC VERSIONS THEREOF AND THE IDEAS, DESIGNS, AND ARRANGEMENTS REPRESENTED THEREBY, ARE AND SHALL REMAIN THE PROPERTY OF MARTINEZ & JOHNSON ARCHITECTURE PC. NO DEFINED BY APPLICABLE CONTRACTUAL AGREEMENTS, THE AGREEMENTS' AND AS PROTECTED BY THE COPYRIGHT STATUTES OF THE UNITED STATES. USE OF THE DOCUMENTS SHALL BE STRICTLY LIMITED TO THE PROJECT FOR WHICH THEY WERE PREPARED AND DEVELOPED ("THE PROJECT") FOR THE TERMS OF THE AGREEMENTS. NO PART OF THE DOCUMENTS SHALL BE COPIED, DISCLOSED TO OTHERS, OR USED IN CONNECTION WITH ANY OTHER WORK OR PROJECT, OR BY ANY OTHER PERSONS FOR ANY PURPOSES, OTHER THAN THE COMPLETION OF THE PROJECT, WITHOUT THE SPECIFIC WRITTEN AUTHORIZATION OF MARTINEZ & JOHNSON ARCHITECTURE PC. THE DOWNLOADING, OPENING, OR VIEWING OF ELECTRONIC VERSIONS OF THE DOCUMENTS OR VISUAL CONTACT WITH ANY PRINTED FORM THEREOF SHALL CONSTITUTE CONCLUSIVE EVIDENCE OF ACCEPTANCE OF THESE RESTRICTIONS.

7502

DATE:	No.:	ISSUE:
02.19.10	1	PERMIT SET
04.02.10	2	GMP CONTRACT SET
11.11.10	-	CONTRACT SET

DATE:	No.:	REVISION:

SHEET TITLE:  
**CIVIL GEOMETRIC PLAN**

**C-1.02**

NOTES:

1. THE LOCATIONS OF UNDERGROUND AND OTHER NONVISIBLE UTILITIES SHOWN HEREON HAVE BEEN PLOTTED BASED UPON DATA EITHER FURNISHED BY THE AGENCIES CONTROLLING SUCH DATA AND/OR OBTAINED FROM RECORDS MADE AVAILABLE TO US BY THE AGENCIES CONTROLLING SUCH RECORDS. WHERE FOUND, THE SURFACE FEATURES OF UTILITIES ARE SHOWN. THE ACTUAL NONVISIBLE LOCATIONS MAY VARY FROM THOSE SHOWN HEREON. EACH AGENCY SHOULD BE CONTACTED RELATIVE TO THE PRECISE LOCATION OF ITS UNDERGROUND INSTALLATIONS PRIOR TO ANY RELIANCE UPON THE ACCURACY OF SUCH LOCATIONS SHOWN HEREON. PRIOR TO EXCAVATION AND DIGGING CALL LA. ONE CALL (1-800-272-3020).

LEGEND	
EXISTING FEATURES	
⊕ OR ⊞	EXIST. DROP INLET
—C—	EXIST. GUY WIRE
---W(SIZE)---	EXIST. WATERLINE
---G(SIZE)---	EXIST. GAS LINE
---E---E---	EXIST. UNDERGROUND ELECTRIC LINE
---S---S---	EXIST. SEWER LINE
---T---T---	EXIST. TELEPHONE LINE
(SIZE)	EXIST. DRAIN LINE
T.B.M.	TEMPORARY BENCHMARK
CS	THE POINT OF CHANGE FROM CIRCULAR CURVE TO SPIRAL
T.C.	TOP OF CASTING/CURB ELEVATION
EL.	ELEVATION
HC	HANDICAP
SMH	SEWER MANHOLE
⊙	EXIST. SEWER MANHOLE
⊕	EXIST. DRAIN MANHOLE
⊕	EXIST. FIRE HYDRANT
⊕	EXIST. WATER VALVE
⊕	EXIST. WATER METER
⊕	GAS METER
⊕	GAS VALVE
⊕	EXIST. SEWER CLEANOUT
⊕	EXIST. SIGN
⊕	EXIST. BOLLARD
⊕	EXIST. FUEL FILLER LIDS
⊕	EXIST. LIGHT POLE
⊕	EXIST. TRAFFIC LIGHT
⊕	HOSE BIB
⊕	EXIST. TRAFFIC SIGNALBOX
⊕	EXIST. RIGHT-OF-WAY MARKER
⊕	EXIST. POWER OR TELEPHONE POLE
⊕	EXIST. CATCH BASIN
XCUT	CROSS CUT IN CONC.
RCP	EXIST. BOUNDARY LINE
CMP	REINFORCED CONCRETE PIPE
INV.	CORRUGATED METAL PIPE
CONC.	INVERT ELEVATION
S/W	CONCRETE SIDEWALK
+6.58	EXIST. SPOT ELEVATION
FND	FOUND
⊕	OVERHEAD ELECTRIC
⊕	EXIST. TREE OR SHRUB
⊕	EXIST. DITCH
⊕	EXIST. CHAINLINK FENCE
⊕	EXIST. VINYL FENCE
⊕	FOUND IRON PIPE
⊕	EXIST. MAILBOX
⊕	EXIST. TELEPHONE PEDESTAL
⊕	EXIST. ELECTRICAL TRANSFORMER
⊕	EXIST. AC UNIT
⊕	EXIST. STEEL POLE

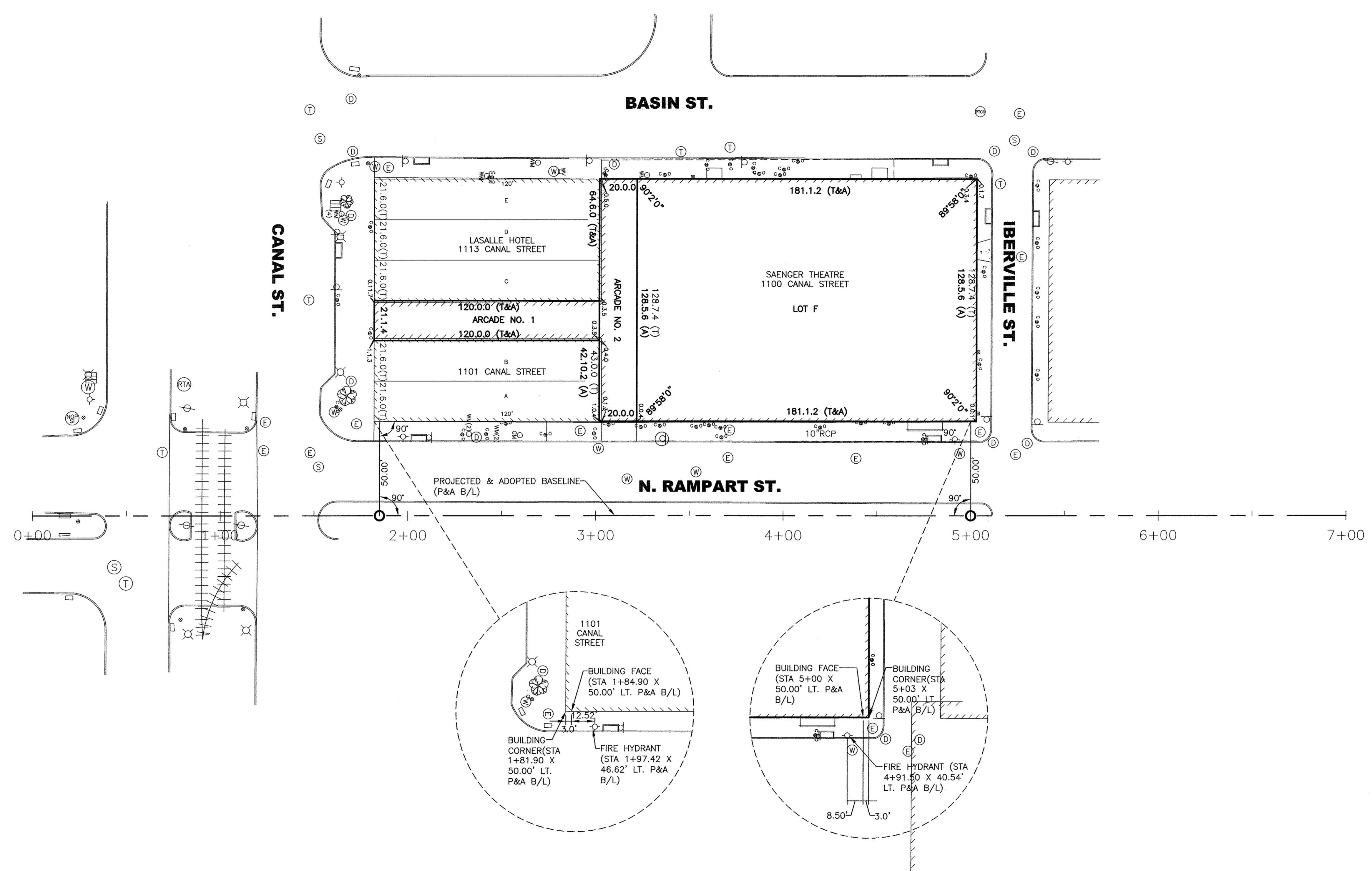

KEY PLAN

CIVIL GEOMETRIC PLAN

1" = 30'

1