

F.S. SECTION  
AT  
DOORS

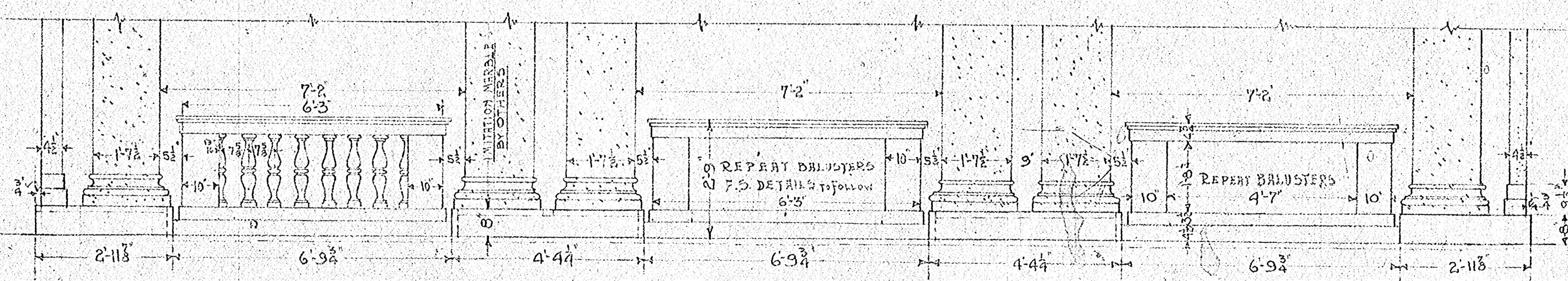
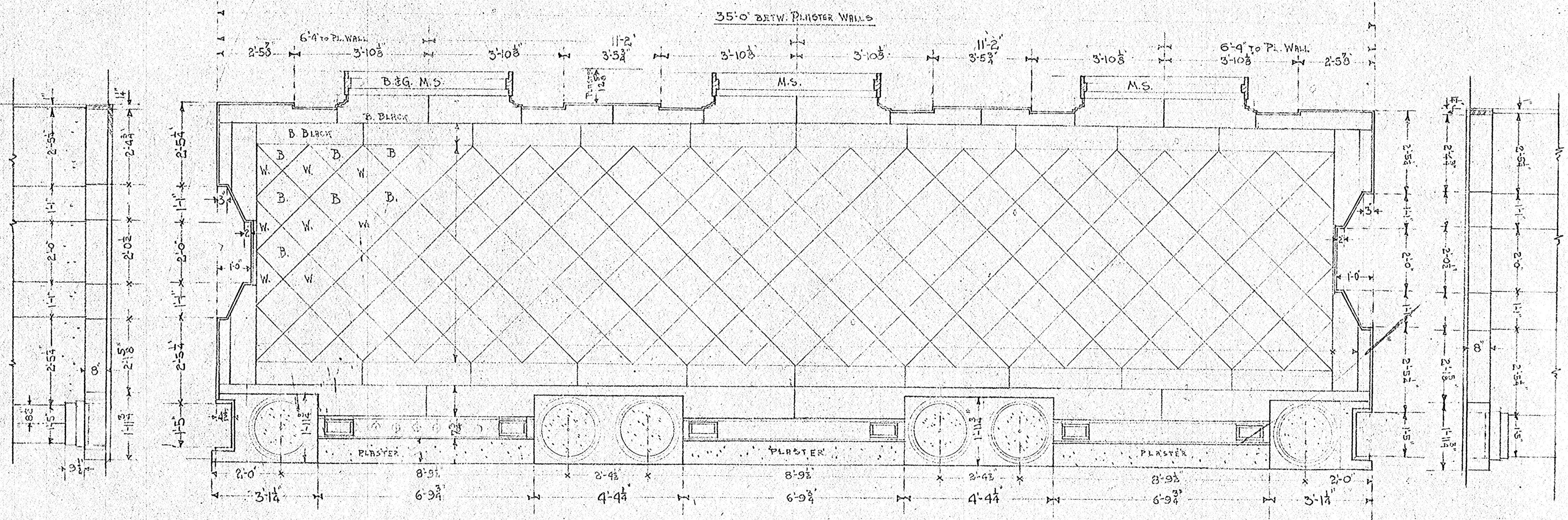
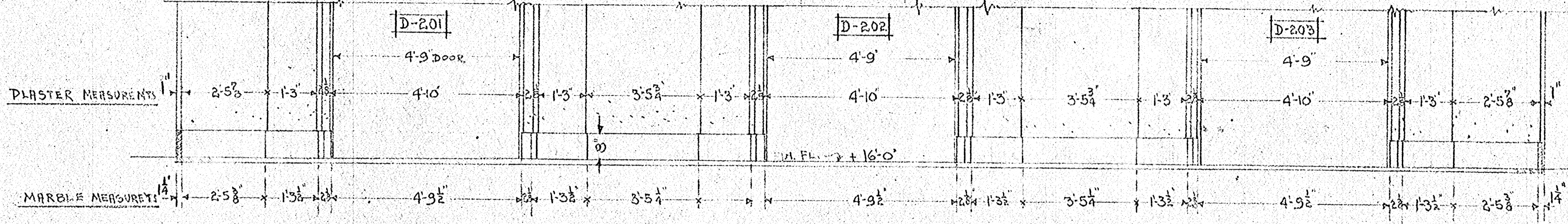
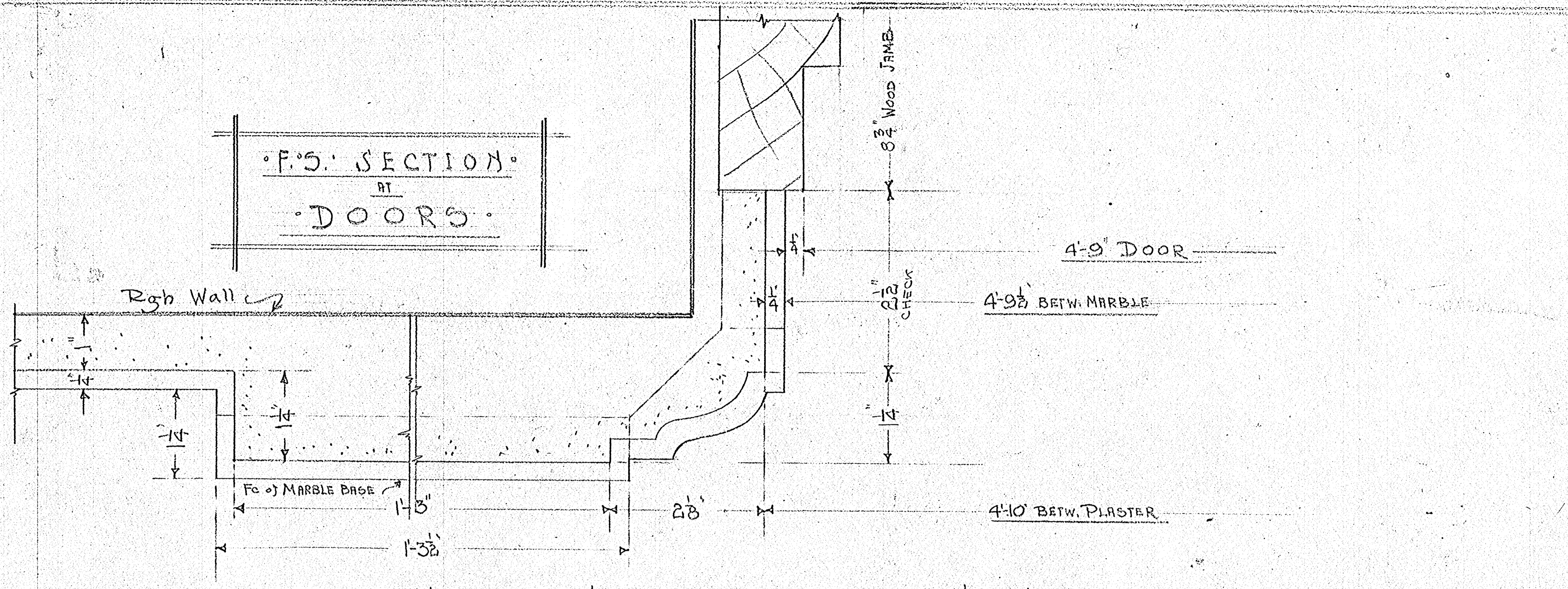

*For approval  
August 1926*

BALCONY

ALL FLOOR TILE TO BE ALTERNATING BELG. BLACK & ENGL. VEIN WHITE ITALIAN F.S.R.  
 BORDER TO BE D. BLACK F.S.R. BASE, PLINTHS & FIRST MEMBER OF COLUMN BASE TO BE BLACK & GOLD POL.  
 BALUSTERS & BAL. CAP. TO BE ENGL. VEIN WHITE ITALIAN POL. WAINSCOT TRIM & PILASTERS BY OTHERS.  
 DETAILS TO FOLLOW SEE DRAWING 11-D

REVISED 8-19-26 K.O.  
8-23-26 K.O.

APPROVED  
BY ARCHITECTS  
DATE 8-20-26 P.P.C.

450-C  
45-C

MR. R. T. WEISS MARBLE & GRANITE  
 135 S. SAENGER CANAL ST. THEATER  
 BALCONY  
 GEO. J. GLOVER CO.  
 ARCHT. EMILE WEISS, INC.  
 OF 225 WING 11 SCALE 3/4" = 1'-0"  
 7-15-26