

RENOVATIONS TO AUXILIARY  
GYMNASIUM & MULTI-PURPOSE  
BUILDING 2

**SALMEN HIGH  
SCHOOL**

300 SPARTAN DRIVE  
SLIDELL, LOUISIANA  
ST. TAMMANY PARISH

STPSB PROJECT No. 1011

**ST. TAMMANY PARISH  
SCHOOL BOARD**

321 NORTH THEARD STREET  
COVINGTON, LA 70434

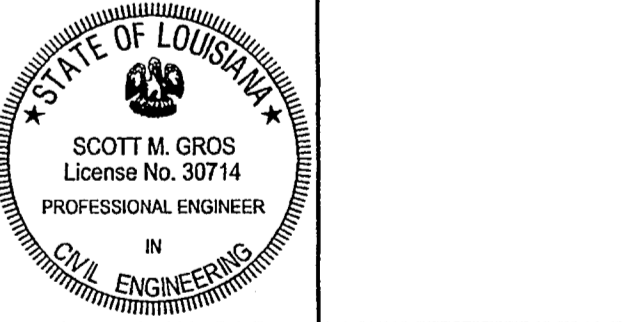
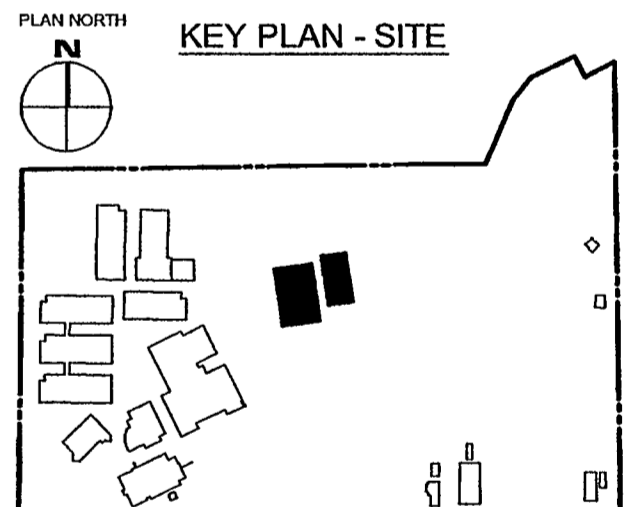

THESE DRAWINGS ARE THE SOLE PROPERTY OF FAUNTLEROY LATHAM WELDON BARRÉ ARCHITECTS, APC, AND ARE ISSUED AS INSTRUMENTS OF SERVICE. THESE DRAWINGS SHALL NOT BE COPIED, REPRODUCED OR USED IN ANY MANNER WITHOUT WRITTEN CONSENT OF FAUNTLEROY LATHAM WELDON BARRÉ ARCHITECTS, APC.

Issue	Date	Remark

**DEMOLITION AND FOUNDATION PLANS**

Job No	206011.09	Sheet No	<b>S2.1</b>
Drawn by	MMM		
Checked by	SMG		
Date	16.SEP.10		

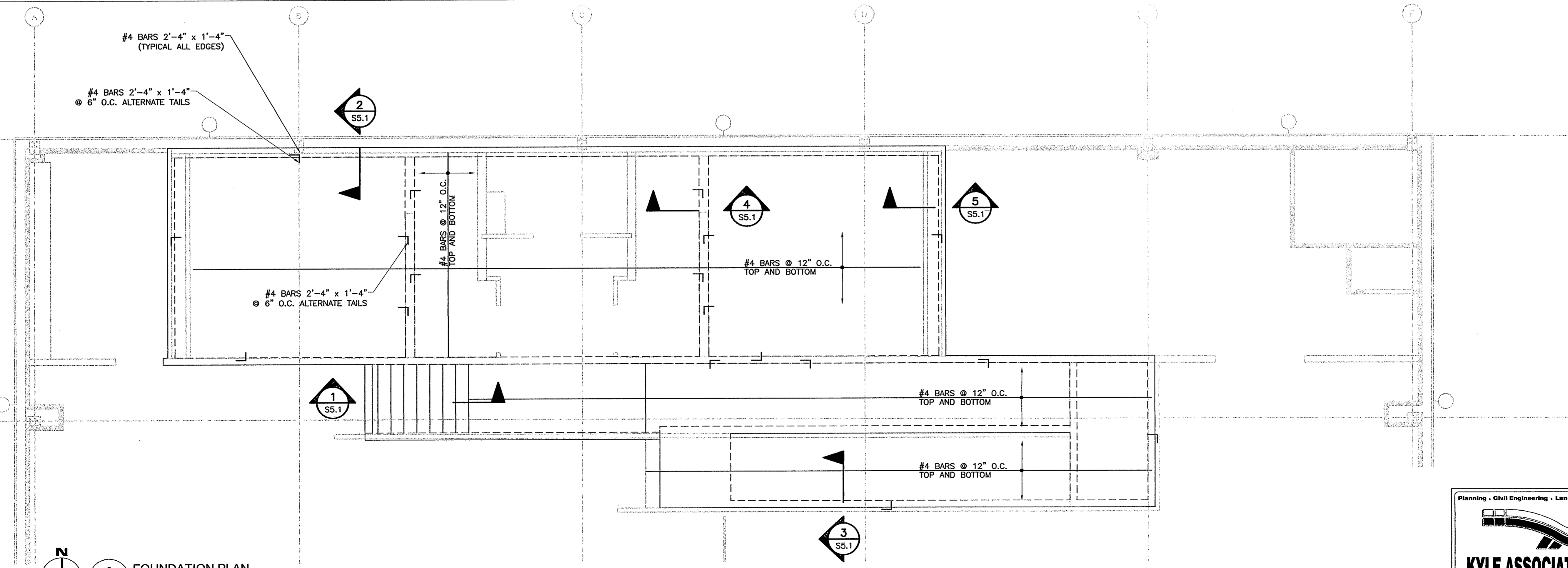
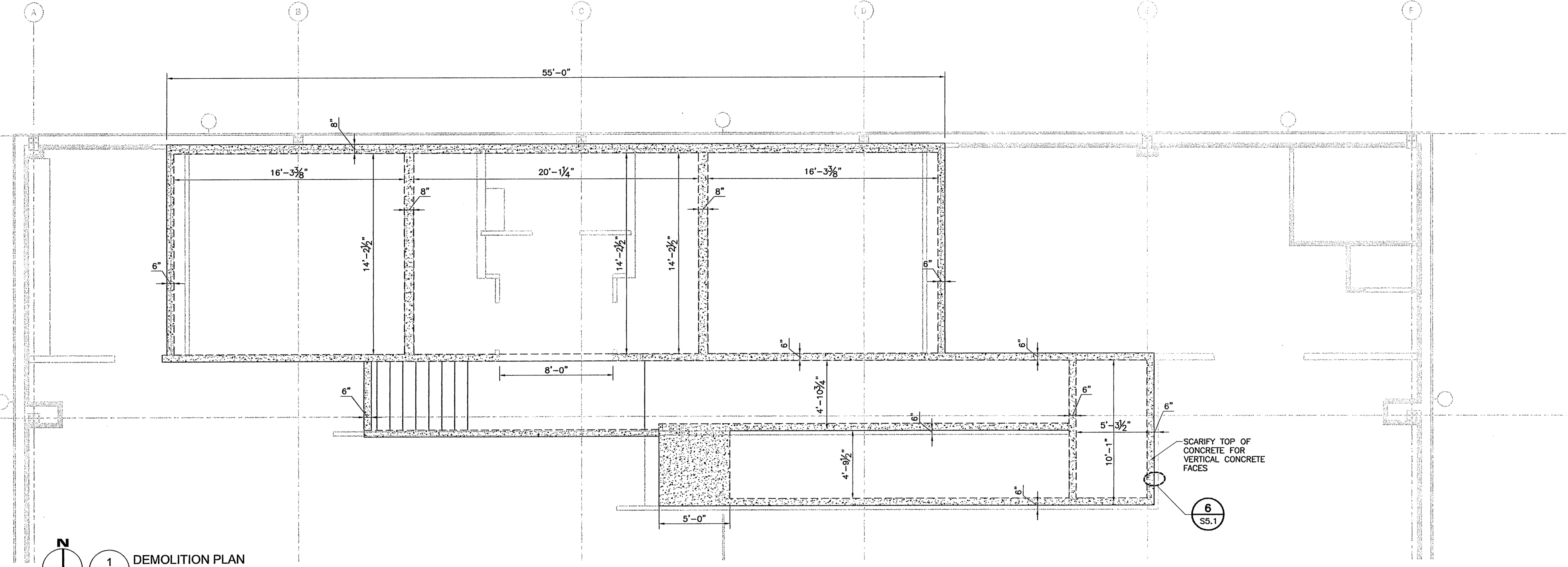

N:\2010\101109 - Salmen HS - Gym and MP2\Drawings\1\049-FL-FOUNDATION.dwg, ADI, S2, 9/16/2010 9:23:57 AM, Invert