

- NOTES:**
- ELEVATIONS SHOWN ARE M.S.L.
  - FIELD VERIFY ALL ELEVATIONS PRIOR TO START OF WORK FOR PROPER DRAINAGE FLOW.

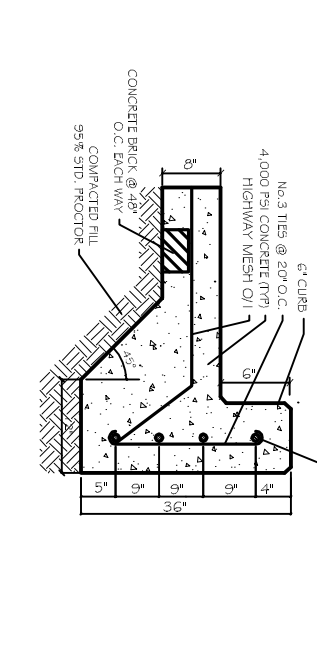
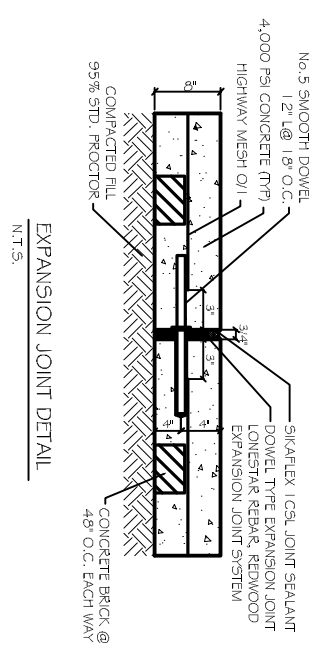
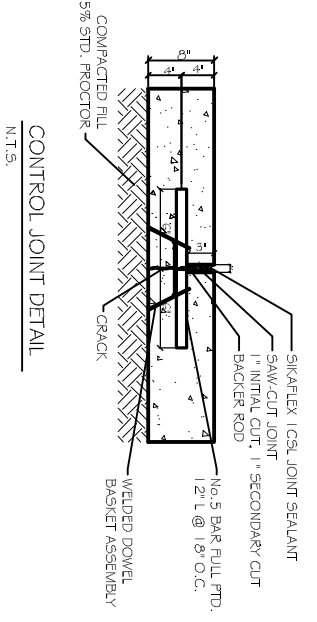

**PAVING NOTES:**

- ALL NEW CONCRETE SHALL HAVE A MINIMUM COMPRESSIVE STRENGTH OF 4,000 PSI AT 28 DAYS AND A MINIMUM THICKNESS OF 8\"/>
- CONCRETE MIX SHALL BE IN ACCORDANCE WITH THE LATEST REVISION OF ASTM C-1150 TYPE 1.
- CONCRETE PAVING THICKNESS SHALL VARY AS FOLLOWS:
  - DRIVEWAYS = 6\"/>
  - ALL REINFORCING STEEL SHALL MEET ASTM A615 (GRADE 60).
  - ALL REINFORCING STEEL SHALL BE SECURELY SUPPORTED TO PREVENT BOTH VERTICAL AND HORIZONTAL MOVEMENT DURING CONCRETE PLACEMENT. ALL CONTROL AND EXPANSION JOINTS SHALL BE LOCATED AND INSTALLED AS SHOWN ON THE PAVING PLAN AND IN ACCORDANCE WITH THE MANUFACTURER'S RECOMMENDATIONS.
  - ALL SUB GRADE FILL SHALL BE SELECT GRANULAR MATERIAL COMPACTED TO 95% STANDARD PROCTOR DENSITY IN A MAXIMUM OF 6 LIFTS.
  - CONTRACTOR SHALL CONTACT THEIR REGULATORY DEPARTMENT OF ENGINEERING PRIOR TO CONDUCTING ANY WORK.
  - ANY WORK WITHIN THE ROADWAY OR ADJACENT TO THE ROADWAY CAUSING AN INTERFERENCE TO VEHICULAR TRAFFIC MUST CONFORM TO THE REQUIREMENTS SET FORTH BY THE UNIFORM MANUAL OF TRAFFIC CONTROL DEVICES OF THE STATE OF LOUISIANA. THE CONTRACTOR MUST FURNISH ALL NECESSARY TRAFFIC SIGNS AND/OR BARRICADES AND MAINTAIN THEM DURING CONSTRUCTION ACTIVITIES.

- LEGEND**
- PROPERTY LINE
  - CONTROL JT.
  - EXPANSION JT.
  - ⊙ 0.00' - TOP OF GRADE ELEVATION
  - ⊙ 0.00' - INVERT ELEVATION
  - ⊠ 0.00' - NEW ELEVATION
  - ⊡ 0.00' - TOP OF CURB
  - ⊢ 0.00' - BOTTOM OF CURB

**506.96'**  
EAST CONCRETE PAVING PLAN  
SCALE: 1" = 30'

**217.12'**  
NORTH  
INV. EL. 14.93'  
600 NAIL (SET)



<b>C-1</b>	FLOOR PLAN SHEET No: 1 OF 1	REVISIONS	<b>B. &amp; W. TRUCKING INC.</b>		<b>DAMMON ENGINEERING INC.</b> Architects & Engineers	
		DATE	JOB No:	DATE: 09-19-2012		
		DESCRIPTION	130 INDUSTRIAL DRIVE SUDELL LA 70460	DRAWN BY: CKD	CHECKED BY: CKD	CHIEF ENGINEER: EMMETT DAMMON, P.E. CHIEF ARCHITECT: ROBERT WLTZE 554 OLD SPANISH TRAIL SUDELL, LA 70458 dammonengineering.com dammoneng@bellsouth.net PHONE: 985-649-5832 FAX: 985-641-5950