

FLOORPLAN SKETCH

Borrower: DWIGHT FONTENETTE

File No.: 1219-282352

Property Address: 1170 Clipper Dr

Case No.:

City: Slidell

State: LA

Zip: 70458

Lender: OCMBC DBA LOANSTREAM MORTGAGE

Sketch

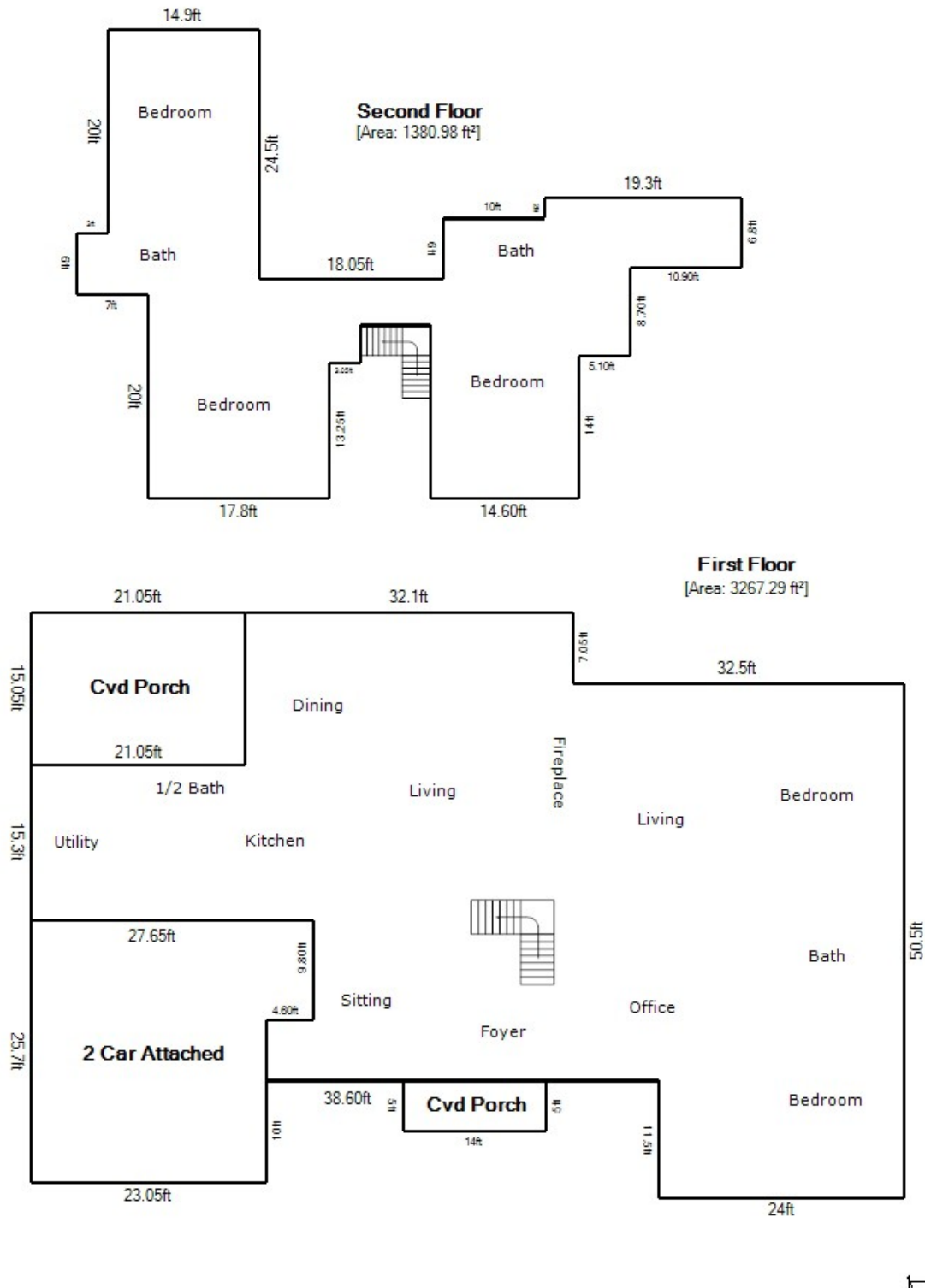

Living Area		Area Calculation			
First Floor	3267.29 ft²	First Floor			x 1.00 = 3267.29 ft²
Second Floor	1380.98 ft²	□	7.05ft x 32.1ft x	1.00 =	226.31 ft²
Nonliving Area		□	11.5ft x 24ft x	1.00 =	276 ft²
2 Car Attached	637.47 ft²	□	4.60ft x 5.90ft x	1.00 =	27.14 ft²
Cvd Porch	316.80 ft²	□	39ft x 58ft x	1.00 =	2262 ft²
Cvd Porch	70 ft²	□	27.65ft x 15.3ft x	1.00 =	423.05 ft²
		□	8ft x 6.60ft x	1.00 =	52.80 ft²
		Second Floor			x 1.00 = 1380.98 ft²
		□	13.25ft x 17.8ft x	1.00 =	235.85 ft²
		△	3ft x 6ft x	0.50 =	9 ft²
		□	14ft x 14.60ft x	1.00 =	204.40 ft²
		△	15.56ft x 5.03ft x	0.49 =	38.59 ft²
		□	20.85ft x 8.25ft x	1.00 =	172.01 ft²
		□	6.80ft x 4.50ft x	1.00 =	30.60 ft²
		□	1.30ft x 7.50ft x	1.00 =	9.75 ft²
		□	8.70ft x 18.40ft x	1.00 =	160.08 ft²
		△	19.3ft x 19.89ft x	0.12 =	46.32 ft²
		□	10ft x 4.8ft x	1.00 =	48 ft²
		△	1.68ft x 0.75ft x	0.45 =	0.56 ft²
		□	6.25ft x 1.5ft x	1.00 =	9.38 ft²
		△	15.56ft x 4.5ft x	0.48 =	33.52 ft²
		□	20ft x 14.9ft x	1.00 =	298 ft²
		△	19.89ft x 4.8ft x	0.49 =	46.32 ft²
Total Living Area (rounded):	4648.27 ft²	□	2ft x 19.3ft x	1.00 =	38.60 ft²

The Appraiser has provided a sketch in this appraisal report to show the approximate dimensions of the improvements. The sketch is included only to assist the reader in visualizing the property and understanding the Appraiser's determination of the size.

