

OCCUPANT LOAD

ROOM	AREA	LOAD		OCCUPANT		EXIT WIDTH		EXIT WIDTH FACTOR		EXIT CAPACITY		TOTAL
		FACTOR	LOAD	LOAD	STAIRS	DOORS	STAIRS	DOORS	STAIRS	DOORS		
OFFICES	1206	100		12								
MECH/BOILER/PLAN	894	300		2								
LABORATORIES	13320	100		133								
LIBRARY	304	100		3								
STORAGE	4648	300		15								
CONFERENCE	468	15		30								
BREAK ROOM	380	15		26								
COMMON AREAS	2804	100		28								
TOTAL	23714			289	0	284	0.3	0.2	0	1320	1320	

LEGEND

- 165 → EXIT CAPACITY
- TRAVEL DISTANCE
- EXIT LIGHT
- 5lb 3A;40B;C FIRE EXTINGUISHER

SEE DESIGN AND LIFE SAFETY ANALYSIS FOR MORE INFORMATION

THE FOLLOWING ARE LIGHT HAZARD OCCUPANCIES:
ALL OFFICES
CONFERENCE ROOM
RESTROOMS
CORRIDORS
LOBBY
DRP SECURITY WORK AREA
BREAKROOM
ALL AREAS NOT LISTED ABOVE ARE CONSIDERED ORDINARY HAZARD OCCUPANCIES.

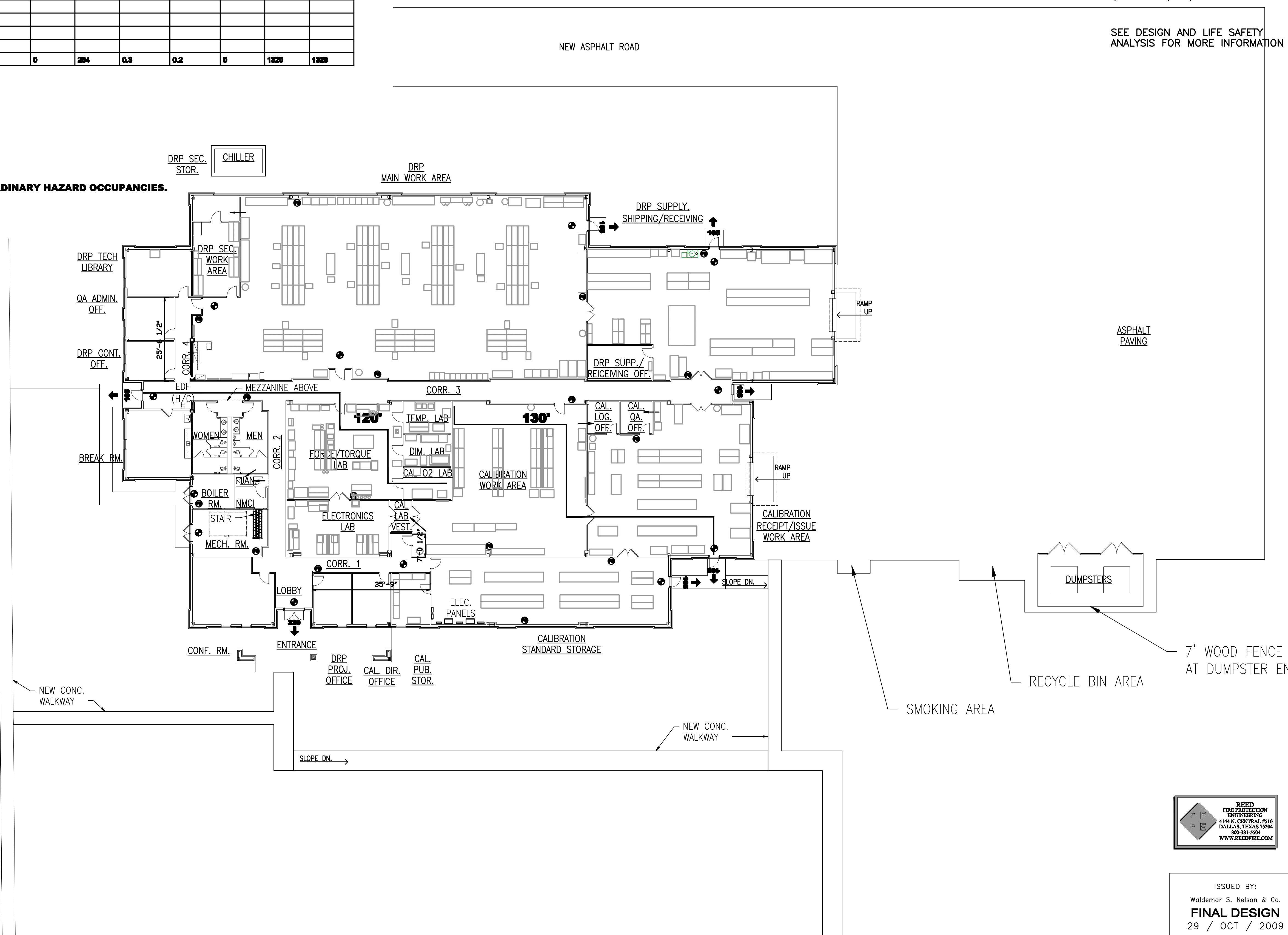

BROADMOOR
 BUILDING by DESIGN
 BROADMOOR, L.L.C.
 2740 North Ancelet Road
 Metairie, Louisiana 70002
 www.broadmoorllc.com

REV.	DESCRIPTION	DATE	APPROVED
0	FINAL DESIGN	07/29/09	P.S.

NMS JRB New Orleans
NAVAIRSEFAC CALIBRATION BLDG.
 LIFE SAFETY PLAN
 DATE: AUGUST 22, 2008
 ETD FOR COMMANDER, NAVFAC



ISSUED BY:
 Waldemar S. Nelson & Co.
FINAL DESIGN
 29 / OCT / 2009

LIFE SAFETY PLAN
 SCALE: 1/16" = 1'-0"



Waldemar S. Nelson and Company
 ENGINEERS AND ARCHITECTS
 1200 ST. CHARLES AVE. NEW ORLEANS, LA.

RECORD DRAWING DATE	05/27/09
CODE I.D. NO.	-
DRAWING SIZE	D
SPEC. NO. 06-	-
CONSTRN. CONTR. NO.	-
NAVFAC DRAWING NO.	150.309.18
SHEET	1 OF 1

LS-01