

DAMMON
ENGINEERING, INC.

EMMETT
DAMMON

ARCHITECT
ROBERT
WILTSE

1095 FLORIDA AVENUE
SLIDELL, LA, 70458
985-649-5832

WWW.DAMMONENGINEERING.COM

WEBSITE:

EMAIL:

DAMMONENG@BELLSOUTH.NET

ARCHITECTURE
ENGINEERING
STUDIES
PLANNING
INVESTIGATION
EXPERT WITNESS

TANGIPAHOA
PARISH
LANDFILL

TANGIPAHOA
CELL 12 - PHASE II(WEST)
LEACHATE & FORCE MAIN
PIPING SYSTEM

ELECTRICAL
SERVICE
PLAN

REV: REV#1 10-27-2010

SCALE: AS NOTED

JOB#: 2067

DATE: 7-12-2010

SHEET

E-1

OF

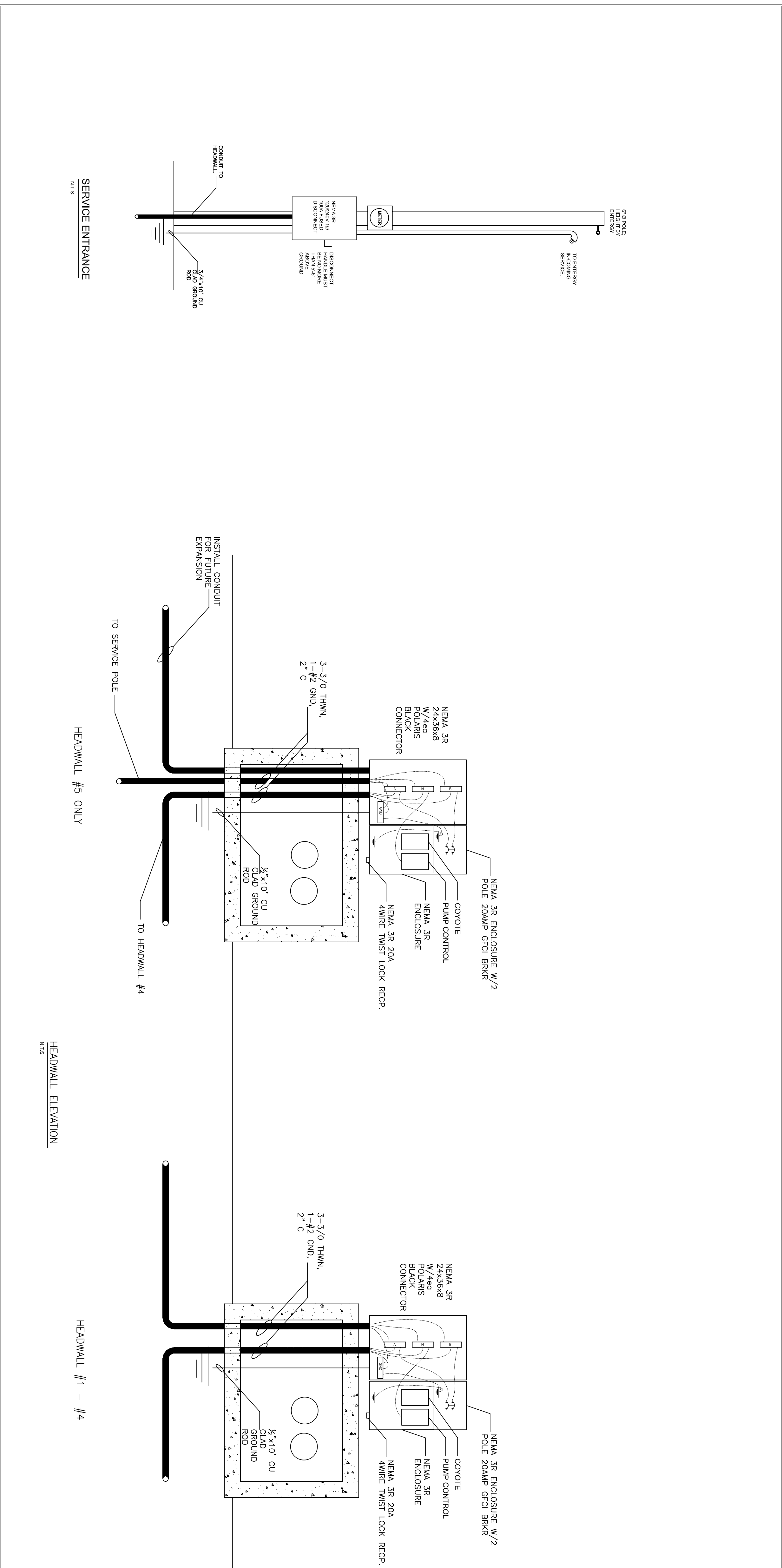

- GENERAL NOTES:
1. ELECTRICIAN SHALL SET A SERVICE POLE ON THE DOWN SLOPE SIDE, 10 FT FROM TOP OF BERM, ACROSS FROM RISER CELL 12 - PHASE II (WEST) - #5.
 2. SERVICE SHALL BE EXTENDED TO #5 PUMP.
 3. 2" UNDERGROUND CONDUITS SHALL BE INSTALLED FROM ONE HEADWALL TO THE NEXT.
 4. ALL PUMPS WILL BE CONNECTED WITH TYPE SO CORD AND TERMINATED WITH 20AMP 4-WIRE TWIST-LOCK MALE PLUG.
 5. TERMINATE ALL EQUIPMENT ACCORDING TO MANUFACTURER'S RECOMMENDATION.
- ELECTRICAL SERVICE:
- | | | |
|---------|-----------------|----------------|
| CURRENT | 6 EA. 1/2 HP 1Ø | 3-WIRE MOTORS |
| | 6.0 AMP RUN | 21.5 AMP START |
| FUTURE | 5 EA. 1/2 HP 1Ø | 3-WIRE MOTORS |
| | 6.0 AMP RUN | 21.5 AMP START |

ELECTRICAL NOTES

1. ALL WORK SHALL CONFORM TO THE LATEST EDITION OF THE NATIONAL ELECTRICAL CODE, THE GOVERNING ELECTRICAL CODE AND ALL OTHER INSPECTION DEPARTMENT'S HAVING JURISDICTION. OBTAIN CERTIFICATES OR APPROVAL WHERE REQUIRED.
2. ALL MATERIALS FURNISHED SHALL BE NEW AND SHALL BE U.L. LISTED.
3. THE DRAWINGS INDICATE SIZE AND GENERAL LOCATION OF WORK. SCALE DIMENSIONS SHALL NOT BE USED. THE EXACT LOCATION AND LOCATION OF ALL POWER POLES AND ALL RISERS SHALL BE DETERMINED BY ACTUAL CONDITIONS IN THE FIELD.
4. PRIOR TO BIDDING, CONTRACTOR SHALL VISIT THE JOB SITE AND FAMILIARIZE THEMSELVES WITH THE EXISTING CONDITIONS.
5. ELECTRICAL CONTRACTOR SHALL COORDINATE HIS WORK WITH OTHER TRADES AND WITH OTHER CONTRACTORS WHOSE WORK MAY AFFECT THIS INSTALLATION.
6. ELECTRICAL CONTRACTOR SHALL COORDINATE INCOMING ELECTRICAL SERVICE WITH UTILITY COMPANY AND INCLUDE IN HIS BID ALL CHARGES AND FEES INCURRED IN MODIFICATIONS, IF THE INCOMING ELECTRICAL SERVICE VOLTAGE IS NOT AT THE PROPER VOLTAGE, THE ELECTRICAL CONTRACTOR IS TO INSTALL BUCK/BOOST TRANSFORMERS.
7. PERFORM TEST REQUIRED BY THE OWNER OR THE ENGINEER IN CONNECTION WITH THE OPERATION OF THE ELECTRICAL SYSTEM IN THE BUILDING.
8. ALL TESTS SHALL BE MADE IN ACCORDANCE WITH THE LATEST STANDARD OF THE IEEE AND THE NATIONAL ELECTRICAL CODE.
9. MINIMUM CONDUCTOR SIZE SHALL BE #12, 600V INSULATION. MINIMUM SIZE CONDUIT SHALL BE 1" SCH 80 FOR EXTERIOR USE.
10. CONTRACTOR SHALL INSTALL WIRING AND OTHER CIRCUIT COMPONENTS TO MATCH EQUIPMENT ACTUALLY INSTALLED.
11. INSTALL GROUND FAULT RECEPTACLES AT RECEPTACLE LOCATIONS AT EXTERIOR LOCATIONS. EXTERIOR RECEPTACLES SHALL ALSO BE WATERPROOF.
12. BONDING AND GROUNDING SHALL BE IN ACCORDANCE WITH NFPA 70:230-63, NFPA 250-23, 250-71 & 250-72.
13. GROUND NEUTRAL IN ACCORDANCE WITH NFPA 70:250-23b.
14. FUSES SHALL BE ITT CLASS K5, 250 VOLT, 200,000 AMP INTERRUPTING CAP.

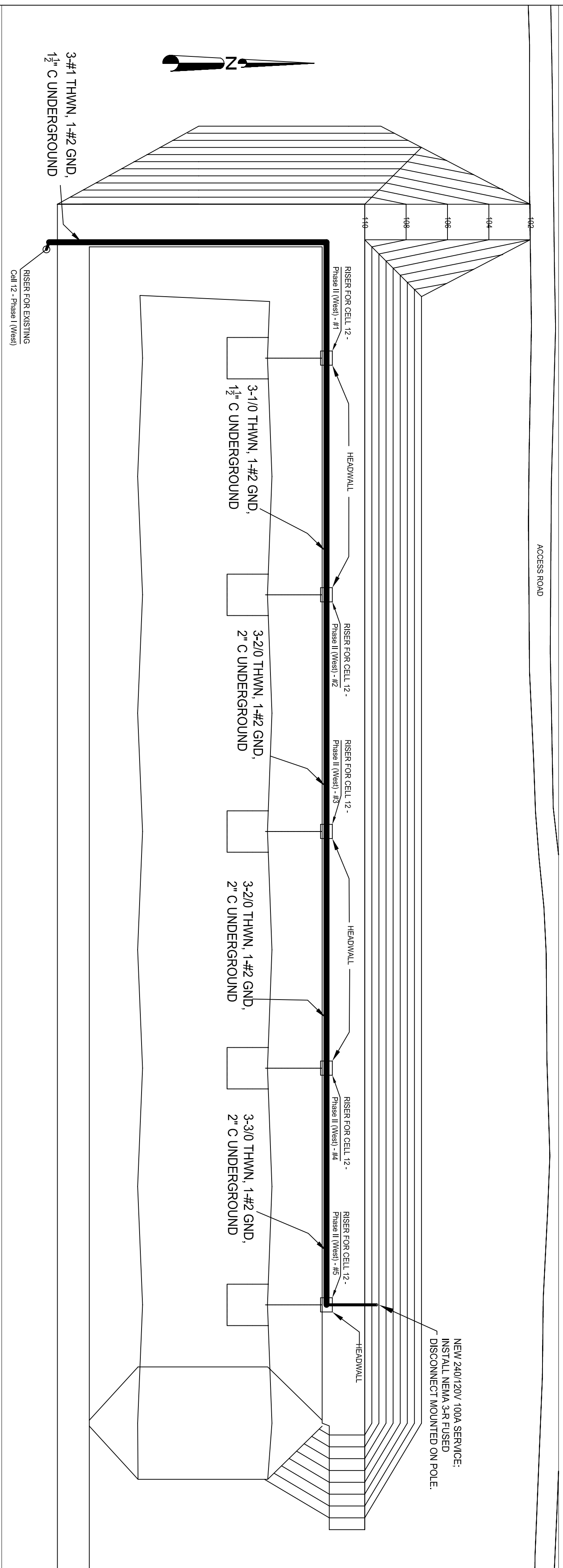

ELECTRICAL SITE PLAN
N.T.S.