



RICHARD C. LAMBERT
CONSULTANT, L.L.C.
521 N. Causeway Blvd.
Metairie, LA 70006
Tel: 833-772-4887
Fax: 833-772-4887
#1 Poydras St., Ste. 1400 #10
New Orleans, LA 70112
New Orleans, LA 70112

This drawing and details are the property of Richard C. Lambert Consulting, L.L.C. and may not be reproduced or used without the written permission of RCL.

RCLC Project Number: 0699
Date Issued: 03/23/07
Drawn By: BP
Checked By: AB
Revisions:

ST. TAMMANY PARISH SHERIFF'S OFFICE
BROWNSWITCH ROAD
SLIDELL, LOUISIANA

CONSTRUCTION DOCUMENTS

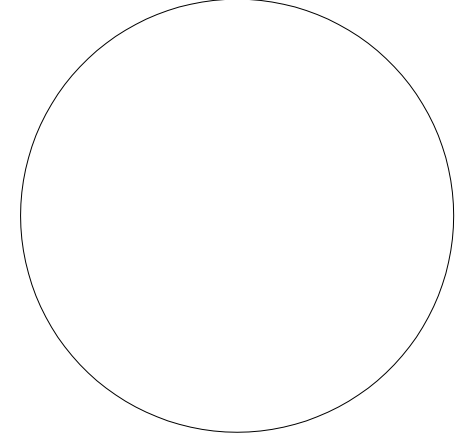

IRRIGATION PLAN
Sheet Number: IR1

Copyright 2007

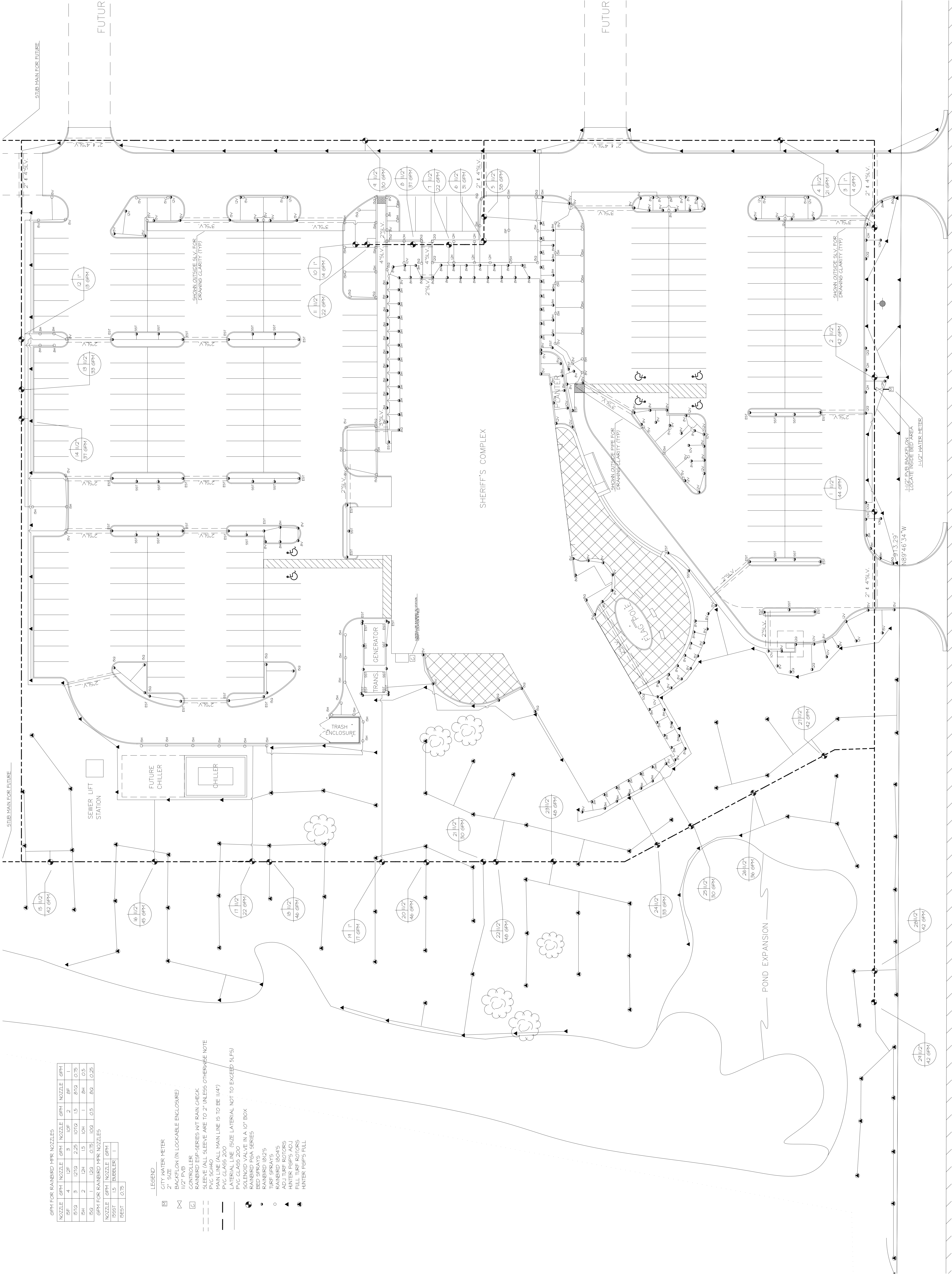

GPM FOR RAINBIRD MKR NOZZLES

NOZZLE	GPM	NOZZLE	GPM	NOZZLE	GPM
1/2"	1	1/2"	2	1/2"	1
3/4"	4	1/2"	3	1/2"	8F
1"	12F	1/2"	10F	1/2"	15
1 1/4"	2,25	1/2"	15	1/2"	20
1 1/2"	1,2H	1/2"	15	1/2"	25
1 3/4"	1,23	1/2"	15	1/2"	30
2"	1,23	1/2"	15	1/2"	35
2 1/4"	1,23	1/2"	15	1/2"	40
2 1/2"	1,23	1/2"	15	1/2"	45
2 3/4"	1,23	1/2"	15	1/2"	50
3"	1,23	1/2"	15	1/2"	55
3 1/4"	1,23	1/2"	15	1/2"	60
3 1/2"	1,23	1/2"	15	1/2"	65
3 3/4"	1,23	1/2"	15	1/2"	70
4"	1,23	1/2"	15	1/2"	75
4 1/4"	1,23	1/2"	15	1/2"	80
4 1/2"	1,23	1/2"	15	1/2"	85
4 3/4"	1,23	1/2"	15	1/2"	90
5"	1,23	1/2"	15	1/2"	95
5 1/4"	1,23	1/2"	15	1/2"	100
5 1/2"	1,23	1/2"	15	1/2"	105
5 3/4"	1,23	1/2"	15	1/2"	110
6"	1,23	1/2"	15	1/2"	115
6 1/4"	1,23	1/2"	15	1/2"	120
6 1/2"	1,23	1/2"	15	1/2"	125
6 3/4"	1,23	1/2"	15	1/2"	130
7"	1,23	1/2"	15	1/2"	135
7 1/4"	1,23	1/2"	15	1/2"	140
7 1/2"	1,23	1/2"	15	1/2"	145
7 3/4"	1,23	1/2"	15	1/2"	150
8"	1,23	1/2"	15	1/2"	155
8 1/4"	1,23	1/2"	15	1/2"	160
8 1/2"	1,23	1/2"	15	1/2"	165
8 3/4"	1,23	1/2"	15	1/2"	170
9"	1,23	1/2"	15	1/2"	175
9 1/4"	1,23	1/2"	15	1/2"	180
9 1/2"	1,23	1/2"	15	1/2"	185
9 3/4"	1,23	1/2"	15	1/2"	190
10"	1,23	1/2"	15	1/2"	195
10 1/4"	1,23	1/2"	15	1/2"	200
10 1/2"	1,23	1/2"	15	1/2"	205
10 3/4"	1,23	1/2"	15	1/2"	210
11"	1,23	1/2"	15	1/2"	215
11 1/4"	1,23	1/2"	15	1/2"	220
11 1/2"	1,23	1/2"	15	1/2"	225
11 3/4"	1,23	1/2"	15	1/2"	230
12"	1,23	1/2"	15	1/2"	235
12 1/4"	1,23	1/2"	15	1/2"	240
12 1/2"	1,23	1/2"	15	1/2"	245
12 3/4"	1,23	1/2"	15	1/2"	250
13"	1,23	1/2"	15	1/2"	255
13 1/4"	1,23	1/2"	15	1/2"	260
13 1/2"	1,23	1/2"	15	1/2"	265
13 3/4"	1,23	1/2"	15	1/2"	270
14"	1,23	1/2"	15	1/2"	275
14 1/4"	1,23	1/2"	15	1/2"	280
14 1/2"	1,23	1/2"	15	1/2"	285
14 3/4"	1,23	1/2"	15	1/2"	290
15"	1,23	1/2"	15	1/2"	295
15 1/4"	1,23	1/2"	15	1/2"	300
15 1/2"	1,23	1/2"	15	1/2"	305
15 3/4"	1,23	1/2"	15	1/2"	310
16"	1,23	1/2"	15	1/2"	315
16 1/4"	1,23	1/2"	15	1/2"	320
16 1/2"	1,23	1/2"	15	1/2"	325
16 3/4"	1,23	1/2"	15	1/2"	330
17"	1,23	1/2"	15	1/2"	335
17 1/4"	1,23	1/2"	15	1/2"	340
17 1/2"	1,23	1/2"	15	1/2"	345
17 3/4"	1,23	1/2"	15	1/2"	350
18"	1,23	1/2"	15	1/2"	355
18 1/4"	1,23	1/2"	15	1/2"	360
18 1/2"	1,23	1/2"	15	1/2"	365
18 3/4"	1,23	1/2"	15	1/2"	370
19"	1,23	1/2"	15	1/2"	375
19 1/4"	1,23	1/2"	15	1/2"	380
19 1/2"	1,23	1/2"	15	1/2"	385
19 3/4"	1,23	1/2"	15	1/2"	390
20"	1,23	1/2"	15	1/2"	395
20 1/4"	1,23	1/2"	15	1/2"	400
20 1/2"	1,23	1/2"	15	1/2"	405
20 3/4"	1,23	1/2"	15	1/2"	410
21"	1,23	1/2"	15	1/2"	415
21 1/4"	1,23	1/2"	15	1/2"	420
21 1/2"	1,23	1/2"	15	1/2"	425
21 3/4"	1,23	1/2"	15	1/2"	430
22"	1,23	1/2"	15	1/2"	435
22 1/4"	1,23	1/2"	15	1/2"	440
22 1/2"	1,23	1/2"	15	1/2"	445
22 3/4"	1,23	1/2"	15	1/2"	450
23"	1,23	1/2"	15	1/2"	455
23 1/4"	1,23	1/2"	15	1/2"	460
23 1/2"	1,23	1/2"	15	1/2"	465
23 3/4"	1,23	1/2"	15	1/2"	470
24"	1,23	1/2"	15	1/2"	475
24 1/4"	1,23	1/2"	15	1/2"	480
24 1/2"	1,23	1/2"	15	1/2"	485
24 3/4"	1,23	1/2"	15	1/2"	490
25"	1,23	1/2"	15	1/2"	495
25 1/4"	1,23	1/2"	15	1/2"	500
25 1/2"	1,23	1/2"	15	1/2"	505
25 3/4"	1,23	1/2"	15	1/2"	510
26"	1,23	1/2"	15	1/2"	515
26 1/4"	1,23	1/2"	15	1/2"	520
26 1/2"	1,23	1/2"	15	1/2"	525
26 3/4"	1,23	1/2"	15	1/2"	530
27"	1,23	1/2"	15	1/2"	535
27 1/4"	1,23	1/2"	15	1/2"	540
27 1/2"	1,23	1/2"	15	1/2"	545
27 3/4"	1,23	1/2"	15	1/2"	550
28"	1,23	1/2"	15	1/2"	555
28 1/4"	1,23	1/2"	15	1/2"	560
28 1/2"	1,23	1/2"	15	1/2"	565
28 3/4"	1,23	1/2"	15	1/2"	570
29"	1,23	1/2"	15	1/2"	575
29 1/4"	1,23	1/2"	15	1/2"	580
29 1/2"	1,23	1/2"	15	1/2"	585
29 3/4"	1,23	1/2"	15	1/2"	590
30"	1,23	1/2"	15	1/2"	595
30 1/4"	1,23	1/2"	15	1/2"	600
30 1/2"	1,23	1/2"	15	1/2"	605
30 3/4"	1,23	1/2"	15	1/2"	610
31"	1,23	1/2"	15	1/2"	615
31 1/4"	1,23	1/2"	15	1/2"	620
31 1/2"	1,23	1/2"	15	1/2"	625
31 3/4"	1,23	1/2"	15	1/2"	630
32"	1,23	1/2"	15	1/2"	635
32 1/4"	1,23	1/2"	15	1/2"	640
32 1/2"	1,23	1/2"	15	1/2"	645
32 3/4"	1,23	1/2"	15	1/2"	650
33"	1,23	1/2"	15	1/2"	655
33 1/4"	1,23	1/2"	15	1/2"	660
33 1/2"	1,23	1/2"	15	1/2"	665
33 3/4"	1,23	1/2"	15	1/2"	670
34"	1,23	1/2"	15	1/2"	675
34 1/4"	1,23	1/2"	15	1/2"	680
34 1/2"	1,23	1/2"	15	1/2"	685
34 3/4"	1,23	1/2"	15	1/2"	690
35"	1,23	1/2"	15	1/2"	695
35 1/4"	1,23	1/2"	15	1/2"	700
35 1/2"	1,23	1/2"	15	1/2"	705
35 3/4"	1,23	1/2"	15	1/2"	710
36"	1,23	1/2"	15	1/2"	715
36 1/4"	1,23	1/2"	15	1/2"	720
36 1/2"	1,23	1/2"	15	1/2"	725
36 3/4"	1,23	1/2"	15	1/2"	730
37"	1,23	1/2"	15	1/2"	735
37 1/4"	1,23	1/2"	15	1/2"	740
37 1/2"	1,23	1/2"	15	1/2"	745
37 3/4"	1,23	1/2"	15	1/2"	750
38"	1,23	1/2"	15	1/2"	755
38 1/4"	1,23	1/2"	15	1/2"	760
38 1/2"	1,23	1/2"	15	1/2"	765
38 3/4"	1,23	1/2"	15	1/2"	770
39"	1,23	1/2"	15	1/2"	775
39 1/4"	1,23	1/2"	15	1/2"	780
39 1/2"	1,23	1/2"	15	1/2"	785
39 3/4"	1,23	1/2"	15	1/2"	790
40"	1,23	1/2"	15	1/2"	795
40 1/4"	1,23	1/2"	15	1/2"	800
40 1/2"	1,23	1/2"	15	1/2"	805
40 3/4"	1,23	1/2"	15	1/2"	810
41"	1,23	1/2"	15	1/2"	815
41 1/4"	1,23	1/2"	15	1/2"	820
41 1/2"	1,23	1/2"	15	1/2"	825
41 3/4"	1,23	1/2"	15	1/2"	830
42"	1,23	1/2"	15	1/2"	835
42 1/4"	1,23	1/2"	15	1/2"	840
42 1/2"	1,23	1/2"	15	1/2"	845
42 3/4"	1,23	1/2"	15	1/2"	850
43"	1,23	1/2"	15	1/2"	855
43 1/4"	1,23	1/2"	15	1/2"	860
43 1/2"	1,23	1/2"	15	1/2"	865
43 3/4"	1,23	1/2"	15	1/2"	870
44"	1,23	1/2"	15	1/2"	875
44 1/4"	1,23	1/2"	15	1/2"	880
44 1/2"	1,23	1/2"	15	1/2"	885
44 3/4"	1,23	1/2"	15	1/2"	890
45"	1,23	1/2"	15	1/2"	895
45 1/4"	1,23	1/2"	15	1/2"	900
45 1/2"	1,23	1/2"	15	1/2"	905
45 3/4"	1,23	1/2"	15	1/2"	910
46"	1,23	1/2"	15	1/2"	915
46 1/4"	1,23	1/2"	15	1/2"	920
46 1/2"	1,23	1/2"	15	1/2"	925
46 3/4"	1,23	1/2"	15	1	