

1.1 GENERAL

- A. **Submittals:** In addition to product certificates, submit the following where applicable:
1. Certification of grass seed from seed vendor for all applicable.
 2. List of plant suppliers and anticipated delivery dates.
 3. Provide sample or product data of planting mix, top soil, fertilizers, pre-emergent and mulch or any other treatment required for project.

- B. **Quality Assurance:** Provide trees, shrubs, ground covers, and plants of quality size, genus, species, and variety indicated, complying with applicable requirements of ANSI Z601 "American Standard for Nursery Stock." Materials that do not meet the above mentioned requirements may be rejected.
- C. **Special Warranty:** Nourish trees, shrubs and ground covers for a period of one year after date of substantial completion, against defects including death and unsatisfactory growth. Contractor shall provide and pay for all necessary watering, fertilizing, pruning, and other abnormal weather conditions unusual for warranty period, or incidents which are beyond Contractor's control.

1. Remove and replace any unhealthy and dead trees and shrubs within the warranty period.

- D. Maintain and establish lawns by watering, fertilizing, weeding, mowing, trimming, replanting, and other operations to produce a uniformly smooth lawn for not less than the following:

1. Seeded Lawns: 60 days after date of substantial completion.
2. Sodded Lawns: 30 days after date of substantial completion.

1.2 PRODUCTS

- A. **Trees and Shrubs:** Well-shaped, fully branched, healthy, vigorous nursery-grown stock of all sizes and grades indicated, free of disease, insects, eggs, larvae, and defects, conforming to ANSI Z601.
1. Provide balled and burlapped trees and shrubs, or
2. Provide container grown trees and shrubs.
- B. **Ground Covers and Plants:** Established and well rooted in removable containers or integral peat pots and with not less than the minimum number and length of runners required by ANSI Z601 for the pot size indicated.

- C. **Grass Seed:** Fresh, clean, dry, new-crop seed complying with the Association of Official Seed Analysts' Rules for Testing Seeds for purity and germination tolerances.

1. **Seed Mixture:** Provide seed of grass species and varieties, proportions by weight, and minimum percentages of purity, germination, and maximum percentage of weed seed as indicated.

- D. **Sod:** Certified turfgrass sod complying with ASFA specifications for machine-cut thickness, native origin, moisture content, and uniformity of color and texture, and free of disease, insects, and capable of vigorous growth and development when planted.

1. **Species:** Provide sod of grass species and varieties, proportions by weight, and minimum percentages of purity, germination, and maximum percentage of weed seed as indicated.

- E. **Planting mix:** ASTM D 5268, pH range of 5.5 to 7.4 percent organic material minimum, free of stakes 1 inch (25 mm) or larger in any dimension, and other extraneous materials harmful to plant growth.

- F. **Planting mix:** Equal parts of sharp sand, peat moss and composted bark.

1. **Lime:** ASTM C 602, Class I, agricultural limestone.

6. **Peat:** Humus: Finely divided or granular texture, with a pH range of 6 to 7.5, composed of partially decomposed moss peat (other than sphagnum), peat humus, or reed-sedge peat.

- H. **Sawdust or Ground-Bark-Humus:** Decomposed, nitrogen-treated, of uniform texture, free of chips, stones, sticks, soil, or toxic materials.

- I. **Bonemeal:** Commercial, raw, finely ground, minimum of 4 percent nitrogen and 20 percent phosphoric acid.

- J. **Superphosphate:** Commercial, phosphate mixture, soluble, minimum of 20 percent available phosphoric acid.

- K. **Lawn Fertilizer:** Commercial-grade complete fertilizer of neutral character, consisting urea-form, phosphorus, and potassium.

- L. **Planting bed Fertilizer:** Osmocote classic B-B-13 6 to 9 month longevity or approved equal Apply in accordance to manufacturer's specifications.

- M. **Pre-emergent Herbicide:** Epiam 20-d or approved equal. Apply in accordance to manufacturer's specifications.

- N. **Organic Mulch:** Organic mulch, free from deleterious materials and suitable as a top dressing, consisting of ground or shredded bark, wood or bark chips, salt hay or threshed straw, or shredded hardwood.

- O. **Mineral Mulch:** Hard, durable riverbed gravel or crushed stone, washed free of loam, sand, clay, and other foreign substances.

1. **Size Range:** 1-1/2 inches (38 mm) maximum, 3/4 inch (19 mm) minimum.

- P. **Steel Edging:** ASTM A 564 (ASTM A 564M) rolled edge, standard painted steel edging and accessories fabricated in sections with loops stamped from or welded to face of sections approximately 30 inches (760 mm) apart to receive stakes. Cuts required to install edging to be sanded and painted to match factory finish.

1. **Edging Size:** 3/16 inch (4.8 mm) wide by 4 inches (102 mm) deep.

1.3 EXECUTION

- A. **Planting Mix Preparation:** Before mixing, close topsoil of roots, plants, sods, stones, clay lumps, and other extraneous materials harmful to plant growth. Mix soil amendments and fertilizers with topsoil at rates indicated.
- B. **Lawn Planting Preparation (Disturbed):** Loosen subgrade to a minimum depth of 4 inches (100 mm). Remove stones larger than 1-1/2 inches (38 mm) in any dimension and sticks, roots, rubbish, and other extraneous materials.

1. **Spread topsoil mix mixture to depth required to meet thickness, grades, and elevations shown, after light rolling and natural settlement. Do not spread if planting soil or subgrade is frozen.**
2. **Place approximately 1/2 the thickness of topsoil mixture required. Mark into top of loosened subgrade to create a transition layer and then place remainder of topsoil mixture.**

- C. **Lawn Planting Preparation (Undisturbed):** Where lawns are to be planted in areas watered or undisturbed by excavating, grading, or surface soil stripping operations, remove and dispose of existing grass, vegetation, and turf.

1. **Till surface soil to a depth of at least 6 inches (150 mm). Apply soil amendments and initial fertilizers and mix thoroughly into top 4 inches (100 mm) of soil. Trim high areas and fill in depressions. Till soil to a homogenous mixture of fine texture.**

- D. **Moisten prepared lawn areas before planting when soil is dry and allow surface to dry before planting.**

- E. **Ground Cover and Plant Bed Preparation:** Loosen subgrade of planting bed areas to a minimum depth of 6 inches (150 mm). Remove stones larger than 1-1/2 inches (38 mm) in any dimension and sticks, roots, rubbish, and other extraneous materials.

1. **Spread planting soil mixture to depth required to meet thickness, grades, and elevations shown, after light rolling and natural settlement. Place approximately 1/2 the thickness of planting soil mixture required. Mark into top of loosened subgrade to create a transition layer and then place remainder of planting soil mixture.**

- F. **Excavation for Trees and Shrubs:** Excavate pits with vertical sides and with bottom of pits sloping slightly away from the tree or shrub. Excavate to a depth of 12 inches (305 mm) as wide as ball diameter and deep enough to allow placing of root ball on a setting layer of planting soil. Loosen hard subsoil in bottom of excavation.

6. **Planting Trees and Shrubs:** Set stock plumb and in center of pit or trench with top of ball raised above adjacent finish grade.

1. **Place a setting layer of compacted planting soil.**
2. **Remove burlap and wire baskets from tops of balls and partially from sides, but do not remove from under balls. Do not use planting stock if ball is cracked or broken before or during planting operation.**

3. **Place backfill around ball in layers, tamping to settle backfill and eliminate voids and air pockets. Fill around ball to a depth of 12 inches (305 mm) above top of root ball.**
4. **Dish and tamp top of backfill to form a 3-inch- (75-mm-) high mound around the rim of the pit. Do not cover top of root ball with backfill.**

- H. **Tree and Shrub Pruning:** Prune, thin, and shape trees and shrubs according to standard horticultural practice. Prune trees to retain required height and spread. Do not cut tree limbs or branches of trees. Prune shrubs to retain natural character. Shrub sizes indicated are size after pruning.

- I. **Planting Ground Cover and Plants:** Plant spacing according to plan, unless otherwise indicated. Dig holes large enough to allow spreading of roots, and backfill with planting soil. Mark soil around roots to eliminate air pockets and leave a slight saucer indentation around each root. Water thoroughly after planting, taking care not to cover plant crowns with wet soil.

- J. **Planting Bed Fertilizer:** Install per manufacturer recommendations

- K. **Pre-Emergent Herbicide:** Install per manufacturer recommendations

- L. **Mulching:** Completely cover area to be mulched. Apply mulch and finish level with adjacent finish grade. Do not place mulch against trunks or stems.

1. **Mulch Type and Thickness:** Cut pine straw, 4 inches (100 mm) thick as indicated on drawings.

- M. **Seeding Lawns:** Sow seed with a spreader or a seeding machine. Do not broadcast or drop seed when wind velocity exceeds 5 mph (8 km/h). Evenly distribute seed by sowing equal quantities in 2 directions at right angles to each other. Rake seed lightly into top 1/8 inch (3 mm) of topsoil, roll lightly, and water with fine spray.

1. **Seeding Rate:** 8 to 4 lb. per 1000 sq. ft. (1.5 to 2 kg per 100 sq. m).
2. **Protect seeded areas with slopes less than 1:6 against erosion by spreading straw mulch after completion of seeding operations and anchor by crimping into topsoil. Spread uniformly at a minimum rate of 2 tons per acre (45 kg per 100 sq. m).**

- N. **Sodding Lawns:** Lay sod to form a solid mass with tightly fitted joints within 24 hours of installation. Firm joints by rolling with a roller or by tamping. Water sods immediately to effect joints in adjacent courses. Avoid damage to subgrade or sod during installation. Tamp and roll lightly to ensure contact with subgrade, eliminate air pockets, and form a smooth surface. Mark silted soil or fine sand into minor cracks between pieces of sod. Remove excess to avoid smothering sod and adjacent grass.

1. **Anchor sod on slopes exceeding 1:6 with wood pegs spaced as recommended by sod manufacturer.**

2. **Saturate sod with fine water spray within 2 hours of planting. Drying first week. Water daily or more frequently as necessary to maintain moist soil to a minimum depth of 1-1/2 inches (38 mm) below the sod.**

- O. **Edging:** Install edgings where indicated and anchor with stakes driven below top elevation of edging according to manufacturer's recommendations.

- P. **Disposal:** Remove surplus soil and waste material, including excess subsoil, unsuitable soil, trash, and debris, and legally dispose of it off the Owner's property.

END OF SECTION 02300

MINIMUM 6" GARDEN SOIL TO BE TILLED INTO EXISTING SOIL AFTER ALL GRASS AND WEEDS ARE REMOVED. PRE-EMERGENT HERBICIDE TO BE APPLIED AS PER MANUFACTURER'S RECOMMENDATIONS.

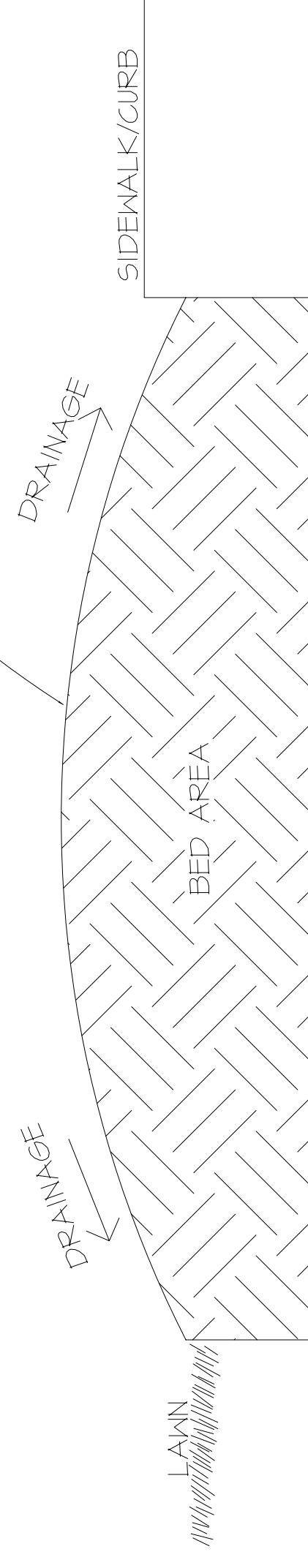

1.1 SOD MOUNDING DETAIL

1-1/2 NTS

PLANT SCHEDULE

Quantity	Symbol	Scientific Name	Common Name	Planting Size
125		Agapanthus africanus	Blue lily of Nile	1-Gal
46		Camellia Sasanqua 'Shi-Shi'	Shi-Shi Camellia	3-Gal
533		Dietes spp.	Butterfly Iris	1-Gal
28		Ilex attenuata 'Savannah'	Savannah Holly	10'-12' O.A.
43		Ilex cornuta 'Burfordii Nana'	Dwarf Burford Holly	3-Gal
11		Nellie R. Stevens Holly	Nellie R. Stevens Holly	15-Gal
690		Juniperus chinensis 'Parsonii'	Parson Juniper	3-Gal
20		Lagerstroemia indica 'Natchez'	Natchez white Grape Myrtle	12'-14' O.A., MUL.T.
8		Ligustrum japonicum	Tree Form Ligustrum	12' - 14' o.a.
45		Miscanthus sinensis	Japanese silver grass	3-Gal
19		Quercus phellos	Willow oak	2"-Cal 10' Min.
38		Quercus virginiana	Southern live oak	3"-Cal 12' Min.
502		Raphiolepis indica 'Snow White'	Snow White Indian Hawthorn	3-Gal
31		Taxodium distichum	Bald cypress	2"-Cal 10' Min.
2		Trachycarpus fortunei	Windmill palm	5' C.T.
34		Viburnum odoratissimum	Sweet viburnum	1-Gal
4-8,5005Y		Class 'A' Bermuda Sod	Class 'A' Bermuda Sod	Squares
4-1,1005Y		Hydroseed	Hydroseed	5Y

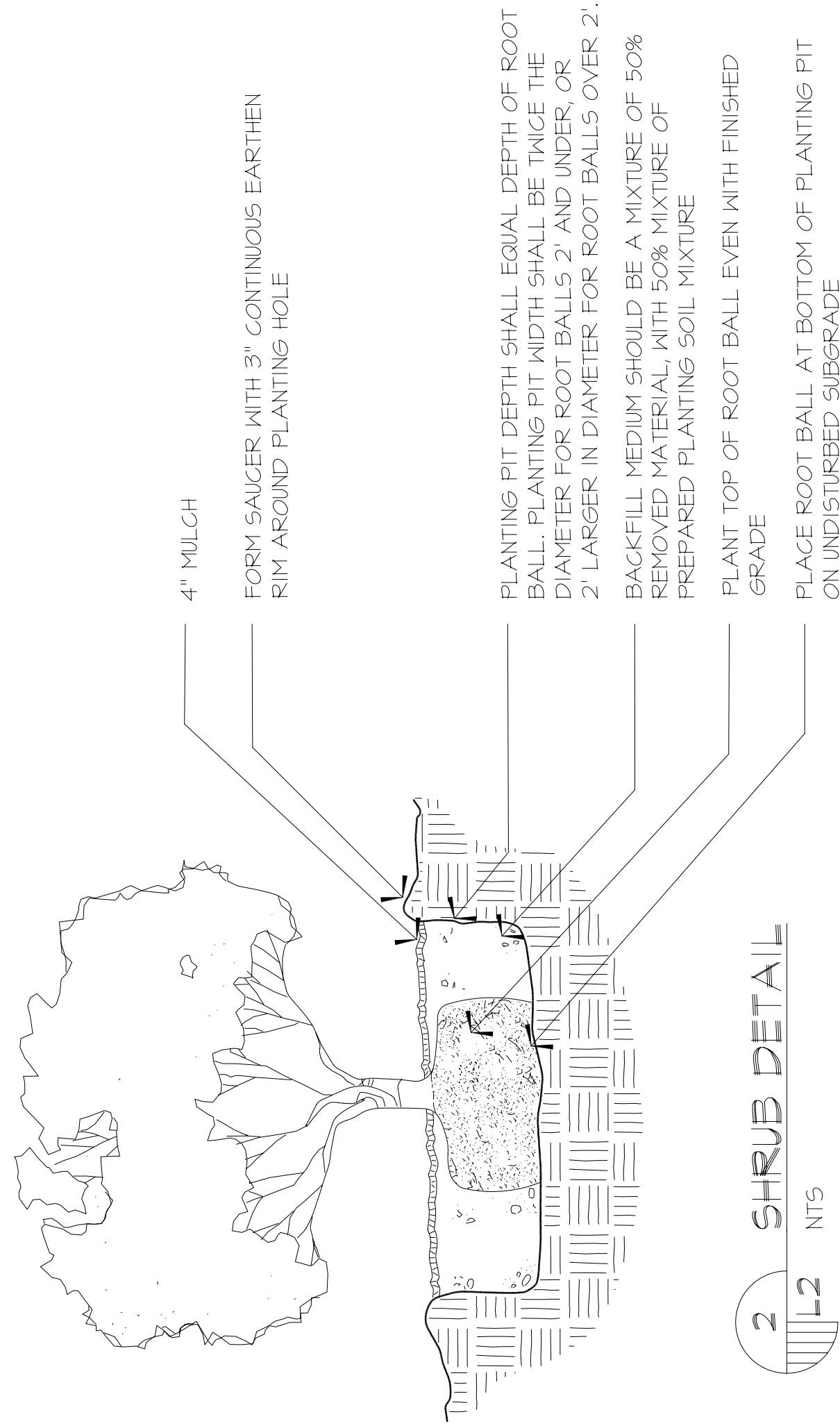

2 SHRUB DETAIL

1-1/2 NTS

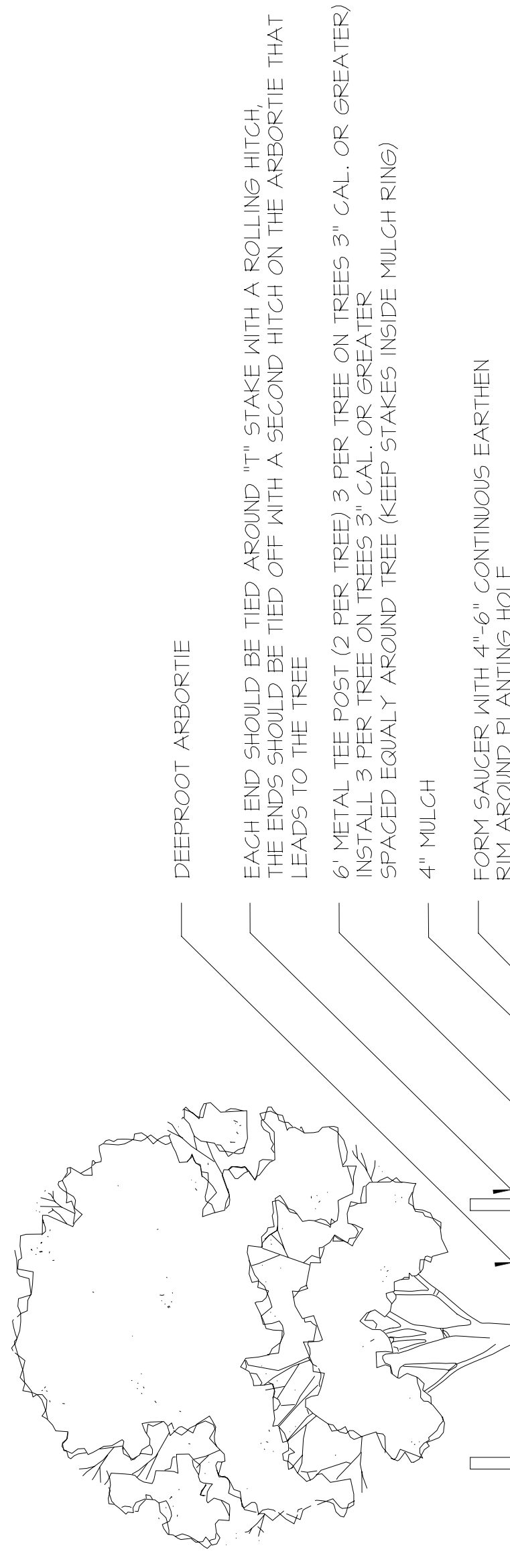

3 TREE DETAIL

1-1/2 NTS

ST. TAMMANY PARISH SHERIFFS OFFICE
BROWNSWITCH ROAD
SLIDELL, LOUISIANA

CONSTRUCTION DOCUMENTS

LANDSCAPE SPECS/DETAILS

Sheet Number:

L2