

4 CABLE SCHEDULE

NO SCALE

LEGEND	CIRCUIT LABEL	SPECIFICATION	NOTES
DOOR CONTROLLER	03	CABLE - FIBER RATED UNSHIELDED	DOOR CONTROLLER
CARD ACCESS READER	04	1 - #12 UNSHIELDED	DOOR CONTROLLER
DOOR CONTACT	05	1 - #16 TWISTED STRANDED OVERALL SHIELDED	READER BOARD PORT
ELECTRIC MOTOR/SHINE	06	1 - #6/2 SHIELDED	INPUT PORT COMMON
CCTV CAMERA WITH NEUTRAL	07	1 - #6/2 SHIELDED	OUTPUT NO. AND COMMON
CCTV CAMERA WITH NEUTRAL	08	1 - #6/2 SHIELDED	PROVIDE SEPARATE POWER CIRCUITRY FOR CAMERA OPERATION
VEHICLE DETECTION CONTROLLER	09	1 - #6/2 SHIELDED	PROVIDE SEPARATE POWER CIRCUITRY FOR CAMERA OPERATION
CCTV CAMERA WITH NEUTRAL	10	1-50/75 MULTICORE 50/ HICKON FIBER OPTIC, 10 GIG LASER ENHANCED	PROVIDE SEPARATE POWER CIRCUITRY FOR CAMERA OPERATION
DOOR RELEASE	11	1 - #6/2 UNSHIELDED	CONNECT TO 1488 NOTIFICATION
DIAGNOSIS BUTTON	12	1 - #6/2 UNSHIELDED	CONNECT TO 1488 NOTIFICATION
VOICE-DATA COMMUNICATION	13	24 AWG SHIELDED 4 PAIR CATEGORY 5E	CONNECT TO 1488 NOTIFICATION
VOICE	14	24 AWG SHIELDED 4 PAIR CATEGORY 5E	CONNECT TO 1488 NOTIFICATION
CATV	15	1 - RG6U UNSHIELDED	WHITE JACKETS
MONITOR	16	1 - #6/2 UNSHIELDED	WHITE JACKETS
ANTENNA / SATELLITE	17	32 AWG SHIELDED 4 PAIR CATEGORY 6 RATED PROVIDE (7) CABLES PER DEVICE	BLUE BLUE BLUE BLUE JACKETS
CCTV CAMERA WITH WEATHER PROOF AND INSTALLATION	18	1-50/75 MULTICORE 50/ HICKON FIBER OPTIC, 10 GIG LASER ENHANCED	CAMERA TO BE PAINT-TILT-ZOOM PROVIDE SEPARATE POWER CIRCUITRY FOR CAMERA OPERATION

5 OUTLET DETAIL

NO SCALE

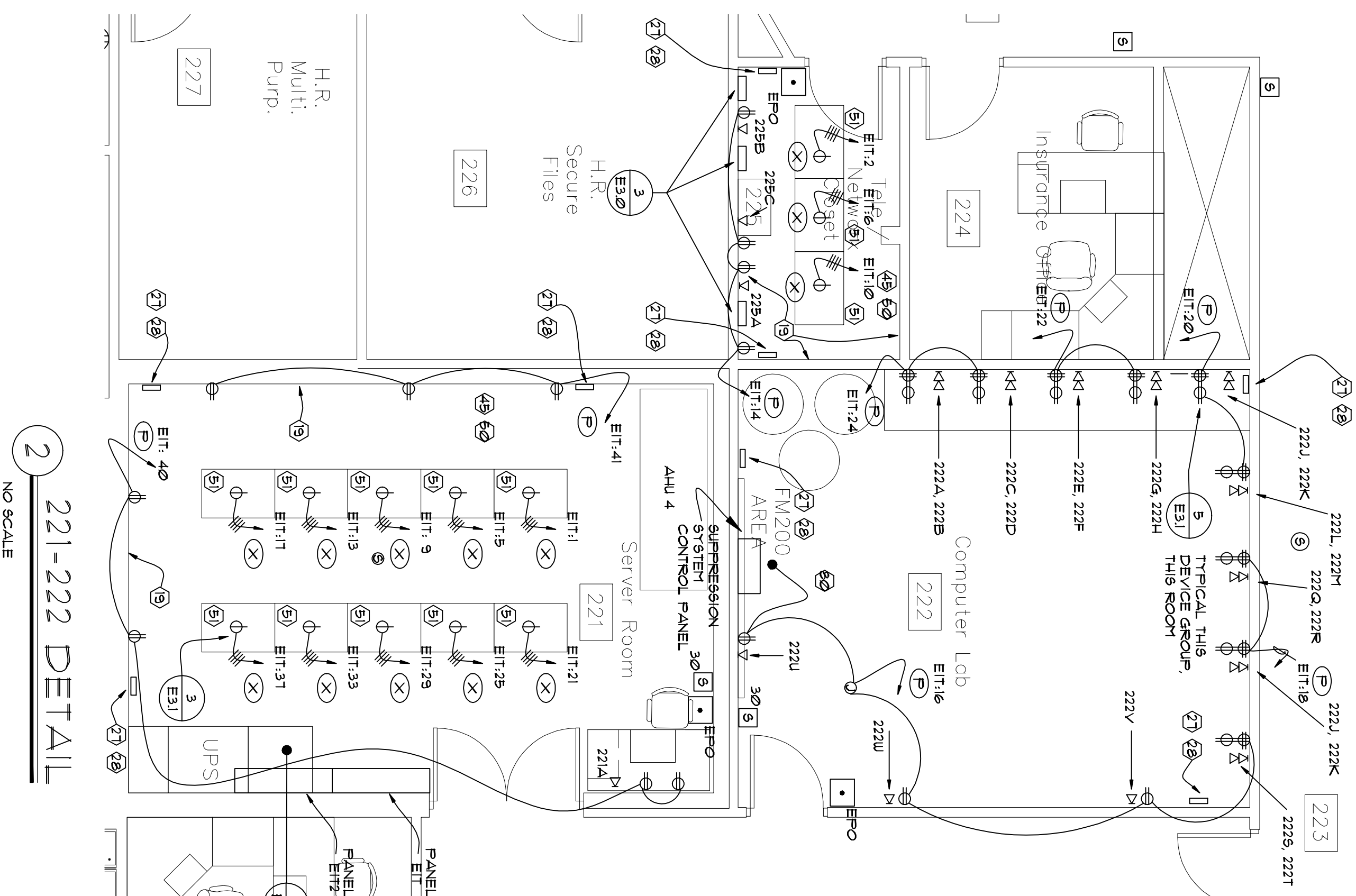
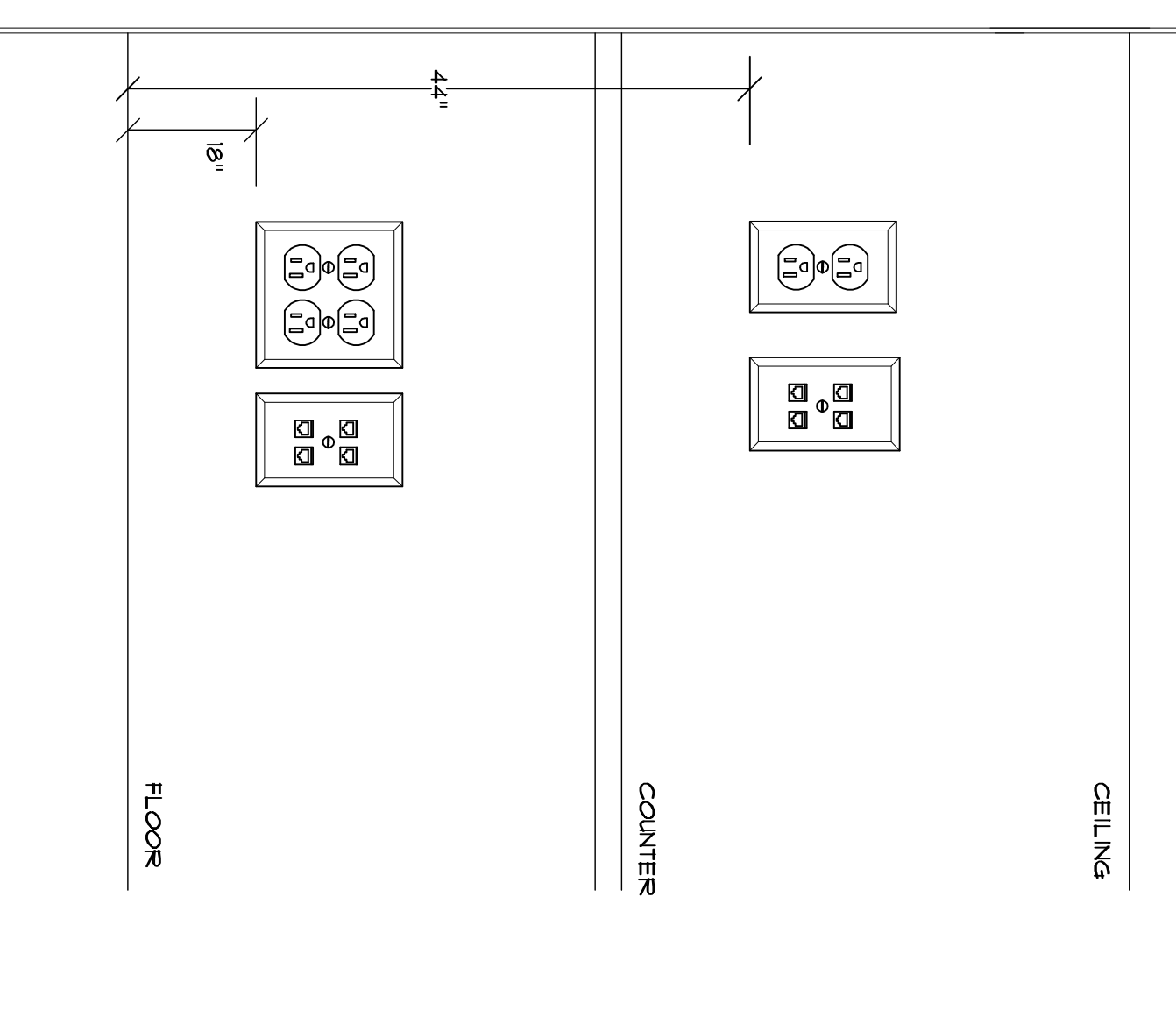

2 221-222 DETAIL
NO SCALE

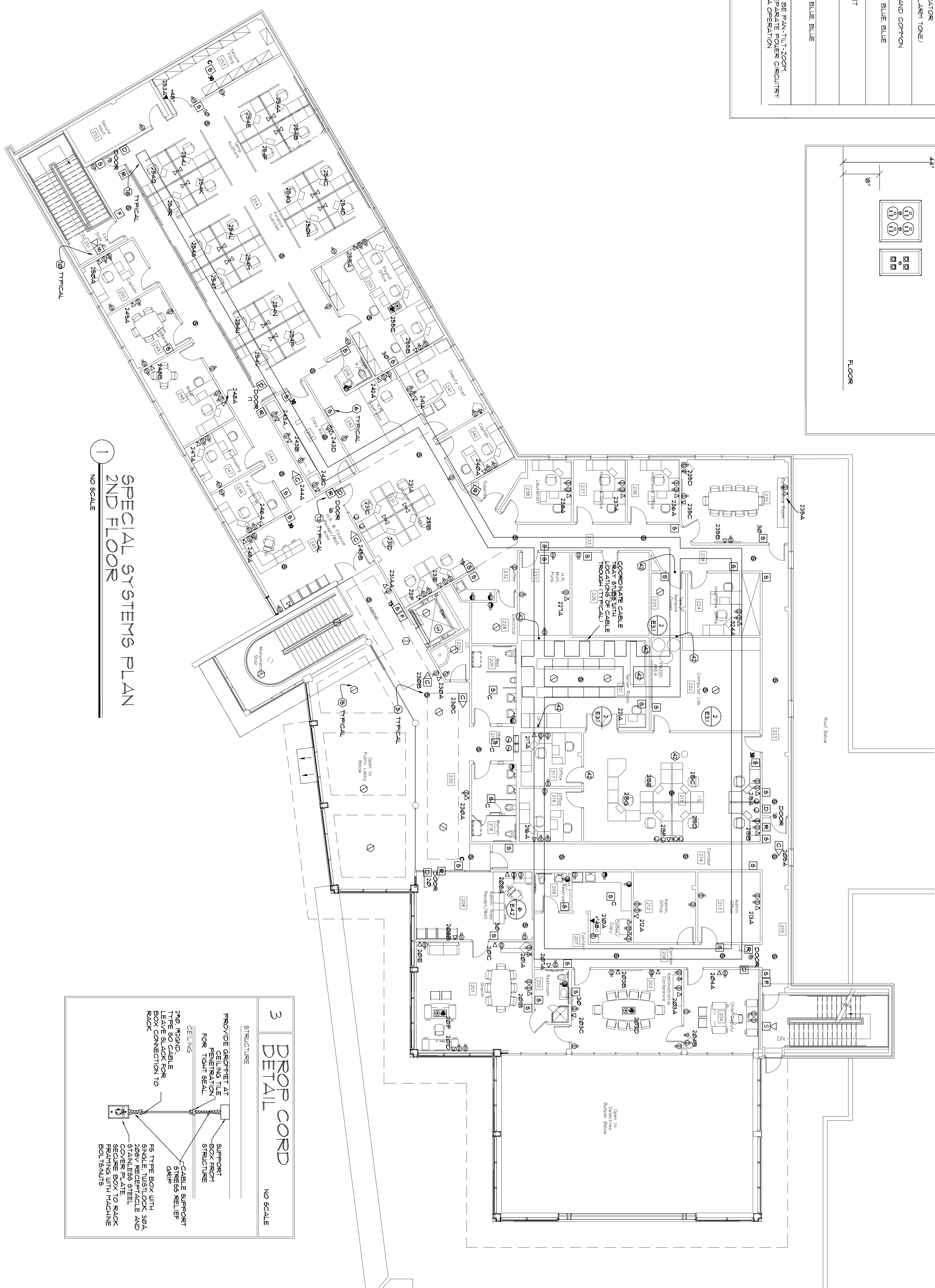

1 SPECIAL SYSTEMS PLAN
2ND FLOOR
NO SCALE

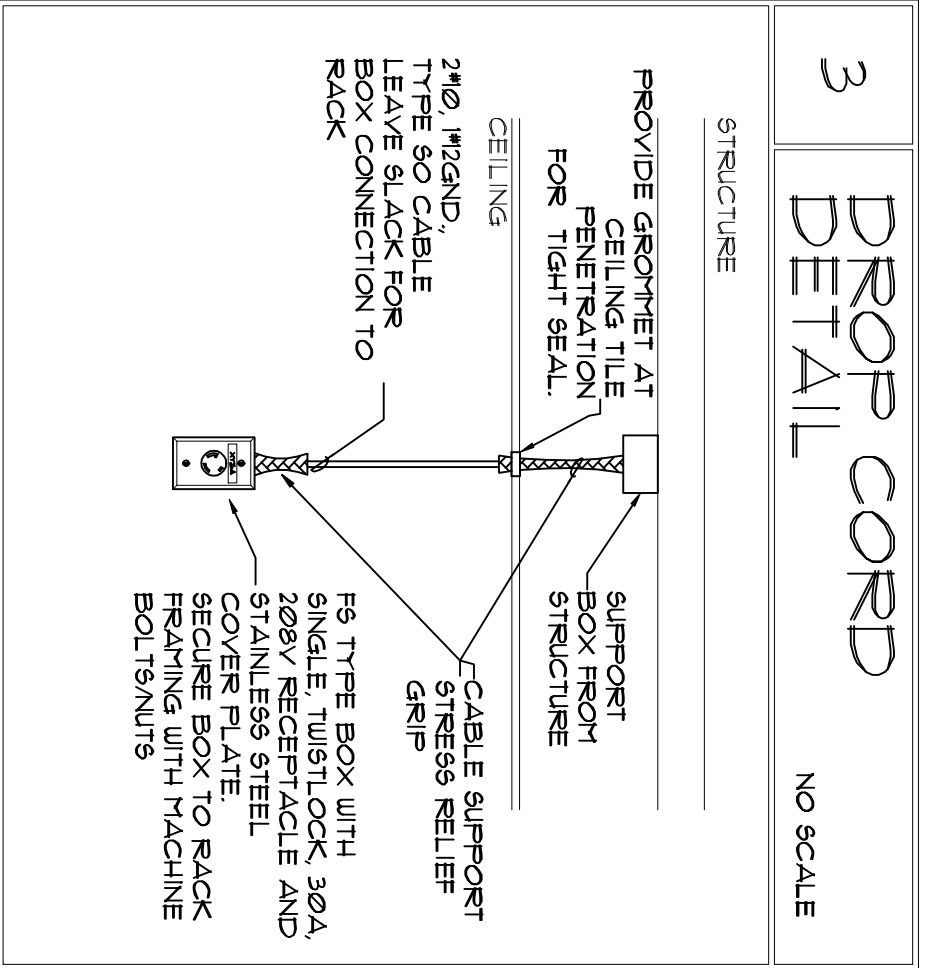

3 DROPCORD
NO SCALE

Engineering Design Associates, L.L.C.
3390 Ridgeway Drive Suite 100 Metairie, Louisiana 70002
504 836 3889 • 504 836 3887 (fax) • ead@engdesignassociates.com

ST. TAMMANY PARISH SHERIFF'S OFFICE
BROWNSWITCH ROAD
SLIDELL, LOUISIANA

Project Number: 0687
Date Issued: 05/15/07
Drawn By: EDA
Checked By: EDA
Revisions:

RCL
Richard C. Lambert
Architect
Engineering
Construction
Management

Richard C. Lambert
Consulting LLC
521 N. Calumet Blvd.
Metairie, LA 70002
Phone: 504.885.7242
Fax: 504.885.7242
Web: www.rclllc.com
100-0017242

This drawing and design is the exclusive property of Richard C. Lambert Consulting LLC and shall remain the property of RCL. Reproduction and further distribution is prohibited.

SPECIAL SYSTEMS PLAN
2ND FLOOR
Sheet Number: E3.1