

LEGEND

- BUILDING
- EXISTING RIGHT OF WAY
- SERVITUDE
- CATCH BASIN
- CULVERT
- DROP INLET, DRAIN LINE
- DROP INLET, DRAIN LINE
- COMMUNICATIONS MANHOLE, LINE
- DRAIN MANHOLE, DRAIN LINE
- ELECTRICAL MANHOLE, ELEC. LINE
- GAS MANHOLE, GAS LINE
- SEWER MANHOLE, SEWER LINE
- TELEPHONE MANHOLE, TELE LINE
- TRAFFIC MANHOLE, TRAFFIC LINE
- WATER MANHOLE, WATER LINE
- UTILITY POLE / OVERHEAD LINES
ELECTRIC, TELEPHONE, CABLE TV
- FIBER OPTIC RISER / LINE
- FENCE
- TELCO RISER / PEDISTAL
- UTILITY CLEANOUT
- UTILITY METER
- UTILITY PEDESTAL
- UTILITY VALVE
- UTILITY VALVE VAULT
- FIRE HYDRANT
- LIGHT STANDARD
- TRAFFIC SIGNAL POLE
- TRAFFIC LIGHT POWER VAULT
- CANOPY SUPPORT
- BOLLARD
- SIGN
- TREE
- RESIDENTIAL MAILBOX
- PP DEADMAN

GENERAL NOTES

THE LOCATIONS OF UNDERGROUND AND OTHER NONVISIBLE UTILITIES SHOWN HEREON HAVE BEEN DETERMINED FROM DATA EITHER FURNISHED BY THE AGENCIES CONTROLLING SUCH DATA AND/OR EXTRACTED FROM RECORDS MADE AVAILABLE TO US BY THE AGENCIES CONTROLLING SUCH RECORDS. WHERE FOUND, THE SURFACE FEATURES OF LOCATIONS ARE SHOWN. THE ACTUAL NONVISIBLE LOCATIONS MAY VARY FROM THOSE SHOWN HEREON. EACH AGENCY SHOULD BE CONTACTED RELATIVE TO THE PRECISE LOCATION OF ITS UNDERGROUND INSTALLATION PRIOR TO ANY RELIANCE UPON THE ACCURACY OF SUCH LOCATIONS SHOWN HEREON, INCLUDING PRIOR TO EXCAVATION AND DIGGING.

BASIS OF ELEVATION

ELEVATIONS SHOWN ON THIS SURVEY ARE BASED ON THE NORTH AMERICAN VERTICAL DATUM OF 1988 (NAVD88) UTILIZING GEOID 12A. THEY ARE DERIVED FROM GPS OBSERVATIONS REFERENCED TO THE LOUISIANA STATE UNIVERSITY CONTINUOUSLY OPERATING REFERENCE STATIONS NETWORK IN ACCORDANCE WITH LOUISIANA R.S. 50:173.1 COVERING VERTICAL CONTROL STANDARDS.

SERVITUDES

THE SERVITUDES AND RESTRICTIONS SHOWN ON THIS SURVEY ARE LIMITED TO THOSE SET FORTH IN THE DESCRIPTION FURNISHED US AND THERE IS NO REPRESENTATION THAT ALL APPLICABLE SERVITUDES AND RESTRICTIONS ARE SHOWN HEREON. THE SURVEYOR HAS MADE NO TITLE SEARCH OR PUBLIC RECORD SEARCH IN COMPILING THE DATA FOR THIS SURVEY.

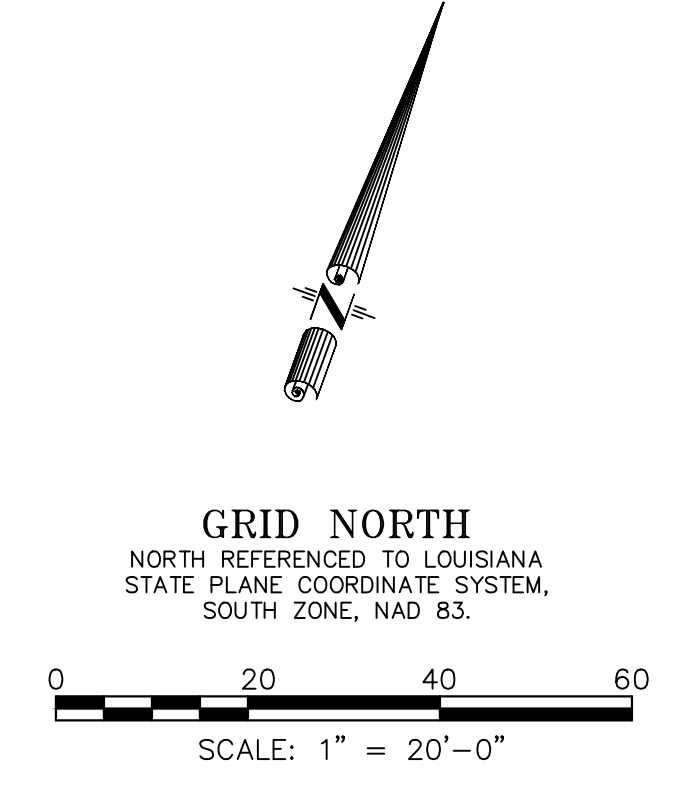
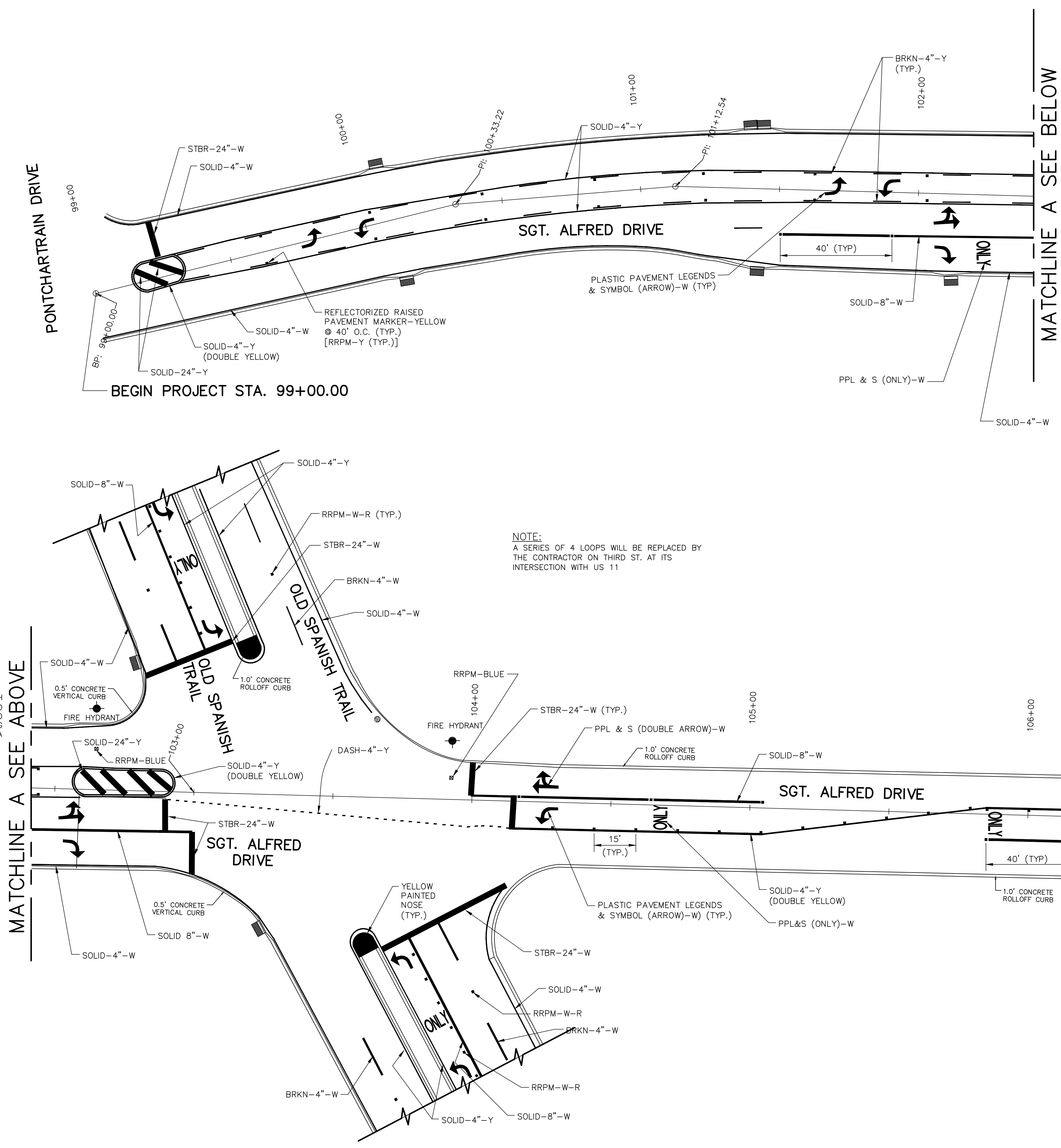

NOTE:
A SERIES OF 4 LOOPS WILL BE REPLACED BY THE CONTRACTOR ON THIRD ST. AT ITS INTERSECTION WITH US 11

LEGEND:

- EX. WATER METER
- EX. WATER VALVE
- EX. TELEPHONE MANHOLE
- EX. OVERHEAD TRAFFIC SIGNAL
- EX. TRAFFIC SIGN
- NEW TRAFFIC SIGN
- TRAFFIC DIRECTION, FOR INFORMATION ONLY
- SOLID-4"-W . . . THERMOPLASTIC PAVEMENT STRIPING SOLID-4"-WHITE
- SOLID-4"-Y . . . THERMOPLASTIC PAVEMENT STRIPING SOLID-4"-YELLOW
- SOLID-8"-W . . . THERMOPLASTIC PAVEMENT STRIPING SOLID-8"-WHITE
- BRKN-4"-W . . . THERMOPLASTIC PAVEMENT STRIPING BROKEN-4"-WHITE
- BRKN-4"-Y . . . THERMOPLASTIC PAVEMENT STRIPING BROKEN-4"-YELLOW
- DASH-4"-Y . . . THERMOPLASTIC PAVEMENT STRIPING DASH-4"-YELLOW
- CRWK-8"-W . . . THERMOPLASTIC PAVEMENT CROSS WALK SOLID-8"-WHITE
- STBR-24"-W . . . THERMOPLASTIC PAVEMENT STOP BAR SOLID-24"-WHITE
- PPL&S (ARROW)-W . . . THERMOPLASTIC PAVEMENT LEGENDS & SYMBOLS-ARROW-WHITE
- PPL&S (ONLY)-W . . . THERMOPLASTIC PAVEMENT LEGENDS & SYMBOLS-ONLY-WHITE
- PPL&S (SCHOOL)-Y . . . THERMOPLASTIC PAVEMENT LEGENDS & SYMBOLS-SCHOOL-YELLOW
- RRPM-W-R . . . REFLECTORIZED RAISED PAVEMENT MARKER-WHITE-RED
- RRPM-Y . . . REFLECTORIZED RAISED PAVEMENT MARKER-YELLOW
- NRRPM-Y . . . NONREFLECTORIZED RAISED PAVEMENT MARKER-YELLOW

CITY OF SLIDELL ENGINEERING DEPARTMENT

NO.	DATE	DESCRIPTION	BY	RAC
1	9.7.16	GENERAL STRIPING REVISIONS		

Infinity Engineering Consultants, LLC
 CIVIL STRUCTURAL ELECTRICAL MARINE
 504-308-0548
 NEW ORLEANS, LA
 DRAWN BY: PHAN THI NGUYEN
 DESIGN/CHECK BY: TUNG THANH N'VIETSON
 APPROVED BY: TUNG THANH N'VIETSON

SGT. ALFRED DRIVE ROADWAY IMPROVEMENTS
 CITY OF SLIDELL, LA.
STRIPING PLANS (SHEET 1 OF 7)
 City Project No. 600-141
 Date MAY 2016
 Scale AS NOTED
 Sheet 11 OF 22

