

LEGEND

- EXISTING RIGHT OF WAY
- ST --- EXISTING STREET
- O --- OLVERT
- D --- DROP INLET DRAIN LINE
- G --- DROP INLET DRAIN LINE
- S --- GAS MANHOLE, GAS LINE
- T --- SEWER MANHOLE, SEWER LINE
- TR --- TELEPHONE MANHOLE, TELE LINE
- W --- TRAFFIC MANHOLE, TRAFFIC LINE
- W --- WATER MANHOLE, WATER LINE
- W --- UTILITY POLE / OVERHEAD LINES
- W --- ELECTRIC, TELEPHONE, CABLE TV
- X --- FENCE
- S --- SEWER CLEANOUT
- M --- WATER METER
- I --- UTILITY PEDESTAL
- V --- UTILITY VALVE
- V --- UTILITY VALVE VAULT
- H --- FIRE HYDRANT
- L --- LIGHT STANDARD
- S --- SIGN
- T --- TREE
- M --- RESIDENTIAL MAILBOX
- P --- PP DEWMAN
- C --- CONCRETE HATCH/DRIVEWAY
- G --- GRAVEL HATCH/DRIVEWAY
- X 0.00 --- SPOT ELEVATION

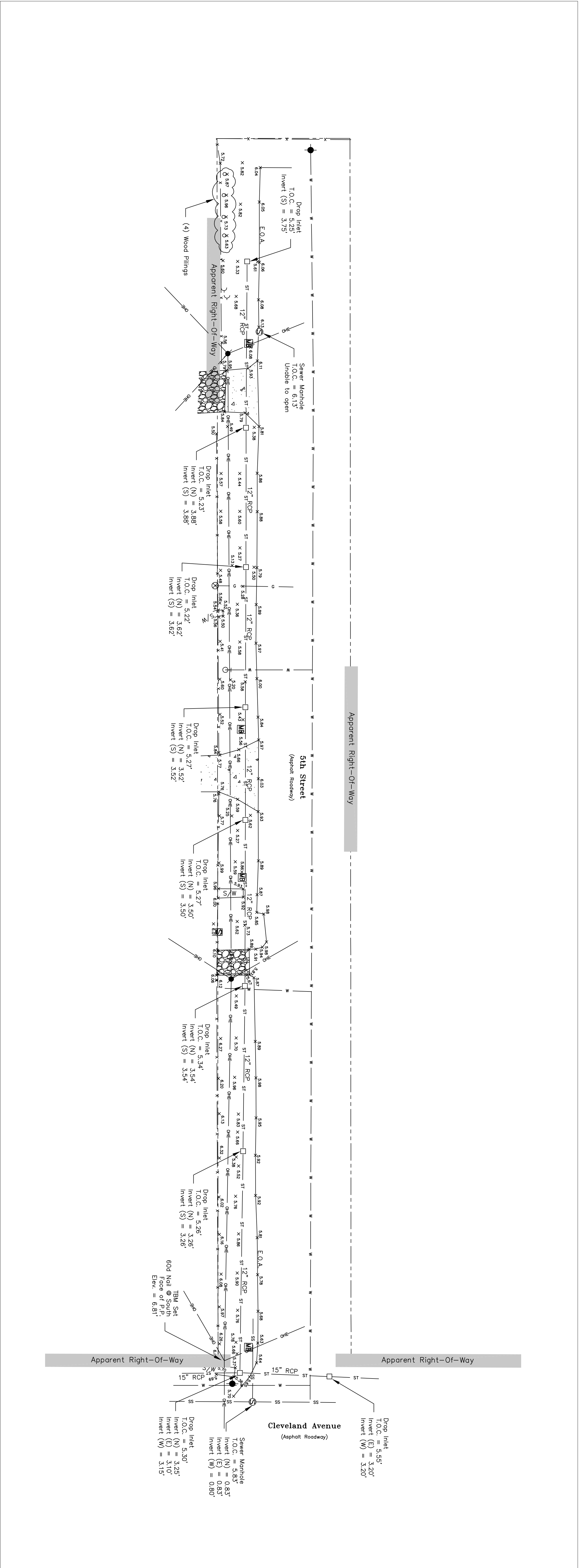

GENERAL NOTES

The servitudes and restrictions shown on this survey are limited to those set forth in the description furnished us and there are no other servitudes or restrictions shown hereon. The surveyor has made no title search or public record search in compiling the data for this survey.

I have consulted the Federal Insurance Maps and found this property is in a Special Flood Hazard Area.

PERMITS: AF  
BASE FLOOD ELEV. = 9'

COMMUNITY PANEL NO. 220204 0010 C  
MAP DATED/REVISED: APRIL 21, 1939

THE LOCATIONS OF UNDERGROUND AND OTHER NONVISIBLE UTILITIES SHOWN HEREON HAVE BEEN DETERMINED FROM DATA EITHER FURNISHED BY THE AGENCIES OR INCLUDING SPOT DATA AND/OR EXTRACTED FROM RECORDS MADE BY AGENCIES. THE SURFACE FEATURES OF LOCATIONS ARE SHOWN, THE ACTUAL NONVISIBLE LOCATIONS MAY VARY FROM THOSE SHOWN HEREON. EACH AGENCY IS RESPONSIBLE FOR THE ACCURACY OF THE INFORMATION PROVIDED BY IT. UNDERGROUND INSTALLATION PRIOR TO ANY RELIANCE UPON THE ACCURACY OF SUCH LOCATIONS SHOWN HEREON, INCLUDING PRIOR TO EXCAVATION AND DIGGING.

ALL ELEVATIONS SHOWN REFER TO NAD 83 DATUM, 2009 GEOID.

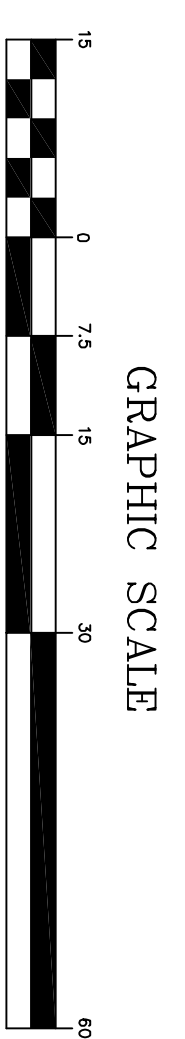

A TOPOGRAPHIC SURVEY OF WASHINGTON AVENUE FROM ELEANOR STREET TO THE END OF WASHINGTON AVENUE JUST PAST TUPELO STREET, LOCATED WITHIN LINCOLN PARK ADDITION TO THE TOWN OF SLIDELL, SECTION 15, T-9-S, R-14-E, ST. TAMMANY PARISH, LOUISIANA.

I certify that this plot represents an actual ground survey made by me or under my direction, and it does not conform to the requirements for the Minimum Standards for Property Boundary Surveys as found in Louisiana Administrative Code TITLE 48: LXI, Chapter 29 for a Class C survey.

CITY OF SLIDELL

**BAM**  
CORPORATION, L.L.C.  
Professional Land Surveyors  
534 WILLIAMS BOULEVARD  
E-mail: bmicorp@bmicorporation.com  
(504) 467-8600  
Fax No. (504) 467-0065  
CITY OF KENNER  
1515 PINE ST.  
JEFFERSON PARISH, LOUISIANA, 70062

REGISTERED PROFESSIONAL LAND SURVEYOR  
JOHN S. TEEGARDEN  
REGISTRATION NO. 46355

MARK	DESCRIPTION	DATE	BY	CHK'D
	REVISION RECORD			

SCALE	1" = 15'
DATE:	2012
DRAWN BY:	J.E.M.
CHECKED BY:	J.E.M.
PROJECT NO.	7731
DRAWING NO.	7731
SHEET	5
OF	6