

VICINITY MAP
NOT TO SCALE

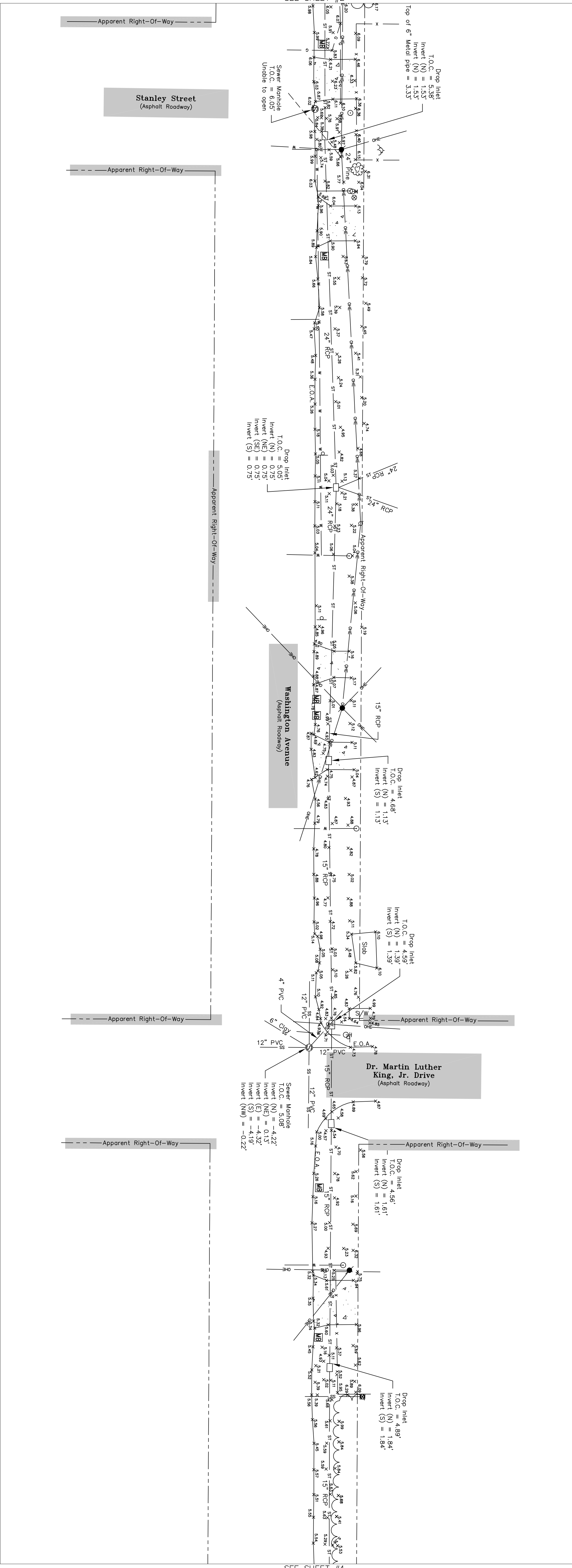

LEGEND

---	EXISTING RIGHT OF WAY
ST	EXISTING STREET
—D—	EXISTING DRAIN LINE
—D—	EXISTING DROP INLET DRAIN LINE
—G—	EXISTING GAS MANHOLE, GAS LINE
—S—	EXISTING SEWER MANHOLE, SEWER LINE
—T—	EXISTING TELEPHONE MANHOLE, TELE LINE
—TR—	EXISTING TRAFFIC MANHOLE, TRAFFIC LINE
—W—	EXISTING WATER MANHOLE, WATER LINE
—W—	EXISTING UTILITY POLE / OVERHEAD LINES
—W—	EXISTING ELECTRIC, TELEPHONE, CABLE TV
X	FENCE
S	SEWER CLEANOUT
W	WATER METER
U	UTILITY FEDESTAL
U	UTILITY VALVE
U	UTILITY VALVE VAULT
H	FIRE HYDRANT
★	LIGHT STANDARD
○	SIGN
○	TREE
○	RESIDENTIAL MAILBOX
○	PP DEADMAN
○	CONCRETE HATCH/DRIVEWAY
○	GRAVEL HATCH/DRIVEWAY
X 0.00	SPOT ELEVATION



GENERAL NOTES

The Servitudes and Restrictions shown on this survey are limited to those set forth in the description furnished us and there are no other servitudes or restrictions shown hereon. The surveyor has made no title search or public record search in compiling the data for this survey.

I have consulted the Federal Insurance Maps and found this property is in a Special Flood Hazard Area.

PRN 739E, AE
BASE FLOOD ELEV. = 9'

COMMUNITY PANEL NO. 220204 000 C
MAP DATED/REVISED: APRIL 21, 1999

THE LOCATIONS OF UNDERGROUND AND OTHER NONVISIBLE UTILITIES SHOWN HEREON HAVE BEEN DETERMINED FROM DATA EITHER FURNISHED BY THE AGENCIES CONCERNED, FROM RECORDS, OR BY EXCAVATION. THE SURFACE FEATURES OF LOCATIONS ARE SHOWN, THE ACTUAL NONVISIBLE LOCATIONS MAY VARY FROM THOSE SHOWN HEREON. EACH AGENCY HAS BEEN ADVISED OF THE LOCATION OF SUCH UTILITIES SHOWN HEREON, INCLUDING PRIOR TO EXCAVATION AND DIGGING.

ALL ELEVATIONS SHOWN REFER TO NA83 DATUM, 2009 GEOID.

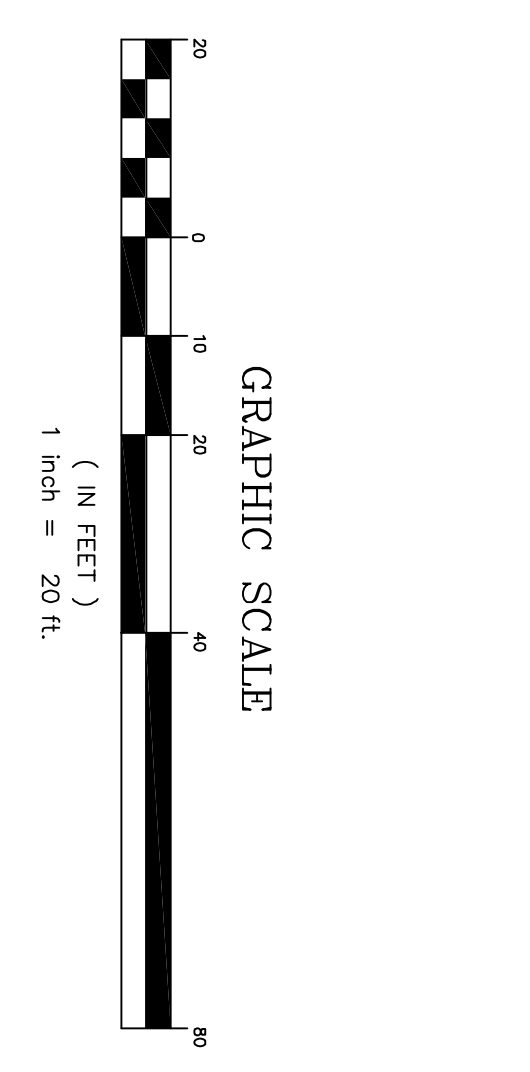

MARK	DESCRIPTION	DATE	BY	CHK'D
	REVISION RECORD			

A TOPOGRAPHIC SURVEY OF WASHINGTON AVENUE FROM ELEANOR STREET TO THE END OF WASHINGTON AVENUE JUST PAST TUPELO STREET, LOCATED WITHIN LINCOLN PARK ADDITION TO THE TOWN OF SLIDELL, SECTION 15, T-9-S, R-14-E, ST. TAMMANY PARISH, LOUISIANA.

I certify that this plot represents an actual ground survey made by me or under my direction, and it does not conform to the requirements for the Minimum Standards for Property Boundary Surveys as found in Louisiana Administrative Code TITLE 46: LXI, Chapter 29 for a Class C survey.

CITY OF SLIDELL

BAM
CORPORATION, L.L.C.
Professional Land Surveyors

534 WILLIAMS BOULEVARD
E-mail: bincorp@bincorporation.com
(504) 468-8500
Fax No. (504) 467-0065
CITY OF KENNER
115 LISI
JEFFERSON PARISH, LOUISIANA, 70062

REGISTERED PROFESSIONAL LAND SURVEYOR
JOHN S. TEEGARDEN
REGISTRATION NO. 46355