

VICINITY MAP  
NOT TO SCALE

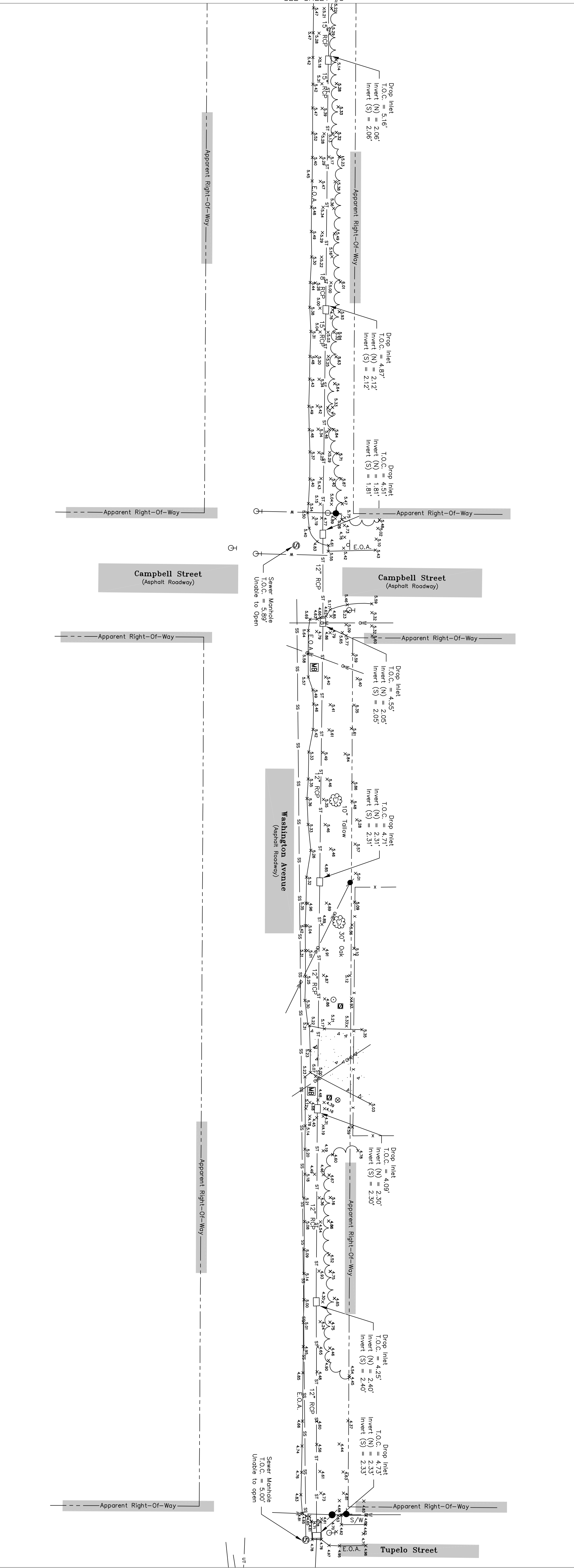

LEGEND	
	EXISTING RIGHT OF WAY
	CULVERT
	DROP INLET DRAIN LINE
	DROP INLET DRAIN LINE
	GAS MANHOLE, GAS LINE
	SEWER MANHOLE, SEWER LINE
	TELEPHONE MANHOLE, TELE LINE
	TRAFFIC MANHOLE, TRAFFIC LINE
	WATER MANHOLE, WATER LINE
	UTILITY POLE / OVERHEAD LINES ELECTRIC, TELEPHONE, CABLE TV
	FENCE
	SEWER CLEANOUT
	WATER METER
	UTILITY PEDESTAL
	UTILITY VALVE
	UTILITY VALVE VAULT
	FIRE HYDRANT
	LIGHT STANDARD
	SIGN
	TREE
	RESIDENTIAL MAILBOX
	PP DEAMAN
	CONCRETE HATCH/DRIVEWAY
	GRAVEL HATCH/DRIVEWAY
	SPOT ELEVATION



**GENERAL NOTES**

The Servitudes and Restrictions shown on this survey are limited to those set forth in the description furnished us and there are no other servitudes or restrictions shown hereon. The surveyor has made no title search or public record search in compiling the data for this survey.

I have consulted the Federal Insurance Maps and found this property is in a Special Flood Hazard Area.

PRN 739E, AE  
BASE FLOOD ELEV. = 9'

COMMUNITY PANEL NO. 220204 000 C  
MAP DATED/REVISED: APRIL 21, 1999

THE LOCATIONS OF UNDERGROUND AND OTHER NONVISIBLE UTILITIES SHOWN HEREON HAVE BEEN DETERMINED FROM DATA EITHER FURNISHED BY THE AGENCIES CONCERNING SUCH DATA AND/OR EXTRACTED FROM RECORDS MADE BY SUCH AGENCIES. THE SURFACE FEATURES OF LOCATIONS ARE SHOWN, THE ACTUAL NONVISIBLE LOCATIONS MAY VARY FROM THOSE SHOWN HEREON. EACH AGENCY UNDERTAKING INSTALLATION PRIOR TO ANY RELIANCE UPON THE ACCURACY OF SUCH LOCATIONS SHOWN HEREON, INCLUDING PRIOR TO EXCAVATION AND DIGGING.

ALL ELEVATIONS SHOWN REFER TO NAD 88 DATUM, 2009 GEOID.



MARK	DESCRIPTION	DATE	BY	CHK'D

SCALE: 1" = 20'

DATE: 2012

DRAWN BY: J.E.M.

CHECKED BY: J.E.M.

PROJECT NO. 7731 DRAWING NO. 7731

SHEET 4 OF 6

A TOPOGRAPHIC SURVEY OF WASHINGTON AVENUE FROM ELEANOR STREET TO THE END OF WASHINGTON AVENUE JUST PAST TUPELO STREET, LOCATED WITHIN LINCOLN PARK ADDITION TO THE TOWN OF SLIDELL, SECTION 15, T-9-S, R-14-E, ST. TAMMANY PARISH, LOUISIANA.

I certify that this plot represents an actual ground survey made by me or under my direction, and it does not conform to the requirements for the Minimum Standards for Property Boundary Surveys as found in Louisiana Administrative Code TITLE 46: LXI, Chapter 29 for a Class C survey.

CITY OF SLIDELL

**BAM**  
CORPORATION, L.L.C.  
Professional Land Surveyors

534 WILLIAMS BOULEVARD  
E-mail: bincorp@bamicorporation.com  
(504) 468-8800  
Fax No. (504) 467-0065  
CITY OF KENNER  
1515 PINE ST.  
JEFFERSON PARISH, LOUISIANA, 70062

REGISTERED PROFESSIONAL LAND SURVEYOR  
JOHN S. TEEGARDEN  
REGISTRATION NO. 46355