

EXISTING 200 AMP SERVICE
AND METER TO REMAIN

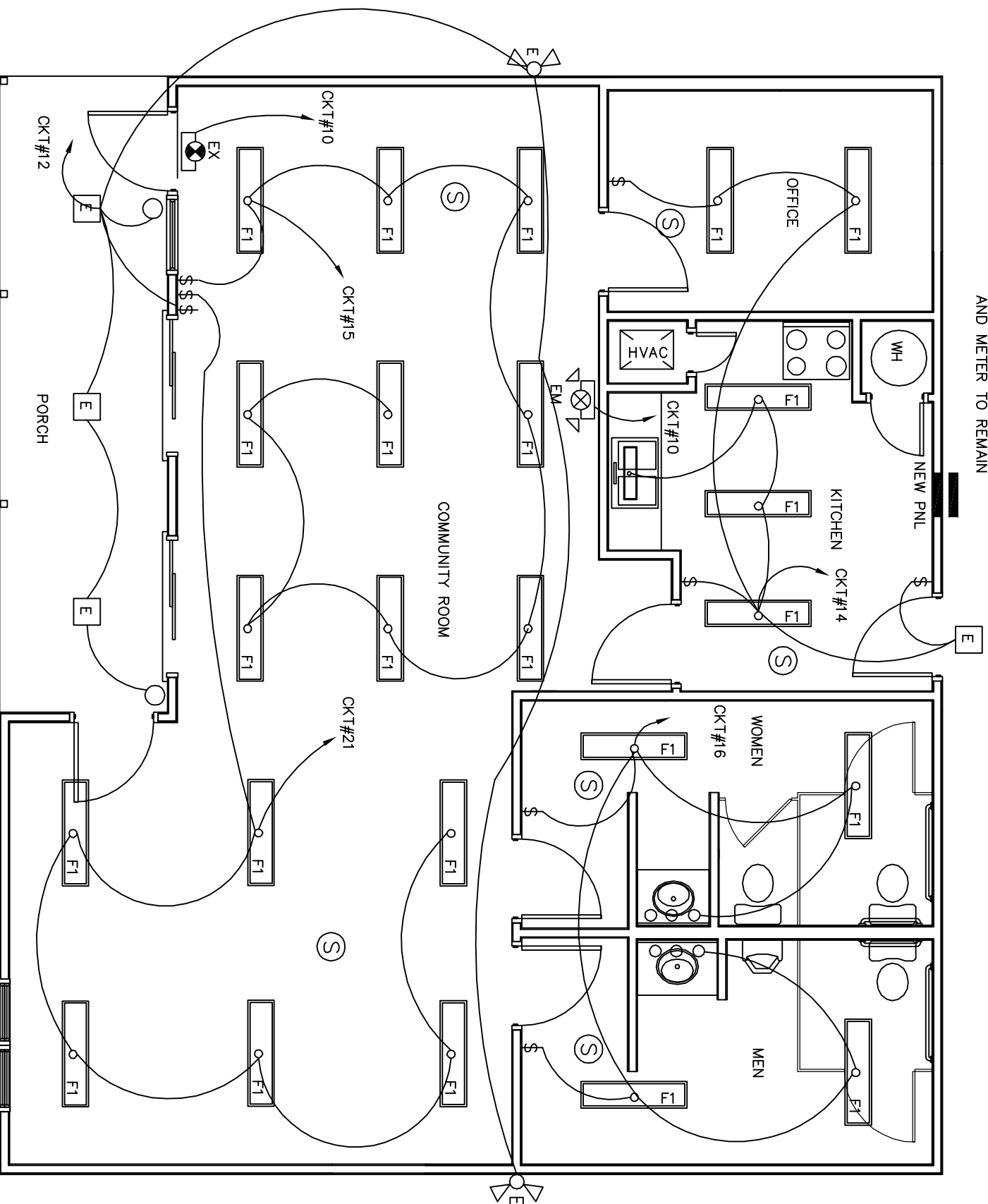

LIGHTING PLAN
SCALE - 1/4" = 1"

PANEL: LP-1
LOCATION: KITCHEN
FEEDER SOURCE: CLECO

VOLTAGE: 120/240V, 200A 1 ϕ , 3W, MLO
FLUSH MOUNTED W/EQUIPMENT GND BAR

CKT. NO.	THHN SIZE	LOAD DESCRIPTION	BREAKER AMP	POLE	LOAD (VA)	A#		B#		LOAD (VA)	BREAKER AMP	POLE	LOAD DESCRIPTION	THHN SIZE	CKT. NO.	
						1	2	1	2							
1	#8	AHU #1 10 KW	60	2	5000					4800	2	40	A/C COMPRESSOR #1	#8	2	
3	#12	COMMUNITY ROOM RECEPTACLES	20	1	5000					4800	20	4		#12	4	
5	#12	COMMUNITY ROOM RECEPTACLES	20	1	1120					1120	1	20	COMMUNITY ROOM RECEPTACLES	#12	6	
7	#12	OFFICE ROOM RECEPTACLES	20	1	960					320	1	20	KITCHEN ROOM RECEPTACLES	#12	8	
9	#8	STOVE	50	2	6000					400	1	20	EXIT LIGHT & EMERGENCY LIGHT	#12	10	
11	#12	REFRIGERATOR RECEPTACLE	20	1	6000					1400	1	20	EXTERIOR LIGHTS FRONT PORCH	#12	12	
13	#12	COMMUNITY ROOM LIGHTS	20	1	1800					1400	1	20	KITCHEN/OFFICE LIGHTS	#12	14	
15	#12	COMMUNITY ROOM LIGHTS	20	1	1800					1200	1	20	MEN/WOMEN LIGHTS	#12	16	
17	#8	WATER HEATER 30 GALLON	30	2	3600					1000	1	20	MICROWAVE/VENT	#12	18	
19	#12	COMMUNITY ROOM LIGHTS	20	1	3600					-	1	20	SPARE	#12	20	
21	BLANK	COMMUNITY ROOM LIGHTS	20	1	1200					-	-	-	BLANK	-	22	
23	BLANK	COMMUNITY ROOM LIGHTS	-	-	-					-	-	-	BLANK	-	24	
TOTAL CONNECTED LOAD (VA) =											A# =		B# =		GROUND BUS GROUND WIRE (G)	

SOLID NEUTRAL NEUTRAL WIRE (N)
 GROUND BUS GROUND WIRE (G)