

CREW: TSgt RABOEAU
Sgt LADENBARK
SSgt BEKE

NOTES

RANGE CORNERS WERE ORIGINALLY SET IN DATUM NAD27, MS EAST 2301.

CORPSCON VERSION 6 WAS USED TO CONVERT NAD 27 TO NAD83

ROUTE CONTROL PLAT FROM NORTH GATE ROAD WIDENING WAS USED TO TRIANGULATE HORIZONTAL + VERTICAL CALIBRATION TO BRIDGE RANGE CORNERS TO NAD83.

ALL BERM ELEVATIONS ARE TO BE 14' HIGHER THAN FIRING LINE ELEVATIONS.

RETENTION POND LOCATIONS ARE APPROXIMATE AND USED CALCULATIONS BASED UPON MS STATE REQUIREMENTS.

22-141 50 SHEETS
22-142 100 SHEETS
22-144 200 SHEETS



RANGE COORDINATES

#	NORTHING	EASTING
1	315149.4700	729434.0170
2	315183.2610	729610.9190
3	312230.5680	730174.0460
4	312202.7760	729997.2450
5	312998.1640	729587.8800
6	313012.9550	729782.3220
7	312714.3120	729805.1460
8	312649.4510	729610.7050
9	312960.0910	729087.3270
10	312994.6140	729531.8520
11	312495.4900	729558.8590
12	312660.9780	729110.1710
13	312798.1680	728942.6680
14	312806.5700	729046.8990
15	312657.1070	729059.4110
16	312644.6570	728954.7500
17	312764.0870	728680.7270
18	312819.7380	728879.3970
19	312644.4060	728908.0100
20	312602.6450	728716.2910
21	312713.9150	728529.8920
22	312732.3060	728632.1170
23	312591.0640	728665.5190
24	312567.6840	728563.2340
25	313615.7440	72956.7920
26	313681.0560	728280.2390
27	312210.6890	728577.0140
28	312145.3710	728253.5320
29	312522.3640	728752.7310
30	312522.7520	728602.7320
31	312372.3630	728902.7340
32	312372.3620	728752.7320
33	312583.5670	729601.2670
34	312583.5700	729751.2660
35	312433.5640	729751.2710
36	312433.5670	729602.2690
37	311972.8170	728902.3850
38	311972.8190	729042.3810
39	311852.8120	729042.3830
40	311852.8160	728902.3810

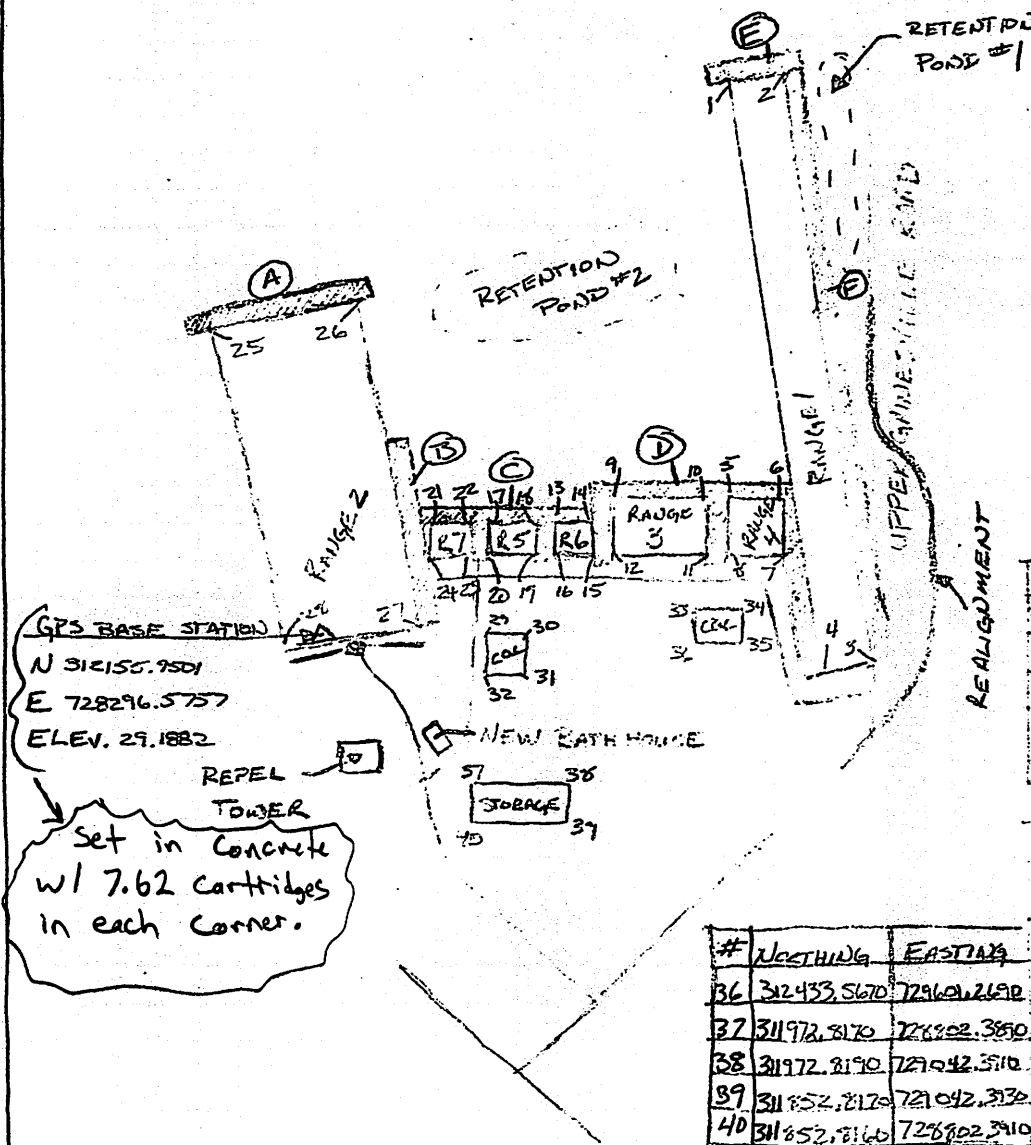

ALL COORDINATES ARE IN NAD83 MS STATE PLANE EAST 2301

Dave's COPY

Hand Held GPS Coordinates For Ranges

accuracy ~ 12-15 ft.

<u>Description</u>	<u>Lat</u> , <u>Long</u>
NE corner of 1,000 yd range (orange tip 4x4)	30° 21.850' N, 89° 38.443'
NW corner of 1,000 yd range (orange tip 4x4)	30° 21.846' N, 89° 38.479'
NW corner of Range 6 (orange tip stake)	30° 21.458' N, 89° 38.567'
NE corner of Range 6 (orange tip stake)	30° 21.456' N, 89° 38.548'
NW corner of Range 3 (orange tip stake)	30° 21.477' N, 89° 38.542'
NE corner of Range 3 (orange tip stake)	30° 21.491' N, 89° 38.405'
NW corner of Range 4 (orange tip stake)	30° 21.490' N, 89° 38.438'
NE corner of Range 4 (orange tip stake)	30° 21.493' N, 89° 38.453'

South corners of ranges are marked w/ orange tipped 4x4s.
Except SE corner of 1,000 yd range in road marked with
a nail + red survey tape at 30° 21.366' N, 89° 38.333'