

Centrifugal Roof Exhaust Fans Models G and GB

Direct and Belt Drive



 **GREENHECK**
Building Value in Air.

July
2007

Models G & GB Spun Aluminum - Centrifugal Roof Exhaust Fans



Greenheck's Model G and GB centrifugal roof exhaust fans provide the industry's best performance and durability for general clean air applications.



- Broadest performance in the industry, up to 2.75 in. wg (683 Pa) and 44,700 cfm (75,946 m³/hr).
- Most advanced motor cooling of any fan in its class.
- Performance as cataloged is assured. All fan sizes are tested in our AMCA Accredited Laboratory, and all models are licensed to bear the AMCA sound and air performance seals.
- UL Listed for electrical.*
- Greenheck subjects these products to extensive life testing, assuring you that the fans will provide years of reliable performance.

Outstanding Customer Service

Your local Greenheck representative has a wealth of industry and product knowledge to answer your questions. Our representatives receive the latest product information and can have orders processed directly to our factory. With our direct order processing system, we can ship orders as fast as the next day. With Greenheck's experienced staff, we can answer questions and provide solutions.



*UL is optional and must be specified. G and GB models are listed for electrical (UL/cUL 705) File no. E40001



Greenheck Fan Corporation certifies that the Models G and GB fans shown herein are licensed to bear the AMCA Seal. The ratings shown are based on tests and procedures performed in accordance with AMCA Publication 211 and Publication 311 and comply with the requirements of the AMCA Certified Ratings Program. The certified ratings for Models G and GB are shown on pages 7 to 43.

Leading Edge Technical Support



When product and IOM (Installation, Operation and Maintenance Manual) information is needed, our products are supported by the industry's best product literature, electronic media, and Computer Aided Product Selection (CAPS) program. You'll also find this information on our website at www.greenheck.com

Our national and international representative organization provide personal service and expertise. To locate your nearest Greenheck representative, call 715-359-6171 or visit our website at www.greenheck.com

World Class Manufacturing

Greenheck's skilled production workers use cost-effective machines and unique dies designed and built by our own engineers to add innovative features and greater strength to our centrifugal exhaust fans. Our advanced manufacturing processes and quality control procedures always ensure the highest product quality. And just to be sure you get the peace-of-mind you expect when you specify Greenheck, our assembly inspectors test run and monitor every fan before it leaves the factory. Results of these tests are kept in permanent records for future reference.



Model Comparison

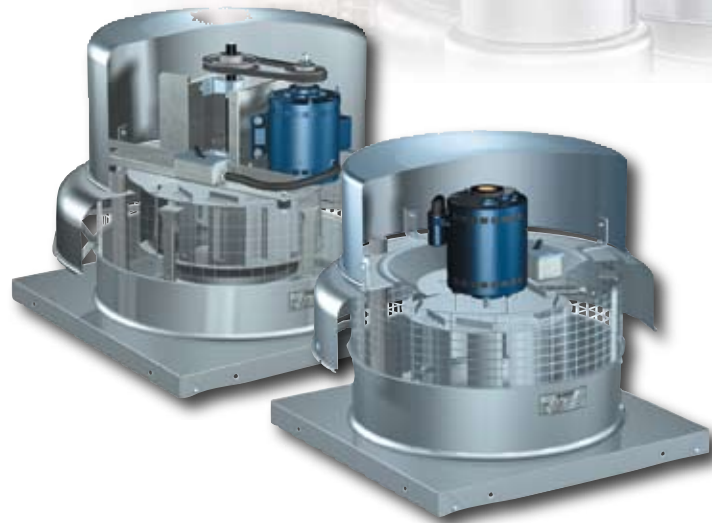
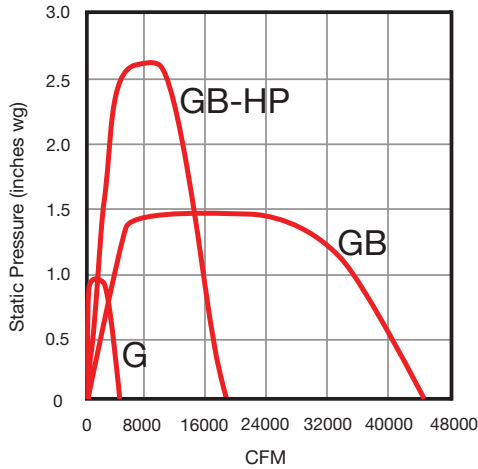

G - Direct Drive

Typically used for short and/or low resistance ductwork.

Maximum operating temperature is 130°F (54°C).

GB - Belt Drive

Typically used for average length and/or average resistance ductwork.

High volume / Average pressure

Maximum operating temperature is 180°F (82°C).

GB-HP - Belt Drive

Typically used for long and/or high resistance ductwork.

Low volume / High pressure

Maximum operating temperature is 180°F (82°C).

Quick Delivery and Quick Build Programs



More than 45 G and GB configurations are stocked in our strategically located Greenheck warehouses. Greenheck's Quick Delivery (QD) Program includes stock products that can be shipped in as little as 4 hours.

Our Quick Build (QB) Program ensures rapid response time with your needs dictating manufacturing time. Products can be manufactured in one, three, five or ten days, then shipped to your job site.

Model Number Code

The Model number system is designed to completely identify the fan. The correct code letters must be specified to designate belt or direct drive. The remainder of the model number is determined by the size and performance.

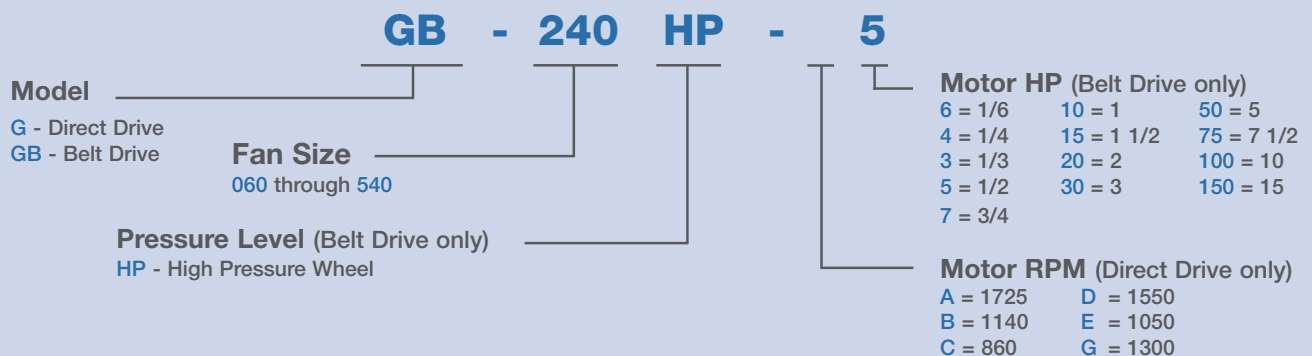

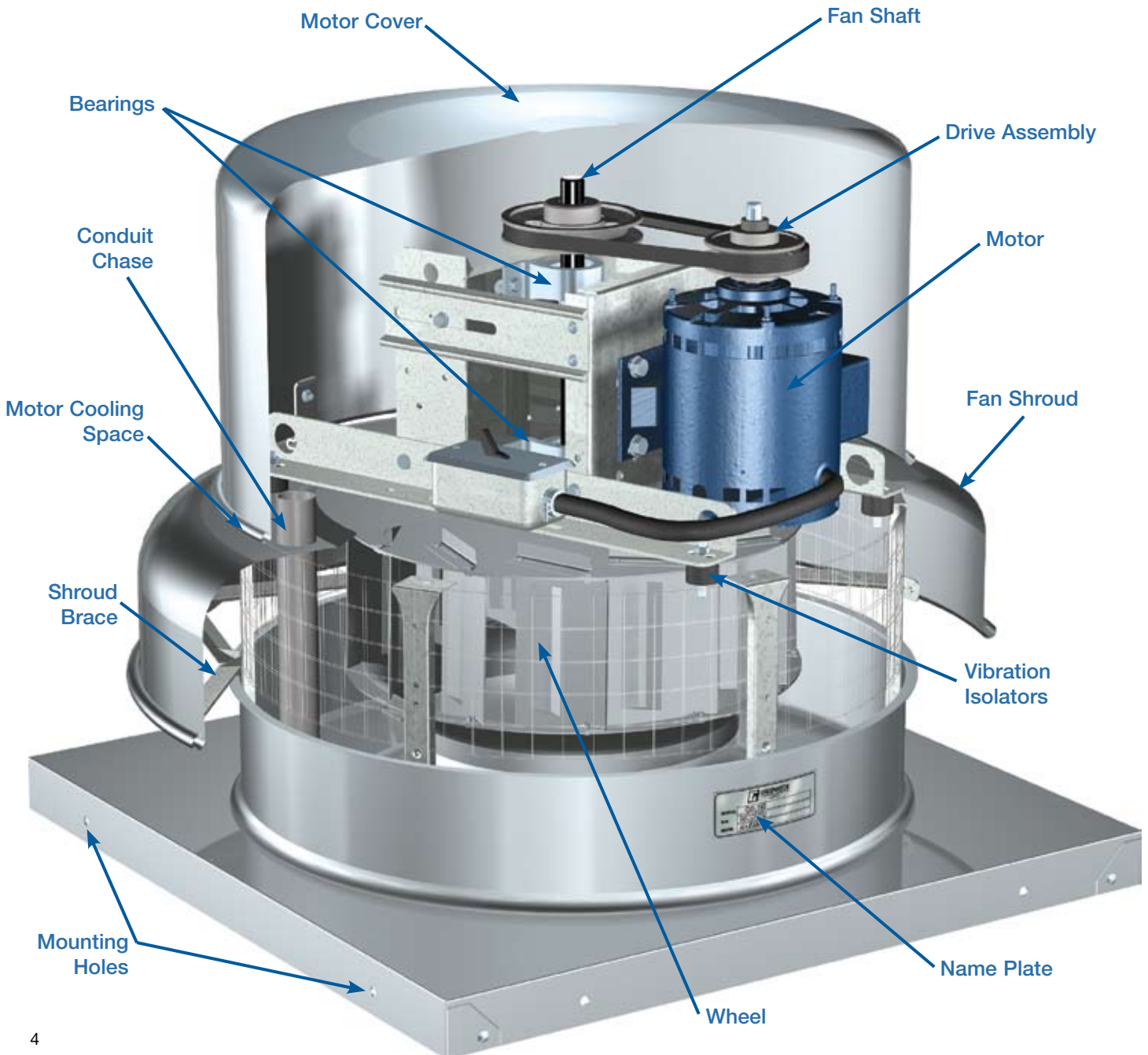
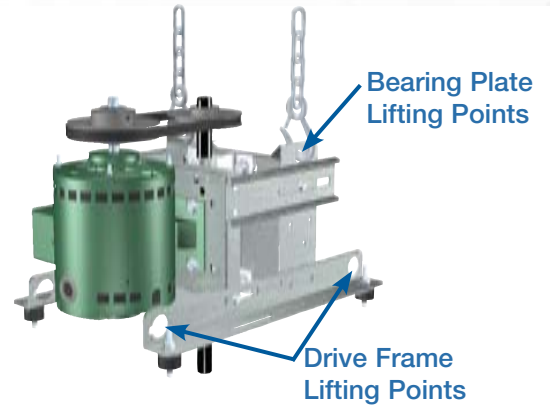
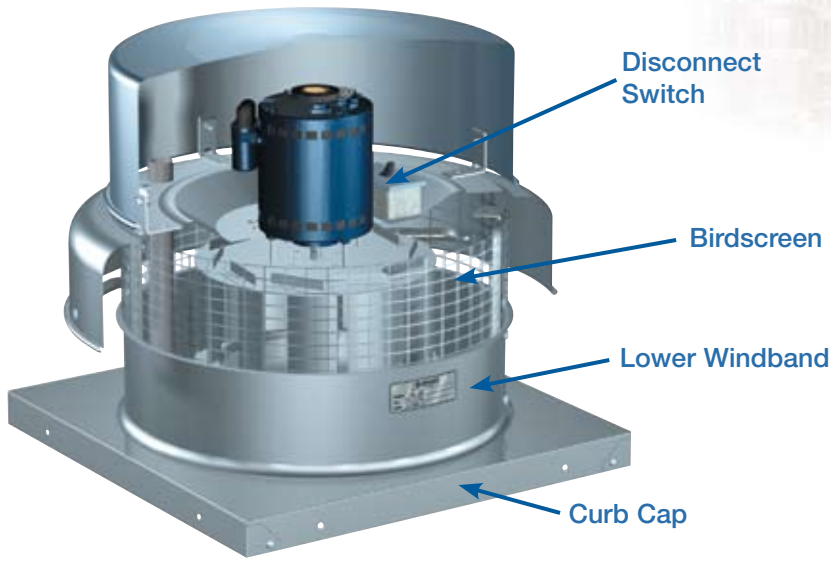

Standard Construction Features



Wheel - An aluminum, backward-inclined, non-overloading centrifugal wheel is utilized to generate high efficiency and minimal sound. Wheel cones are carefully matched to the venturi for maximum efficiency. Each wheel is robotically welded and statically and dynamically balanced for long life and quiet operation.

Disconnect Switch - NEMA-1 switch is factory mounted and wiring is provided from the motor as standard (other switches are available). All wiring and electrical components comply with the National Electric Codes (NEC) and are either UL listed or recognized.

Internal Conduit Chase - A large diameter conduit for installing electrical wiring through the curb cap into the motor compartment.

Fan Shaft - Is precisely sized, ground, and polished so the first critical speed is at least 25% over the maximum operating speed. Where the shaft makes contact with bearings, close tolerances result in longer bearing life.

Bearings - 100% factory tested and designed specifically for air handling applications with a minimum (L10) life in excess of 100,000 hours (L50 life of 500,000 hours).

Motor Cover - Constructed of aluminum, machine punched, and attached with stainless steel hardware for easy removal and access to motor compartment and drive assembly.

Drive Assembly - Belts, pulleys, and keys are oversized 150% of driven horsepower. Machined cast pulleys are adjustable for final system balancing. Belts are static free and oil resistant.

Motor Cooling - Cooling fins located on top of fan wheel draw outside air through a large space between the fan shroud and the motor cover directly into the motor compartment. Positive motor cooling with fresh air results in maximum motor life.

Vibration Isolation - Vibration isolators support the drive assembly and wheel for long life and quiet operation.

Fan Shroud - One piece, constructed of heavy gauge aluminum with a rolled bead for extra strength directs exhaust air downward.

Name Plate - Permanent stamped aluminum plate for exact model and serial identification.

Mounting Holes - Curb cap has prepunched mounting holes to ensure correct attachment to the roof.

Galvanized Birdscreen - Galvanized rigid wire protects the fan's discharge from birds or small objects.

Curb Cap - Curb cap (with integral deep spun venturi) is constructed of aluminum in one piece for a weather tight fit.

Lower Windband - Heavy gauge aluminum with formed edges for added strength and provide weather resistance.

Motor - Carefully matched to the fan load and is mounted out of airstream.

Lifting Points - Select models have various lifting points located on the drive frame or bearing plates.

Options and Accessories

Hinge Kit - Mounted to the curb cap, allows entire fan to tilt away from curb for access to wheel and ductwork. Includes restraint cables.

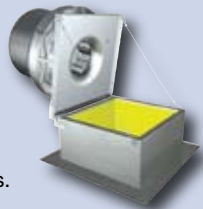

Roof Curbs - Prefabricated roof curbs reduce installation time and costs by ensuring compatibility between the fan, the curb, and roof opening. All curbs are insulated with fiberglass. A wide variety of roof curbs are available, including: flanged, pitched, and sound-absorbing.

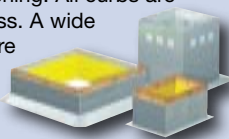

Curb Extension - Extensions raise the fan discharge above the roof line and provide an accessible mounting location for dampers. Insect screen bases, constructed with a removable fine mesh, are recommended for applications where insect entry must be prevented.

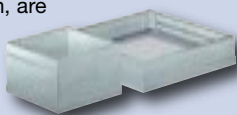

Coatings - Wide variety of coatings and colors are available. Greenheck coatings and resistance charts can be found in the coatings bulletin.



Disconnect Switches - A wide selection of NEMA rated switches are available for positive electrical shutoff and safety, including: dust-tight, rainproof, and corrosion-resistant. Switches may be internally or externally mounted.



Dampers - Designed to prevent outside air from entering back into the building when fan is off. Includes: gravity and motorized dampers. Damper sizes are shown on each performance data page.



Birdscreen - Galvanized mesh is standard, optional aluminum or stainless steel rigid wire are also available.

Speed Controllers - Available for use with shaded pole and permanent split capacitor (PSC) open motors on Model G fans. They provide an economical means of system balancing with direct drive fans.



Tie Down Points - Four brackets located on the shroud for securing the fan in heavy wind applications. Cables and anchors by others.



Curb Seal - Rubber seal between fan and curb to assure proper sealing when attached to a curb.

G and GB models are listed for electrical (UL/cUL 705) File no. E40001



Installation

Models G and GB exhaust fans are designed to meet the needs of general clean air applications. Tests were conducted to assure safe, rugged and reliable fans.

Due to the varying airstreams encountered in commercial ventilation, system designers must be aware of national, state, and local codes and guidelines governing these installations. Local code authorities should be consulted before proceeding with any ventilation project.

When roofing materials extend to the top of the curb, roof curbs should be 1½ inches (¾ inches on a side) less than the unit curb cap to allow for roofing and flashing.

For recommended duct size, damper size, and roof opening dimensions, refer to the performance data pages.

Installation must include a means for inspecting, cleaning and servicing the exhaust fan.

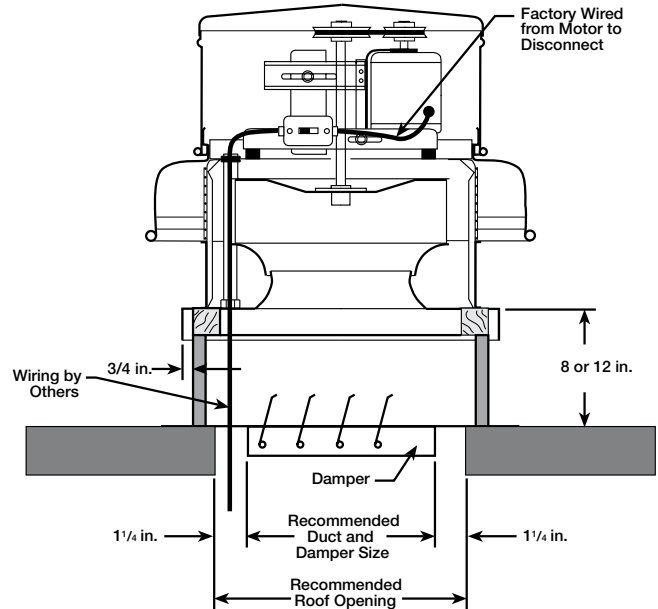

Fan Inlet Connections

In order to assure proper fan performance, caution must be exercised in fan placement and connection to the ventilation system. Obstructions, transitions, poorly designed elbows, improperly selected dampers, etc., can cause reduced performance, excessive noise, and increased mechanical stress. For performance to be as published, the system must provide uniform and stable airflow into the fan.

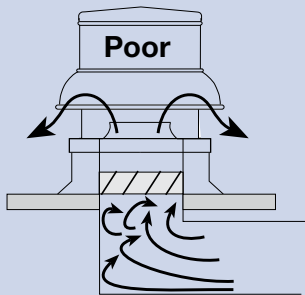

Dampers must open fully. Use motorized dampers in low airflow applications to reduce losses.

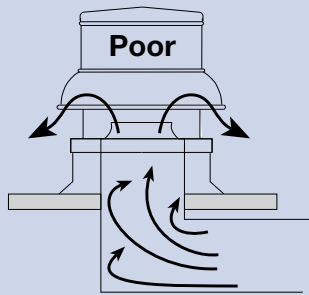

Avoid sharp turns or entrance conditions which cause uneven flow. Use turning vanes in elbows to reduce adverse effects.

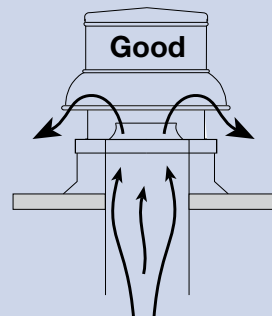

Provide uniform airflow at fan inlet to assure optimum performance.

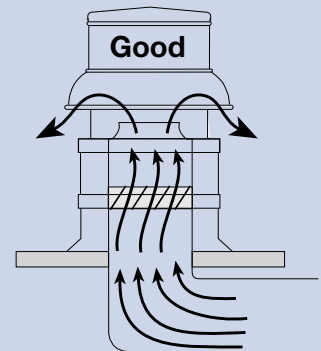

Provide uniform airflow at fan inlet and through the damper to assure optimum performance.

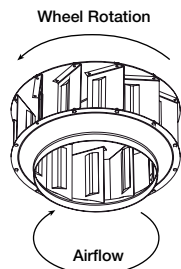

Wheel Rotation

Direction of rotation is very critical. Rotation in the wrong direction will result in excessive horsepower, possible motor burnout, and increased noise levels. Check rotation by energizing the unit only momentarily. The rotation should be the same as the rotation decals affixed to the unit and is clockwise when viewed from the top of the unit.

G-060 and 065 - Direct Drive

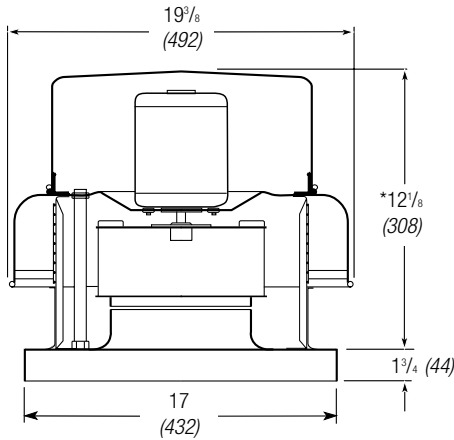

Damper Size = 8 x 8 (203 x 203)
 Roof Opening = 10 1/2 x 10 1/2 (267 x 267)
 ^Approximate Unit Weight = 18 lb. (8 kg)

All dimensions in inches (millimeters).
 *May be greater depending on motor.
 ^Weight shown is largest cataloged Open Drip Proof motor.

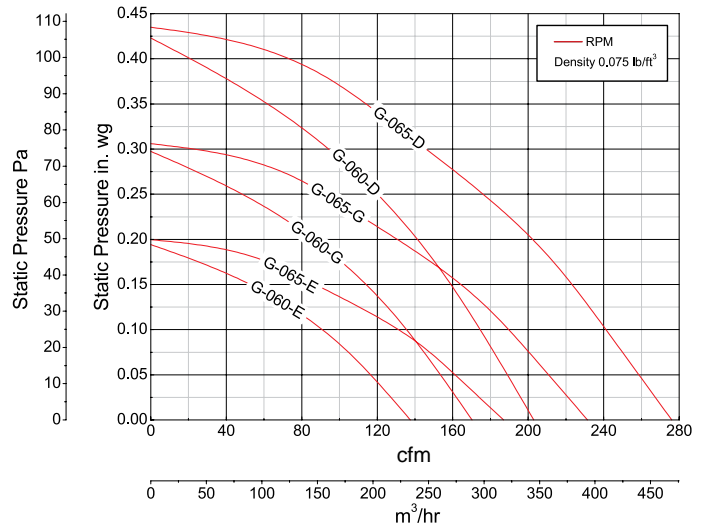

Model Number	HP (Size)	Fan RPM	Static Pressure in Inches wg											
			0	0.05	0.1	0.125	0.15	0.2	0.25	0.3	0.375	0.4		
G-060-E	1/200	1050	CFM	138	116	90	73	53						
			BHP	0.00	0.00	0.01	0.01	0.01						
			Sones	1.7	1.7	1.7	1.7	1.7						
G-060-G	1/100	1300	CFM	170	153	135	125	113	85					
			BHP	0.01	0.01	0.01	0.01	0.01	0.01					
			Sones	2.9	2.8	2.8	2.7	2.7	2.6					
G-060-D	1/60	1550	CFM	203	188	173	166	158	140	120	92			
			BHP	0.01	0.01	0.01	0.01	0.02	0.02	0.02	0.02	0.2		
			Sones	4.2	3.9	3.8	3.8	3.8	3.7	3.7	3.6			
G-065-E	1/100	1050	CFM	187	161	130	110	87						
			BHP	0.01	0.01	0.01	0.01	0.01						
			Sones	2.2	2.1	1.9	1.8	1.7						
G-065-G	1/60	1300	CFM	231	211	189	178	163	130	92				
			BHP	0.01	0.01	0.01	0.01	0.01	0.01	0.01				
			Sones	3.2	3.1	3.0	2.9	2.9	2.8	2.7				
G-065-D	1/30	1550	CFM	276	259	241	232	223	201	176	145	96		
			BHP	0.02	0.02	0.02	0.02	0.02	0.02	0.02	0.02	0.02	0.02	
			Sones	4.9	4.6	4.5	4.5	4.4	4.3	4.3	4.1	4.0		

Performance certified is for installation type A: Free inlet, Free outlet. Performance ratings include the effects of a birdscreen in the airstream. The sound ratings shown are loudness values in fan sones at 5 ft. (1.5 m) in a hemispherical free field calculated per AMCA Standard 301. Values shown are for installation type A: Free inlet fan sone levels.

G-070 and 075 - Direct Drive

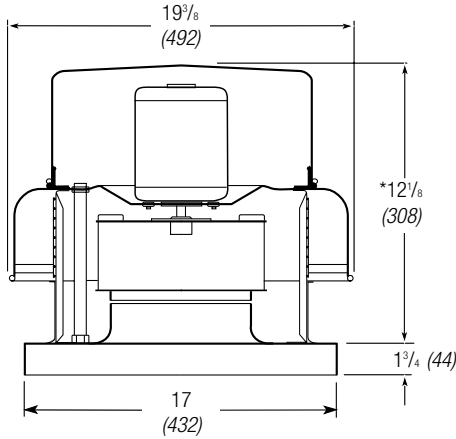

Damper Size = 8 x 8 (203 x 203)
 Roof Opening = 10 1/2 x 10 1/2 (267 x 267)
 ^Approximate Unit Weight = 18 lb. (8 kg)

All dimensions in inches (millimeters).
 *May be greater depending on motor.
 ^Weight shown is largest cataloged Open Drip Proof motor.

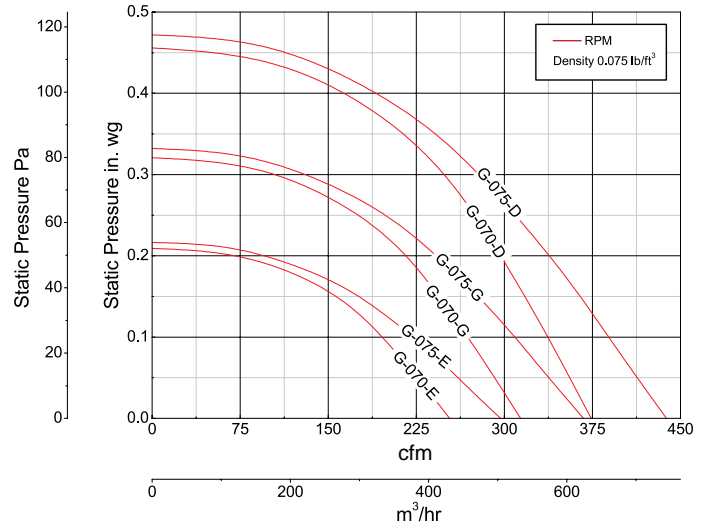

Model Number	HP (Size)	Fan RPM	Static Pressure in Inches wg											
			0	0.05	0.1	0.125	0.15	0.2	0.25	0.3	0.375	0.4		
G-070-E	1/100	1050	CFM	253	226	195	179	152						
			BHP	0.01	0.01	0.01	0.01	0.01						
			Sones	2.7	2.1	1.7	1.5	1.2						
G-070-G	1/60	1300	CFM	314	292	269	257	244	214	171				
			BHP	0.01	0.1	0.02	0.02	0.02	0.02	0.02				
			Sones	4.1	3.7	3.4	3.3	3.2	2.9	2.6				
G-070-D	1/30	1550	CFM	374	356	337	327	317	297	274	244	190		
			BHP	0.02	0.02	0.02	0.03	0.03	0.03	0.03	0.03	0.03		
			Sones	5.6	5.4	5.2	5.2	5.1	4.9	4.7	4.5	4.1		
G-075-E	1/80	1050	CFM	297	260	222	200	176						
			BHP	0.01	0.01	0.01	0.01	0.01						
			Sones	3.6	3.1	2.9	2.8	2.6						
G-075-G	1/50	1300	CFM	367	338	309	293	277	241	195				
			BHP	0.02	0.02	0.02	0.02	0.02	0.02	0.02				
			Sones	4.1	3.9	3.7	3.7	3.7	3.6	3.5				
G-075-D	1/25	1550	CFM	438	413	389	377	364	337	309	277	214		
			BHP	0.03	0.03	0.3	0.04	0.04	0.04	0.04	0.04	0.03		
			Sones	6.1	5.8	5.6	5.4	5.3	5.1	4.9	4.9	4.8		

Performance certified is for installation type A: Free inlet, Free outlet. Performance ratings include the effects of a birdscreen in the airstream. The sound ratings shown are loudness values in fan sones at 5 ft. (1.5 m) in a hemispherical free field calculated per AMCA Standard 301. Values shown are for installation type A: Free inlet fan sone levels.

G-080 and 085 - Direct Drive

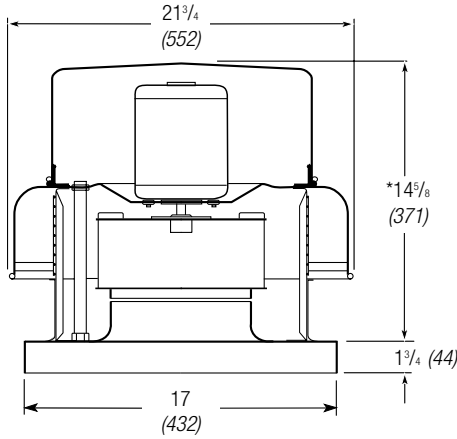

Damper Size = 10 x 10 (254 x 254)
 Roof Opening = 12 1/2 x 12 1/2 (318 x 318)
 ^Approximate Unit Weight = 26 lb. (12 kg)

All dimensions in inches (millimeters).
 *May be greater depending on motor.
 ^Weight shown is largest cataloged Open Drip Proof motor.

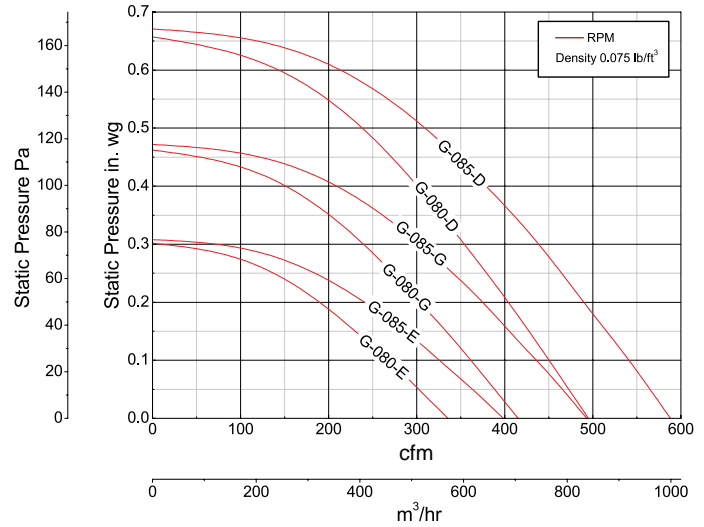

Model Number	HP (Size)	Fan RPM	Static Pressure in Inches wg											
			0	0.1	0.125	0.15	0.2	0.25	0.3	0.375	0.5	0.625		
G-080-E	1/40	1050	CFM	335	268	249	230	189	134					
			BHP	0.01	0.02	0.02	0.02	0.02	0.02					
			Sones	3.8	3.7	3.6	3.7	3.9	4.2					
G-080-G	1/30	1300	CFM	415	361	348	333	303	272	239	174			
			BHP	0.02	0.03	0.03	0.03	0.03	0.03	0.03	0.03			
			Sones	5.4	5.4	5.4	5.4	5.4	5.5	5.6	5.9			
G-080-D	1/20	1550	CFM	495	450	439	427	404	379	354	314	237		
			BHP	0.04	0.04	0.04	0.05	0.05	0.05	0.05	0.06	0.6		
			Sones	7.3	7.3	7.3	7.3	7.3	7.2	7.3	7.3	7.6		
G-085-E	1/40	1050	CFM	398	326	307	286	240	179					
			BHP	0.01	0.02	0.02	0.02	0.02	0.02					
			Sones	4.0	3.9	3.9	3.9	4.1	4.3					
G-085-G	1/30	1300	CFM	493	436	420	405	375	340	302	233			
			BHP	0.02	0.03	0.03	0.03	0.03	0.04	0.04	0.04			
			Sones	5.5	5.3	5.3	5.3	5.3	5.3	5.4	5.5			
G-085-D	1/20	1550	CFM	588	541	528	515	490	464	439	394	308	168	
			BHP	0.04	0.04	0.05	0.05	0.05	0.05	0.06	0.06	0.06	0.06	
			Sones	7.6	7.4	7.4	7.4	7.4	7.4	7.4	7.4	7.4	7.6	8.1

Performance certified is for installation type A: Free inlet, Free outlet. Performance ratings include the effects of a birdscreen in the airstream. The sound ratings shown are loudness values in fan sones at 5 ft. (1.5 m) in a hemispherical free field calculated per AMCA Standard 301. Values shown are for installation type A: Free inlet fan sone levels.

G-090 and 095 - Direct Drive

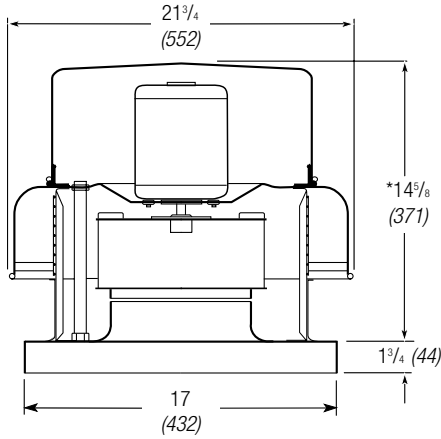

Damper Size = 10 x 10 (254 x 254)
 Roof Opening = 12 1/2 x 12 1/2 (318 x 318)
 ^Approximate Unit Weight = 26 lb. (12 kg)

All dimensions in inches (millimeters).
 *May be greater depending on motor.
 ^Weight shown is largest cataloged Open Drip Proof motor.

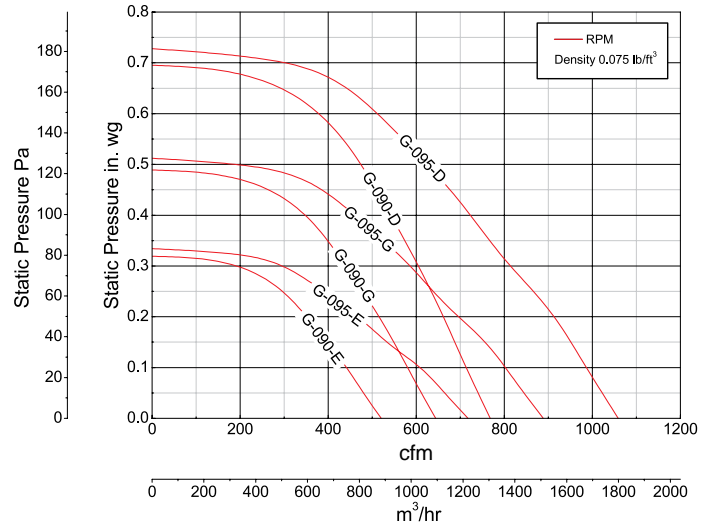

Model Number	HP (Size)	Fan RPM	Static Pressure in Inches wg										
			0	0.1	0.125	0.15	0.2	0.25	0.3	0.375	0.5	0.625	
G-090-E	1/40	1050	CFM	520	441	420	398	351	293				
			BHP	0.01	0.02	0.02	0.02	0.02	0.02				
			Sones	4.0	3.9	3.9	4.0	4.1	4.2				
G-090-G	1/25	1300	CFM	644	580	565	549	515	478	440	373		
			BHP	0.03	0.03	0.04	0.04	0.04	0.04	0.04	0.05		
			Sones	5.4	5.4	5.4	5.4	5.4	5.5	5.5	5.6		
G-090-D	1/15	1550	CFM	768	714	701	688	662	633	605	557	473	338
			BHP	0.05	0.05	0.06	0.06	0.06	0.06	0.07	0.07	0.08	0.07
			Sones	7.6	7.5	7.5	7.5	7.5	7.4	7.4	7.4	7.4	7.4
G-095-E	1/30	1050	CFM	717	606	570	534	468	389	290			
			BHP	0.03	0.03	0.04	0.04	0.04	0.04	0.03			
			Sones	5.4	4.5	4.5	4.5	4.4	4.5	4.6			
G-095-G	1/12	1300	CFM	888	802	780	754	695	640	586	493	184	
			BHP	0.06	0.06	0.06	0.06	0.07	0.07	0.07	0.07	0.05	
			Sones	7.6	6.8	6.7	6.6	6.5	6.4	6.4	6.4	6.4	6.8
G-095-D	1/8	1550	CFM	1059	987	969	950	912	863	814	745	623	474
			BHP	0.10	0.10	0.10	0.11	0.11	0.11	0.11	0.12	0.12	0.11
			Sones	9.6	9.4	9.3	9.2	9.0	8.8	8.7	8.7	8.7	8.7

Performance certified is for installation type A: Free inlet, Free outlet. Performance ratings include the effects of a birdscreen in the airstream. The sound ratings shown are loudness values in fan sones at 5 ft. (1.5 m) in a hemispherical free field calculated per AMCA Standard 301. Values shown are for installation type A: Free inlet fan sone levels.

G-101 and 121 - Direct Drive

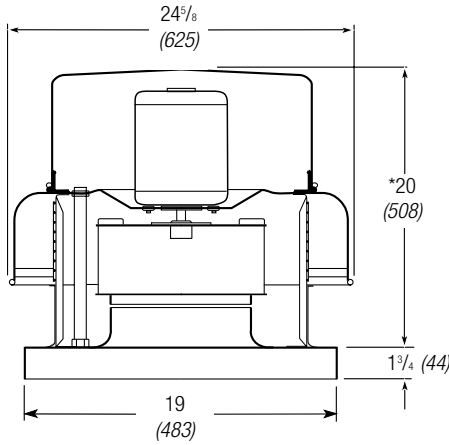

Damper Size = 12 x 12 (304 x 304)
 Roof Opening = 14 1/2 x 14 1/2 (368 x 368)
 ^Approximate Unit Weight = 43 lb. (20 kg)

All dimensions in inches (millimeters).
 *May be greater depending on motor.
 ^Weight shown is largest cataloged Open Drip Proof motor.

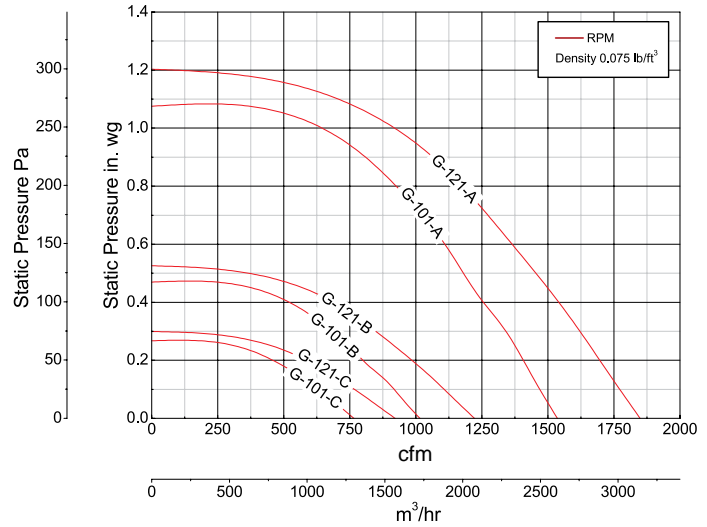

Model Number	HP (Size)	Fan RPM	Static Pressure in Inches wg												
			0	0.1	0.125	0.25	0.3	0.375	0.5	0.625	0.75	1			
G-101-C	1/8	860	CFM	766	625	588									
			BHP	0.02	0.03	0.03									
			Sones	4.3	4.2	4.2									
G-101-B	1/6	1140	CFM	1015	917	893	747	683	569						
			BHP	0.05	0.06	0.06	0.06	0.06	0.06						
			Sones	7.1	7.0	7.0	6.8	6.8	6.6						
G-101-A	1/4	1725	CFM	1536	1470	1454	1374	1340	1277	1181	1086	974			
			BHP	0.17	0.18	0.19	0.20	0.20	0.20	0.21	0.22	0.22			
			Sones	12.1	11.9	11.8	11.6	11.5	11.3	11.2	11.3	11.7			
G-121-C	1/8	860	CFM	922	767	723	450								
			BHP	0.03	0.03	0.04	0.04								
			Sones	5.6	5.2	5.2	5.2								
G-121-B	1/6	1140	CFM	1222	1107	1078	918	848	734	335					
			BHP	0.06	0.07	0.07	0.08	0.09	0.09	0.07					
			Sones	8.1	7.9	7.9	7.8	7.8	8.1	9.8					
G-121-A	1/4	1725	CFM	1849	1772	1753	1659	1621	1560	1453	1341	1223	911		
			BHP	0.22	0.23	0.24	0.25	0.26	0.27	0.28	0.29	0.3	0.29		
			Sones	14.1	14.0	13.9	13.8	13.6	13.4	13.4	13.4	13.4	13.4	14.1	

Performance certified is for installation type A: Free inlet, Free outlet. Performance ratings include the effects of a birdscreen in the airstream. The sound ratings shown are loudness values in fan sones at 5 ft. (1.5 m) in a hemispherical free field calculated per AMCA Standard 301. Values shown are for installation type A: Free inlet fan sone levels.

G-131 and 141 - Direct Drive

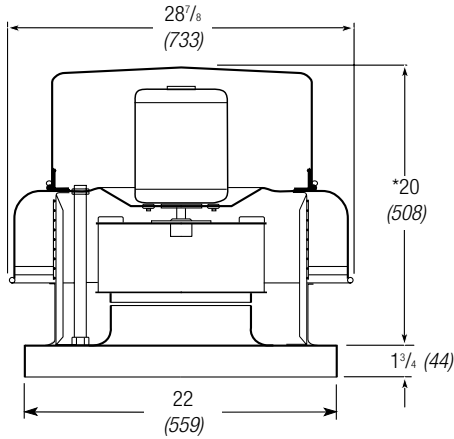

Damper Size = 16 x 16 (406 x 406)
 Roof Opening = 18 1/2 x 18 1/2 (470 x 470)
 ^Approximate Unit Weight = 59 lb. (27 kg)

All dimensions in inches (millimeters).
 *May be greater depending on motor.
 ^Weight shown is largest cataloged Open Drip Proof motor.

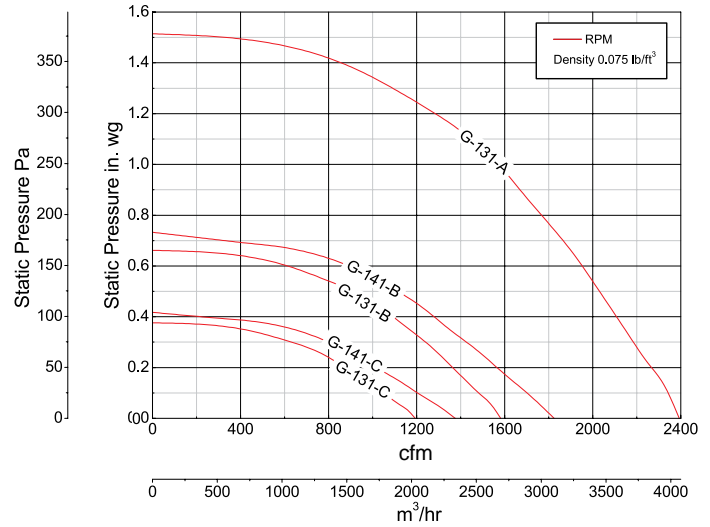

Model Number	HP (Size)	Fan RPM	Static Pressure in Inches wg											
			0	0.1	0.125	0.25	0.3	0.375	0.5	0.625	0.75	1		
G-131-C	1/8	860	CFM	1193	1050	1011	771	626						
			BHP	0.04	0.049	0.051	0.056	0.055						
			Sones	6.5	6.1	6.0	5.9	5.9						
G-131-B	1/6	1140	CFM	1581	1482	1452	1304	1239	1130	889				
			BHP	0.094	0.105	0.108	0.12	0.123	0.13	0.129				
			Sones	9.9	9.8	9.7	9.4	9.2	9.0	8.8				
G-131-A	1/2	1725	CFM	2393	2340	2327	2225	2186	2127	2030	1931	1817	1555	
			BHP	0.325	0.339	0.342	0.366	0.376	0.389	0.407	0.423	0.426	0.453	
			Sones	19.2	18.9	18.9	18.4	18.4	18.2	18.1	18.1	17.8	17.4	
G-141-C	1/8	860	CFM	1376	1205	1161	919	798	489					
			BHP	0.055	0.064	0.066	0.074	0.074	0.063					
			Sones	6.8	6.6	6.5	6.4	6.6	8.0					
G-141-B	1/6	1140	CFM	1824	1701	1667	1498	1425	1314	1113	794			
			BHP	0.129	0.141	0.144	0.158	0.163	0.17	0.175	0.158			
			Sones	10.4	10.4	10.3	9.8	9.5	9.1	8.7	8.4			

Performance certified is for installation type A: Free inlet, Free outlet. Performance ratings include the effects of a birdscreen in the airstream. The sound ratings shown are loudness values in fan sones at 5 ft. (1.5 m) in a hemispherical free field calculated per AMCA Standard 301. Values shown are for installation type A: Free inlet fan sone levels.

G-150 and 160 - Direct Drive

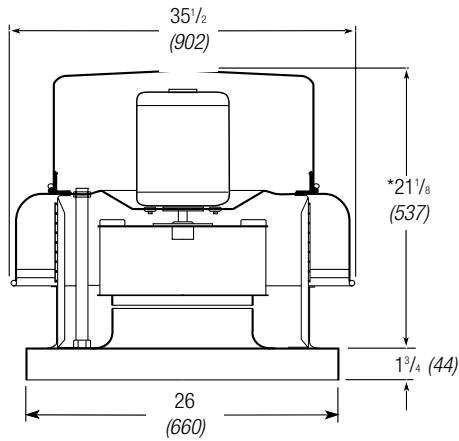

Model G-150

Damper Size = 16 x 16 (406 x 406)
 Roof Opening = 18 1/2 x 18 1/2 (470 x 470)
 ^Approximate Unit Weight = 59 lb. (27 kg)

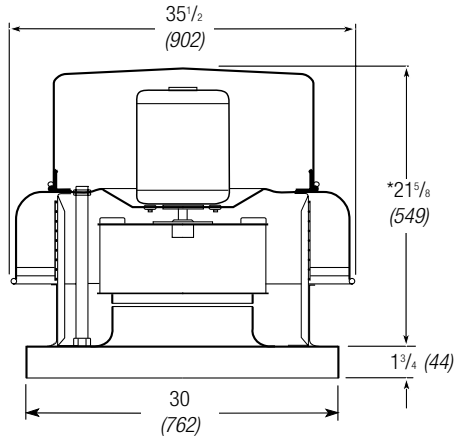

Models G-160

Damper Size = 18 x 18 (457 x 457)
 Roof Opening = 20 1/2 x 20 1/2 (521 x 521)
 ^Approximate Unit Weight = 81 lb. (37 kg)

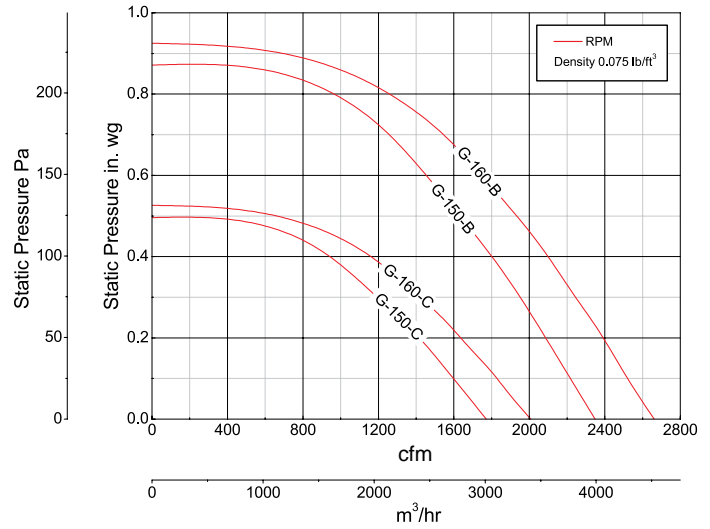

All dimensions in inches (millimeters). *May be greater depending on motor.
 ^Weight shown is largest cataloged Open Drip Proof motor.

Model Number	HP (Size)	Fan RPM		Static Pressure in Inches wg										
				0	0.1	0.125	0.2	0.25	0.3	0.375	.5	.625	.75	
G-150-C	1/8	860	CFM	1772	1598	1553	1415	1304	1194	1005				
			BHP	0.09	0.09	0.10	0.12	0.12	0.13	0.13				
			Sones	7.9	7.8	7.8	7.5	7.4	7.5	7.7				
G-150-B	1/4	1140	CFM	2349	2217	2185	2085	2017	1949	1836	1628	1397	1114	
			BHP	0.21	0.21	0.21	0.21	0.23	0.25	0.27	0.29	0.29	0.28	
			Sones	11.7	11.6	11.6	11.3	11.1	11.0	10.9	11.2	11.8	12.8	
G-160-C	1/8	860	CFM	2008	1828	1784	1637	1535	1421	1230				
			BHP	0.10	0.11	0.12	0.13	0.13	0.13	0.14				
			Sones	8.0	7.7	7.7	7.5	7.4	7.3	7.3				
G-160-B	1/3	1140	CFM	2662	2521	2489	2392	2319	2245	2135	1933	1697	1411	
			BHP	0.23	0.25	0.25	0.27	0.28	0.28	0.29	0.31	0.32	0.32	
			Sones	13.6	13.4	13.4	13.3	13.1	13.1	13.1	12.9	12.7	12.6	

Performance certified is for installation type A: Free inlet, Free outlet. Performance ratings include the effects of a birdscreen in the airstream. The sound ratings shown are loudness values in fan sones at 5 ft. (1.5 m) in a hemispherical free field calculated per AMCA Standard 301. Values shown are for installation type A: Free inlet fan some levels.

G-170 and 180 - Direct Drive

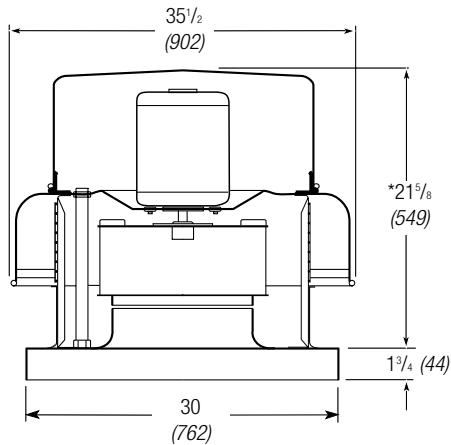

Models G-170

Damper Size = 18 x 18 (457 x 457)

Roof Opening = 20 1/2 x 20 1/2 (521 x 521)

^Approximate Unit Weight = 81 lb. (37 kg)

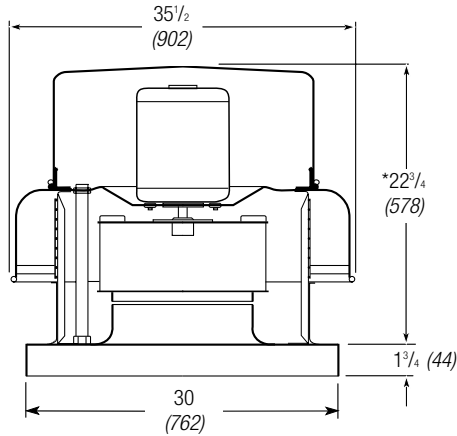

Model G-180

Damper Size = 18 x 18 (457 x 457)

Roof Opening = 20 1/2 x 20 1/2 (521 x 521)

^Approximate Unit Weight = 118 lb. (54 kg)

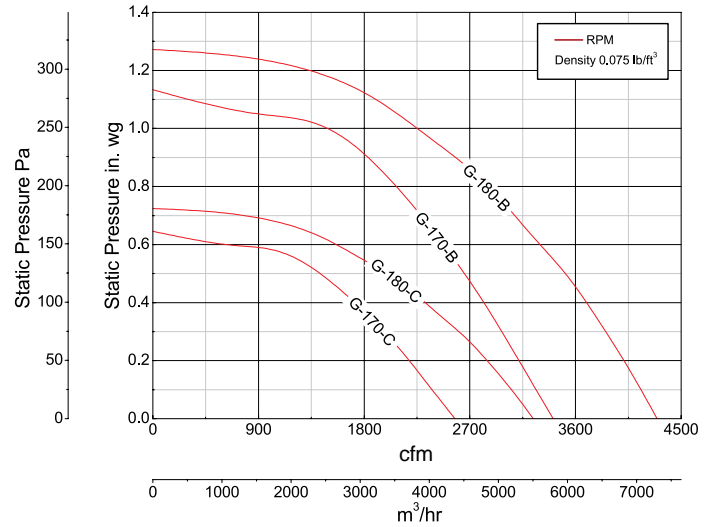

All dimensions in inches (millimeters). *May be greater depending on motor. ^Weight shown is largest cataloged Open Drip Proof motor.

Model Number	HP (Size)	Fan RPM	Static Pressure in Inches wg										
			0	0.1	0.125	0.25	0.3	0.375	0.5	0.625	0.75	1	
G-170-C	1/4	860	CFM	2572	2379	2330	2077	1961	1782	1416			
			BHP	0.172	0.187	0.191	0.208	0.214	0.223	0.228			
			Sones	9.7	9.6	9.5	9.2	9.1	9.1	9.1			
G-170-B	1/2	1140	CFM	3409	3263	3227	3043	2969	2857	2647	2428	2181	1457
			BHP	0.4	0.421	0.426	0.45	0.46	0.473	0.494	0.514	0.532	0.488
			Sones	16.3	16.2	16.2	16.1	16.1	16.1	16.1	16.1	16.1	16.1
G-180-C	1/3	860	CFM	3240	3053	3002	2733	2603	2390	1978	1438		
			BHP	0.24	0.262	0.268	0.296	0.306	0.321	0.332	0.316		
			Sones	12.1	12.4	12.4	12.5	12.5	12.3	11.9	11.9		
G-180-B	3/4	1140	CFM	4295	4156	4121	3933	3855	3731	3509	3241	2971	2246
			BHP	0.559	0.589	0.596	0.634	0.649	0.671	0.707	0.74	0.771	0.759
			Sones	19.5	19.4	19.4	19.3	19.5	19.7	19.8	20	20	20

Performance certified is for installation type A: Free inlet, Free outlet. Performance ratings include the effects of a birdscreen in the airstream. The sound ratings shown are loudness values in fan sones at 5 ft. (1.5 m) in a hemispherical free field calculated per AMCA Standard 301. Values shown are for installation type A: Free inlet fan some levels.

GB-071 - Belt Drive

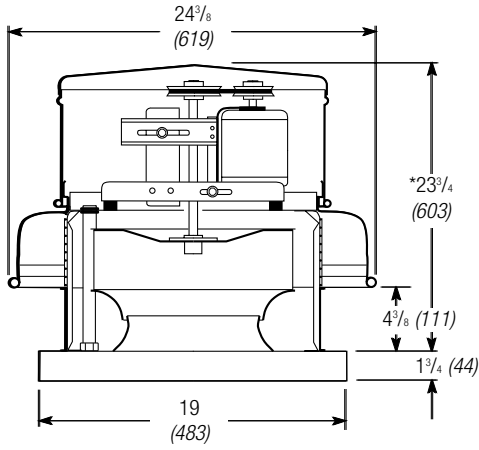

Damper Size = 12 x 12 (305 x 305)
 Roof Opening = 14 1/2 x 14 1/2 (368 x 368)
 Shroud Thickness = 0.051 (1.3)
 Motor Cover Thickness = 0.040 (1.0)
 Curb Cap Thickness = 0.064 (1.6)
 ^Approximate Unit Weight = 58 lb. (26 kg)

All dimensions in inches (millimeters).
 *May be greater depending on motor.
 ^Weight shown is largest cataloged Open Drip Proof motor.

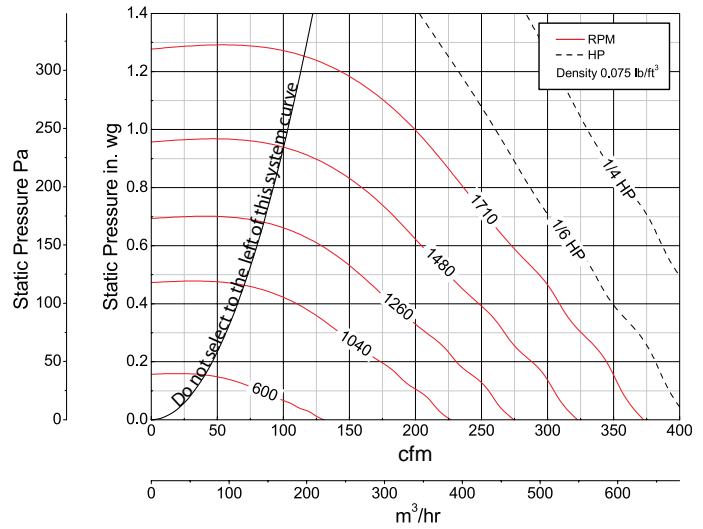

Model Number	HP (Size)	Fan RPM	Static Pressure in Inches wg																		
			0	0.125	0.25	0.375	0.5	0.625	0.75	0.875	1	1.125									
GB-071-6 or GB-071-4	1/6	630	CFM	137	79																
			BHP	0.01	0.01																
			Sones	1.3	1.4																
		738	CFM	161	112																
			BHP	0.01	0.01																
			Sones	1.9	2.1																
		846	CFM	184	144	95															
			BHP	0.02	0.02	0.01															
			Sones	2.7	2.6	2.6															
		954	CFM	208	172	132	76														
			BHP	0.02	0.02	0.02	0.02														
			Sones	3.5	3.6	3.4	3.2														
		1062	CFM	231	200	164	127														
			BHP	0.03	0.03	0.03	0.03														
			Sones	4.5	4.6	4.4	4.2														
		1170	CFM	255	227	196	162	123													
			BHP	0.04	0.04	0.04	0.04	0.04													
			Sones	5.7	5.7	5.5	5.2	5.0													
		1278	CFM	279	254	226	195	164	124												
			BHP	0.05	0.05	0.05	0.05	0.05	0.05												
			Sones	6.7	6.7	6.5	6.2	6.0	5.8												
		1386	CFM	302	280	253	226	197	169	129											
			BHP	0.07	0.07	0.07	0.07	0.07	0.07	0.06											
			Sones	7.6	7.6	7.4	7.2	6.9	6.7	6.5											
		1494	CFM	326	305	280	257	230	203	177	138										
			BHP	0.09	0.09	0.09	0.09	0.09	0.08	0.08	0.07										
			Sones	8.6	8.6	8.4	8.2	7.9	7.6	7.5	7.3										
		1602	CFM	349	329	308	286	262	237	212	186	150									
			BHP	0.11	0.11	0.11	0.11	0.11	0.10	0.10	0.10	0.09									
			Sones	9.8	9.7	9.6	9.3	9.1	8.8	8.5	8.4	8.1									
		1710	CFM	373	353	335	312	292	269	246	223	198	164								
			BHP	0.13	0.13	0.13	0.13	0.13	0.13	0.13	0.12	0.12	0.11								
			Sones	11.1	11.0	11.0	10.6	10.3	10.0	9.8	9.5	9.3	9.1								

MAXIMUM BHP AT A GIVEN RPM = (RPM/3371)³
 MAXIMUM RPM = 1710
 TIP SPEED (ft/min.) = RPM x 2.929
 MAXIMUM MOTOR FRAME SIZE = 56

Performance shown is for installation type A: Free inlet, Free outlet. Power rating (BHP) does not include transmission losses. Performance ratings include the effects of a birdscreen in the airstream. The sound ratings shown are loudness values in fan sones at 5 ft. (1.5 m) in a hemispherical free field calculated per AMCA Standard 301. Values shown are for installation type A: Free inlet fan sone levels.

GB-081 - Belt Drive

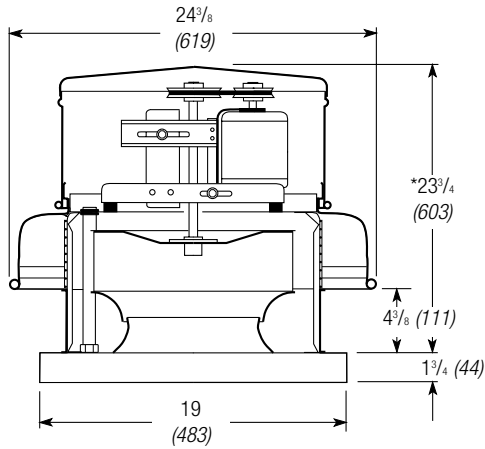

Damper Size = 12 x 12 (305 x 305)
 Roof Opening = 14 1/2 x 14 1/2 in. (368 x 368)
 Shroud Thickness = 0.051 (1.3)
 Motor Cover Thickness = 0.040 (1.0)
 Curb Cap Thickness = 0.064 (1.6)
 ^Approximate Unit Weight = 58 lb. (26 kg)

All dimensions in inches (millimeters).
 *May be greater depending on motor.
 ^Weight shown is largest cataloged Open Drip Proof motor.

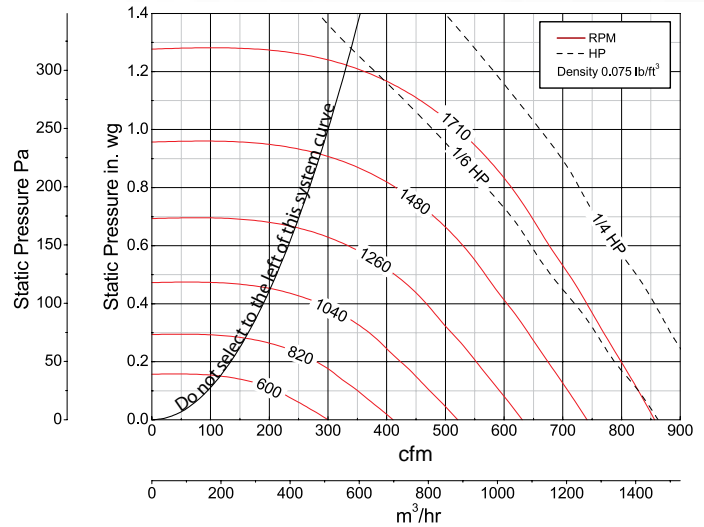

Model Number	HP (Size)	Fan RPM	Static Pressure in Inches wg																		
			0	0.125	0.25	0.375	0.5	0.625	0.75	0.875	1	1.125									
GB-081-6 or GB-081-4	1/6 or 1/4	630	CFM	316	207																
			BHP	0.01	0.01																
			Sones	2.4	2.1																
		738	CFM	370	283																
			BHP	0.01	0.02																
			Sones	3.1	2.8																
		864	CFM	433	361	265															
			BHP	0.02	0.02	0.02															
			Sones	4.0	3.8	3.5															
		954	CFM	478	413	341															
			BHP	0.03	0.03	0.03															
			Sones	4.8	4.6	4.2															
		1062	CFM	532	474	411	329														
			BHP	0.04	0.04	0.05	0.04														
			Sones	5.9	5.7	5.3	5.0														
		1170	CFM	586	533	478	419	317													
			BHP	0.05	0.06	0.06	0.06	0.06													
			Sones	6.9	6.7	6.4	6.0	5.7													
		1278	CFM	640	592	543	490	428	320												
			BHP	0.07	0.07	0.08	0.08	0.08	0.07												
			Sones	7.9	7.8	7.4	7.0	6.7	6.6												
		1386	CFM	694	650	605	557	507	441	334											
			BHP	0.09	0.09	0.10	0.10	0.10	0.10	0.09											
			Sones	9.1	8.9	8.6	8.2	7.9	7.6	7.6											
		1494	CFM	748	708	666	623	577	528	457	357										
			BHP	0.11	0.12	0.12	0.12	0.12	0.13	0.12	0.11										
			Sones	10.1	10.0	9.8	9.4	8.9	8.7	8.5	8.4										
		1602	CFM	802	765	725	686	644	602	552	480	388									
			BHP	0.14	0.14	0.15	0.15	0.15	0.15	0.16	0.15	0.14									
			Sones	11.3	11.1	10.9	10.5	10.1	9.9	9.6	9.5	9.3									
		1710	CFM	856	821	785	748	710	669	630	581	511	424								
			BHP	0.17	0.17	0.18	0.18	0.19	0.19	0.19	0.19	0.18	0.17								
			Sones	12.5	12.3	12.1	11.9	11.5	11.2	10.9	10.6	10.5	10.3								

MAXIMUM BHP AT A GIVEN RPM = (RPM/2985)³
 MAXIMUM RPM = 1710
 TIP SPEED (ft/min.) = RPM x 2.929
 MAXIMUM MOTOR FRAME SIZE = 56

Performance shown is for installation type A: Free inlet, Free outlet. Power rating (BHP) does not include transmission losses. Performance ratings include the effects of a birdscreen in the airstream. The sound ratings shown are loudness values in fan sones at 5 ft. (1.5 m) in a hemispherical free field calculated per AMCA Standard 301. Values shown are for installation type A: Free inlet fan sone levels.

GB-091 - Belt Drive

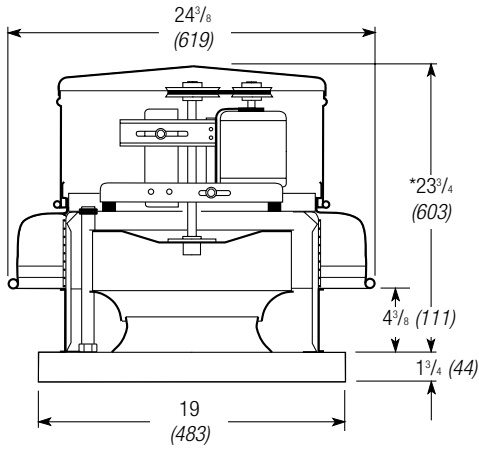

Damper Size = 12 x 12 (305 x 305)
 Roof Opening = 14 1/2 x 14 1/2 in. (368 x 368)
 Shroud Thickness = 0.051 (1.3)
 Motor Cover Thickness = 0.040 (1.0)
 Curb Cap Thickness = 0.064 (1.6)
 ^Approximate Unit Weight = 58 lb. (26 kg)

All dimensions in inches (millimeters).
 *May be greater depending on motor.
 ^Weight shown is largest cataloged Open Drip Proof motor.

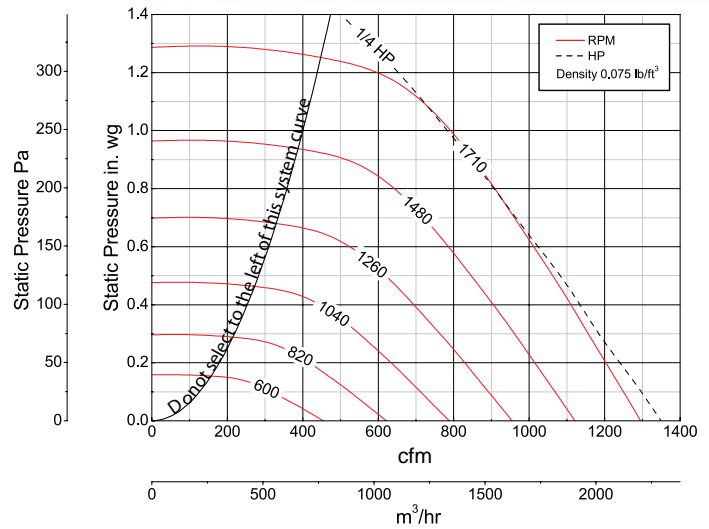

Model Number	HP (Size)	Fan RPM	Static Pressure in Inches wg															
			0	0.125	0.25	0.375	0.5	0.625	0.75	0.875	1	1.125						
GB-091-4	1/4	630	CFM	477	309													
			BHP	0.01	0.01													
			Sones	2.9	3.0													
		738	CFM	559	421													
			BHP	0.02	0.02													
			Sones	3.7	3.6													
		864	CFM	655	539	405												
			BHP	0.03	0.03	0.03												
			Sones	4.9	4.8	4.5												
		954	CFM	723	619	506	313											
			BHP	0.04	0.04	0.04	0.04											
			Sones	5.9	5.7	5.3	5.1											
		1062	CFM	805	711	613	502											
			BHP	0.05	0.06	0.06	0.06											
			Sones	7.2	7.0	6.6	6.2											
		1170	CFM	886	802	715	621	500										
			BHP	0.07	0.08	0.08	0.08	0.08										
			Sones	8.7	8.4	8.0	7.5	7.1										
		1278	CFM	968	891	813	729	639	516									
			BHP	0.09	0.10	0.10	0.10	0.11	0.10									
			Sones	9.5	9.3	8.9	8.5	8.1	7.8									
		1386	CFM	1050	979	907	832	752	666	545								
			BHP	0.12	0.12	0.13	0.13	0.13	0.14	0.13								
			Sones	10.3	10.1	9.9	9.5	9.1	8.8	8.5								
		1494	CFM	1132	1066	999	932	860	785	698	584							
			BHP	0.15	0.15	0.16	0.16	0.17	0.17	0.17	0.16							
			Sones	11.2	11.1	10.9	10.6	10.2	9.9	9.6	9.3							
		1602	CFM	1214	1152	1090	1028	962	894	823	738	631						
			BHP	0.18	0.19	0.19	0.20	0.20	0.20	0.21	0.21	0.20						
			Sones	12.3	12.1	12.0	11.8	11.4	11.1	10.8	10.5	10.2						
		1710	CFM	1296	1238	1180	1122	1062	999	934	867	785	685					
			BHP	0.22	0.23	0.23	0.24	0.24	0.25	0.25	0.25	0.25	0.25	0.24				
			Sones	13.4	13.3	13.2	13.0	12.7	12.4	12.1	11.8	11.6	11.2					

MAXIMUM BHP AT A GIVEN RPM = (RPM/2703)³
 MAXIMUM RPM = 1710
 TIP SPEED (ft/min.) = RPM x 2.929
 MAXIMUM MOTOR FRAME SIZE = 56

Performance shown is for installation type A: Free inlet, Free outlet. Power rating (BHP) does not include transmission losses. Performance ratings include the effects of a birdscreen in the airstream. The sound ratings shown are loudness values in fan sones at 5 ft. (1.5 m) in a hemispherical free field calculated per AMCA Standard 301. Values shown are for installation type A: Free inlet fan sone levels.

GB-101 - Belt Drive

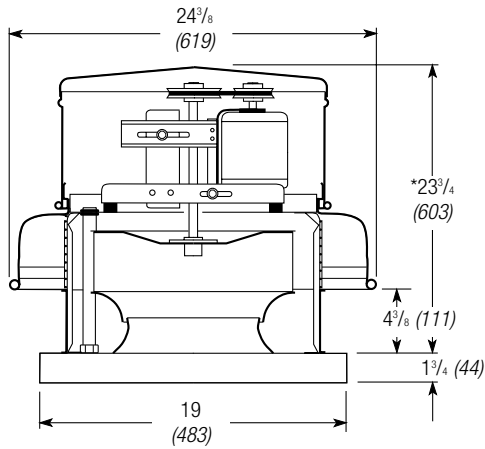

Damper Size = 12 x 12 (305 x 305)
 Roof Opening = 14 1/2 x 14 1/2 (368 x 368)
 Shroud Thickness = 0.051 (1.3)
 Motor Cover Thickness = 0.040 (1.0)
 Curb Cap Thickness = 0.064 (1.6)
 ^Approximate Unit Weight = 63 lb. (29 kg)

All dimensions in inches (millimeters).
 *May be greater depending on motor.
 ^Weight shown is largest cataloged Open Drip Proof motor.

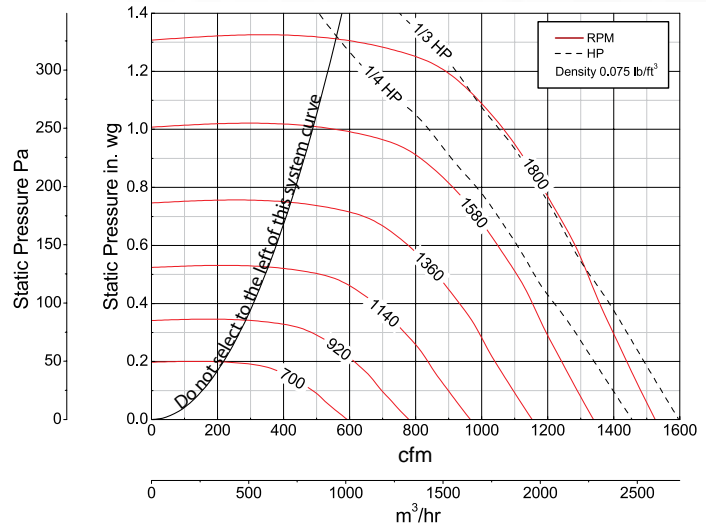

Model Number	HP (Size)	Fan RPM	Static Pressure in Inches wg																	
			0	0.125	0.25	0.375	0.5	0.625	0.75	0.875	1	1.25								
GB-101-4	1/4	830	CFM	703	594	420														
			BHP	0.03	0.03	0.03														
			Sones	4.5	3.5	2.6														
		930	CFM	788	688	572														
			BHP	0.04	0.04	0.05														
			Sones	5.1	4.3	3.7														
	1030	CFM	873	781	688	539														
		BHP	0.05	0.06	0.06	0.06														
		Sones	5.7	5.1	4.7	3.8														
	1130	CFM	958	873	795	690	420													
		BHP	0.07	0.08	0.08	0.08	0.07													
		Sones	6.5	5.9	5.6	5	3.6													
	1230	CFM	1042	965	894	807	693													
		BHP	0.09	0.10	0.11	0.11	0.11													
		Sones	7.3	6.8	6.5	6.2	5.5													
	1330	CFM	1127	1055	987	917	827	696												
		BHP	0.12	0.12	0.13	0.14	0.14	0.13												
		Sones	8.3	7.8	7.6	7.4	6.9	6.4												
1430	CFM	1212	1144	1080	1021	943	851	715												
	BHP	0.14	0.15	0.16	0.17	0.17	0.17	0.16												
	Sones	9.1	8.8	8.5	8.2	7.8	7.3	6.6												
1530	CFM	1297	1233	1173	1117	1053	975	883	744											
	BHP	0.18	0.18	0.19	0.20	0.21	0.21	0.21	0.19											
	Sones	10.0	9.7	9.5	9.1	8.6	8.2	7.8	7.1											
1635	CFM	1386	1326	1269	1215	1162	1095	1020	929	793										
	BHP	0.22	0.22	0.23	0.24	0.25	0.25	0.25	0.25	0.24										
	Sones	11.1	10.8	10.4	10.2	9.8	9.3	8.9	8.4	7.8										
GB-101-3	1/3	1718	CFM	1456	1399	1345	1291	1244	1185	1118	1043	943								
			BHP	0.25	0.26	0.27	0.28	0.29	0.29	0.29	0.29	0.29								
			Sones	12.1	11.7	11.3	11.1	10.8	10.2	9.8	9.4	8.9								
		1800	CFM	1526	1471	1419	1368	1321	1270	1209	1142	1065	793							
			BHP	0.29	0.30	0.30	0.31	0.33	0.34	0.34	0.34	0.34	0.34							
			Sones	13.2	12.8	12.5	12.3	12.2	11.3	10.8	10.6	10.1	9.3							

MAXIMUM BHP AT A GIVEN RPM = (RPM/2593)³
 MAXIMUM RPM = 1800
 TIP SPEED (ft/min.) = RPM x 2.913
 MAXIMUM MOTOR FRAME SIZE = 56

Performance shown is for installation type A: Free inlet, Free outlet. Power rating (BHP) does not include transmission losses. Performance ratings include the effects of a birdscreen in the airstream. The sound ratings shown are loudness values in fan sones at 5 ft. (1.5 m) in a hemispherical free field calculated per AMCA Standard 301. Values shown are for installation type A: Free inlet fan sone levels.

GB-101HP - Belt Drive

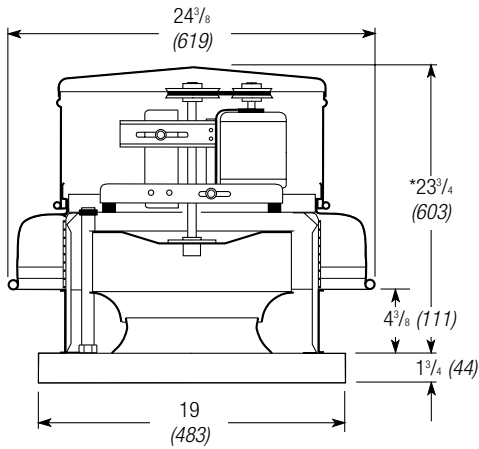

Damper Size = 12 x 12 (305 x 305)
 Roof Opening = 14 1/2 x 14 1/2 (368 x 368)
 Shroud Thickness = 0.051 (1.3)
 Motor Cover Thickness = 0.040 (1.0)
 Curb Cap Thickness = 0.064 (1.6)
 ^Approximate Unit Weight = 63 lb. (29 kg)

All dimensions in inches (millimeters).
 *May be greater depending on motor.
 ^Weight shown is largest cataloged Open Drip Proof motor.

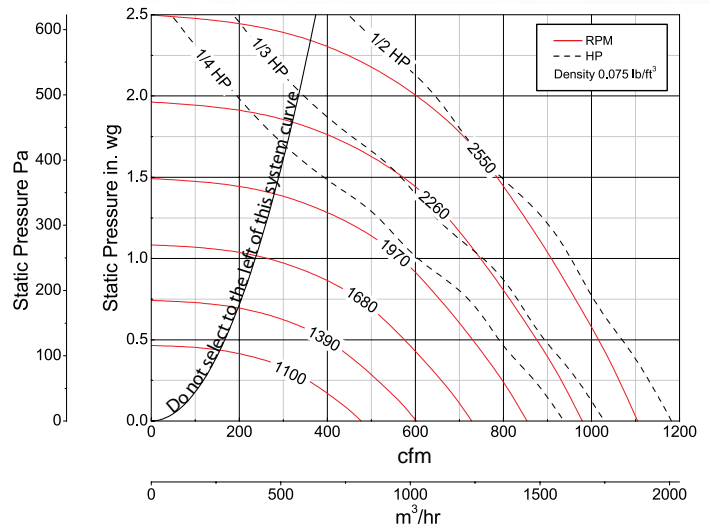

Model Number	HP (Size)	Fan RPM	Static Pressure in Inches wg																		
			0	0.25	0.5	0.75	1	1.25	1.5	1.75	2	2.25									
GB-101HP-4	1/4	1300	CFM	571	477	342															
			BHP	0.06	0.06	0.07															
			Sones	6.6	5.7	5.3															
		1445	CFM	635	553	449	243														
			BHP	0.08	0.09	0.09	0.08														
			Sones	8.4	7.5	7.0	6.3														
	1590	CFM	699	626	537	417															
		BHP	0.10	0.11	0.12	0.12															
		Sones	10.4	9.5	9.1	8.3															
	1735	CFM	762	697	619	527	376														
		BHP	0.13	0.15	0.15	0.16	0.15														
		Sones	11.5	10.8	10.7	10.3	10.2														
1880	CFM	826	767	697	618	518	337														
	BHP	0.17	0.18	0.20	0.20	0.21	0.18														
	Sones	12.7	12.2	11.9	12	11.4	11.9														
2025	CFM	890	836	772	702	622	515	313													
	BHP	0.21	0.23	0.24	0.24	0.26	0.25	0.22													
	Sones	14.2	13.6	13.3	13.2	12.6	12	11.4													
GB-101HP-3	1/3	2137	CFM	939	889	830	765	693	607	474											
			BHP	0.25	0.26	0.28	0.28	0.30	0.30	0.28											
			Sones	15.4	14.8	14.4	14.2	13.4	13.1	12.1											
	2229	CFM	979	931	875	814	748	674	574	406											
		BHP	0.29	0.30	0.31	0.32	0.33	0.35	0.33	0.31											
		Sones	15.8	15.4	14.8	14.5	14.1	13.7	13.2												
GB-101HP-5	1/2	2336	CFM	1026	981	928	871	809	742	661	543	358									
			BHP	0.33	0.34	0.36	0.37	0.37	0.39	0.40	0.38	0.34									
			Sones	16.4	16.0	15.4	14.9	14.7	14.0	14.1	13.5	13.6									
	2443	CFM	1073	1030	981	927	869	807	739	649	519										
		BHP	0.38	0.39	0.41	0.42	0.42	0.44	0.46	0.44	0.42										
		Sones	17.3	16.9	16.4	16.0		14.9	14.5	14.7	15.0										
2550	CFM	1120	1078	1032	982	928	869	807	735	639	497										
	BHP	0.43	0.44	0.46	0.48	0.48	0.49	0.51	0.52	0.50	0.47										
	Sones	18.2	17.9	17.4	17.2	16.3	16.1	15.1	15.6	16.2	17.2										

MAXIMUM BHP AT A GIVEN RPM = (RPM/3165)³
 MAXIMUM RPM = 2550
 TIP SPEED (ft/min.) = RPM x 2.978
 MAXIMUM MOTOR FRAME SIZE = 56

Performance shown is for installation type A: Free inlet, Free outlet. Power rating (BHP) does not include transmission losses. Performance ratings include the effects of a birdscreen in the airstream. The sound ratings shown are loudness values in fan sones at 5 ft. (1.5 m) in a hemispherical free field calculated per AMCA Standard 301. Values shown are for installation type A: Free inlet fan sone levels.

GB-121 - Belt Drive

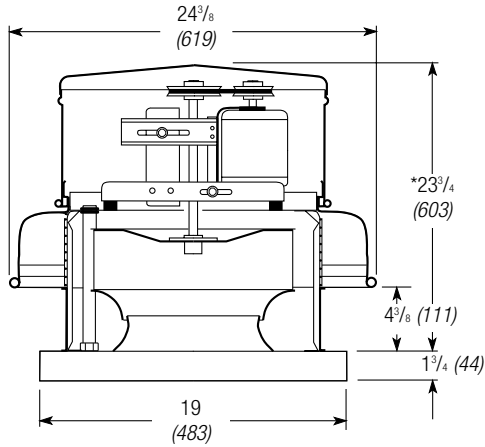

Damper Size = 12 x 12 (305 x 305)
 Roof Opening = 14 1/2 x 14 1/2 (368 x 368)
 Shroud Thickness = 0.051 (1.3)
 Motor Cover Thickness = 0.040 (1.0)
 Curb Cap Thickness = 0.064 (1.6)
 ^Approximate Unit Weight = 66 lb. (30 kg)

All dimensions in inches (millimeters).
 *May be greater depending on motor.
 ^Weight shown is largest cataloged Open Drip Proof motor.

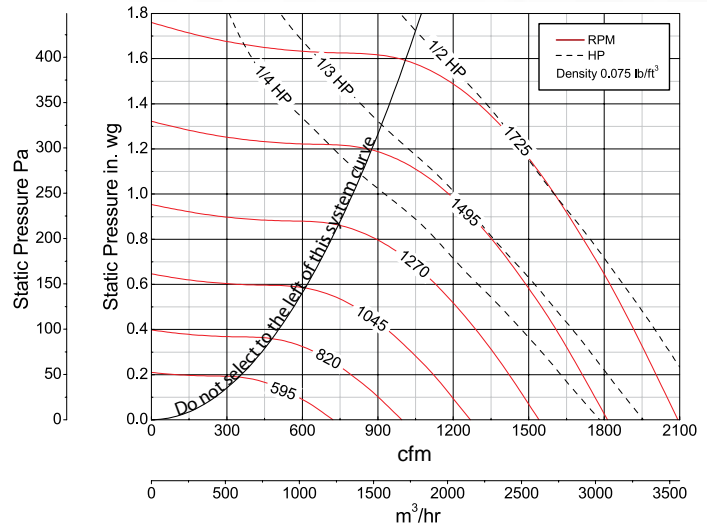

Model Number	HP (Size)	Fan RPM	Static Pressure in Inches wg																
			0	0.125	0.25	0.375	0.5	0.625	0.75	1	1.25	1.5							
GB-121-4	1/4	595	CFM	722	542														
			BHP	0.02	0.02														
			Sones	3.3	3.4														
		728	CFM	883	747	543													
				BHP	0.03	0.04	0.04												
				Sones	4.2	4.3	4.2												
		861	CFM	1044	933	798	584												
				BHP	0.05	0.06	0.06	0.06											
				Sones	5.4	5.5	5.2	5.2											
		994	CFM	1206	1111	1004	872	673											
				BHP	0.08	0.09	0.09	0.10	0.09										
				Sones	6.7	6.7	6.6	6.4	6.3										
	1127	CFM	1367	1284	1195	1092	969	799											
			BHP	0.11	0.12	0.13	0.14	0.14	0.13										
			Sones	8.2	8.2	8.2	7.9	7.8	7.7										
	1260	CFM	1528	1454	1377	1292	1196	1084	938										
			BHP	0.16	0.17	0.18	0.19	0.19	0.19	0.19									
			Sones	10.1	10.1	10.0	9.9	9.6	9.5	9.3									
	1395	CFM	1692	1625	1557	1484	1404	1315	1214	907									
			BHP	0.21	0.23	0.24	0.25	0.26	0.26	0.26	0.25								
			Sones	12.5	12.4	12.3	12.2	12.0	11.7	11.5	11.3								
GB-121-3	1/3	1473	CFM	1787	1723	1659	1591	1518	1438	1352	1127								
			BHP	0.25	0.27	0.28	0.29	0.30	0.31	0.31	0.30								
			Sones	13.5	13.4	13.3	13.1	12.9	12.7	12.4	12.0								
		1550	CFM	1880	1820	1759	1696	1629	1555	1475	1289	974							
				BHP	0.30	0.31	0.32	0.33	0.34	0.35	0.36	0.36	0.33						
				Sones	14.6	14.5	14.3	14.2	14.0	13.8	13.5	12.9	12.4						
GB-121-5	1/2	1638	CFM	1987	1930	1872	1814	1751	1684	1613	1452	1238							
			BHP	0.35	0.36	0.38	0.39	0.40	0.41	0.42	0.43	0.42							
			Sones	16.0	15.8	15.6	15.5	15.3	15.1	14.9	14.0	13.5							
		1725	CFM	2093	2038	1984	1928	1871	1810	1743	1600	1426	1180						
				BHP	0.40	0.42	0.44	0.45	0.46	0.47	0.48	0.50	0.50	0.48					
				Sones	17.4	17.2	17.0	16.8	16.7	16.4	16.2	15.5	14.9	14.0					

MAXIMUM BHP AT A GIVEN RPM = (RPM/2170)³
 MAXIMUM RPM = 1725
 TIP SPEED (ft/min.) = RPM x 3.420
 MAXIMUM MOTOR FRAME SIZE = 56

Performance shown is for installation type A: Free inlet, Free outlet. Power rating (BHP) does not include transmission losses. Performance ratings include the effects of a birdscreen in the airstream. The sound ratings shown are loudness values in fan sones at 5 ft. (1.5 m) in a hemispherical free field calculated per AMCA Standard 301. Values shown are for installation type A: Free inlet fan sone levels.

GB-131 - Belt Drive

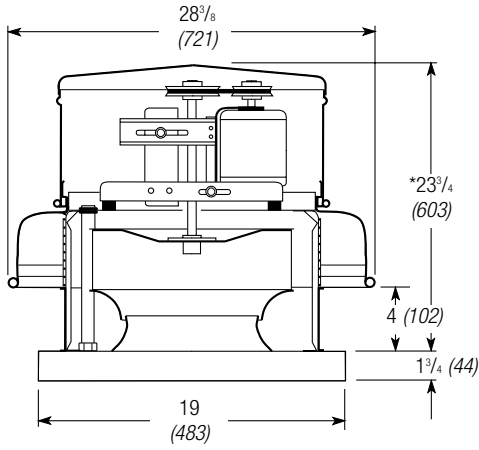

Damper Size = 12 x 12 (305 x 305)
 Roof Opening = 14 1/2 x 14 1/2 in. (368 x 368)
 Shroud Thickness = 0.051 (1.3)
 Motor Cover Thickness = 0.040 (1.0)
 Curb Cap Thickness = 0.064 (1.6)
 ^Approximate Unit Weight = 67 lb. (30 kg)

All dimensions in inches (millimeters).
 *May be greater depending on motor.
 ^Weight shown is largest cataloged Open Drip Proof motor.

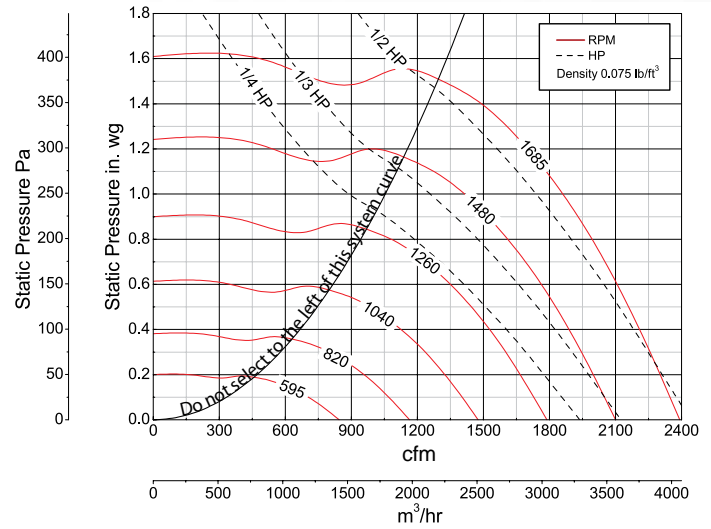

Model Number	HP (Size)	Fan RPM	Static Pressure in Inches wg														
			0	0.125	0.25	0.375	0.5	0.625	0.75	1	1.25	1.5					
GB-131-4	1/4	595	CFM	844	655												
			BHP	0.02	0.02												
			Sones	4.5	4.6												
	700	CFM	993	845	585												
			BHP	0.03	0.04	0.04											
			Sones	5.2	5.2	5.0											
	800	CFM	1135	1012	843												
			BHP	0.05	0.06	0.06											
			Sones	6.0	6.0	5.7											
	900	CFM	1277	1169	1039	845											
			BHP	0.07	0.08	0.08	0.08										
			Sones	7.0	6.9	6.6	6.3										
1000	CFM	1419	1223	1213	1075	867											
		BHP	0.10	0.11	0.11	0.12	0.11										
		Sones	8.1	8.0	7.7	7.4	7.0										
1100	CFM	1516	1475	1381	1268	1124	898										
		BHP	0.13	0.14	0.15	0.15	0.16	0.15									
		Sones	9.5	9.2	9.0	8.6	8.3	7.9									
1200	CFM	1703	1624	1539	1443	1330	1191	964									
		BHP	0.17	0.18	0.19	0.20	0.20	0.20	0.19								
		Sones	11.1	10.8	10.5	10.1	9.7	9.4	8.8								
1315	CFM	1866	1794	1718	1637	1545	1435	1305									
		BHP	0.22	0.23	0.24	0.25	0.26	0.26	0.26								
		Sones	13.2	12.8	12.5	12.1	11.7	11.2	10.9								
GB-131-3	1/3	1440	CFM	2044	1978	1911	1838	1759	1674	1571	1299						
			BHP	0.294	0.306	0.318	0.327	0.336	0.344	0.347	0.342						
			Sones	15.0	15.0	15.1	15.1	14.5	13.9	13.4	12.5						
GB-131-5	1/2	1563	CFM	2218	2158	2097	2031	1964	1887	1807	1606	1300					
			BHP	0.375	0.389	0.402	0.413	0.424	0.432	0.44	0.445	0.427					
			Sones	16.0	15.8	15.6	15.5	15.2	14.8	14.3	13.6	12.8					
	1685	CFM	2391	2335	2279	2219	2158	2093	2020	1857	1654	1312					
			BHP	0.47	0.485	0.499	0.512	0.523	0.534	0.543	0.555	0.557	0.522				
			Sones	16.9	16.6	16.3	16.0	15.7	15.4	15.1	14.5	13.9	13.5				

MAXIMUM BHP AT A GIVEN RPM = (RPM/2047)³
 MAXIMUM RPM = 1685
 TIP SPEED (ft/min.) = RPM x 3.436
 MAXIMUM MOTOR FRAME SIZE = 56

Performance shown is for installation type A: Free inlet, Free outlet. Power rating (BHP) does not include transmission losses. Performance ratings include the effects of a birdscreen in the airstream. The sound ratings shown are loudness values in fan sones at 5 ft. (1.5 m) in a hemispherical free field calculated per AMCA Standard 301. Values shown are for installation type A: Free inlet fan sone levels.

GB-141 - Belt Drive

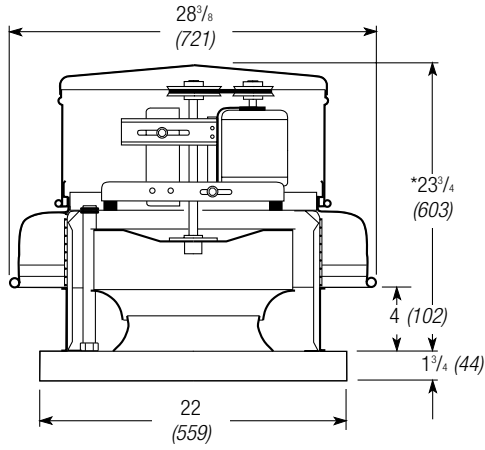

Damper Size = 16 x 16 (406 x 406)
 Roof Opening = 18 1/2 x 18 1/2 (470 x 470)
 Shroud Thickness = 0.051 (1.3)
 Motor Cover Thickness = 0.040 (1.0)
 Curb Cap Thickness = 0.064 (1.6)
 ^Approximate Unit Weight = 83 lb. (38 kg)

All dimensions in inches (millimeters).
 *May be greater depending on motor.
 ^Weight shown is largest cataloged Open Drip Proof motor.

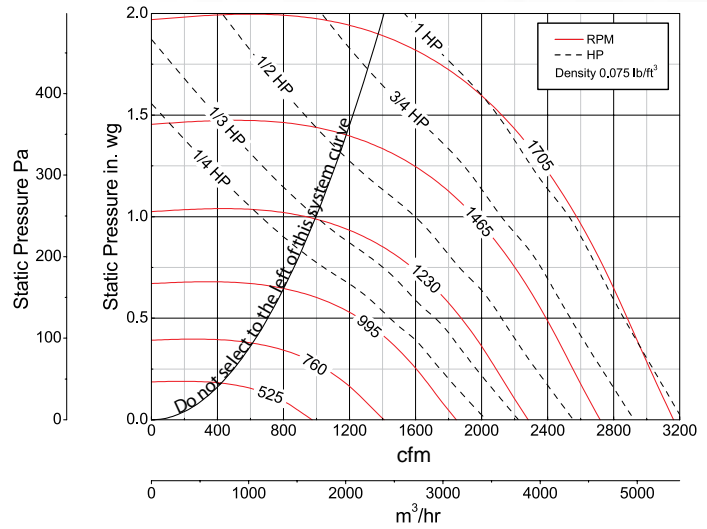

Model Number	HP (Size)	Fan RPM	Static Pressure in Inches wg																		
			0	0.125	0.25	0.375	0.5	0.75	1	1.25	1.5	1.75									
GB-141-4	1/4	525	CFM	974	709																
			BHP	0.03	0.03																
			Sones	4.4	4.2																
		663	CFM	1230	1046	732															
			BHP	0.06	0.06	0.06															
			Sones	5.3	5.5	4.4															
	801	CFM	1486	1337	1161	850															
		BHP	0.10	0.11	0.11	0.10															
		Sones	6.5	6.6	6.1	5.3															
	939	CFM	1742	1614	1482	1313	1040														
		BHP	0.16	0.17	0.17	0.18	0.16														
		Sones	7.9	7.8	7.5	7.0	6.4														
1075	CFM	1994	1882	1771	1647	1490															
	BHP	0.24	0.25	0.26	0.26	0.26															
	Sones	10.0	9.9	9.4	8.9	8.4															
GB-141-3	1/3	1170	CFM	2170	2067	1966	1859	1734	1356												
			BHP	0.31	0.32	0.33	0.33	0.34	0.32												
			Sones	11.4	11.3	10.8	10.3	9.9	8.7												
GB-141-5	1/2	1265	CFM	2347	2250	2158	2062	1955	1677	1048											
			BHP	0.39	0.40	0.41	0.42	0.42	0.42	0.35											
			Sones	12.9	12.7	12.3	11.9	11.4	10.4	8.8											
	1360	CFM	2523	2433	2347	2259	2166	1943	1602												
		BHP	0.48	0.50	0.51	0.52	0.52	0.53	0.51												
		Sones	14.6	14.3	13.9	13.5	13.1	12.2	11.0												
GB-141-7	3/4	1453	CFM	2695	2612	2530	2449	2365	2173	1914	1513										
			BHP	0.59	0.60	0.62	0.63	0.64	0.64	0.64	0.60										
			Sones	16.2	15.9	15.6	15.3	14.8	13.9	13.0	11.8										
	1545	CFM	2866	2787	2710	2634	2556	2384	2177	1890											
		BHP	0.71	0.72	0.74	0.75	0.76	0.77	0.78	0.75											
		Sones	17.6	18.0	17.4	17.1	16.8	14.9	14.7	14.7											
GB-141-10	1	1705	CFM	3163	3091	3020	2952	2883	2739	2574	2370	2120	1731								
			BHP	0.95	0.97	0.98	1.00	1.02	1.03	1.03	1.05	1.02	0.96								
			Sones	20	20	20	19.6	19.2	18.1	16.9	16.7	16.6	16.4								

MAXIMUM BHP AT A GIVEN RPM = (RPM/1676)³
 MAXIMUM RPM = 1705
 TIP SPEED (ft/min.) = RPM x 3.829
 MAXIMUM MOTOR FRAME SIZE = 145T

Performance shown is for installation type A: Free inlet, Free outlet. Power rating (BHP) does not include transmission losses. Performance ratings include the effects of a birdscreen in the airstream. The sound ratings shown are loudness values in fan sones at 5 ft. (1.5 m) in a hemispherical free field calculated per AMCA Standard 301. Values shown are for installation type A: Free inlet fan sone levels.

GB-141HP - Belt Drive

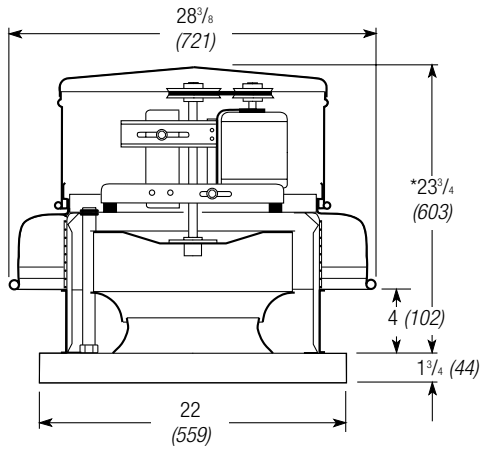

Damper Size = 16 x 16 (406 x 406)
 Roof Opening = 18 1/2 x 18 1/2 (470 x 470)
 Shroud Thickness = 0.051 (1.3)
 Motor Cover Thickness = 0.040 (1.0)
 Curb Cap Thickness = 0.064 (1.6)
 ^Approximate Unit Weight = 83 lb. (38 kg)

All dimensions in inches (millimeters).
 *May be greater depending on motor.
 ^Weight shown is largest cataloged Open Drip Proof motor.

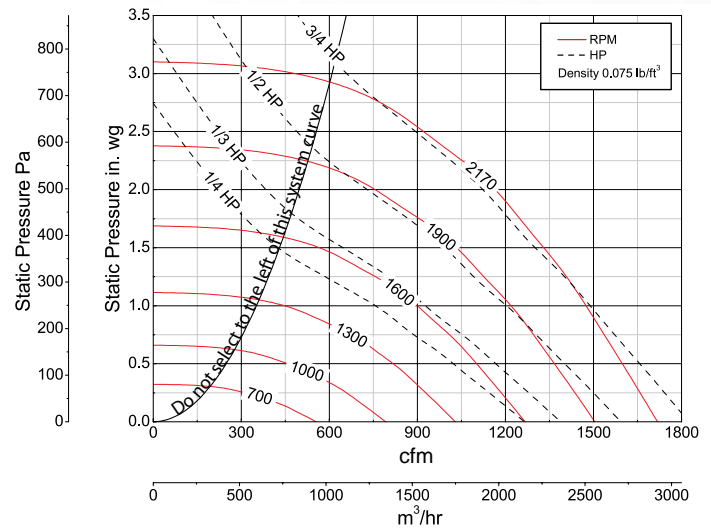

Model Number	HP (Size)	Fan RPM	Static Pressure in Inches wg																			
			0.5	0.75	1	1.25	1.5	1.75	2	2.25	2.5	2.75										
GB-141HP-4	1/4	905	CFM	270																		
			BHP	0.05																		
			Sones	5.5																		
		1054		CFM	537																	
				BHP	0.09																	
				Sones	6.7																	
		1203		CFM	714	527																
				BHP	0.13	0.13																
				Sones	8.4	8.3																
		1352		CFM	870	740	547															
				BHP	0.18	0.19	0.19															
				Sones	10.9	10.3	10.4															
	1500		CFM	1009	903	774	592															
			BHP	0.24	0.26	0.26	0.25															
			Sones	13.1	12.3	12.2	12.4															
GB-141HP-3	1/3	1655	CFM	1151	1064	959	833	668														
			BHP	0.32	0.34	0.35	0.35	0.34														
			Sones	15.0	14.1	13.3	13.1	13.6														
GB-141HP-5	1/2	1737	CFM	1224	1143	1048	946	802	619													
			BHP	0.37	0.38	0.40	0.40	0.40	0.38													
			Sones	16.4	15.6	14.9	14.4	14.4	15.0													
		1818		CFM	1295	1218	1133	1037	920	773	561											
				BHP	0.42	0.44	0.45	0.46	0.46	0.45	0.42											
				Sones	17.9	17.3	16.8	15.9	15.7	16.0	16.7											
	1900		CFM	1366	1294	1218	1127	1033	901	753												
			BHP	0.47	0.49	0.51	0.53	0.53	0.52	0.51												
			Sones	19.0	18.4	18.0	17.4	16.8	16.7	17.0												
GB-141HP-7	3/4	2035	CFM	1483	1417	1347	1269	1184	1095	969	832	633										
			BHP	0.57	0.60	0.62	0.63	0.65	0.65	0.64	0.63	0.59										
			Sones	21	20	19.6	19.1	18.6	18.4	18.1	18.2	18.5										
		2170		CFM	1598	1536	1472	1407	1328	1248	1163	1045	919	757								
				BHP	0.68	0.71	0.73	0.76	0.77	0.78	0.79	0.78	0.77	0.74								
				Sones	22	22	21	21	21	21	21	21	20	19.7	19.8							

MAXIMUM BHP AT A GIVEN RPM = (RPM/2351)³
 MAXIMUM RPM = 2170
 TIP SPEED (ft/min.) = RPM x 3.829
 MAXIMUM MOTOR FRAME SIZE = 145T

Performance shown is for installation type A: Free inlet, Free outlet. Power rating (BHP) does not include transmission losses. Performance ratings include the effects of a birdscreen in the airstream. The sound ratings shown are loudness values in fan sones at 5 ft. (1.5 m) in a hemispherical free field calculated per AMCA Standard 301. Values shown are for installation type A: Free inlet fan sone levels.

GB-161 - Belt Drive

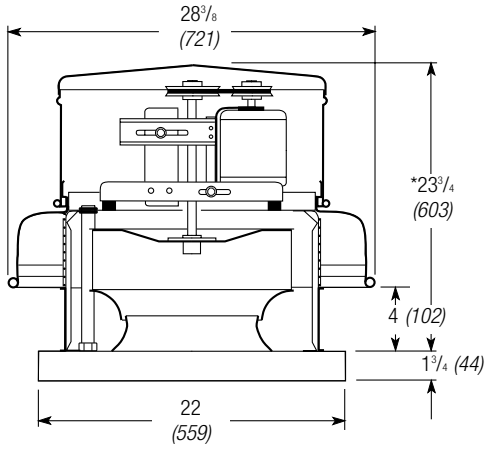

Damper Size = 16 x 16 (406 x 406)
 Roof Opening = 18 1/2 x 18 1/2 (470 x 470)
 Shroud Thickness = 0.051 (1.3)
 Motor Cover Thickness = 0.040 (1.0)
 Curb Cap Thickness = 0.064 (1.6)
 ^Approximate Unit Weight = 89 lb. (40 kg)

All dimensions in inches (millimeters).
 *May be greater depending on motor.
 ^Weight shown is largest cataloged Open Drip Proof motor.

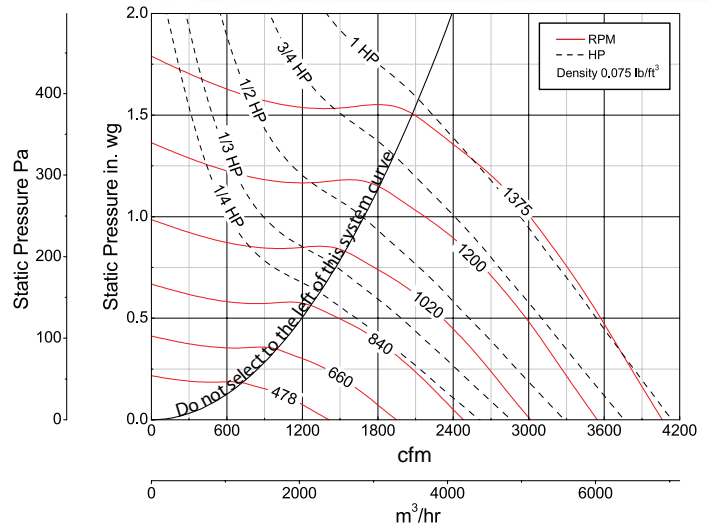

Model Number	HP (Size)	Fan RPM	Static Pressure in Inches wg																	
			0	0.125	0.25	0.375	0.5	0.75	0.875	1	1.25	1.5								
GB-161-4	1/4	478	CFM	1412	1030															
			BHP	0.40	0.04															
			Sones	4.7	4.5															
		575	CFM	1698	1399	937														
				BHP	0.07	0.08	0.07													
				Sones	5.7	5.6	5.3													
		670	CFM	1979	1727	1429														
				BHP	0.11	0.12	0.12													
				Sones	7.0	6.7	6.5													
		765	CFM	2260	2040	1802	1494													
				BHP	0.16	0.17	0.18	0.18												
				Sones	8.6	8.2	8.0	7.5												
	865	CFM	2555	2360	2162	1933	1624													
			BHP	0.24	0.25	0.26	0.26	0.25												
			Sones	10.6	10.1	9.7	9.4	8.8												
GB-161-3	1/3	945	CFM	2791	2612	2434	2236	2010												
			BHP	0.31	0.32	0.33	0.34	0.34												
			Sones	12.6	12.0	11.5	11.2	10.7												
GB-161-5	1/2	1023	CFM	3022	2856	2693	2520	2327	1785											
			BHP	0.39	0.41	0.42	0.43	0.43	0.40											
			Sones	14.0	13.4	12.8	12.5	12.1	11.0											
		1100	CFM	3249	3095	2943	2787	2615	2198	1900										
				BHP	0.49	0.50	0.52	0.53	0.53	0.52	0.50									
				Sones	15.3	14.7	14.1	13.8	13.5	12.5	12.0									
GB-161-7	3/4	1175	CFM	3471	3326	3184	3040	2888	2541	2313	2025									
			BHP	0.59	0.61	0.62	0.64	0.65	0.65	0.64	0.61									
			Sones	16.5	16.0	15.5	15.1	14.8	14.0	13.6	13.0									
		1250	CFM	3692	3557	3422	3289	3149	2838	2658	2444									
				BHP	0.71	0.73	0.75	0.76	0.77	0.79	0.78	0.76								
				Sones	17.9	17.4	17.0	16.6	16.3	15.6	15.2	14.9								
GB-161-10	1	1375	CFM	4062	3938	3815	3694	3571	3304	3161	3007	2609	2073							
			BHP	0.95	0.97	0.99	1.01	1.02	1.04	1.05	1.04	1.01	0.93							
			Sones	21	20	19.6	19.2	18.9	18.4	18.0	17.6	17.2	15.4							

MAXIMUM BHP AT A GIVEN RPM = (RPM/1355)³
 MAXIMUM RPM = 1375
 TIP SPEED (ft/min.) = RPM x 4.352
 MAXIMUM MOTOR FRAME SIZE = 145T

Performance shown is for installation type A: Free inlet, Free outlet. Power rating (BHP) does not include transmission losses. Performance ratings include the effects of a birdscreen in the airstream. The sound ratings shown are loudness values in fan sones at 5 ft. (1.5 m) in a hemispherical free field calculated per AMCA Standard 301. Values shown are for installation type A: Free inlet fan sone levels.

GB-161HP - Belt Drive

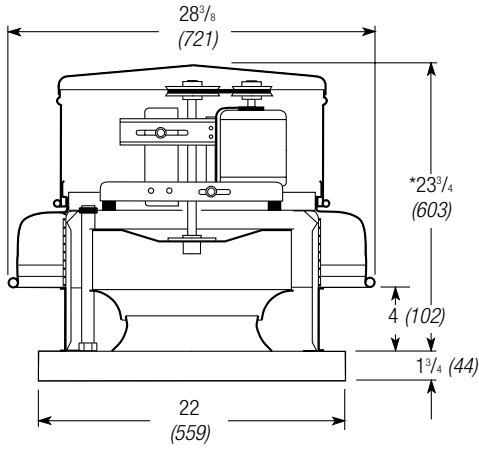

Damper Size = 16 x 16 (406 x 406)
 Roof Opening = 18 1/2 x 18 1/2 (470 x 470)
 Shroud Thickness = 0.051 (1.3)
 Motor Cover Thickness = 0.040 (1.0)
 Curb Cap Thickness = 0.064 (1.6)
 ^Approximate Unit Weight = 89 lb. (40 kg)

All dimensions in inches (millimeters).
 *May be greater depending on motor.
 ^Weight shown is largest cataloged Open Drip Proof motor.

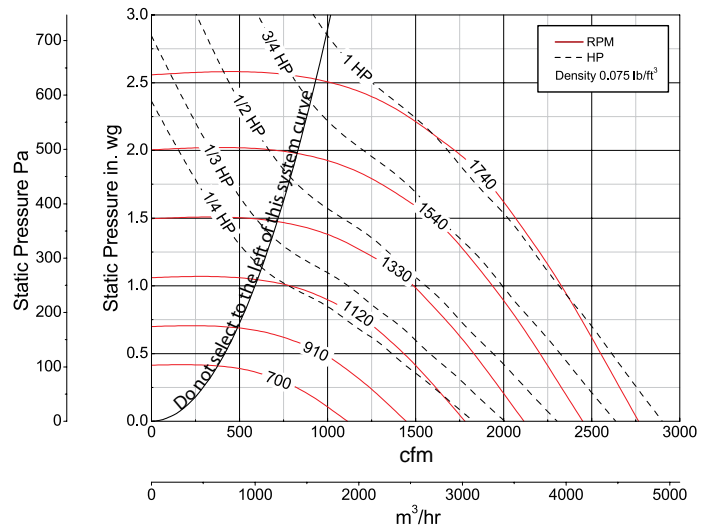

Model Number	HP (Size)	Fan RPM	Static Pressure in Inches wg																		
			0.5	0.625	0.75	1	1.25	1.5	1.75	2	2.25	2.5									
GB-161HP-4	1/4	825	CFM	702																	
			BHP	0.11																	
			Sones	6.5																	
		960	CFM	1093	919	585															
			BHP	0.18	0.17	0.15															
			Sones	7.7	7.6	8.0															
1095	CFM	1380	1271	1139	589																
	BHP	0.26	0.26	0.26	0.21																
	Sones	9.0	9.0	8.9	9.5																
GB-161HP-3	1/3	1210	CFM	1606	1514	1416	1149														
			BHP	0.34	0.35	0.35	0.34														
			Sones	10.6	10.3	10.4	10.3														
GB-161HP-5	1/2	1270	CFM	1718	1636	1545	1333	949													
			BHP	0.39	0.40	0.40	0.41	0.37													
			Sones	11.4	11.2	11.1	11.1	11.4													
		1330	CFM	1829	1753	1668	1483	1204													
			BHP	0.44	0.45	0.46	0.47	0.45													
			Sones	12.3	12.1	11.9	12.1	12.0													
1390	CFM	1938	1865	1789	1619	1399	1032														
	BHP	0.50	0.51	0.52	0.53	0.53	0.48														
	Sones	13.3	13.0	12.8	12.7	12.7	13.1														
GB-161HP-7	3/4	1485	CFM	2109	2041	1973	1822	1654	1416	1012											
			BHP	0.60	0.61	0.63	0.64	0.65	0.63	0.57											
			Sones	14.9	14.7	14.4	13.8	13.7	14.0	14.7											
		1580	CFM	2275	2214	2150	2016	1868	1704	1447	1034										
			BHP	0.72	0.73	0.75	0.77	0.77	0.791	0.75	0.67										
			Sones	16.7	16.7	16.4	15.5	14.7	14.8	15.4	16.6										
GB-161HP-10	1	1660	CFM	2414	2357	2297	2175	2037	1887	1702	1441	996									
			BHP	0.82	0.84	0.85	0.89	0.89	0.91	0.90	0.86	0.75									
			Sones	18.3	18.8	18.3	16.7	16.2	15.8	15.8	17.1	20									
		1740	CFM	2551	2497	2442	2325	2200	2066	1917	1714	1452	987								
			BHP	0.94	0.96	0.97	1.01	1.03	1.03	1.05	1.03	0.98	0.85								
			Sones	20	21	21	18.4	17.5	17.2	16.8	17.2	19.2	28								

MAXIMUM BHP AT A GIVEN RPM = (RPM/1708)³
 MAXIMUM RPM = 1740
 TIP SPEED (ft/min.) = RPM x 4.352
 MAXIMUM MOTOR FRAME SIZE = 145T

Performance shown is for installation type A: Free inlet, Free outlet. Power rating (BHP) does not include transmission losses. Performance ratings include the effects of a birdscreen in the airstream. The sound ratings shown are loudness values in fan sones at 5 ft. (1.5 m) in a hemispherical free field calculated per AMCA Standard 301. Values shown are for installation type A: Free inlet fan sone levels.

GB-180 - Belt Drive

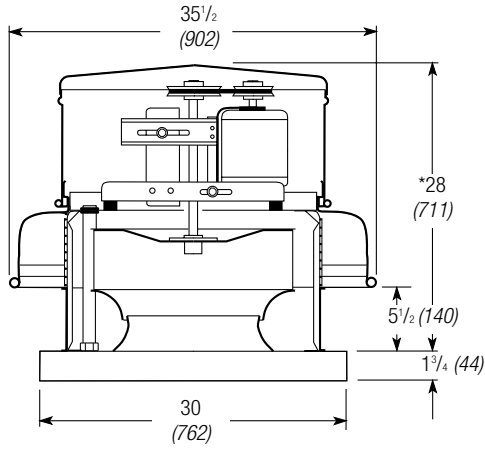

Damper Size = 18 x 18 (457 x 457)
 Roof Opening = 20 1/2 x 20 1/2 (521 x 521)
 Shroud Thickness = 0.064 (1.6)
 Motor Cover Thickness = 0.040 (1.0)
 Curb Cap Thickness = 0.064 (1.6)
 ^Approximate Unit Weight = 125 lb. (57 kg)

All dimensions in inches (millimeters).
 *May be greater depending on motor.
 ^Weight shown is largest cataloged Open Drip Proof motor.

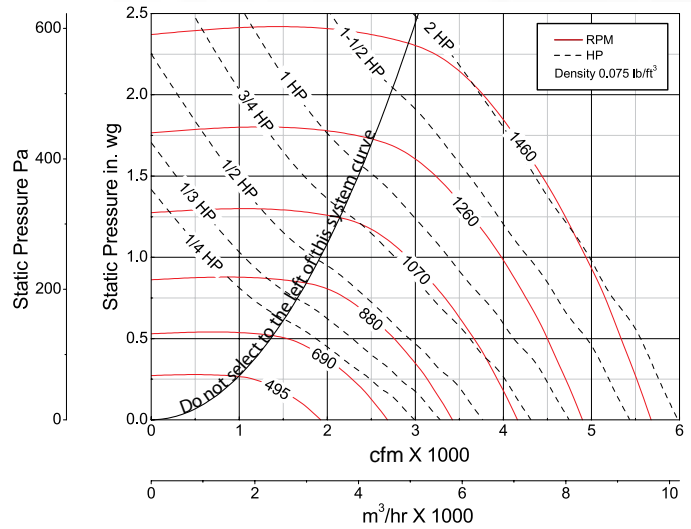

Model Number	HP (Size)	Fan RPM	Static Pressure in Inches wg															
			0	0.125	0.25	0.5	0.75	1	1.25	1.5	1.75	2						
GB-180-4	1/4	495	CFM	1925	1646	1150												
			BHP	0.07	0.08	0.08												
			Sones	4.3	4.7	4.1												
			730	CFM	2839	2668	2469	1882										
			BHP	0.21	0.23	0.27	0.25											
GB-180-3	1/3	810	CFM	3150	2997	2832	2375											
			BHP	0.29	0.31	0.33	0.35											
			Sones	8.8	9.9	8.7	8.2											
			GB-180-5	1/2	875	CFM	3402	3263	3113	2728	2144							
						BHP	0.37	0.38	0.41	0.44	0.43							
Sones	10.5	11.1				10.2	9.4	8.5										
GB-180-7	3/4	1055				CFM	4102	3990	3867	3596	3252	2811						
						BHP	0.65	0.67	0.68	0.74	0.77	0.77						
			Sones	16.2	15.7	14.9	14.0	12.9	12.4									
			GB-180-10	1	1120	CFM	4355	4249	4134	3891	3587	3217	2686					
						BHP	0.77	0.79	0.81	0.88	0.92	0.93	0.89					
Sones	17.5	16.9				16.4	15.5	14.5	13.8	13.0								
GB-180-15	1 1/2	1260				CFM	4899	4805	4706	4498	4256	3977	3641	3223				
						BHP	1.10	1.12	1.15	1.21	1.27	1.32	1.32	1.29				
			Sones	21	19.9	19.3	18.8	18.0	17.3	16.8	16.1							
			GB-180-20	2	1460	CFM	5191	5102	5010	4814	4599	4344	4052	3713	3262			
						BHP	1.31	1.33	1.36	1.41	1.49	1.54	1.57	1.56	1.51			
Sones	22	22				21	21	19.9	19.2	18.7	18.2	17.6						
GB-180-20	2	1460				CFM	5677	5596	5514	5336	5155	4938	4699	4426	4123	3765		
						BHP	1.71	1.74	1.77	1.81	1.93	1.97	2.03	2.05	2.05	2.02		
			Sones	26	25	24	24	23	23	22	22	22	21					

MAXIMUM BHP AT A GIVEN RPM = (RPM/1149)³
 MAXIMUM RPM = 1460
 TIP SPEED (ft/min.) = RPM x 4.843
 MAXIMUM MOTOR FRAME SIZE = 184T

Performance shown is for installation type A: Free inlet, Free outlet. Power rating (BHP) does not include transmission losses. Performance ratings include the effects of a birdscreen in the airstream. The sound ratings shown are loudness values in fan sones at 5 ft. (1.5 m) in a hemispherical free field calculated per AMCA Standard 301. Values shown are for installation type A: Free inlet fan sone levels.

GB-180HP - Belt Drive

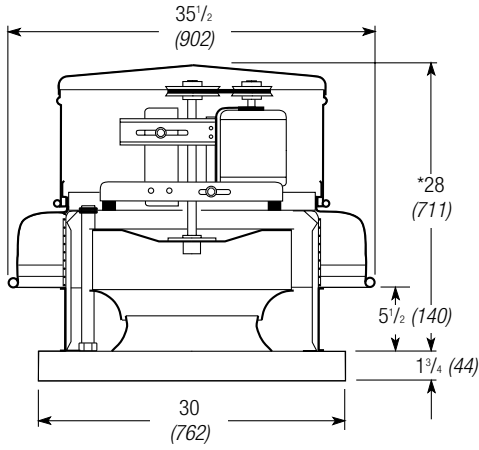

Damper Size = 18 x 18 (457 x 457)
 Roof Opening = 20 1/2 x 20 1/2 (521 x 521)
 Shroud Thickness = 0.064 (1.6)
 Motor Cover Thickness = 0.040 (1.0)
 Curb Cap Thickness = 0.064 (1.6)
 ^Approximate Unit Weight = 125 lb. (57 kg)

All dimensions in inches (millimeters).
 *May be greater depending on motor.
 ^Weight shown is largest cataloged Open Drip Proof motor.

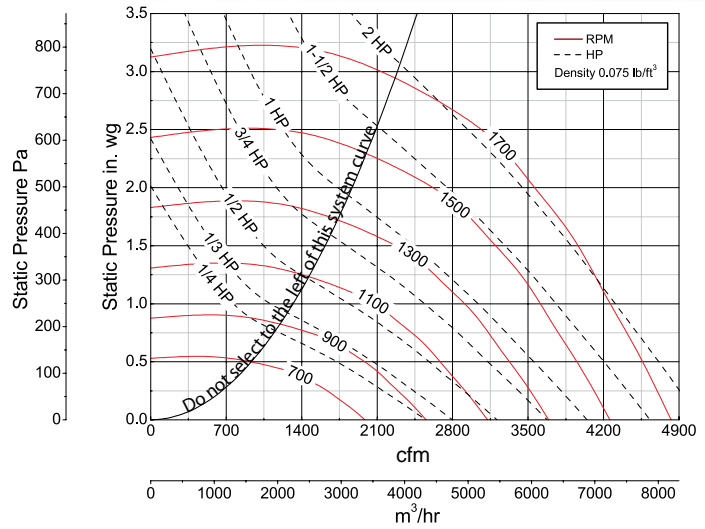

Model Number	HP (Size)	Fan RPM	Static Pressure in Inches wg														
			0.5	0.75	1	1.25	1.5	1.75	2	2.25	2.5	2.75					
GB-180HP-4	1/4	795	CFM	1547													
			BHP	0.22													
			Sones	8.6													
		845	CFM	1759													
			BHP	0.26													
			Sones	9.1													
GB-180HP-3	1/3	935	CFM	2114	1686												
			BHP	0.35	0.35												
			Sones	10.3	9.6												
GB-180HP-5	1/2	1075	CFM	2601	2316	1920											
			BHP	0.51	0.53	0.52											
			Sones	12.9	12.1	11.6											
GB-180HP-7	3/4	1150	CFM	2847	2607	2298	1811										
			BHP	0.61	0.64	0.65	0.62										
			Sones	14.6	13.1	12.6	12.3										
		1225	CFM	3088	2880	2610	2277	1711									
			BHP	0.73	0.77	0.78	0.78	0.72									
			Sones	16.3	14.7	13.9	13.3	13.2									
GB-180HP-10	1	1350	CFM	3485	3296	3095	2840	2540	2059								
			BHP	0.96	1.00	1.04	1.05	1.05	0.99								
			Sones	19.5	17.6	16.4	15.8	15.0	15.1								
GB-180HP-15	1 1/2	1445	CFM	3782	3604	3428	3213	2969	2670	2216							
			BHP	1.16	1.21	1.25	1.28	1.29	1.28	1.21							
			Sones	22	20	18.8	17.8	17.3	16.4	16.6							
		1540	CFM	4076	3909	3744	3576	3353	3119	2827	2407						
			BHP	1.39	1.44	1.49	1.53	1.55	1.56	1.55	1.48						
			Sones	25	22	21	20	19.6	18.9	18.1	18.3						
GB-180HP-20	2	1620	CFM	4319	4163	4005	3848	3663	3450	3223	2923	2512					
			BHP	1.60	1.66	1.71	1.76	1.79	1.81	1.82	1.80	1.72					
			Sones	27	25	24	23	22	21	20	19.7	19.8					
		1700	CFM	4560	4414	4263	4114	3964	3764	3560	3340	3037	2642				
			BHP	1.84	1.90	1.96	2.01	2.06	2.08	2.10	2.11	2.07	1.99				
			Sones	30	27	26	25	24	23	22	22	21	21				

MAXIMUM BHP AT A GIVEN RPM = (RPM/1325)³
 MAXIMUM RPM = 1700
 TIP SPEED (ft/min.) = RPM x 4.843
 MAXIMUM MOTOR FRAME SIZE = 184T

Performance shown is for installation type A: Free inlet, Free outlet. Power rating (BHP) does not include transmission losses. Performance ratings include the effects of a birdscreen in the airstream. The sound ratings shown are loudness values in fan sones at 5 ft. (1.5 m) in a hemispherical free field calculated per AMCA Standard 301. Values shown are for installation type A: Free inlet fan sone levels.

GB-200 - Belt Drive

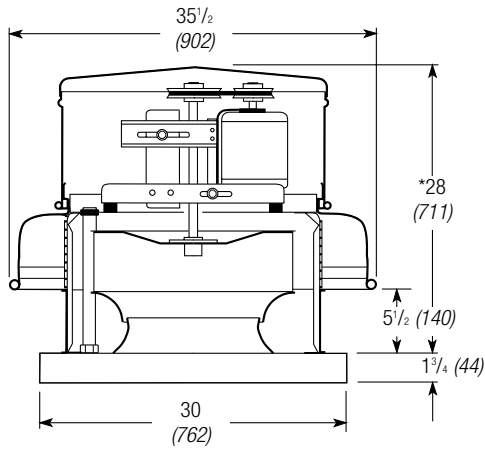

Damper Size = 18 x 18 (457 x 457)
 Roof Opening = 20 1/2 x 20 1/2 (521 x 521)
 Shroud Thickness = 0.064 (1.6)
 Motor Cover Thickness = 0.040 (1.0)
 Curb Cap Thickness = 0.064 (1.6)
 ^Approximate Unit Weight = 138 lb. (63 kg)

All dimensions in inches (millimeters).
 *May be greater depending on motor.
 ^Weight shown is largest cataloged Open Drip Proof motor.

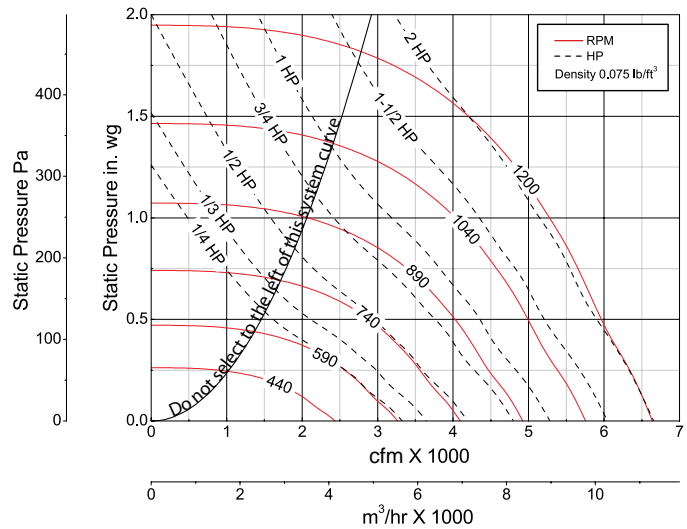

Model Number	HP (Size)	Fan RPM	Static Pressure in Inches wg													
			0	0.125	0.25	0.375	0.5	0.75	1	1.25	1.5	1.75				
GB-200-4	1/4	440	CFM	2435	1976											
			BHP	0.10	0.10											
			Sones	6.5	5.8											
				600	CFM	3320	2984	2637	2089							
			BHP	0.25	0.26	0.26	0.25									
			Sones	8.5	7.9	7.3	6.1									
GB-200-3	1/3	665	CFM	3680	3378	3085	2706	2087								
			BHP	0.34	0.34	0.36	0.35	0.33								
			Sones	9.6	9.0	8.5	7.7	6.7								
GB-200-5	1/2	718	CFM	3973	3700	3422	3109	2684								
			BHP	0.43	0.43	0.45	0.45	0.44								
			Sones	10.8	10.0	9.6	9.0	8.3								
				770	CFM	4261	4013	3744	3477	3141						
			BHP	0.53	0.53	0.55	0.55	0.55								
			Sones	12.1	11.0	10.7	10.2	9.8								
GB-200-7	3/4	860	CFM	4759	4548	4289	4068	3811	3085							
			BHP	0.73	0.74	0.75	0.77	0.74								
			Sones	14.1	13.3	12.9	12.4	11.8	11.1							
GB-200-10	1	965	CFM	5340	5158	4927	4720	4520	4015	3240						
			BHP	1.03	1.04	1.05	1.08	1.09	1.08	1.02						
			Sones	16.7	16.0	15.4	15.0	14.5	13.7	13.0						
GB-200-15	1 1/2	1028	CFM	5689	5517	5309	5101	4918	4488	3911	2941					
			BHP	1.25	1.26	1.27	1.29	1.31	1.32	1.29	1.14					
			Sones	18.5	17.8	17.2	16.8	16.4	15.6	14.7	14.6					
		1090	CFM	6032	5870	5682	5473	5301	4925	4450	3751					
			BHP	1.49	1.50	1.51	1.52	1.56	1.56	1.56	1.48					
			Sones	20	19.6	18.9	18.4	18.1	17.5	16.8	15.8					
GB-200-20	2	1145	CFM	6336	6182	6010	5809	5637	5299	4870	4333	3517				
			BHP	1.73	1.74	1.75	1.76	1.79	1.81	1.82	1.77	1.64				
			Sones	22	21	21	20	19.8	19.2	18.7	17.7	16.6				
		1200	CFM	6640	6494	6336	6145	5969	5651	5274	4829	4177	3077			
			BHP	1.99	2.00	2.01	2.02	2.04	2.09	2.09	2.08	1.96	1.69			
			Sones	24	23	23	22	22	21	21	19.9	18.6	16.7			

MAXIMUM BHP AT A GIVEN RPM = (RPM/938)³
 MAXIMUM RPM = 1200
 TIP SPEED (ft/min.) = RPM x 5.596
 MAXIMUM MOTOR FRAME SIZE = 184T

Performance shown is for installation type A: Free inlet, Free outlet. Power rating (BHP) does not include transmission losses. Performance ratings include the effects of a birdscreen in the airstream. The sound ratings shown are loudness values in fan sones at 5 ft. (1.5 m) in a hemispherical free field calculated per AMCA Standard 301. Values shown are for installation type A: Free inlet fan sone levels.

GB-200HP - Belt Drive

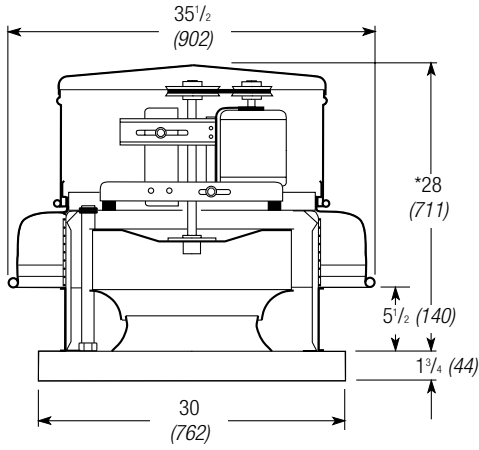

Damper Size = 18 x 18 (457 x 457)
 Roof Opening = 20 1/2 x 20 1/2 (521 x 521)
 Shroud Thickness = 0.064 (1.6)
 Motor Cover Thickness = 0.040 (1.0)
 Curb Cap Thickness = 0.064 (1.6)
 ^Approximate Unit Weight = 138 lb. (63 kg)

All dimensions in inches (millimeters).
 *May be greater depending on motor.
 ^Weight shown is largest cataloged Open Drip Proof motor.

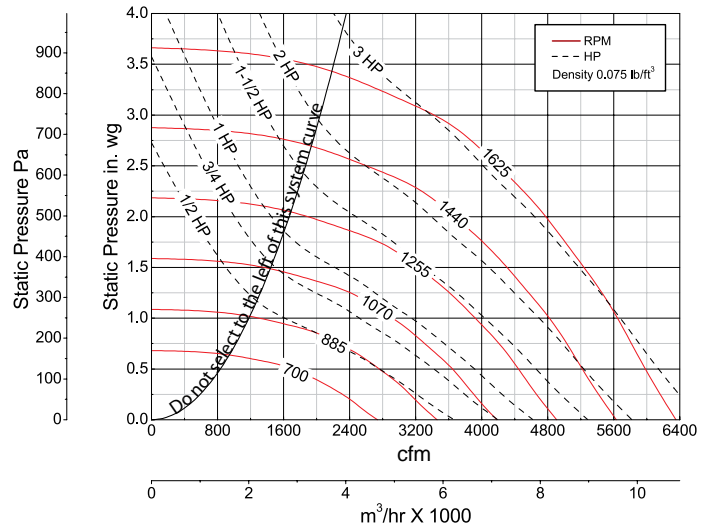

Model Number	HP (Size)	Fan RPM	Static Pressure in Inches wg																			
			0.5	0.75	1	1.25	1.5	2	2.5	2.75	3	3.25										
GB-200HP-5	1/2	740	CFM	1961																		
			BHP	0.30																		
			Sones	8.7																		
			895	CFM	2809	2331	1424															
GB-200HP-7	3/4	958	CFM	3116	2715	2153																
			BHP	0.63	0.65	0.63																
			Sones	12.8	12.1	11.6																
			1020	CFM	3409	3050	2602	1857														
GB-200HP-10	1	1125	CFM	3885	3584	3243	2804	2136														
			BHP	0.99	1.02	1.04	1.04	0.97														
			Sones	16.9	16.4	15.5	15.3	15.2														
			1205	CFM	4229	3967	3663	3314	2884													
GB-200HP-15	1 1/2	1205	CFM	4229	3967	3663	3314	2884														
			BHP	1.19	1.24	1.27	1.29	1.27														
			Sones	18.8	17.9	17.2	16.5	16.4														
			1285	CFM	4569	4343	4070	3770	3416	2278												
GB-200HP-20	2	1350	CFM	4843	4638	4384	4109	3811	2996													
			BHP	1.65	1.71	1.75	1.78	1.81	1.76													
			Sones	23	22	21	19.8	19.3	19.1													
			1415	CFM	5114	4919	4692	4442	4169	3492	2250											
GB-200HP-30	3	1520	CFM	5550	5368	5182	4952	4713	4166	3458	2850	2046										
			BHP	2.31	2.38	2.45	2.50	2.53	2.58	2.53	2.38	2.06										
			Sones	27	27	27	26	24	23	22	22	22	22									
			1625	CFM	5982	5812	5642	5448	5233	4767	4196	3859	3377	2725								
			BHP	2.80	2.88	2.95	3.02	3.06	3.13	3.16	3.12	3.01	2.76									
			Sones	32	31	31	29	28	27	25	24	23	22									

MAXIMUM BHP AT A GIVEN RPM = (RPM/1106)³
 MAXIMUM RPM = 1625
 TIP SPEED (ft/min.) = RPM x 5.596
 MAXIMUM MOTOR FRAME SIZE = 184T

Performance shown is for installation type A: Free inlet, Free outlet. Power rating (BHP) does not include transmission losses. Performance ratings include the effects of a birdscreen in the airstream. The sound ratings shown are loudness values in fan sones at 5 ft. (1.5 m) in a hemispherical free field calculated per AMCA Standard 301. Values shown are for installation type A: Free inlet fan sone levels.

GB-220 - Belt Drive

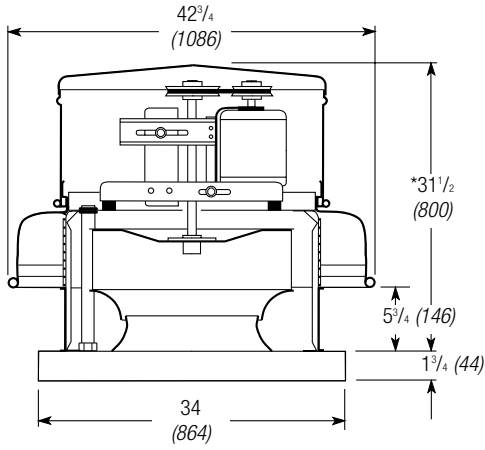

Damper Size = 24 x 24 (610 x 610)
 Roof Opening = 26 1/2 x 26 1/2 (673 x 673)
 Shroud Thickness = 0.064 (1.6)
 Motor Cover Thickness = 0.040 (1.0)
 Curb Cap Thickness = 0.064 (1.6)
 ^Approximate Unit Weight = 158 lb. (72 kg)

All dimensions in inches (millimeters).
 *May be greater depending on motor.
 ^Weight shown is largest cataloged Open Drip Proof motor.

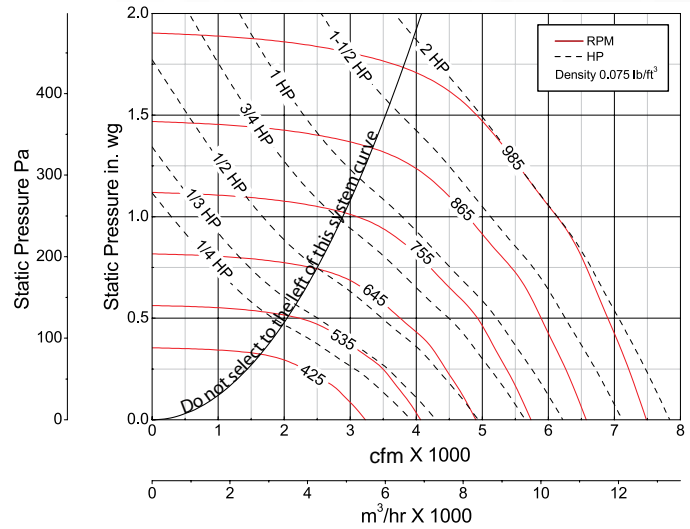

Model Number	HP (Size)	Fan RPM	Static Pressure in Inches wg												
			0	0.125	0.25	0.375	0.5	0.625	0.75	1	1.25	1.5			
GB-220-4	1/4	425	CFM	3230	2879	2296									
			BHP	0.14	0.16	0.16									
			Sones	7.4	7.2	6.9									
		465	CFM	3533	3219	2758	1951								
			BHP	0.18	0.20	0.21	0.19								
			Sones	8.1	7.8	7.4	7.0								
500	CFM	3799	3512	3132	2542										
	BHP	0.23	0.25	0.26	0.26										
	Sones	8.8	8.4	7.9	7.5										
GB-220-3	1/3	550	CFM	4179	3924	3629	3158	2526							
			BHP	0.30	0.32	0.34	0.35	0.33							
			Sones	10.0	9.6	8.9	8.4	8.0							
GB-220-5	1/2	640	CFM	4863	4654	4403	4120	3702	3208						
			BHP	0.48	0.50	0.53	0.54	0.55	0.54						
			Sones	13.0	12.8	12.1	11.2	10.5	9.7						
GB-220-7	3/4	710	CFM	5395	5206	4990	4762	4459	4077	3633					
			BHP	0.65	0.68	0.71	0.73	0.74	0.75	0.74					
			Sones	15.0	14.9	14.4	13.6	12.8	12.1	11.2					
GB-220-10	1	755	CFM	5737	5559	5362	5148	4920	4579	4206	3095				
			BHP	0.79	0.82	0.84	0.87	0.89	0.90	0.90	0.82				
			Sones	15.7	15.6	15.2	14.6	14.0	13.4	12.7	11.2				
		800	CFM	6079	5911	5732	5530	5326	5049	4716	3929				
			BHP	0.93	0.97	1.00	1.02	1.05	1.06	1.07	1.05				
			Sones	16.6	16.4	16.1	15.6	15.2	14.6	14.2	12.5				
GB-220-15	1 1/2	848	CFM	6444	6286	6122	5932	5741	5540	5236	4566	3542			
			BHP	1.11	1.15	1.18	1.21	1.23	1.26	1.27	1.27	1.17			
			Sones	17.8	17.5	17.2	16.9	16.5	16.2	15.7	14.5	13.4			
		895	CFM	6801	6651	6501	6323	6142	5960	5723	5122	4401			
			BHP	1.31	1.34	1.38	1.41	1.44	1.47	1.49	1.50	1.47			
			Sones	19.4	19.1	18.8	18.5	18.2	18.0	17.6	16.9	15.5			
GB-220-20	2	985	CFM	7485	7349	7212	7062	6898	6734	6568	6107	5548	4883		
			BHP	1.74	1.78	1.82	1.86	1.89	1.92	1.95	1.99	2.00	1.96		
			Sones	23	23	23	22	22	22	22	22	21	20	19.0	

MAXIMUM BHP AT A GIVEN RPM = (RPM/782)³
 MAXIMUM RPM = 985
 TIP SPEED (ft/min.) = RPM x 6.283
 MAXIMUM MOTOR FRAME SIZE = 184T

Performance shown is for installation type A: Free inlet, Free outlet. Power rating (BHP) does not include transmission losses. Performance ratings include the effects of a birdscreen in the airstream. The sound ratings shown are loudness values in fan sones at 5 ft. (1.5 m) in a hemispherical free field calculated per AMCA Standard 301. Values shown are for installation type A: Free inlet fan sone levels.

GB-220HP - Belt Drive

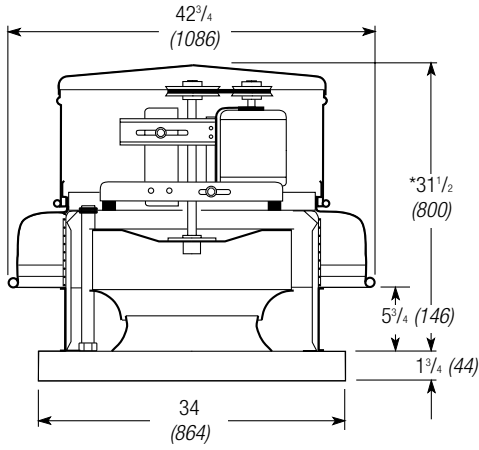

Damper Size = 24 x 24 (610 x 610)
 Roof Opening = 26 1/2 x 26 1/2 (673 x 673)
 Shroud Thickness = 0.064 (1.6)
 Motor Cover Thickness = 0.040 (1.0)
 Curb Cap Thickness = 0.064 (1.6)
 ^Approximate Unit Weight = 158 lb. (72 kg)

All dimensions in inches (millimeters).
 *May be greater depending on motor.
 ^Weight shown is largest cataloged Open Drip Proof motor.

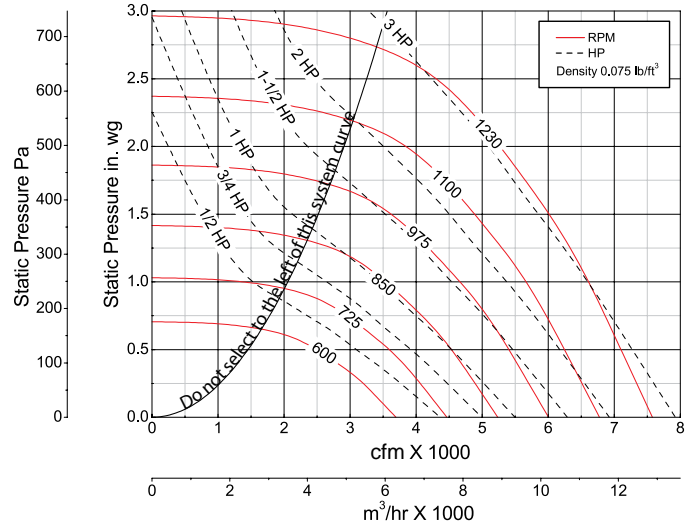

Model Number	HP (Size)	Fan RPM	Static Pressure in Inches wg																	
			0.5	0.625	0.75	1	1.25	1.5	1.75	2	2.25	2.5								
GB-220HP-5	1/2	650	CFM	2952	2555	1892														
			BHP	0.47	0.46	0.42														
			Sones	8.9	8.5	8.3														
	680	CFM	3215	2871	2440															
		BHP	0.53	0.53	0.52															
		Sones	9.4	9.2	8.9															
GB-220HP-7	3/4	728	CFM	3614	3312	2974														
			BHP	0.65	0.65	0.65														
			Sones	10.6	10.3	9.9														
	775	CFM	3973	3719	3424	2643														
		BHP	0.77	0.79	0.79	0.75														
		Sones	12.0	11.5	11.1	10.5														
GB-220HP-10	1	850	CFM	4532	4317	4083	3536	2648												
			BHP	1.00	1.02	1.04	1.03	0.95												
			Sones	15.0	13.8	13.5	12.7	12.0												
GB-220HP-15	1 1/2	913	CFM	4975	4791	4590	4119	3545	2557											
			BHP	1.22	1.25	1.27	1.29	1.27	1.13											
			Sones	16.7	16.0	15.3	14.4	13.5	13.0											
	975	CFM	5400	5245	5060	4660	4185	3602												
		BHP	1.46	1.50	1.53	1.57	1.56	1.53												
		Sones	18.7	18.2	17.5	16.3	15.4	14.8												
GB-220HP-20	2	1025	CFM	5740	5591	5432	5075	4643	4157	3492										
			BHP	1.68	1.72	1.76	1.81	1.82	1.804	1.74										
			Sones	21	20	19.4	18.2	17.1	16.4	15.6										
	1075	CFM	6076	5935	5794	5459	5082	4649	4136	3346										
		BHP	1.93	1.97	2.01	2.06	2.10	2.10	2.07	1.93										
		Sones	23	22	21	20	18.7	18.3	17.7	16.4										
GB-220HP-30	3	1127	CFM	6422	6289	6154	5852	5520	5124	4703	4173	3299								
			BHP	2.20	2.24	2.29	2.36	2.41	2.42	2.41	2.37	2.17								
			Sones	24	24	23	22	21	20	19.3	18.6	17.7								
	1230	CFM	7100	6981	6858	6611	6316	6009	5649	5263	4812	4265								
		BHP	2.82	2.87	2.92	3.01	3.08	3.14	3.15	3.14	3.10	3.02								
		Sones	28	27	27	27	25	25	23	22	22	22								

MAXIMUM BHP AT A GIVEN RPM = (RPM/838)³
 MAXIMUM RPM = 1230
 TIP SPEED (ft/min.) = RPM x 6.414
 MAXIMUM MOTOR FRAME SIZE = 184T

Performance shown is for installation type A: Free inlet, Free outlet. Power rating (BHP) does not include transmission losses. Performance ratings include the effects of a birdscreen in the airstream. The sound ratings shown are loudness values in fan sones at 5 ft. (1.5 m) in a hemispherical free field calculated per AMCA Standard 301. Values shown are for installation type A: Free inlet fan sone levels.

GB-240 - Belt Drive

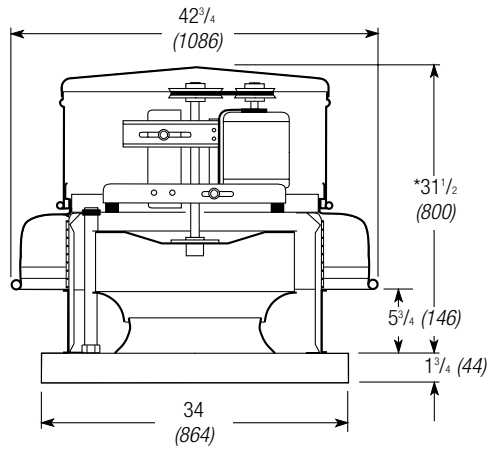

Damper Size = 24 x 24 (610 x 610)
 Roof Opening = 26 1/2 x 26 1/2 (673 x 673)
 Shroud Thickness = 0.064 (1.6)
 Motor Cover Thickness = 0.040 (1.0)
 Curb Cap Thickness = 0.064 (1.6)
 ^Approximate Unit Weight = 158 lb. (72 kg)

All dimensions in inches (millimeters).
 *May be greater depending on motor.
 ^Weight shown is largest cataloged Open Drip Proof motor.

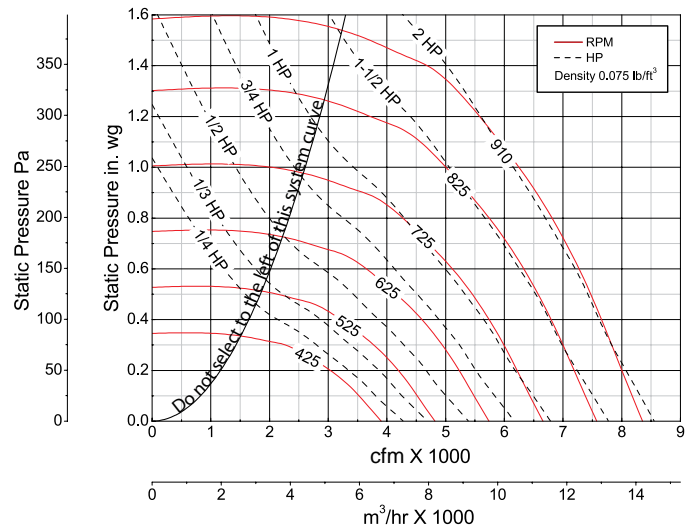

Model Number	HP (Size)	Fan RPM	Static Pressure in Inches wg											
			0	0.125	0.25	0.375	0.5	0.625	0.75	1	1.25	1.5		
GB-240-4	1/4	425	CFM	3902	3422	2691								
			BHP	0.19	0.21	0.20								
			Sones	5.9	5.9	4.7								
		460	CFM	4223	3785	3188	2036							
			BHP	0.24	0.26	0.27	0.22							
GB-240-3	1/3	505	CFM	4637	4242	3761	3060							
			BHP	0.32	0.35	0.35	0.34							
			Sones	7.8	7.5	6.9	6.1							
GB-240-5	1/2	585	CFM	5371	5031	4666	4195	3562	2112					
			BHP	0.50	0.53	0.54	0.55	0.53	0.41					
			Sones	10.3	9.7	9.1	8.8	8.2	7.2					
GB-240-7	3/4	623	CFM	5720	5400	5069	4660	4131	3428					
			BHP	0.60	0.64	0.65	0.66	0.65	0.61					
			Sones	11.7	11.0	10.4	10.0	9.6	9.1					
		660	CFM	6060	5757	5449	5094	4636	4073	3217				
			BHP	0.71	0.75	0.78	0.79	0.78	0.76	0.69				
GB-240-10	1	730	CFM	6702	6428	6158	5861	5507	5077	4568				
			BHP	0.96	1.01	1.05	1.05	1.06	1.06	1.03				
			Sones	15.8	15.0	14.3	13.8	13.4	13.1	12.9				
GB-240-15	1 1/2	778	CFM	7143	6886	6632	6363	6058	5700	5266	4145			
			BHP	1.16	1.21	1.26	1.27	1.28	1.29	1.28	1.18			
			Sones	17.7	16.6	15.9	15.4	15.0	14.7	14.4	13.2			
		825	CFM	7575	7332	7092	6844	6574	6261	5901	5002			
			BHP	1.39	1.44	1.49	1.51	1.52	1.54	1.53	1.48			
GB-240-20	2	870	CFM	7988	7757	7529	7300	7055	6775	6457	5680	7757		
			BHP	1.63	1.68	1.73	1.77	1.78	1.80	1.80	1.77	1.68		
			Sones	22	21	19.6	19.1	18.7	18.3	17.9	16.9	21		
		910	CFM	8355	8135	7916	7700	7467	7215	6933	6240	5388	3707	
			BHP	1.86	1.92	1.97	2.02	2.03	2.05	2.06	2.05	1.97	1.66	
			Sones	24	23	21	21	21	20	19.6	19.2	16.7	13.6	

MAXIMUM BHP AT A GIVEN RPM = (RPM/715)³
 MAXIMUM RPM = 910
 TIP SPEED (ft/min.) = RPM x 6.414
 MAXIMUM MOTOR FRAME SIZE = 184T

Performance shown is for installation type A: Free inlet, Free outlet. Power rating (BHP) does not include transmission losses. Performance ratings include the effects of a birdscreen in the airstream. The sound ratings shown are loudness values in fan sones at 5 ft. (1.5 m) in a hemispherical free field calculated per AMCA Standard 301. Values shown are for installation type A: Free inlet fan sone levels.

GB-240HP - Belt Drive

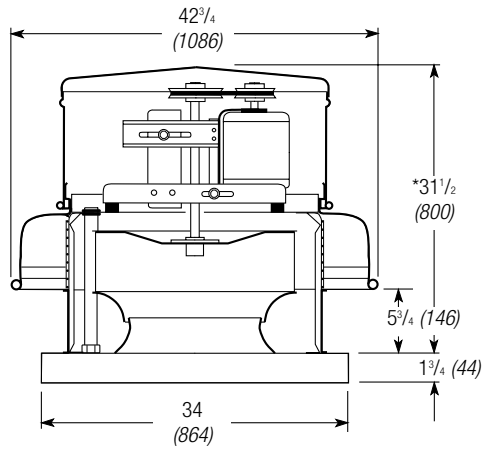

Damper Size = 24 x 24 (610 x 610)
 Roof Opening = 26 1/2 x 26 1/2 (673 x 673)
 Shroud Thickness = 0.064 (1.6)
 Motor Cover Thickness = 0.040 (1.0)
 Curb Cap Thickness = 0.064 (1.6)
 ^Approximate Unit Weight = 158 lb. (72 kg)

All dimensions in inches (millimeters).
 *May be greater depending on motor.
 ^Weight shown is largest cataloged Open Drip Proof motor.

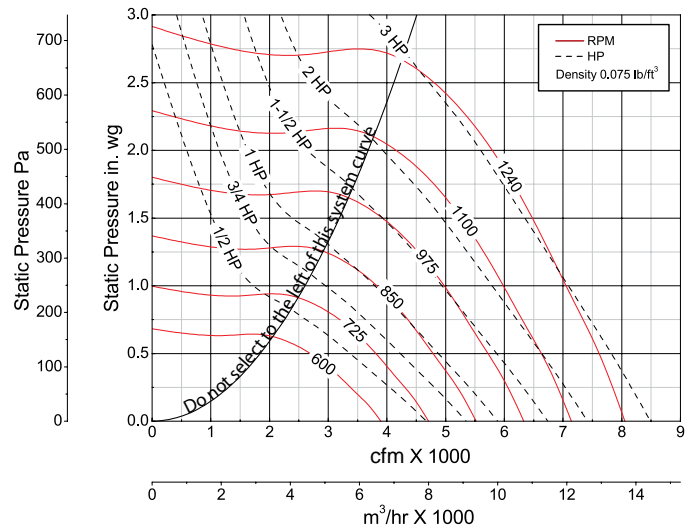

Model Number	HP (Size)	Fan RPM	Static Pressure in Inches wg																		
			0.5	0.625	0.75	1	1.25	1.5	1.75	2	2.25	2.5									
GB-240HP-5	1/2	635	CFM	3035	2586																
			BHP	0.42	0.41																
			Sones	8.0	7.6																
	685	CFM	3475	3147	2693																
		BHP	0.53	0.53	0.51																
		Sones	9.4	8.8	8.4																
GB-240HP-7	3/4	733	CFM	3877	3603	3272															
			BHP	0.64	0.65	0.65															
			Sones	11.0	10.3	9.7															
	780	CFM	4247	4005	3740	2964															
		BHP	0.76	0.77	0.78	0.75															
		Sones	12.7	11.9	11.3	10.3															
GB-240HP-10	1	860	CFM	4860	4654	4434	3915	3105													
			BHP	0.99	1.02	1.04	1.05	0.99													
			Sones	15.9	15.2	14.3	13.2	12.2													
GB-240HP-15	1 1/2	920	CFM	5310	5118	4925	4496	3944													
			BHP	1.20	1.23	1.25	1.29	1.27													
			Sones	18.5	17.4	16.6	15.0	13.8													
	980	CFM	5751	5574	5392	5010	4562	3958													
		BHP	1.43	1.47	1.49	1.54	1.55	1.52													
		Sones	22	19.9	19.1	17.2	15.6	14.8													
GB-240HP-20	2	1030	CFM	6114	5948	5776	5428	5039	4560	3896											
			BHP	1.65	1.69	1.72	1.77	1.80	1.80	1.73											
			Sones	24	23	21	19.6	17.6	16.3	15.7											
	1080	CFM	6474	6315	6154	5826	5468	5062	4555	3763											
		BHP	1.89	1.92	1.96	2.02	2.06	2.08	2.05	1.93											
		Sones	27	26	24	23	20	18.2	17.3	16.7											
GB-240HP-30	3	1133	CFM	6853	6702	6550	6237	5914	5560	5133	4588										
			BHP	2.16	2.20	2.24	2.31	2.36	2.40	2.39	2.35										
			Sones	29	27	26	24	22	21	19.3	18.7										
	1240	CFM	7610	7471	7333	7053	6767	6469	6146	5775	5364	4776									
		BHP	2.80	2.84	2.89	2.97	3.04	3.10	3.14	3.14	3.13	3.04									
		Sones	31	30	29	28	27	25	24	23	23	22									

MAXIMUM BHP AT A GIVEN RPM = (RPM/845)³
 MAXIMUM RPM = 1240
 TIP SPEED (ft/min.) = RPM x 6.414
 MAXIMUM MOTOR FRAME SIZE = 184T

Performance shown is for installation type A: Free inlet, Free outlet. Power rating (BHP) does not include transmission losses. Performance ratings include the effects of a birdscreen in the airstream. The sound ratings shown are loudness values in fan sones at 5 ft. (1.5 m) in a hemispherical free field calculated per AMCA Standard 301. Values shown are for installation type A: Free inlet fan sone levels.

GB-260 - Belt Drive

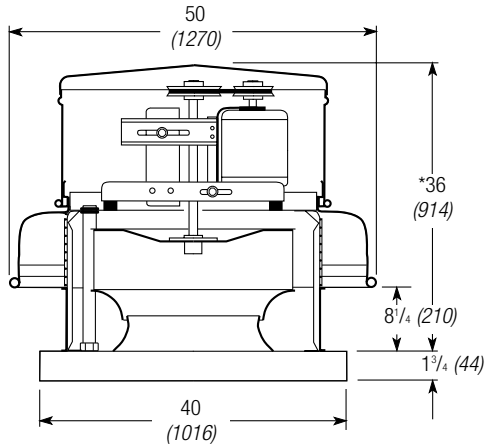

Damper Size = 30 x 30 (762 x 762)
 Roof Opening = 32 1/2 x 32 1/2 (826 x 826)
 Shroud Thickness = 0.064 (1.6)
 Motor Cover Thickness = 0.051 (1.3)
 Curb Cap Thickness = 0.064 (1.6)
 ^Approximate Unit Weight = 305 lb. (138 kg)

All dimensions in inches (millimeters).
 *May be greater depending on motor.
 ^Weight shown is largest cataloged Open Drip Proof motor.

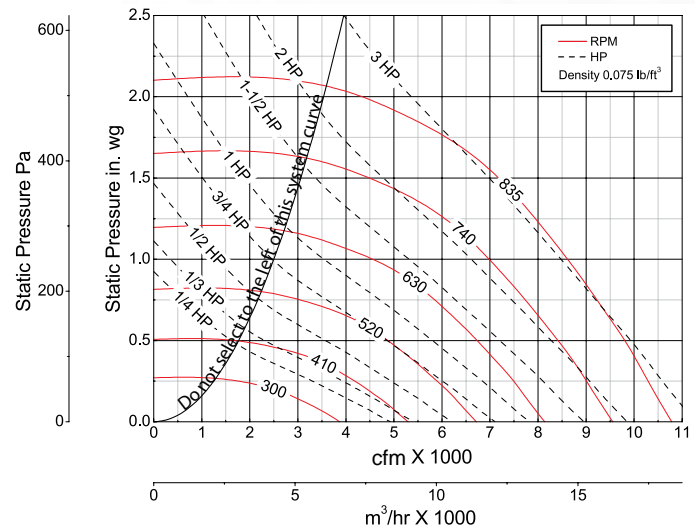

Model Number	HP (Size)	Fan RPM	Static Pressure in Inches wg													
			0	0.125	0.25	0.5	0.75	1	1.25	1.5	1.75	2				
GB-260-4	1/4	300	CFM	3875	3121	1727										
			BHP	0.12	0.14	0.12										
			Sones	8.0	7.1	7.4										
	365	CFM	4714	4130	3393											
		BHP	0.22	0.25	0.26											
		Sones	9.2	8.8	8.6											
GB-260-3	1/3	405	CFM	5231	4716	4095										
			BHP	0.30	0.33	0.35										
			Sones	10.4	10.3	10.3										
GB-260-5	1/2	465	CFM	6005	5570	5063	3745									
			BHP	0.45	0.50	0.52	0.53									
			Sones	11.4	10.9	10.4	9.6									
GB-260-7	3/4	520	CFM	6716	6324	5898	4869	3008								
			BHP	0.63	0.68	0.72	0.75	0.64								
			Sones	12.9	12.1	11.3	10.3	9.4								
GB-260-10	1	580	CFM	7491	7137	6775	5912	4826								
			BHP	0.88	0.93	0.98	1.04	1.03								
			Sones	14.4	13.7	13.0	12.2	11.0								
GB-260-15	1 1/2	665	CFM	8588	8278	7979	7274	6474	5465	3608						
			BHP	1.33	1.39	1.44	1.53	1.57	1.55	1.29						
			Sones	16.7	16.2	15.8	15.0	14.2	13.3	12.8						
			735	CFM	9493	9212	8938	8335	7649	6878	5916	4236				
			BHP	1.79	1.86	1.92	2.03	2.10	2.13	2.09	1.80					
			Sones	18.9	18.6	18.3	17.6	16.8	16.2	15.6	14.9					
GB-260-20	2	700	CFM	9041	8746	8460	7811	7068	6227	4912						
			BHP	1.55	1.61	1.67	1.77	1.82	1.83	1.71						
			Sones	17.8	17.4	17.0	16.2	15.5	14.8	13.8						
			735	CFM	9493	9212	8938	8335	7649	6878	5916	4236				
			BHP	1.79	1.86	1.92	2.03	2.10	2.13	2.09	1.80					
			Sones	18.9	18.6	18.3	17.6	16.8	16.2	15.6	14.9					
GB-260-30	3	785	CFM	10138	9875	9617	9069	8452	7769	7006	5949	4189				
			BHP	2.18	2.26	2.33	2.44	2.53	2.58	2.59	2.49	2.11				
			Sones	21	20	20	19.7	18.9	18.2	17.9	17.1	16.7				
			835	CFM	10784	10537	10292	9794	9225	8606	7932	7157	6024	4294		
			BHP	2.62	2.70	2.78	2.91	3.02	3.08	3.12	3.10	2.93	2.49			
			Sones	23	23	22	22	21	20	19.9	19.7	18.7	18.6			

MAXIMUM BHP AT A GIVEN RPM = (RPM/572)³
 MAXIMUM RPM = 835
 TIP SPEED (ft/min.) = RPM x 7.985
 MAXIMUM MOTOR FRAME SIZE = 184T

Performance shown is for installation type A: Free inlet, Free outlet. Power rating (BHP) does not include transmission losses. Performance ratings include the effects of a birdscreen in the airstream. The sound ratings shown are loudness values in fan sones at 5 ft. (1.5 m) in a hemispherical free field calculated per AMCA Standard 301. Values shown are for installation type A: Free inlet fan sone levels.

GB-300 - Belt Drive

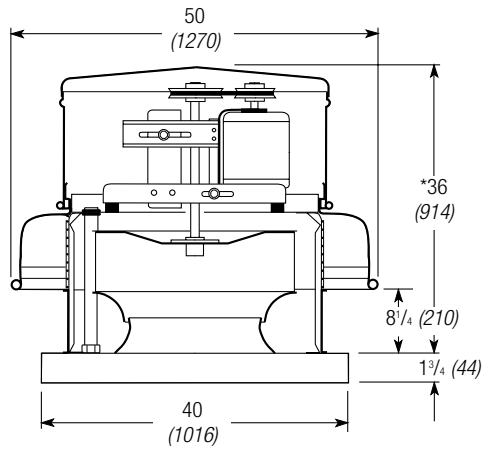

Damper Size = 30 x 30 (762 x 762)
 Roof Opening = 32 1/2 x 32 1/2 (826 x 826)
 Shroud Thickness = 0.064 (1.6)
 Motor Cover Thickness = 0.051 (1.3)
 Curb Cap Thickness = 0.064 (1.6)
 ^Approximate Unit Weight = 320 lb. (145 kg)

All dimensions in inches (millimeters).
 *May be greater depending on motor.
 ^Weight shown is largest cataloged Open Drip Proof motor.

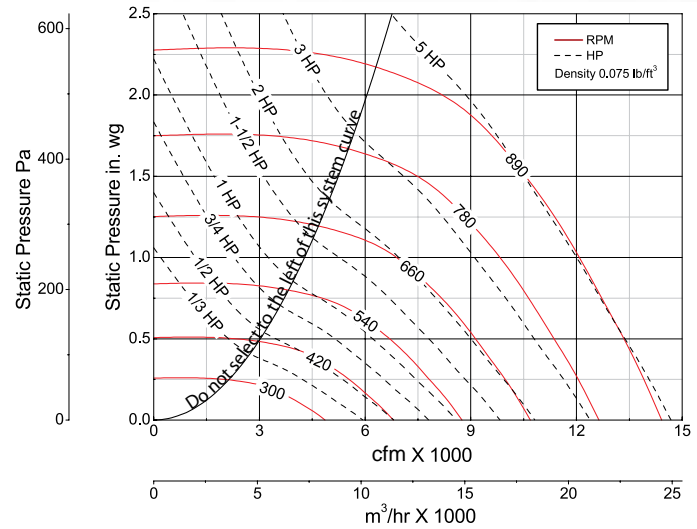

Model Number	HP (Size)	Fan RPM	Static Pressure in Inches wg														
			0	0.125	0.25	0.5	0.75	1	1.25	1.5	1.75	2					
GB-300-3	1/3	300	CFM	4859	3976												
			BHP	0.18	0.19												
			Sones	9.3	5.3												
			365	CFM	5912	5222	4340										
GB-300-5	1/2	420	CFM	6803	6222	5537											
			BHP	0.50	0.52	0.53											
			Sones	9.6	8.0	7.0											
			475	CFM	7694	7197	6616	5095									
GB-300-7	3/4	475	BHP	0.72	0.75	0.77	0.74										
			Sones	11.4	10.6	9.6	8.1										
			530	CFM	8585	8150	7640	6456	4195								
			BHP	1.00	1.04	1.06	1.07	0.91									
GB-300-10	1	530	Sones	13.4	12.9	12.2	10.7	9.4									
			600	CFM	9719	9334	8907	7952	6721								
			BHP	1.45	1.49	1.53	1.55	1.52									
			Sones	15.9	15.4	14.9	13.8	12.2									
GB-300-15	1 1/2	600	CFM	10772	10425	10060	9228	8269	7025								
			BHP	1.97	2.02	2.06	2.11	2.11	2.03								
			Sones	18.8	18.2	17.7	16.8	15.7	13.7								
			713	CFM	11549	11226	10901	10129	9297	8283	6691						
GB-300-20	2	665	BHP	2.43	2.48	2.53	2.59	2.61	2.57	2.38							
			Sones	21	20	19.6	18.9	18.0	16.4	13.7							
			760	CFM	12311	12007	11704	10997	10242	9369	8293	6437					
			BHP	2.94	3.00	3.05	3.13	3.16	3.15	3.06	2.76						
			Sones	23	22	21	21	19.8	18.6	16.8	14.0						
			825	CFM	13363	13084	12804	12175	11501	10770	9909	8885	7128				
			BHP	3.76	3.82	3.88	3.97	4.02	4.05	4.01	3.90	3.56					
			Sones	25	25	24	24	23	22	20	18.7	16.1					
GB-300-30	3	713	CFM	14416	14157	13898	13335	12716	12073	11379	10536	9568	7963				
			BHP	4.73	4.79	4.85	4.96	5.03	5.06	5.09	5.02	4.89	4.54				
			Sones	28	28	28	27	26	25	24	22	21	18.7				
			890	CFM	14416	14157	13898	13335	12716	12073	11379	10536	9568	7963			
GB-300-50	5	890	BHP	4.73	4.79	4.85	4.96	5.03	5.06	5.09	5.02	4.89	4.54				
			Sones	28	28	28	27	26	25	24	22	21	18.7				

MAXIMUM BHP AT A GIVEN RPM = (RPM/517)³
 MAXIMUM RPM = 890
 TIP SPEED (ft/min.) = RPM x 7.985
 MAXIMUM MOTOR FRAME SIZE = 184T

Performance shown is for installation type A: Free inlet, Free outlet. Power rating (BHP) does not include transmission losses. Performance ratings include the effects of a birdscreen in the airstream. The sound ratings shown are loudness values in fan sones at 5 ft. (1.5 m) in a hemispherical free field calculated per AMCA Standard 301. Values shown are for installation type A: Free inlet fan sone levels.

GB-300HP - Belt Drive

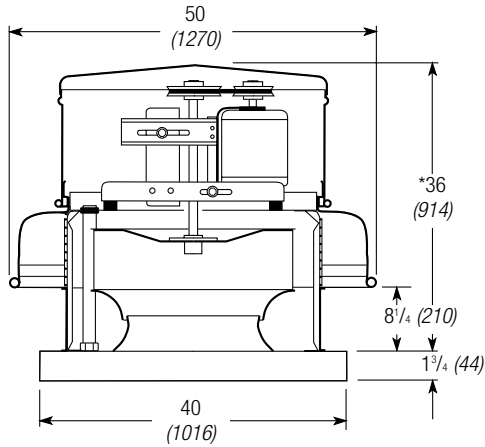

Damper Size = 30 x 30 (762 x 762)
 Roof Opening = 32 1/2 x 32 1/2 (826 x 826)
 Shroud Thickness = 0.064 (1.6)
 Motor Cover Thickness = 0.051 (1.3)
 Curb Cap Thickness = 0.064 (1.6)
 ^Approximate Unit Weight = 320 lb. (145 kg)

All dimensions in inches (millimeters).
 *May be greater depending on motor.
 ^Weight shown is largest cataloged Open Drip Proof motor.

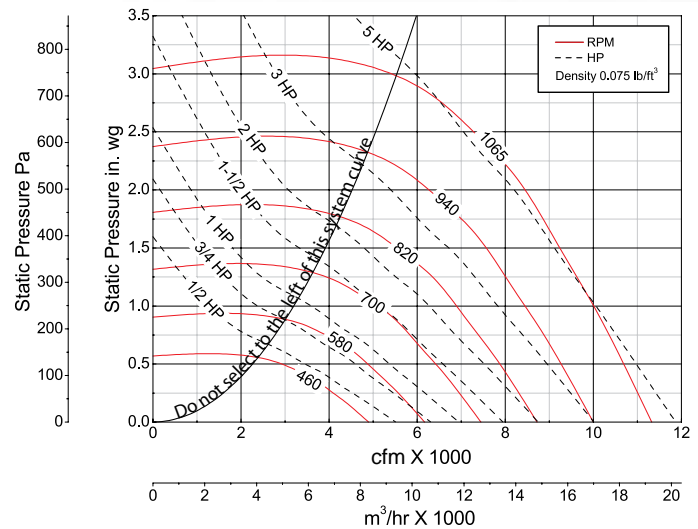

Model Number	HP (Size)	Fan RPM	Static Pressure in Inches wg																		
			0.5	0.75	1	1.25	1.5	1.75	2	2.25	2.5	2.75									
GB-300HP-5	1/2	460	CFM	2912																	
			BHP	0.41																	
			Sones	9.7																	
	495	CFM	3602																		
		BHP	0.53																		
		Sones	10.3																		
GB-300HP-7	3/4	565	CFM	4662	3600																
			BHP	0.77	0.76																
			Sones	11.8	10.4																
GB-300HP-10	1	620	CFM	5398	4652	3309															
			BHP	1.01	1.04	0.94															
			Sones	13.4	12.3	10.6															
GB-300HP-15	1 1/2	710	CFM	6542	5954	5269	4221														
			BHP	1.48	1.53	1.55	1.47														
			Sones	17.2	16.0	15.3	13.4														
GB-300HP-20	2	748	CFM	7013	6462	5889	5027														
			BHP	1.71	1.78	1.81	1.78														
			Sones	18.8	17.5	17.0	15.7														
	785	CFM	7460	6943	6402	5737	4800														
		BHP	1.96	2.04	2.08	2.10	2.00														
		Sones	20	19.1	18.5	17.9	16.2														
GB-300HP-30	3	840	CFM	8107	7642	7146	6636	5922	4992												
			BHP	2.37	2.46	2.52	2.57	2.56	2.43												
			Sones	23	22	21	21	19.7	18.0												
	895	CFM	8746	8328	7870	7394	6892	6150	5245												
		BHP	2.84	2.95	3.03	3.07	3.11	3.08	2.92												
		Sones	25	24	23	23	23	22	19.8												
GB-300HP-50	5	980	CFM	9722	9356	8951	8531	8094	7657	7029	6264	5222									
			BHP	3.68	3.81	3.90	3.99	4.03	4.08	4.09	3.95	3.69									
			Sones	32	31	29	28	27	26	25	24	23									
	1065	CFM	10688	10351	10006	9621	9233	8831	8429	7903	7255	6543									
		BHP	4.67	4.81	4.94	5.04	5.12	5.17	5.23	5.24	5.17	5.01									
		Sones	44	42	37	37	36	35	33	31	30	29									

MAXIMUM BHP AT A GIVEN RPM = (RPM/613)³
 MAXIMUM RPM = 1065
 TIP SPEED (ft/min.) = RPM x 7.985
 MAXIMUM MOTOR FRAME SIZE = 184T

Performance shown is for installation type A: Free inlet, Free outlet. Power rating (BHP) does not include transmission losses. Performance ratings include the effects of a birdscreen in the airstream. The sound ratings shown are loudness values in fan sones at 5 ft. (1.5 m) in a hemispherical free field calculated per AMCA Standard 301. Values shown are for installation type A: Free inlet fan sone levels.

GB-360 - Belt Drive

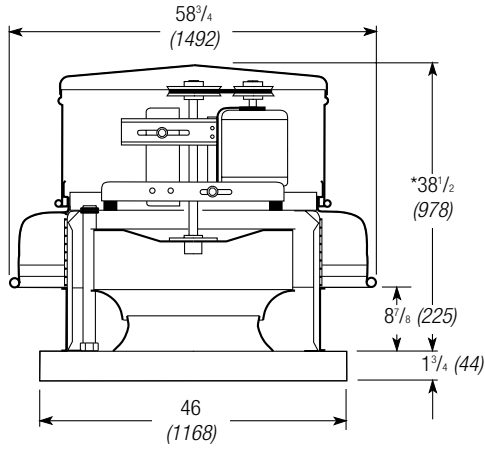

Damper Size = 36 x 36 (914 x 914)
 Roof Opening = 38 1/2 x 38 1/2 (978 x 978)
 Shroud Thickness = 0.80 (2.0)
 Motor Cover Thickness = 0.064 (1.6)
 Curb Cap Thickness = 0.080 (2.0)
 ^Approximate Unit Weight = 403 lb. (183 kg)

All dimensions in inches (millimeters).
 *May be greater depending on motor.
 ^Weight shown is largest cataloged Open Drip Proof motor.

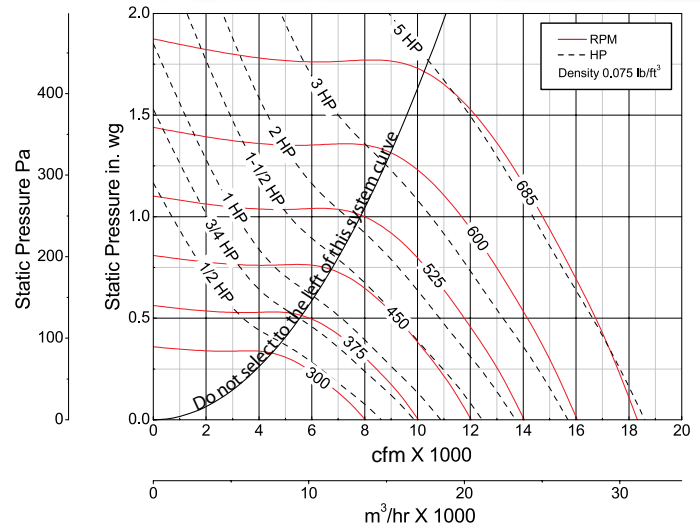

Model Number	HP (Size)	Fan RPM	Static Pressure in Inches wg														
			0	0.125	0.25	0.375	0.5	0.625	0.75	1	1.25	1.5					
GB-360-5	1/2	300	CFM	8024	7070	5804											
			BHP	0.40	0.43	0.44											
			Sones	7.6	6.6	5.6											
	325	CFM	8693	7830	6756	5001											
		BHP	0.51	0.54	0.56	0.51											
		Sones	8.7	7.7	6.8	5.6											
GB-360-7	3/4	365	CFM	9763	9024	8109	7013										
			BHP	0.72	0.76	0.79	0.78										
			Sones	10.8	10.0	8.9	7.9										
GB-360-10	1	410	CFM	10966	10330	9558	8686	7641									
			BHP	1.02	1.07	1.11	1.12	1.11									
			Sones	13.7	13.3	11.9	10.9	9.6									
GB-360-15	1 1/2	460	CFM	12304	11737	11085	10360	9568	8607	7096							
			BHP	1.45	1.50	1.55	1.58	1.59	1.56	1.46							
			Sones	15.9	15.6	14.8	14.1	13.1	12.1	10.9							
GB-360-20	2	483	CFM	12919	12379	11776	11109	10355	9517	8488							
			BHP	1.67	1.73	1.78	1.82	1.83	1.83	1.78							
			Sones	17.0	16.7	16.1	15.5	14.8	13.7	12.9							
	505	CFM	13507	12991	12431	11795	11096	10368	9473								
		BHP	1.91	1.97	2.02	2.07	2.09	2.10	2.07								
		Sones	18.1	17.8	17.3	16.8	16.5	15.5	14.7								
GB-360-30	3	543	CFM	14524	14043	13551	12959	12350	11679	10965	8917						
			BHP	2.38	2.44	2.5	2.55	2.59	2.60	2.60	2.46						
			Sones	20	19.8	19.4	18.9	18.6	17.8	16.9	15.6						
	580	CFM	15513	15064	14614	14077	13523	12917	12289	10813							
		BHP	2.90	2.96	3.03	3.09	3.14	3.17	3.18	3.13							
		Sones	22	22	22	21	21	20	19.1	17.6							
GB-360-50	5	633	CFM	16931	16519	16107	15654	15146	14639	14072	12892	11465					
			BHP	3.77	3.84	3.91	3.98	4.04	4.10	4.12	4.13	4.05					
			Sones	26	25	25	24	24	23	23	21	19.7					
	685	CFM	18322	17941	17560	17179	16711	16243	15774	14710	13535	12119					
		BHP	4.77	4.85	4.93	5.01	5.07	5.14	5.20	5.23	5.21	5.10					
		Sones	30	30	29	29	28	28	26	24	23	22					

MAXIMUM BHP AT A GIVEN RPM = (RPM/394)³
 MAXIMUM RPM = 685
 TIP SPEED (ft/min.) = RPM x 9.425
 MAXIMUM MOTOR FRAME SIZE = 215T

Performance shown is for installation type A: Free inlet, Free outlet. Power rating (BHP) does not include transmission losses. Performance ratings include the effects of a birdscreen in the airstream. The sound ratings shown are loudness values in fan sones at 5 ft. (1.5 m) in a hemispherical free field calculated per AMCA Standard 301. Values shown are for installation type A: Free inlet fan sone levels.

GB-360HP - Belt Drive

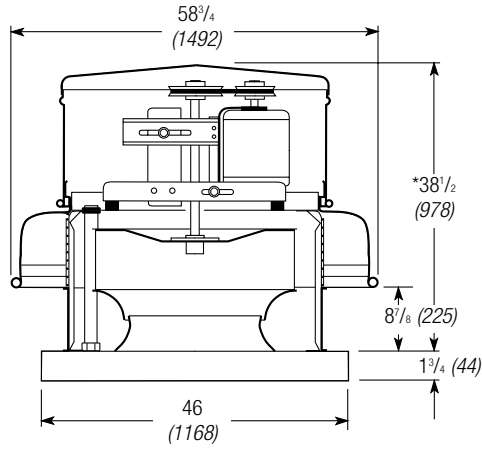

Damper Size = 36 x 36 (914 x 914)
 Roof Opening = 38 1/2 x 38 1/2 (978 x 978)
 Shroud Thickness = 0.080 (2.0)
 Motor Cover Thickness = 0.064 (1.6)
 Curb Cap Thickness = 0.080 (2.0)
 ^Approximate Unit Weight = 403 lb. (183 kg)

All dimensions in inches (millimeters).
 *May be greater depending on motor.
 ^Weight shown is largest cataloged Open Drip Proof motor.

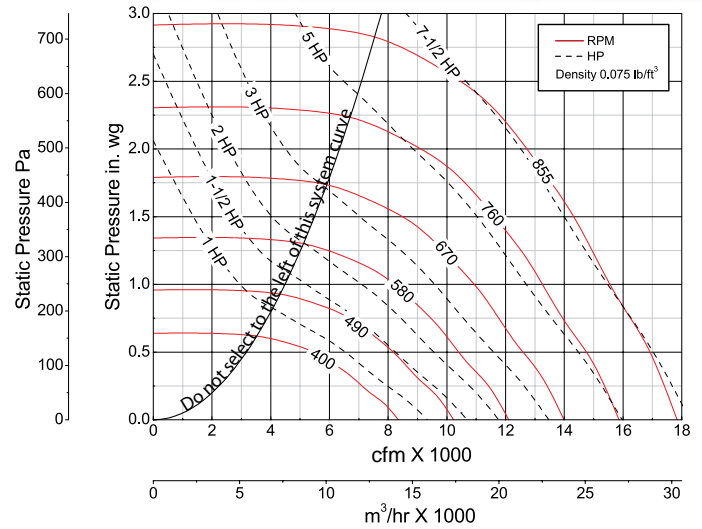

Model Number	HP (Size)	Fan RPM	Static Pressure in Inches wg																		
			0.5	0.75	1	1.25	1.5	1.75	2	2.25	2.5	2.75									
GB-360HP-10	1	420	CFM	6097																	
			BHP	0.91																	
		435	CFM	6576																	
			BHP	1.02																	
GB-360HP-15	1 1/2	500	CFM	8432	7000																
			BHP	1.56	1.53																
			Sones	13.4	12.5																
GB-360HP-20	2	525	CFM	9061	7808	5650															
			BHP	1.79	1.78	1.61															
			Sones	14.7	13.6	12.7															
		550	CFM	9681	8589	6998															
			BHP	2.05	2.06	1.98															
			Sones	16.0	14.8	14.2															
GB-360HP-30	3	590	CFM	10657	9719	8495	6528														
			BHP	2.50	2.57	2.52	2.32														
			Sones	18.0	16.3	15.7	14.9														
		630	CFM	11616	10772	9767	8525	6006													
			BHP	3.01	3.11	3.10	3.04	2.63													
			Sones	20	18.6	17.6	16.9	15.7													
GB-360HP-50	5	690	CFM	13062	12259	11464	10468	9335	7159												
			BHP	3.93	4.02	4.11	4.05	3.99	3.60												
			Sones	24	22	21	20	19.2	18.1												
		750	CFM	14487	13711	13002	12220	11282	10239	8513											
			BHP	5.02	5.10	5.22	5.26	5.20	5.13	4.83											
			Sones	27	25	24	24	23	22	21											
GB-360HP-75	7 1/2	803	CFM	15728	14985	14309	13647	12863	11960	10986	9445										
			BHP	6.13	6.22	6.33	6.46	6.44	6.37	6.30	6.01										
			Sones	31	30	28	27	26	25	24	23										
		855	CFM	16918	16236	15568	14946	14315	13544	12676	11761	10368	8273								
			BHP	7.37	7.47	7.58	7.71	7.82	7.76	7.69	7.61	7.32	6.63								
			Sones	35	33	33	31	29	29	27	27	26	25								

MAXIMUM BHP AT A GIVEN RPM = (RPM/431)³
 MAXIMUM RPM = 855
 TIP SPEED (ft/min.) = RPM x 9.425
 MAXIMUM MOTOR FRAME SIZE = 215T

Performance shown is for installation type A: Free inlet, Free outlet. Power rating (BHP) does not include transmission losses. Performance ratings include the effects of a birdscreen in the airstream. The sound ratings shown are loudness values in fan sones at 5 ft. (1.5 m) in a hemispherical free field calculated per AMCA Standard 301. Values shown are for installation type A: Free inlet fan sone levels.

GB-420 - Belt Drive

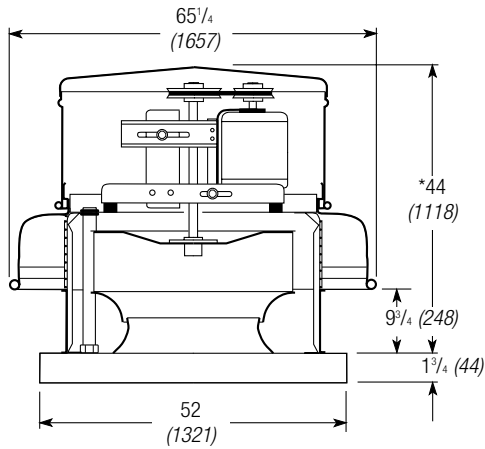

Damper Size = 42 x 42 (1067 x 1067)
 Roof Opening = 44 1/2 x 44 1/2 (1130 x 1130)
 Shroud Thickness = 0.080 (2.0)
 Motor Cover Thickness = 0.064 (1.6)
 Curb Cap Thickness = 0.100 (2.5)
 ^Approximate Unit Weight = 495 lb. (225 kg)

All dimensions in inches (millimeters).
 *May be greater depending on motor.
 ^Weight shown is largest cataloged Open Drip Proof motor.

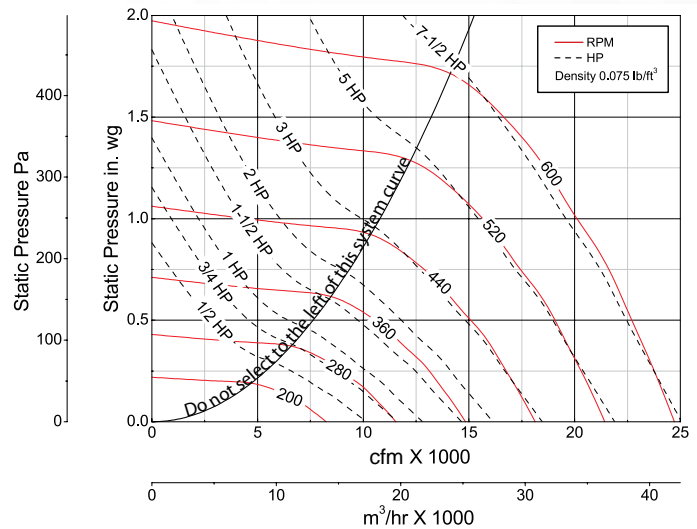

Model Number	HP (Size)	Fan RPM	Static Pressure in Inches wg												
			0	0.125	0.25	0.375	0.50	0.625	0.75	1.00	1.25	1.5			
GB-420-5	1/2	200	CFM	8242	6454										
			BHP	0.27	0.29										
			Sones	3.1	2.9										
		240	CFM	9890	8573	6365									
			BHP	0.46	0.50	0.48									
			Sones	4.6	5.0	4.9									
GB-420-7	3/4	275	CFM	11332	10219	8698									
			BHP	0.69	0.75	0.76									
			Sones	6.2	6.8	5.6									
GB-420-10	1	305	CFM	12568	11579	10320	8672								
			BHP	0.95	1.01	1.03	1.01								
			Sones	8.0	8.4	7.5	7.2								
GB-420-15	1 1/2	345	CFM	14217	13357	12411	11102	9463							
			BHP	1.37	1.45	1.49	1.50	1.45							
			Sones	11.7	11.3	10.8	10.1	9.6							
GB-420-20	2	380	CFM	15659	14892	14043	12983	11787	10108						
			BHP	1.83	1.92	1.97	2.00	2.00	1.91						
			Sones	14.4	13.8	13.3	12.7	12.3	12.0						
GB-420-30	3	435	CFM	17925	17264	16540	15792	14790	13764	12502					
			BHP	2.74	2.86	2.93	2.97	2.99	3.00	2.95					
			Sones	19.0	18.4	17.8	17.3	16.6	16.4	16.5					
GB-420-50	5	475	CFM	19574	18968	18320	17640	16887	15929	14994	12315				
			BHP	3.57	3.69	3.78	3.84	3.88	3.90	3.91	3.69				
			Sones	22	21	20	19.8	19.3	18.6	18.3	18.3				
		515	CFM	21222	20663	20081	19459	18826	18046	17162	15254	12312			
			BHP	4.55	4.68	4.80	4.87	4.92	4.95	4.98	4.92	4.56			
			Sones	24	24	23	22	21	21	20	19.4	19.1			
GB-420-75	7 1/2	558	CFM	22994	22478	21957	21383	20805	20219	19446	17835	15908			
			BHP	5.79	5.93	6.07	6.15	6.22	6.28	6.31	6.34	6.21			
			Sones	27	27	26	25	24	24	23	23	22			
	600		CFM	24725	24245	23765	23243	22709	22166	21621	20104	18585	16590		
			BHP	7.20	7.35	7.51	7.61	7.70	7.76	7.81	7.87	7.86	7.64		
			Sones	30	30	30	29	27	27	26	26	26	26		

MAXIMUM BHP AT A GIVEN RPM = (RPM/302)³
 MAXIMUM RPM = 600
 TIP SPEED (ft/min.) = RPM x 11.061
 MAXIMUM MOTOR FRAME SIZE = 215T

Performance shown is for installation type A: Free inlet, Free outlet. Power rating (BHP) does not include transmission losses. Performance ratings include the effects of a birdscreen in the airstream. The sound ratings shown are loudness values in fan sones at 5 ft. (1.5 m) in a hemispherical free field calculated per AMCA Standard 301. Values shown are for installation type A: Free inlet fan sone levels.

GB-480 - Belt Drive

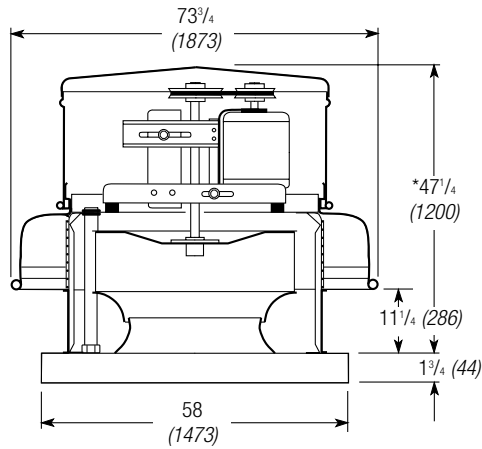

Damper Size = 48 x 48 (1219 x 1219)
 Roof Opening = 50 1/2 x 50 1/2 (1283 x 1283)
 Shroud Thickness = 0.080 (2.0)
 Motor Cover Thickness = 0.064 (1.6)
 Curb Cap Thickness = 0.100 (2.5)
 ^Approximate Unit Weight = 623 lb. (283 kg)

All dimensions in inches (millimeters).
 *May be greater depending on motor.
 ^Weight shown is largest cataloged Open Drip Proof motor.

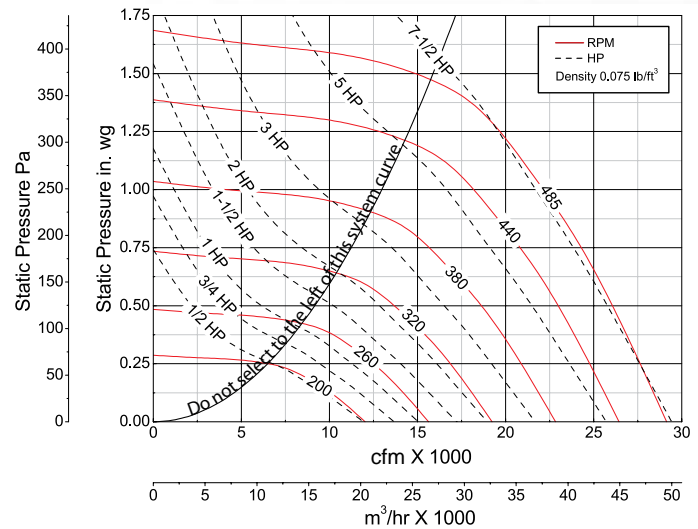

Model Number	HP (Size)	Fan RPM	Static Pressure in Inches wg													
				0	0.125	0.25	0.375	0.5	0.625	0.75	0.875	1	1.25			
GB-480-5	1/2	200	CFM	12020	10059	6529										
			BHP	0.51	0.55	0.48										
			Sones	7.3	6.6	7.3										
GB-480-7	3/4	225	CFM	13522	11811	9500										
			BHP	0.73	0.77	0.76										
			Sones	8.3	8.0	7.6										
GB-480-10	1	250	CFM	15025	13516	11662	8820									
			BHP	1.00	1.05	1.06	0.98									
			Sones	9.5	9.5	8.6	8.1									
GB-480-15	1 1/2	285	CFM	17129	15830	14379	12517	9587								
			BHP	1.48	1.54	1.58	1.56	1.42								
			Sones	11.8	11.2	10.7	10.0	9.1								
GB-480-20	2	310	CFM	18631	17437	16135	14589	12656								
			BHP	1.90	1.97	2.02	2.02	1.97								
			Sones	14.0	13.0	12.2	12.0	11.5								
GB-480-30	3	360	CFM	21636	20608	19548	18385	17010	15420	13507						
			BHP	2.98	3.06	3.13	3.17	3.17	3.21	3.00						
			Sones	17.6	17.0	16.4	15.9	15.5	15.0	14.2						
GB-480-50	5	393	CFM	23619	22678	21736	20683	19605	18254	16764	15086					
			BHP	3.87	3.66	4.05	4.10	4.14	4.12	4.06	3.94					
			Sones	20	19.9	19.5	18.8	18.3	18.0	17.5	16.7					
	415	CFM	24942	24050	23158	22189	21181	20012	18733	17211	15486					
		BHP	4.56	4.65	4.75	4.81	4.85	4.86	4.84	4.74	4.58					
		Sones	22	22	22	21	21	20	20	19.1	18.1					
425	CFM	25542	24672	23801	22868	21883	20799	19550	18156	16604						
	BHP	4.90	4.99	5.09	5.16	5.20	5.22	5.20	5.13	5.00						
	Sones	23	23	23	22	22	21	21	20	19.3						
GB-480-75	7 1/2	455	CFM	27345	26532	25719	24886	23966	23046	21953	20786	19471	15870			
			BHP	6.01	6.11	6.22	6.31	6.36	6.41	6.41	6.38	6.30	5.85			
			Sones	27	27	27	26	26	25	25	24	24	21			
	485	CFM	29149	28386	27623	26860	26016	25153	24290	23201	22106	19517				
		BHP	7.28	7.39	7.50	7.61	7.67	7.72	7.78	7.75	7.73	7.49				
		Sones	31	31	31	31	30	29	29	28	28	26				

MAXIMUM BHP AT A GIVEN RPM = (RPM/245)³
 MAXIMUM RPM = 485
 TIP SPEED (ft./min.) = RPM x 12.632
 MAXIMUM MOTOR FRAME SIZE = 215T

Performance shown is for installation type A: Free inlet, Free outlet. Power rating (BHP) does not include transmission losses. Performance ratings include the effects of a birdscreen in the airstream. The sound ratings shown are loudness values in fan sones at 5 ft. (1.5 m) in a hemispherical free field calculated per AMCA Standard 301. Values shown are for installation type A: Free inlet fan sone levels.

GB-500 - Belt Drive

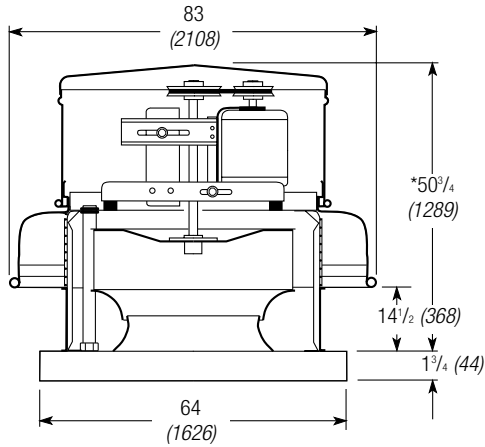

Damper Size = 54 x 54 (1371 x 1371)
 Roof Opening = 56 1/2 x 56 1/2 (1435 x 1435)
 Shroud Thickness = 0.100 (2.5)
 Motor Cover Thickness = 0.064 (1.6)
 Curb Cap Thickness = 0.100 (2.5)
 ^Approximate Unit Weight = 687 lb. (312 kg)

All dimensions in inches (millimeters).
 *May be greater depending on motor.
 ^Weight shown is largest cataloged Open Drip Proof motor.

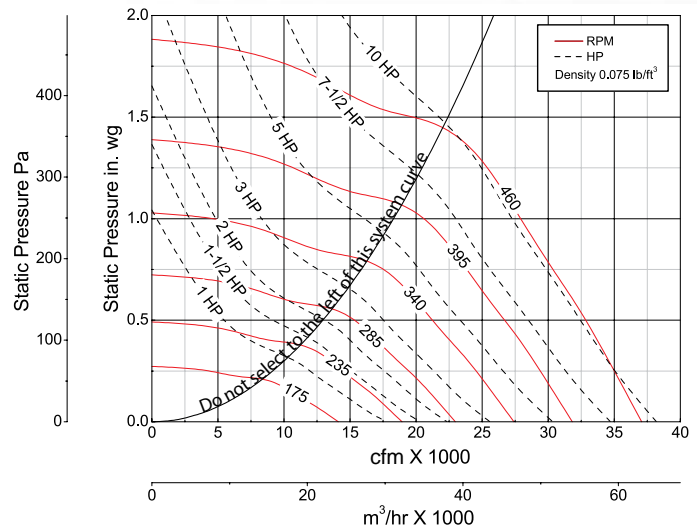

Model Number	HP (Size)	Fan RPM	Static Pressure in Inches wg												
			0	0.125	0.25	0.375	0.5	0.625	0.75	0.875	1	1.25			
GB-500-10	1	175	CFM	14102	11123										
			BHP	0.50	0.57										
			Sones	6.7	6.5										
	200	CFM	16117	13588	10593										
		BHP	0.75	0.85	0.83										
		Sones	8.4	8.0	7.7										
214	CFM	17245	14939	12242											
	BHP	0.92	1.04	1.04											
	Sones	9.5	9.1	8.7											
GB-500-15	1 1/2	245	CFM	19743	17749	15481	12983								
			BHP	1.38	1.54	1.57	1.53								
			Sones	11.9	11.5	11.0	10.7								
GB-500-20	2	269	CFM	21677	19873	17857	15752								
			BHP	1.83	2.02	2.06	2.08								
			Sones	14.0	13.8	13.2	12.7								
GB-500-30	3	308	CFM	24820	23263	21627	19752	17903	15284						
			BHP	2.74	3.00	3.09	3.11	3.11	2.96						
			Sones	17.7	17.4	16.9	16.2	15.8	15.6						
GB-500-50	5	337	CFM	27157	25739	24253	22614	20937	19206	16671					
			BHP	3.59	3.89	4.01	4.06	4.08	4.06	3.88					
			Sones	19.9	19.5	19.1	18.5	17.9	17.6	17.4					
	366	CFM	29494	28188	26834	25429	23831	22310	20688	18366					
		BHP	4.60	4.92	5.10	5.20	5.20	5.24	5.19	4.99					
		Sones	22	22	21	21	20	19.8	19.5	19.4					
GB-500-75	7 1/2	419	CFM	33764	32624	31467	30265	29015	27607	26276	24940	23486			
			BHP	6.90	7.27	7.57	7.70	7.80	7.80	7.84	7.88	7.78			
			Sones	27	27	27	26	26	25	24	24	23			
GB-500-100	10	440	CFM	35457	34371	33279	32134	30989	29679	28373	27107	25801	22407		
			BHP	8.00	8.38	8.74	8.87	9.01	9.03	9.05	9.10	9.09	8.73		
			Sones	30	29	29	29	29	28	27	26	26	25		
	460	CFM	37068	36030	34991	33900	32805	31625	30342	29127	27917	25310			
		BHP	9.14	9.54	9.94	10.10	10.24	10.32	10.32	10.36	10.41	10.26			
		Sones	32	32	32	32	32	31	30	29	28	27			

MAXIMUM BHP AT A GIVEN RPM = (RPM/210)³
 MAXIMUM RPM = 460
 TIP SPEED (ft/min.) = RPM x 14.137
 MAXIMUM MOTOR FRAME SIZE = 256T

Performance shown is for installation type A: Free inlet, Free outlet. Power rating (BHP) does not include transmission losses. Performance ratings include the effects of a birdscreen in the airstream. The sound ratings shown are loudness values in fan sones at 5 ft. (1.5 m) in a hemispherical free field calculated per AMCA Standard 301. Values shown are for installation type A: Free inlet fan sone levels.

GB-540 - Belt Drive

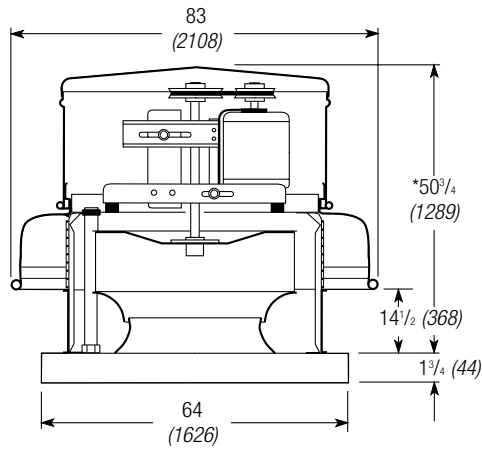

Damper Size = 54 x 54 (1371 x 1371)
 Roof Opening = 56 1/2 x 56 1/2 (1435 x 1435)
 Shroud Thickness = 0.100 (2.5)
 Motor Cover Thickness = 0.064 (1.6)
 Curb Cap Thickness = 0.100 (2.5)
 ^Approximate Unit Weight = 748 lb. (339 kg)

All dimensions in inches (millimeters).
 *May be greater depending on motor.
 ^Weight shown is largest cataloged Open Drip Proof motor.

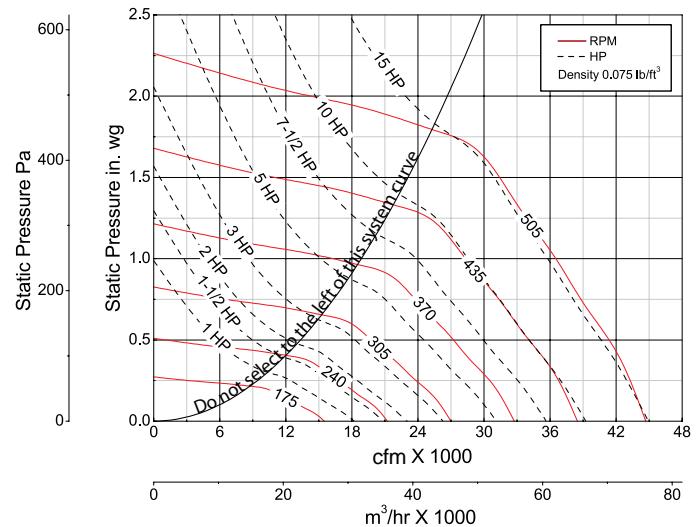

Model Number	HP (Size)	Fan RPM	Static Pressure in Inches wg															
				0	0.125	0.25	0.375	0.5	0.75	1	1.25	1.5	1.75					
GB-540-10	1	175	CFM	15488	1250													
			BHP	0.61	0.65													
			Sones	6.9	6.3													
		195	CFM	17258	14674	11068												
				BHP	0.85	0.90	0.87											
				Sones	7.8	7.5	7.2											
	205	CFM	18143	15724	12632													
			BHP	0.99	1.04	1.03												
			Sones	8.3	8.2	8.1												
GB-540-15	1 1/2	235	CFM	20798	18814	16229	12673											
			BHP	1.49	1.57	1.56	1.50											
			Sones	10.1	10.4	10.5	10.6											
GB-540-20	2	259	CFM	22922	21228	18963	16439											
			BHP	1.99	2.09	2.11	2.08											
			Sones	12.3	12.1	11.9	11.6											
GB-540-30	3	296	CFM	26197	24874	22870	20831	18610										
			BHP	2.97	3.11	3.14	3.13	3.10										
			Sones	16.2	15.6	15.3	15.0	14.3										
GB-540-50	5	351	CFM	31064	30005	28492	26810	25115	21376									
			BHP	4.96	5.13	5.21	5.24	5.23	5.15									
			Sones	21	21	19.9	19.3	18.7	17.4									
GB-540-75	7 1/2	402	CFM	35578	34653	33552	32075	30612	27519	24274								
			BHP	7.45	7.65	7.80	7.84	7.87	7.82	7.73								
			Sones	27	26	26	25	24	23	21								
GB-540-100	10	442	CFM	39118	38277	37435	36109	34766	32131	29134	26111							
			BHP	9.90	10.12	10.34	10.39	10.44	10.46	10.36	10.24							
			Sones	32	32	32	32	32	32	28	27	26						
GB-540-150	15	474	CFM	41950	41165	40381	39287	38034	35558	32927	30151	26271						
			BHP	12.21	12.45	12.68	12.80	12.85	12.90	12.84	12.73	12.42						
			Sones	36	36	37	36	35	33	31	30	28						
		505	CFM	44694	43957	43221	42332	41157	38813	36503	33869	31293	26758					
				BHP	14.77	15.02	15.27	15.45	15.51	15.60	15.60	15.48	15.36	14.84				
				Sones	40	40	40	40	39	38	36	35	32	30				

MAXIMUM BHP AT A GIVEN RPM = (RPM/202)³
 MAXIMUM RPM = 505
 TIP SPEED (ft/min.) = RPM x 14.137
 MAXIMUM MOTOR FRAME SIZE = 256T

Performance shown is for installation type A: Free inlet, Free outlet. Power rating (BHP) does not include transmission losses. Performance ratings include the effects of a birdscreen in the airstream. The sound ratings shown are loudness values in fan sones at 5 ft. (1.5 m) in a hemispherical free field calculated per AMCA Standard 301. Values shown are for installation type A: Free inlet fan sone levels.

Specifications

Direct Drive Specifications

Spun aluminum downblast exhaust fans shall be direct drive type. These fans are specifically designed for roof mounted applications exhausting relatively clean air. Performance capabilities range up to 4,300 cfm and up to 1 in. wg of static pressure. The maximum continuous operating temperature shall be 180°F (82°C). Model G fans are available in sixteen sizes with nominal wheel diameters ranging from 7 to 18 inches (060-180 unit sizes).

Each fan shall bear a permanently affixed manufacturer's engraved metal nameplate containing the model number and individual serial number.

All fans shall bear the AMCA Certificated Rating Seal for sound and air performance.

The fan wheel shall be centrifugal non-overloading backward inclined, constructed of aluminum and shall include a wheel cone carefully matched to the inlet cone for precise running tolerances. Wheels shall be statically and dynamically balanced in accordance to AMCA Standard 204-05.

Motors shall be heavy duty ball bearing type, carefully matched to the fan load, and furnished at the specified voltage, phase and enclosure. Motors shall be mounted on vibration isolators, out of the airstream. Fresh air for motor cooling shall be drawn into the motor compartment from an area free of discharge contaminants. Motors shall be readily accessible for maintenance. Vibration isolators shall be double studded with no metal to metal contact. Each vibration isolator shall be sized to match the weight of each fan.

The fan housing shall consist of the motor cover, shroud, curb cap and lower windband and shall be constructed of heavy gauge aluminum. Housing shall have a rigid internal support structure and leak proof design. The fan shroud shall be one piece with a rolled bead for extra strength which directs exhaust air downward. The lower windband shall be one piece with formed edges for added strength and the curb cap shall include prepunched mounting holes to ensure correct attachment to the roof.

A disconnect switch is a positive electrical shut-off and shall be wired from the fan motor to a junction box installed within the motor compartment. Factory standard shall be a NEMA-1 disconnect switch with other NEMA rated options also available. Disconnect switches shall be factory mounted and/or shipped loose for field mounting.

Options and Accessories shall include: birdscreen, curb extension, curb seal, dampers, finishes, hinge kit, hinge base, pressure probe, roof curbs, and tie-down points.

Fans shall be Model G as manufactured by Greenheck Fan Corporation of Schofield, WI.

Belt Drive Specifications

Spun aluminum downblast exhaust fans shall be belt drive type. These fans are specifically designed for roof mounted applications exhausting relatively clean air. Performance capabilities range up to 44,700 cfm and up to 2.5 in. wg of static pressure. The maximum continuous operating temperature shall be 180°F (82°C). Model GB fans are available in twenty sizes with nominal wheel diameters ranging from 11 to 54 inches (071-540 unit sizes).

Each fan shall bear a permanently affixed manufacturer's engraved metal nameplate containing the model number and individual serial number.

All fans shall bear the AMCA Certificated Rating Seal for sound and air performance.

The fan wheel shall be centrifugal non-overloading backward inclined, constructed of aluminum and shall include a wheel cone carefully matched to the inlet cone for precise running tolerances. Wheels shall be statically and dynamically balanced in accordance to AMCA Standard 204-05.

Motors shall be heavy duty ball bearing type, carefully matched to the fan load, and furnished at the specified voltage, phase and enclosure. Drives shall be sized for a minimum of 150 percent of driven horsepower. Motors and drives shall be mounted on vibration isolators, out of the airstream. Fresh air for motor cooling shall be drawn into the motor compartment from an area free of discharge contaminants. Motors shall be readily accessible for maintenance. Vibration isolators shall be double studded or pedestal mount with no metal to metal contact. Each vibration isolator shall be sized to match the weight of each fan.

Fan shafts shall be precision ground and polished solid steel with an anti corrosive coating. Fan shafts shall be mounted in permanently sealed, lubricated pillow block ball bearings. The first critical speed on a fan shaft shall be at least 25 percent over maximum operating speed. Bearings shall be selected for a minimum (L10) life in excess of 100,000 hours (equivalent to L50 average life of 500,000 hours) at maximum cataloged operating speed. All bearings are 100 percent factory tested.

The fan housing shall consist of the motor cover, shroud, curb cap and lower windband and shall be constructed of heavy gauge aluminum. Housing shall have a rigid internal support structure and leak proof design. The fan shroud shall be one piece with a rolled bead for extra strength which directs exhaust air downward. The lower windband shall be one piece with formed edges for added strength and the curb cap shall include prepunched mounting holes to ensure correct attachment to the roof.

Drive frame assemblies shall be constructed of heavy gauge steel and mounted on vibration isolators. Pulleys shall be of the fully machined cast iron type, keyed and securely attached to the wheel and motor shafts. Motor pulleys shall be adjustable for final system balancing.

A disconnect switch is a positive electrical shut-off and shall be wired from the fan motor to a junction box installed within the motor compartment. Factory standard shall be a NEMA-1 disconnect switch with other NEMA rated options also available. Disconnect switches shall be factory mounted and/or shipped loose for field mounting.

Options and Accessories shall include: auto belt tensioner, birdscreen, curb extension, curb seal, dampers, finishes, hinge kit, hinge base, pressure probe, roof curbs, and tie-down points.

Fans shall be Model GB as manufactured by Greenheck Fan Corporation of Schofield, WI.

Our Warranty

Greenheck warrants this equipment to be free from defects in material and workmanship for a period of one year from the purchase date. Any units or parts which prove defective during the warranty period will be replaced at our option when returned to our factory, transportation prepaid. Motors are warranted by the motor manufacturer for a period of one year. Should motors furnished by Greenheck prove defective during this period, they should be returned to the nearest authorized motor service station. Greenheck will not be responsible for any removal or installation costs.

As a result of our commitment to continuous improvement, Greenheck reserves the right to change specifications without notice.



Prepared to Support
Green Building Efforts

