

- LEGEND**
- R - RETURN
  - S - SUCTION
  - MD - BACKWASH
  - TILES
  - DEPTH MARKERS
  - VALVES

**POOL SPECIFICATIONS:**

650 SQ. FT.  
 DEPTH - 3' - 5'  
 GALLONS APPROXIMATELY 20,000  
 SUCTION AND RETURN PIPING = 2" PVC

**POOL EQUIPMENT:**

- 1 - 1.5HP SUPERFLO PUMP
- 1 - 30" SAND FILTER
- 2 - PENTAIR 2" SKIMMERS
- 2 - WATERWAY VGB APPROVED M.D. COVERS
- 1 - 500 WATT LIGHT
- 1 - 3" TRAD LADDER
- 1 - HANDSALEON STEPS
- 1 - 4" DEPTH MARKER WITH FLOATS
- 1 - 30" KING BOX
- 1 - POOL RULE SIGN

**POOL TURNOVER:**  
 RATES 93 GPM  
 APPROXIMATELY EVERY 3 HOURS  
 OR 8 TIMES IN 24 HOURS

**NOTES:**

1. DECKING SHALL BE INSTALLED IN ACCORDANCE WITH LOUISIANA STATE SANITARY CODE, PART XXIV, 323 F.3, G & Q.
2. PRESSURE OR VACUUM GAUGE SHALL BE INSTALLED IN ACCORDANCE WITH LOUISIANA STATE SANITARY CODE, PART XXIV, 503 C-1.
3. ALL DRAIN INLETS SHALL DISCHARGE 1'0" TO 1'5" BELOW THE SURFACE OF THE WATER IN ACCORDANCE WITH LOUISIANA STATE SANITARY CODE, PART XXIV, 511 B-1.
4. DEPTH MARKERS SHALL BE PLACED IN ACCORDANCE WITH LOUISIANA STATE SANITARY CODE, PART XXIV, 701 A, 1-4 AND 9. IN ADDITION TO THE MARKINGS SHOWN, ADDITIONAL MARKERS SHALL BE LEGIBLE FROM INSIDE THE POOL.
5. THERE WILL BE NO PHYSICAL CONNECTION BETWEEN THE POOL OR POOL PUMP AND THE POTABLE WATER SYSTEM IN ACCORDANCE WITH LOUISIANA STATE SANITARY CODE, PART XXIV, 707 A AND 709 B.
6. THERE WILL BE NO PHYSICAL CONNECTION BETWEEN THE POOL DRAINAGE SYSTEM AND BACKWASH FILTER SYSTEM WITH THE LOCAL SEWER AND DRAINAGE SYSTEMS IN ACCORDANCE WITH LOUISIANA STATE SANITARY CODE, PART XXIV, 511 D.
7. THE DISINFECTANT FACILITY SHALL BE INSTALLED IN ACCORDANCE WITH THE LOUISIANA STATE SANITARY CODE, PART XXIV, 901 A, AND 903 A.
8. POOL FILLING SHALL BE ACCOMPLISHED MANUALLY WITH A GARDEN HOSE. DURING FILLING OPERATIONS, THE HOSE SHALL NOT BE SUBMERGED TO PREVENT CROSS CONNECTIONS IN ACCORDANCE WITH LOUISIANA STATE SANITARY CODE.

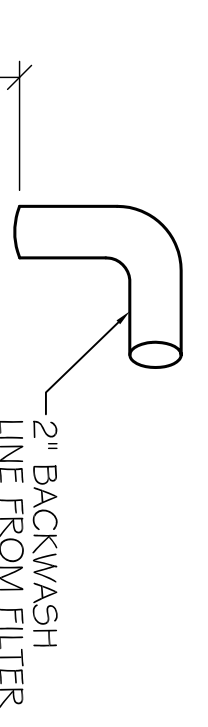
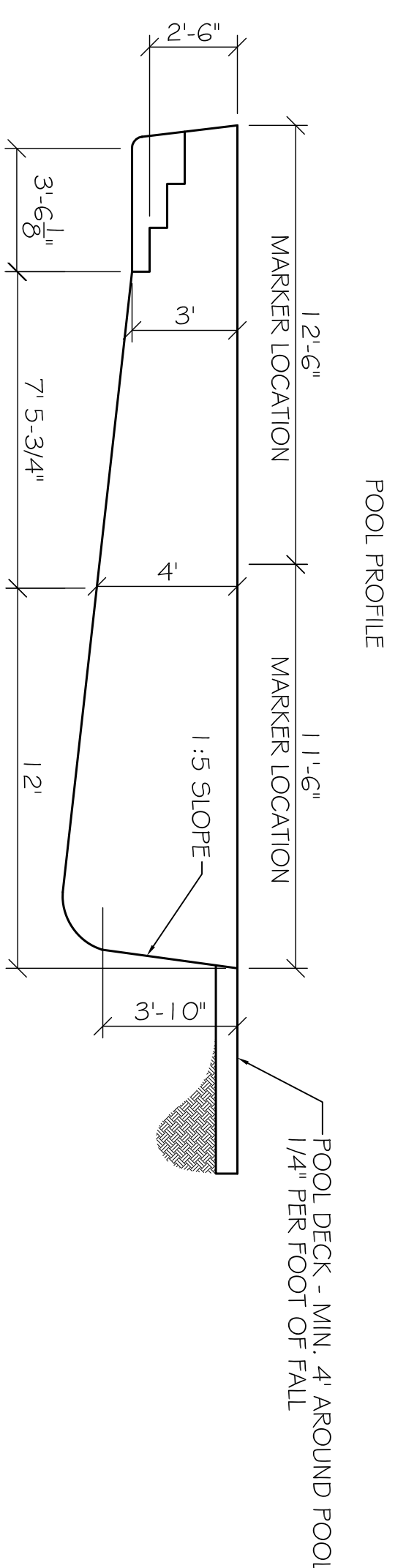
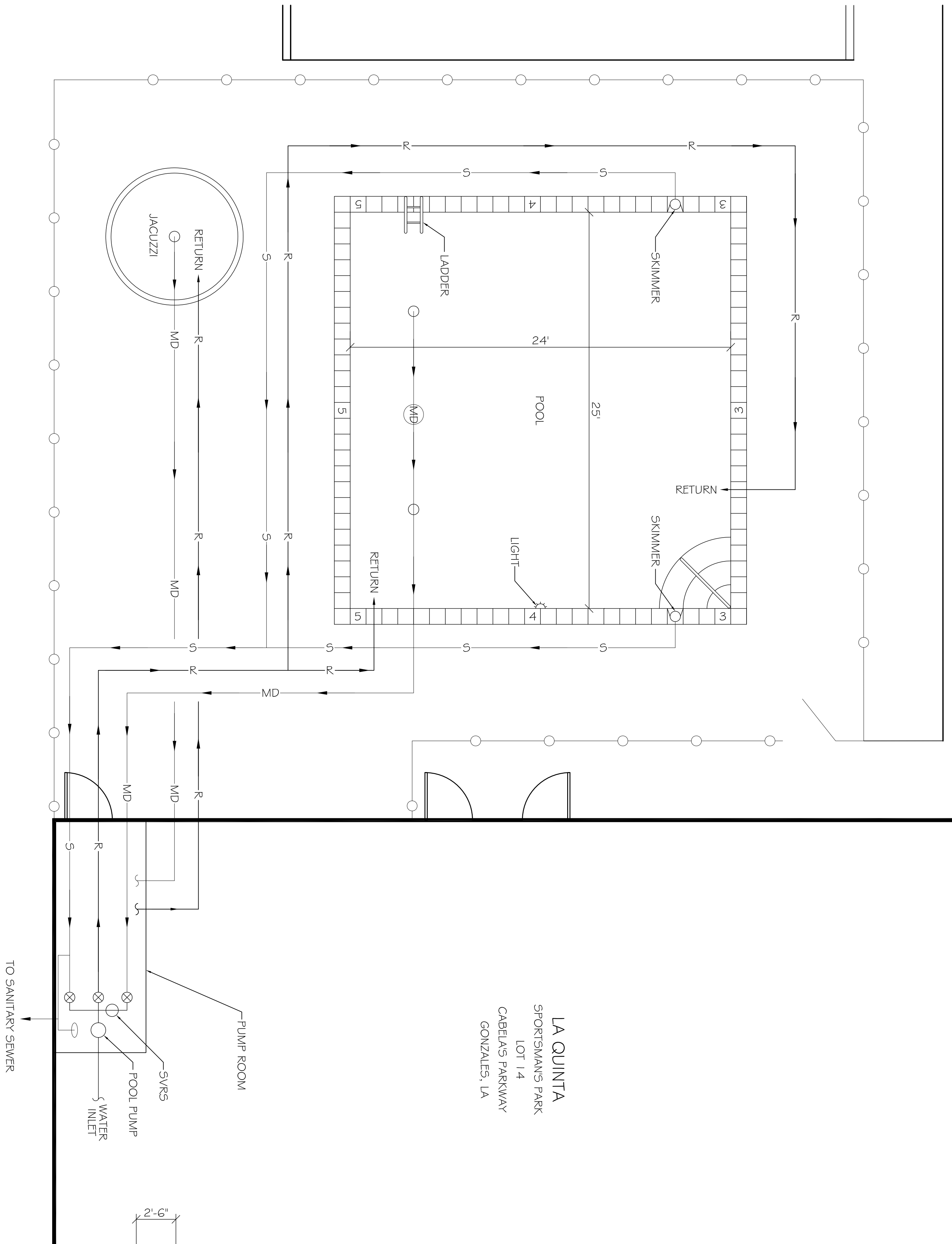

**POOL PLAN**  
 SCALE: 1/4" = 1'-0"

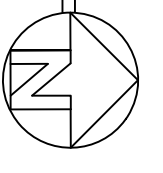

**LA QUINTA INNS AND SUITES**  
**MIKE TEDESCO**  
 SPORTSMANS PARK  
 LOT 14 CABELAS PARKWAY  
 GONZALES, LA

JOB No: DATE: 08-21-2012  
 DRAWN BY: BSN CHECKED BY: BSN



**DAMMON ENGINEERING, INC.**  
 Architects & Engineers

CHIEF ENGINEER: EMMETT DAMMON, P.E.  
 CHIEF ARCHITECT: ROBERT WILTSE  
 554 OLD SPANISH TRAIL  
 SLIDELL, LA 70458

dammoneengineering.com  
 dammoneng@bellsouth.net  
 PHONE: 985-649-5832  
 FAX: 985-641-5950

REVISIONS		DATE
#	DESCRIPTION	

**POOL PLAN**

SHEET No: 01 OF 01

**P-1**