

**UTILITIES AND GOVERNING  
AUTHORITIES CONTACT LIST:**

COUNTY OF PEARL RIVER  
COUNTY ADMINISTRATOR  
ADRAIN LUMPKIN, ADMINISTRATOR  
200 JULIA STREET  
POPLARVILLE, MS 39470  
601 403 2300 PHONE  
ALUMPKIN@PEARLRIVERCOUNTY.NET

PLANNING AND DEVELOPMENT  
LINDSAY WARD, DIRECTOR  
200 JULIA STREET  
POPLARVILLE, MS 39470  
601 749 7780 PHONE  
LWARD@PEARLRIVERCOUNTY.NET

SOUTHERN DISTRICT COMMISSIONER  
DANE MAXWELL, COMMISSIONER  
200 JULIA STREET  
POPLARVILLE, MS 39470  
601 961 5440 PHONE

SEWER & WATER  
JAMES DOWNES, PRESIDENT  
PO BOX 309  
NICHOLSON, MS 39463  
601 798 9696 PHONE  
CNELSON@PEARLRIVERCOUNTY.NET

EMERGENCY MANAGEMENT DIRECTOR  
DAN MANLEY, DIRECTOR  
PO BOX 309  
NICHOLSON, MS 39463  
601 795 3058 PHONE

E-911 ADDRESSING  
CAROLYN NELSON  
402 S MAIN STREET  
POPLARVILLE, MS 39470  
601 403 2300 PHONE  
601 749 7700 PHONE  
CNELSON@PEARLRIVERCOUNTY.NET

MODEP  
DANIEL ANDERSON  
PO BOX 2261  
JACKSON, MS 39225  
601 961 5148 PHONE

MDOOT - DISTRICT 6  
KELLY CASTELBERRY, DISTRICT ENGINEER  
401 NORTH WEST STREET  
JACKSON, MS 39201  
601 544 6511 PHONE  
STEVEN PARKER, PERMIT ENGINEER  
601 544 6511 PHONE

NICHOLSON WATER & SEWER ASSOCIATION  
JAMES DOWNES, PRESIDENT  
PO BOX 309  
NICHOLSON, MS 39463  
601 798 9696 PHONE  
JACOB SMITH, PE  
601 9287390 PHONE  
601 528 0424 CELL PHONE  
JACOB@ONEALBONDENG.COM

WATER UTILITIES  
JUDY PATCH  
PO BOX 309  
NICHOLSON, MS 39463  
601 798 9696 PHONE

ELECTRIC UTILITIES  
RANDY WALLACE GEN. MGR  
PO BOX 1217  
COLUMBIA, MS 39429  
601 736 2666 PHONE

COOPERATIVE ENERGY  
JAMES COMPTON, CEO  
PO BOX 15849  
HATTIESBURG, MS 39404  
601 268 2083 PHONE

GAS - CENTERPOINT ENERGY RESOURCES CORP  
CHRISTIE SINGLETON  
525 MILAM STREET 14<sup>TH</sup> FLOOR  
SHREVEPORT, LA 71101  
501 377 4740 PHONE

ATT  
DAVID GODBOLD  
601 620 8497 PHONE  
06879R@ATT.COM  
TIM SOLLIE PE  
601 693 8871 PHONE  
604 479 9106 CELL PHONE  
T57547@ATT.COM

**SHEET INDEX:**

C1.0	COVER SHEET
C1.1	NOTES
C2.0	DEMOLITION PLAN
C3.0	OVERALL SITE PLAN
C4.1	SWPPP - PHASE I
C4.2	SWPPP - PHASE II
C4.3	SWPPP - PHASE III
C4.4	SWPPP DETAILS
C4.5	SWPPP DETAILS
C5.0	SITE PLAN MAIN
C5.1	DRIVEWAY PLAN
C6.0	OVERALL PAVEMENT PLAN
C7.0	GRADING PLAN
C7.1	LOVE'S GRADING DETAIL
C7.2	TIRESHOP GRADING DETAIL
C7.3	CANOPY GRADING
C7.4	STORMWATER MANAGEMENT SYSTEM
C8.0	UTILITY PLAN
C9.0	SITE DETAILS
C9.1	PAVEMENT DETAILS
C9.2	PAVEMENT DETAILS
C9.3	GRADING DETAILS
C9.4	UTILITY DETAILS
C9.5	UTILITY DETAILS
C9.6	SITWORK SPECIFICATIONS
C9.7	SITWORK SPECIFICATIONS
C9.8	SITWORK SPECIFICATIONS
L1.0	LANDSCAPE PLAN
IR1.0	IRRIGATION DETAILS

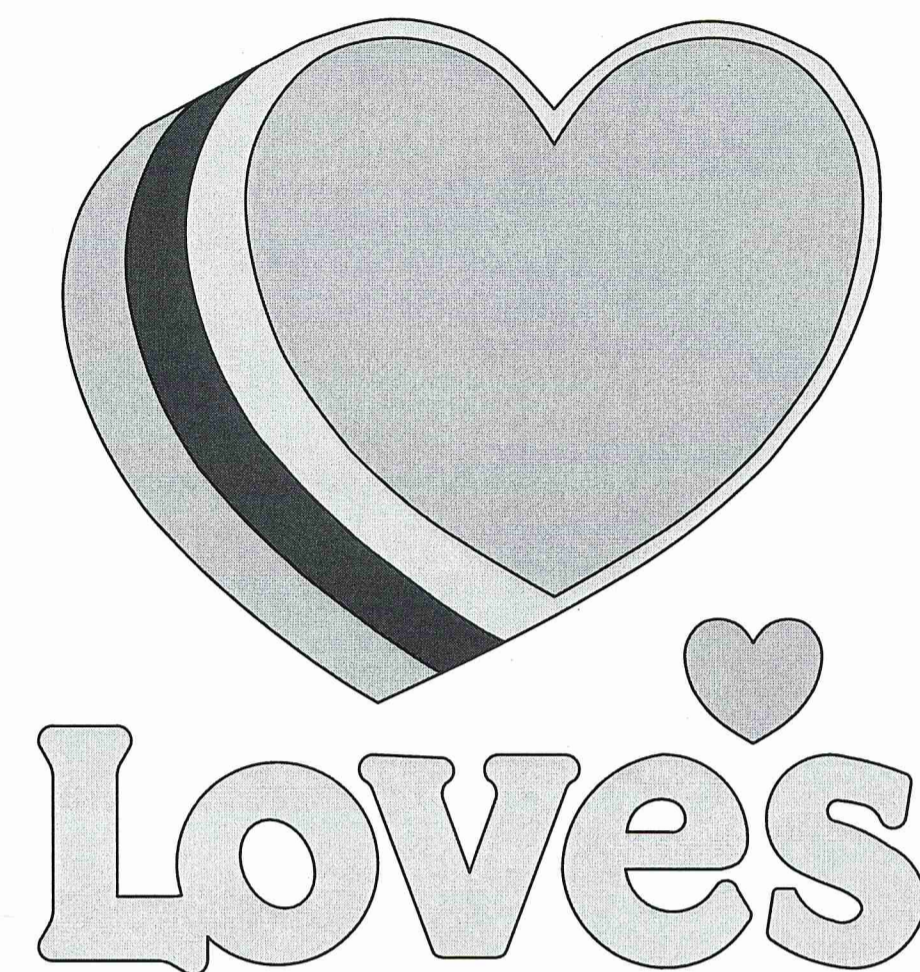

# PROPOSED LOVE'S TRAVEL STOP

**INTERSTATE 59 EXIT 1 @ MS HIGHWAY 607  
PEARL RIVER COUNTY, MISSISSIPPI**



3/1/23  
Jessie Marsh

developer:  
**Love's Travel StoSO  
& Country Stores, Inc.**  
Post Office Box 26210  
Oklahoma City, Ok 73126  
(405) 749 1744 telephone  
(405) 749 9122 telefax

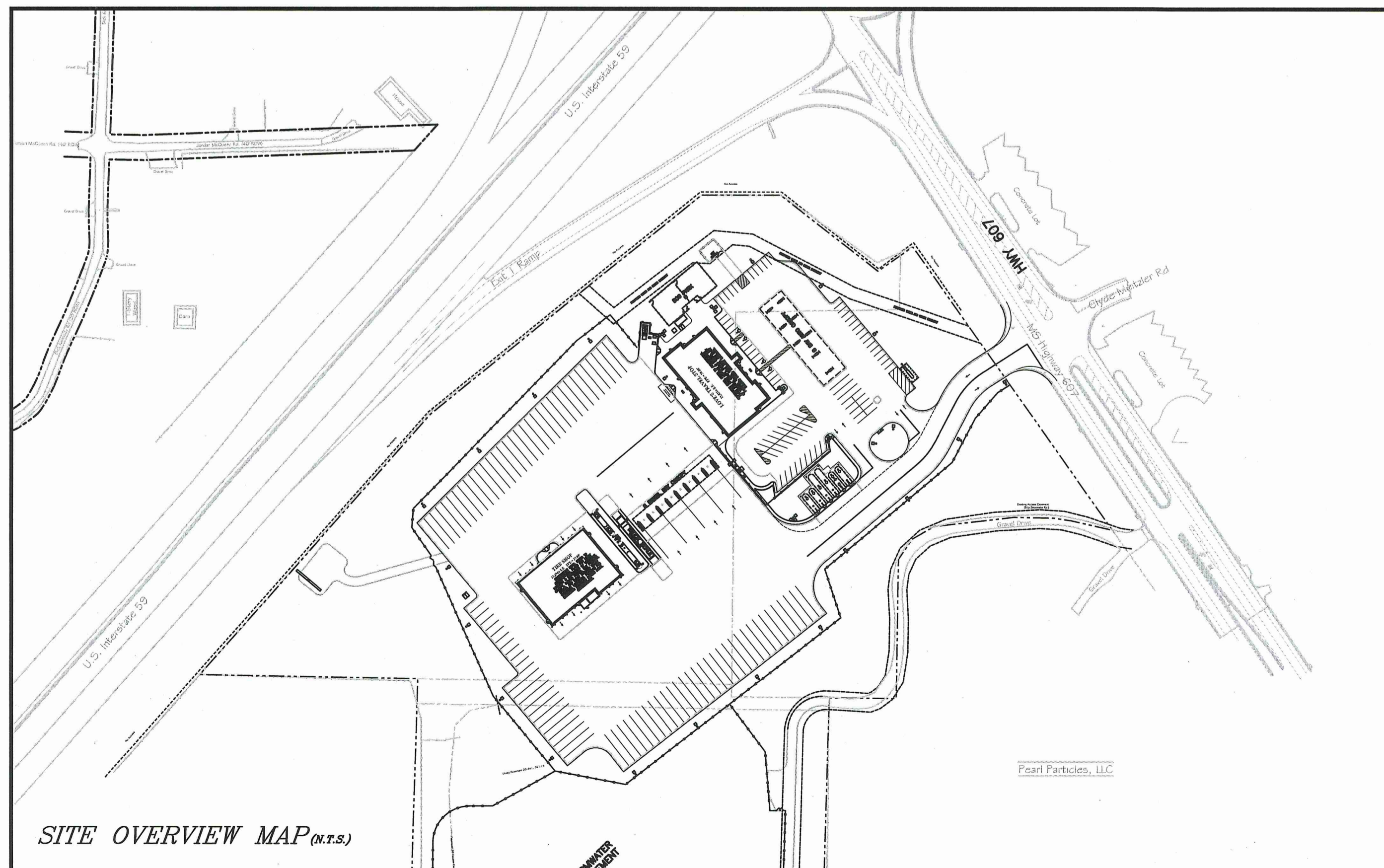
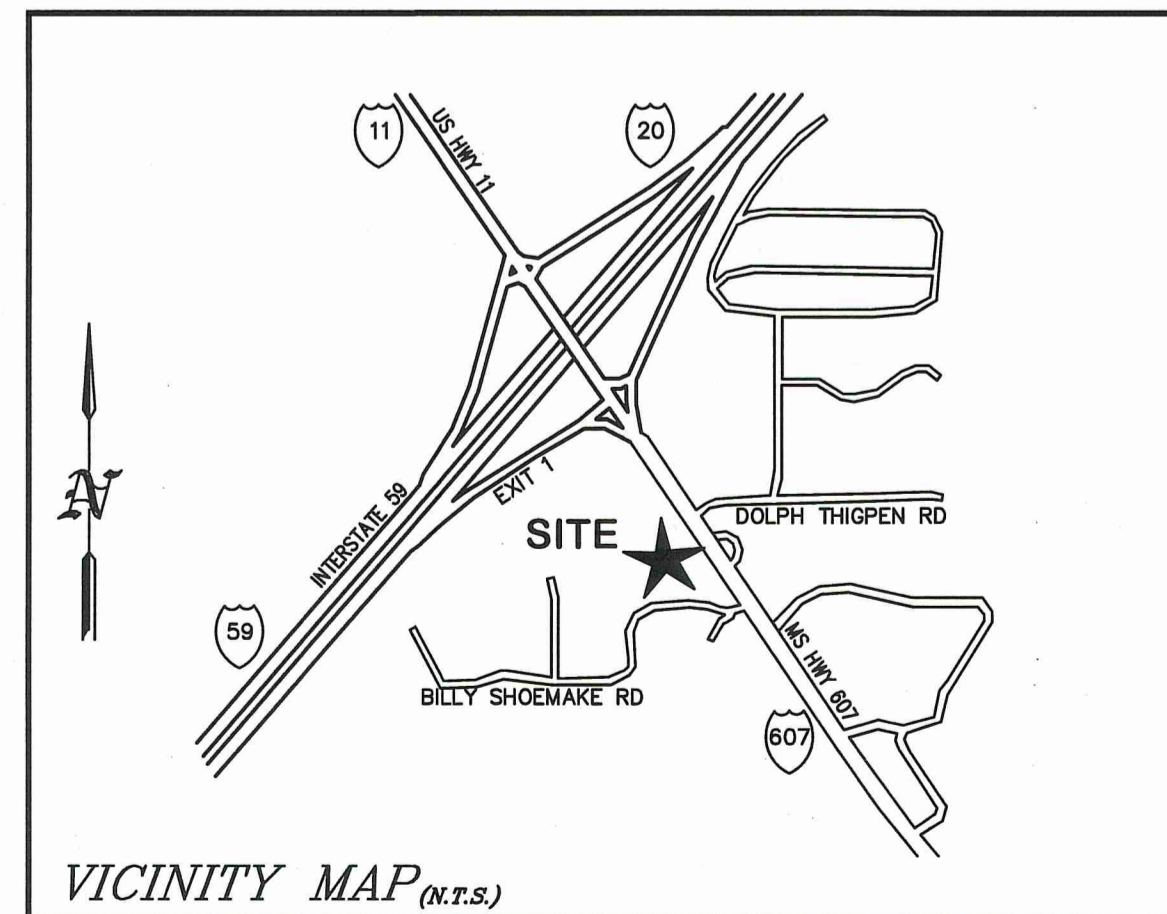

Know what's below.  
Call before you dig.

- NOTES:
1. THE SITWORK FOR THIS PROJECT SHALL MEET OR EXCEED THE SITWORK SPECIFICATIONS.
  2. ALL NECESSARY INSPECTIONS AND/OR CERTIFICATIONS REQUIRED BY CODES AND/OR UTILITY SERVICE COMPANIES SHALL BE PERFORMED PRIOR TO ANNOUNCED BUILDING POSSESSION AND THE FINAL CONNECTION OF SERVICES.



**RESOURCECONSULTING**  
CIVIL ENGINEERING  
6700 Jefferson Highway - Resource Suite 4A  
Baton Rouge, Louisiana 70805  
ResourceConsulting@hotmail.com  
Tel: (225) 761-9909, Fax: (225) 766-6672

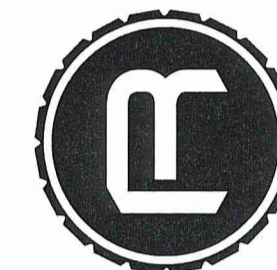

**LOVE'S TRAVEL STOP**  
INTERSTATE 59 EXIT 1 @ MS HIGHWAY 607  
PEARL RIVER COUNTY, MISSISSIPPI