

LEGEND FOR PROPOSED IMPROVEMENTS

- PROPERTY LINE / R.O.W.
- PROPOSED BUILDING
- PROPOSED TYPE III SILT FENCE
- PROPOSED CURB AND GUTTER
- LIMITS OF DISTURBANCE
- PROPOSED INLET
- PROPOSED CURB INLET
- PROPOSED STORM SEWER
- INLET PROTECTION
- STORM DRAIN OUTLET PROTECTION
- STABILIZATION - SOD
- STABILIZATION - PERMANENT VEGETATION
- STABILIZATION - TEMPORARY VEGETATION
- FAIRCLOTH SKIMMER
- SEDIMENT BASIN
- CONSTRUCTION ENTRANCE
- ROCK CHECK DAM
- BoB** BOWIE FINE SANDY LOAM
- CfE** CUTHBERT FINE SANDY LOAM
- Kfc** KIRVIN VERY FINE SANDY LOAM
- LtC** LILBERT LOAMY FINE SAND
- ESTIMATED FLOW DIRECTION
- PROPOSED EXTRA HEAVY DUTY ASPHALT PAVEMENT
- PROPOSED HEAVY DUTY ASPHALT PAVEMENT
- PROPOSED MEDIUM DUTY ASPHALT PAVEMENT
- PROPOSED LIGHT DUTY ASPHALT PAVEMENT
- PROPOSED EXTRA HEAVY DUTY CONCRETE PAVEMENT
- PROPOSED HEAVY DUTY CONCRETE PAVEMENT
- PROPOSED LIGHT DUTY CONCRETE PAVEMENT
- PROPOSED ROADWAY WIDENING ASPHALT PAVEMENT
- PROPOSED GRAVEL DRIVEWAY

EXISTING LEGEND

- SUBJECT PROPERTY BOUNDARY LINE
- ADJACENT BOUNDARY LINES
- OLD WIRE FENCE
- "40" LINES
- LIMITS OF EASEMENT
- BURIED FIBER OPTIC LINE
- OVERHEAD UTILITY LINES
- MAJOR CONTOUR
- MINOR CONTOUR
- DRAINAGE PIPE
- SIGNIFICANT DRAINAGE FLOWLINE
- APPROXIMATE FLOOD ZONE LOCATION
- NO HIGHWAY ACCESS
- PAINT STRIPE
- 1/2" IRON REBAR SET
- IRON PIN FOUND
- FENCE CORNER FOUND
- UTILITY POLE
- AP5** AS PER SURVEY
- APR** AS PER RECORD
- ROW** RIGHT-OF-WAY
- CG2** CONTOUR ELEVATION
- RCP** REINFORCED CONCRETE PIPE
- CMP** CORRUGATED METAL PIPE
- ROAD SIGN POST

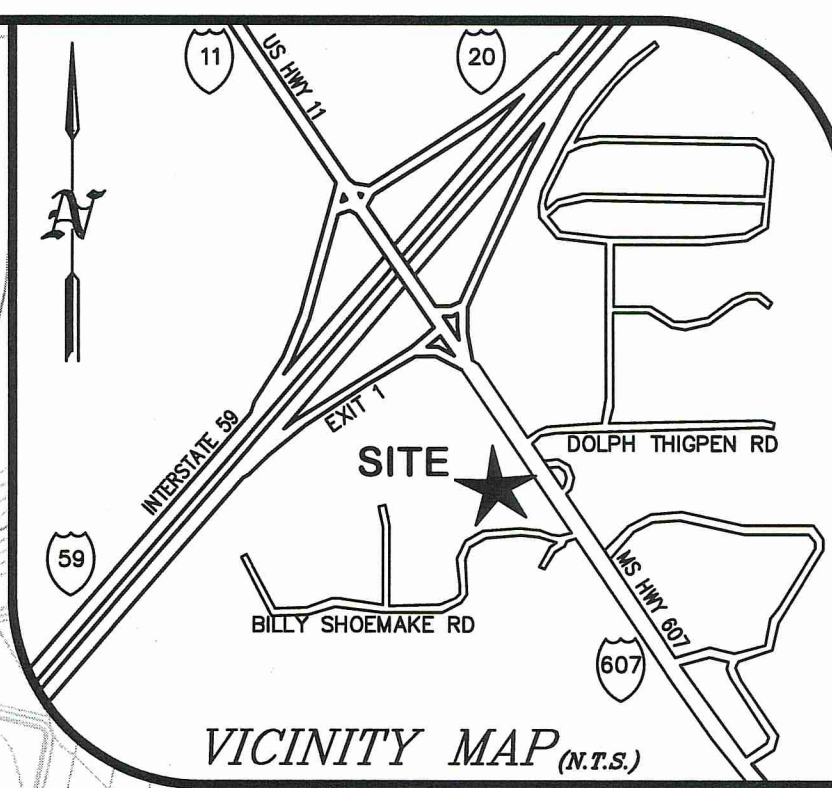
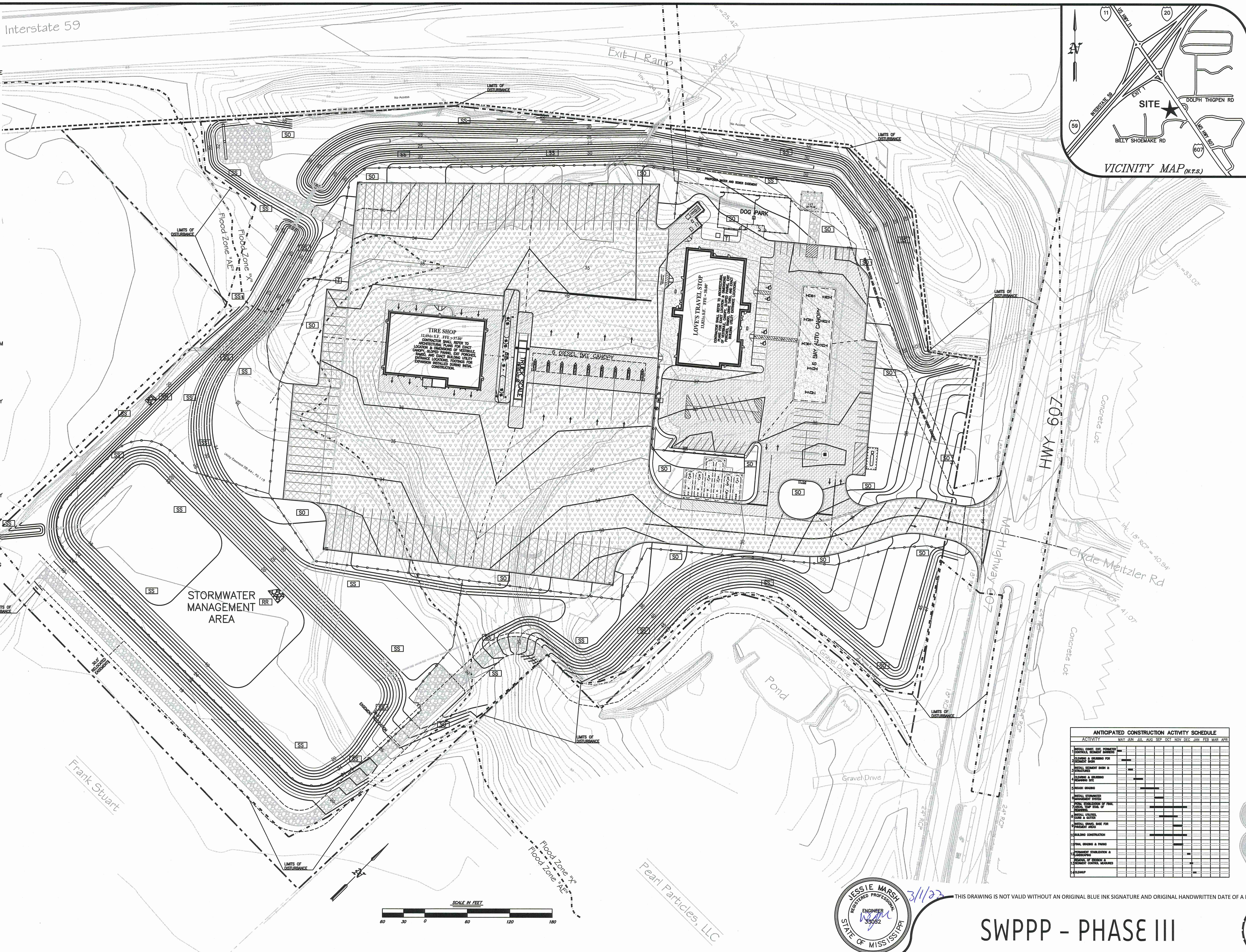

ANTICIPATED CONSTRUCTION ACTIVITY SCHEDULE

| ACTIVITY | MAY | JUN | JUL | AUG | SEP | OCT | NOV | DEC | JAN | FEB | MAR | APR |
|-------------------|-----|-----|-----|-----|-----|-----|-----|-----|-----|-----|-----|-----|
| PERMITTING | | | | | | | | | | | | |
| UTILITY LOCATIONS | | | | | | | | | | | | |
| CONSTRUCTION | | | | | | | | | | | | |
| PAVEMENT | | | | | | | | | | | | |
| LANDSCAPING | | | | | | | | | | | | |

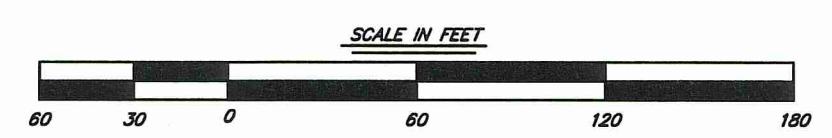

THIS DRAWING IS NOT VALID WITHOUT AN ORIGINAL BLUE INK SIGNATURE AND ORIGINAL HANDWRITTEN DATE OF A LICENSED PROFESSIONAL ENGINEER.

SWPPP - PHASE III

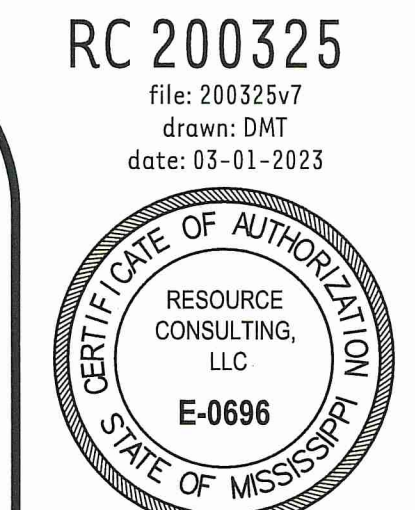

RESOURCE CONSULTING
 CIVIL ENGINEERING
 6700 Jefferson Highway - Resource Suite 4A
 Baton Rouge, Louisiana 70806
 ResourceConsulting@hotmail.com
 Tel. (225) 761-9909, Fax (225) 766-6672

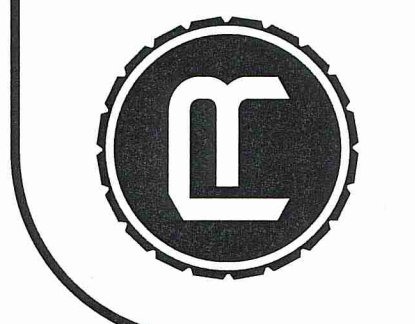

LOVE'S TRAVEL STOP
 INTERSTATE 59 EXIT 1 @ MS HIGHWAY 607
 PEARL RIVER COUNTY, MISSISSIPPI



K:\200325 - Pearl River County MS Love's 1-59 @ MS Hwy 607 SWPPP Phase III.dwg, C:\3 SWPPP PHASE III.dwg, 3/1/2023 4:35:50 PM, Leslie, Resource Consulting, LLC copyright.

