

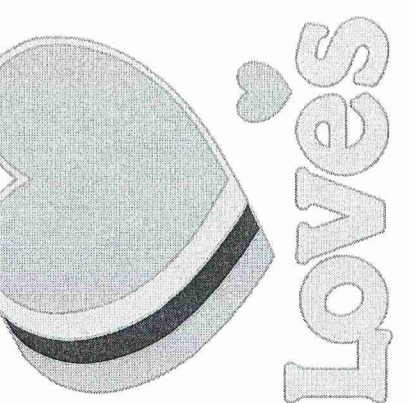

RESOURCECONSULTING
CIVIL ENGINEERING
6700 Jefferson Highway - Resource Suite 4A
Baton Rouge, Louisiana 70806
ResourceConsulting@hotmail.com
Tel: (225) 751-9909; Fax: (225) 766-6672



LOVE'S TRAVEL STOP
INTERSTATE 59 EXIT 1 @ MS HIGHWAY 607
PEARL RIVER COUNTY, MISSISSIPPI



C9.1

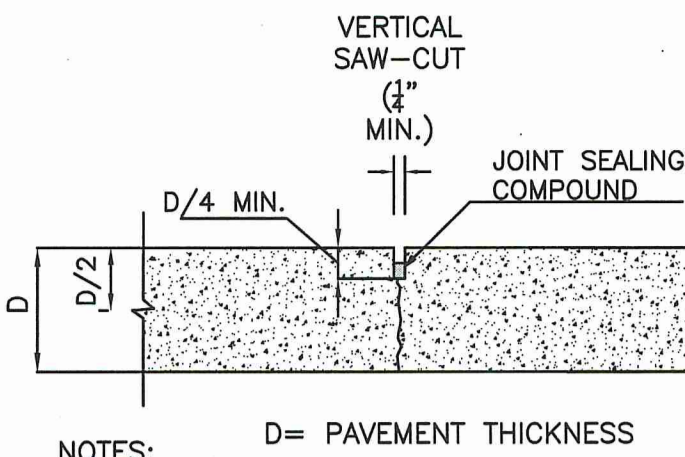

- NOTES:**
1. MAXIMUM CONTRACTION JOINT SPACING IS DEPENDENT UPON THE PAVEMENT THICKNESS. REFER TO TABLE BELOW FOR SPACING REQUIREMENTS.
 2. ENSURE CONTRACTION JOINT PATTERNS DIVIDE PAVEMENT INTO PANELS AS CLOSE TO SQUARE AS POSSIBLE.

CONTRACTION JOINT DETAIL
N.T.S.

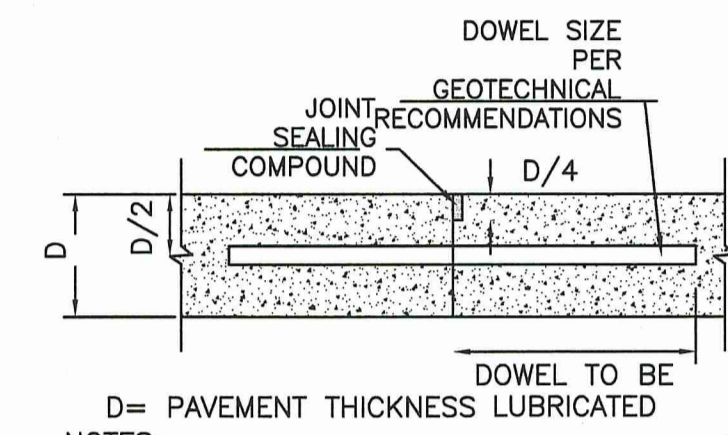

- NOTES:**
1. DOWELS SHALL BE SUPPORTED BY AN APPROVED DEVICE.
 2. ALL BARS AND BASKETS SHALL BE EPOXY COATED.
 3. DOWELED CONTRACTION JOINTS ARE REQUIRED WHERE PAVEMENT DEPTH IS 7" OR GREATER.
 4. DOWELS SHALL BE SMOOTH BARS AND FREE MOVEMENT SHALL BE PROVIDED BY APPLYING A COATING OF GREASE AS A BOND-BREAKING MATERIAL JUST PRIOR TO PLACING THE CONCRETE.

DOWELED CONTRACTION JOINT DETAIL
N.T.S.

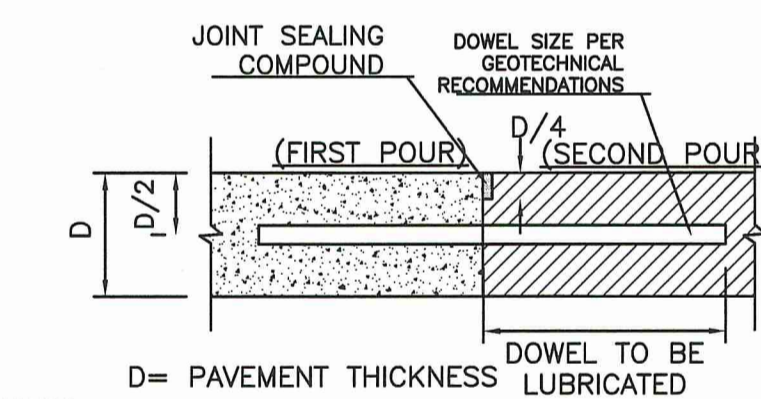

- NOTES:**
1. DOWELS SHALL BE SUPPORTED BY AN APPROVED DEVICE.
 2. ALL BARS AND BASKETS SHALL BE EPOXY COATED.
 3. PLACE CONSTRUCTION JOINTS AT END OF PLACEMENTS AND AT LOCATIONS WHERE PLACEMENT OPERATIONS ARE STOPPED FOR A PERIOD OF MORE THAN 1/2 HOUR.
 4. DOWELS SHALL BE SMOOTH BARS AND FREE MOVEMENT SHALL BE PROVIDED BY APPLYING A COATING OF GREASE AS A BOND-BREAKING MATERIAL JUST PRIOR TO PLACING THE CONCRETE.
 5. IN EMERGENCY SITUATIONS SUCH AS LACK OF MATERIALS, SUDDEN CHANGES IN WEATHER, OR EQUIPMENT BREAKDOWN, A CONSTRUCTION JOINT SHOULD BE INSTALLED IN PLACE OF THE NEAREST CONTRACTION JOINT LOCATION.
 6. CONSTRUCTION JOINTS ARE NOT TO BE LOCATED CLOSER THAN 10'-0" TO ANOTHER PARALLEL JOINT.
 7. WHERE SLABS OF DIFFERENT THICKNESSES COME TOGETHER AT JOINTS, THE SUBGRADE/SUBBASE UNDER THE THINNER PAVEMENT SECTIONS SHOULD BE SHAPED TO PROVIDE GRADUAL THICKNESS TRANSITION OVER A DISTANCE OF 4 FT OR MORE.

CONTRACTION JOINT DETAIL
N.T.S.

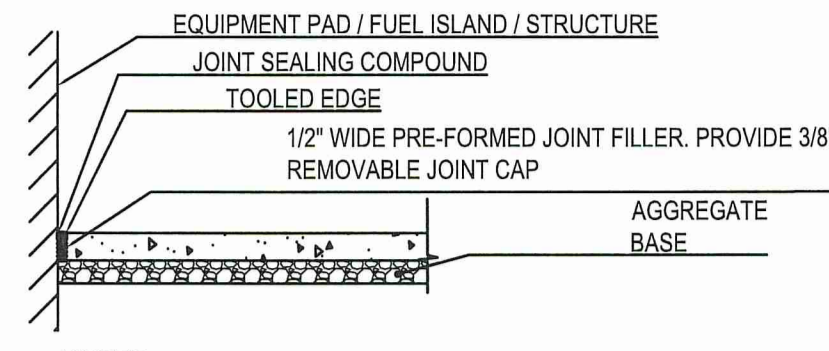

- NOTES:**
1. PLACE ISOLATION JOINTS WHERE CONCRETE PAVEMENT ABUTS SLABS, FUEL ISLANDS, CANOPY COLUMNS, BOLLARDS AND STRUCTURES OR FIXED OBJECTS.
 2. PRE-FORMED JOINT FILLER - NON-IMPREGNATED TYPE, CLOSED CELL RESILIENT POLYETHYLENE FOAM, 1/2" THICK UNLESS OTHERWISE NOTED.
 3. WHERE SLABS OF DIFFERENT THICKNESSES COME TOGETHER AT ISOLATION JOINTS, THE SUBGRADE/SUBBASE UNDER THE THINNER PAVEMENT SECTIONS SHOULD BE SHAPED TO PROVIDE GRADUAL THICKNESS TRANSITION OVER A DISTANCE OF 4 FT OR MORE.

ISOLATION JOINT DETAIL
N.T.S.

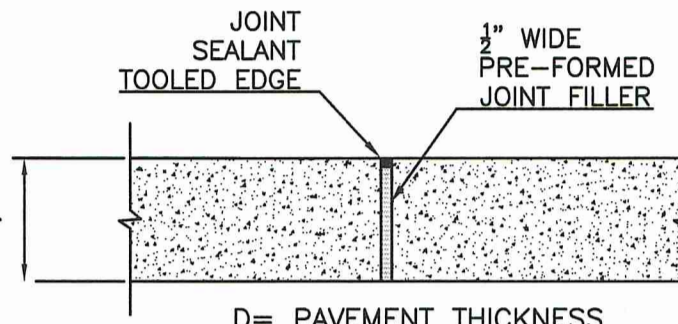

EXPANSION JOINT DETAIL
N.T.S.

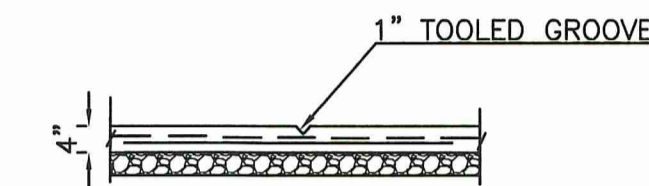
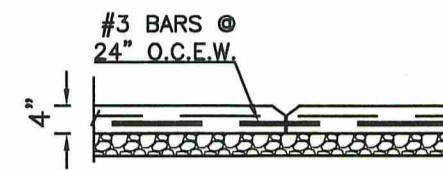
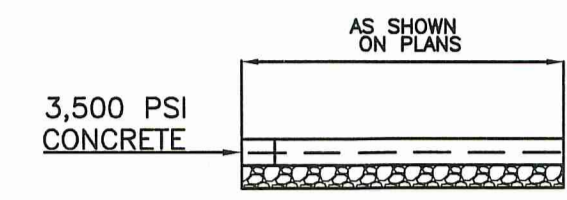
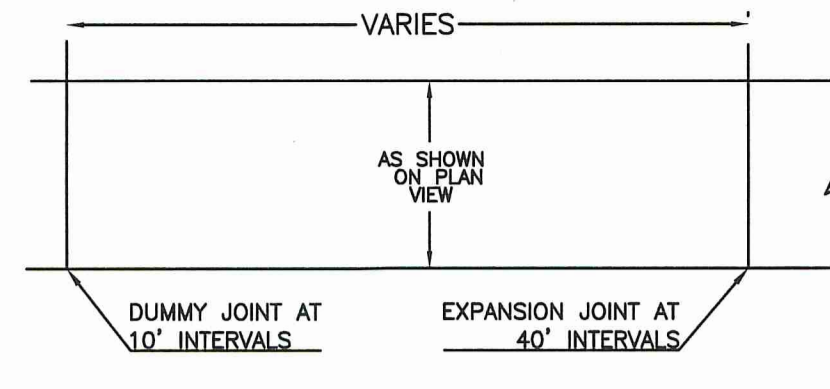

SIDEWALK DETAIL
N.T.S.

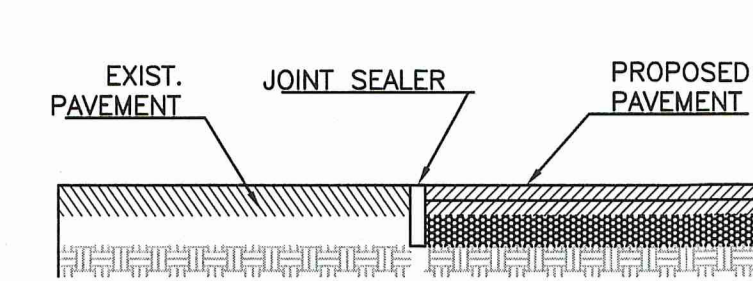

- NOTES:**
1. PROPOSED PAVEMENT TO MATCH ELEVATION OF EXISTING PAVEMENT. SAW CUT EXISTING PAVEMENT AS NECESSARY TO OBTAIN A FULL DEPTH SEAL BETWEEN PAVEMENT AND THE EXISTING PAVEMENT.

PAVEMENT TRANSITION DETAIL
N.T.S.

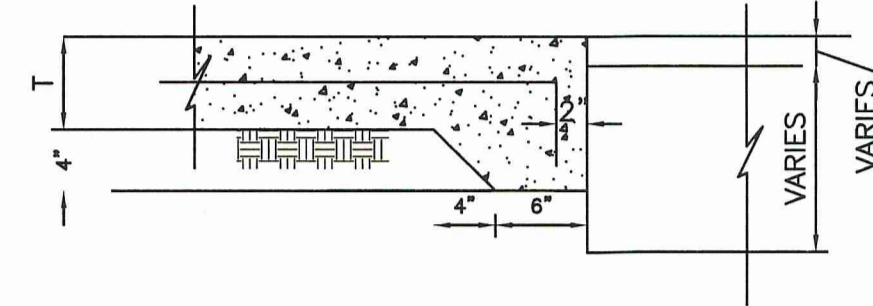

CONCRETE TO ASPHALT STANDARD PAVING DETAIL
N.T.S.

- SIDEWALK JOINT NOTES**
1. ALL JOINTS TO BE SEALED TO BE THOROUGHLY CLEANED BY HYDROBLASTING AND/OR SAND BLASTING METHODS. THE JOINTS ARE TO BE FREE FROM ALL DUST COATINGS, ANY CONTAMINATES, AND FREE FROM ALL MOISTURE THAT MIGHT INTERFERE WITH THE PROPER AND SATISFACTORY BONDING OF THE JOINT SEALANT MATERIAL. THE JOINT WILL BE BLOWN OUT WITH DRY COMPRESSED AIR IMMEDIATELY PRIOR TO APPLYING SEALANT.
 2. CONSTRUCTION EQUIPMENT AND OTHER VEHICLES AND PEDESTRIANS WHICH MAY CAUSE DAMAGE TO THE JOINTS SHALL NOT BE ALLOWED ON THE PAVEMENT & SIDEWALKS BEFORE THE JOINT SEALANT BECOMES TACK FREE.
 3. USE 3/4" X 4" EXPANSION JOINT MATERIAL ALONG SIDEWALK CURB AND ALONG BUILDING.
 4. USE 3/4" X 4" EXPANSION JOINT MATERIAL AROUND POLES OR OTHER OBSTRUCTIONS IN WALK AND FOR JOINTS SHOWN AS EXPANSION JOINT ON THE PLAN VIEW OF THE SITE.
 5. SAW CUT JOINTS NOT ALLOWED. USE DEEP TOOLED JOINTS.
 6. SIDEWALK EXPANSION JOINTS ARE NOT DOWELED.

- JOINT SEALANT NOTES**
- **JOINT SEALERS FOR SIDEWALKS SHALL CONFORM TO THE FOLLOWING:**
- (1) LOW MODULUS SILICONE JOINT SEALANT, MACHINE EXTRUDED OR APPLIED BY GUN. GREY IN COLOR.
 - (2) LOW MODULUS SILICONE JOINT SEALANT, MACHINE EXTRUDED OR APPLIED BY GUN. FOR SLAB, SEALANT SHALL BE DOW CORNING 890 SL, DOW CORNING 888 OR EQUAL (JOINT MUST BE TOOLED). FOR CURBS, SEALANT SHALL BE DOW CORNING 888 OR EQUAL (JOINT MUST BE TOOLED).

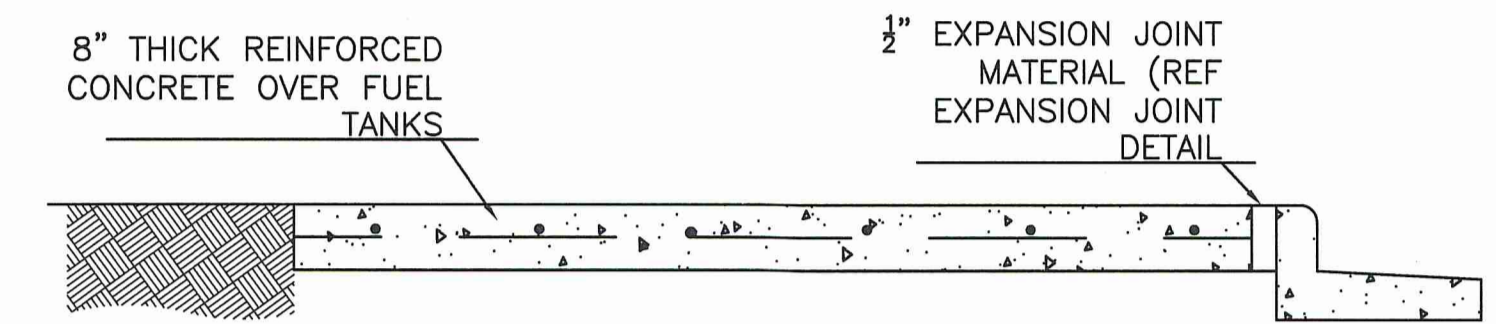

TYPICAL SECTION THROUGH PAVING OVER FUEL TANKS
N.T.S.

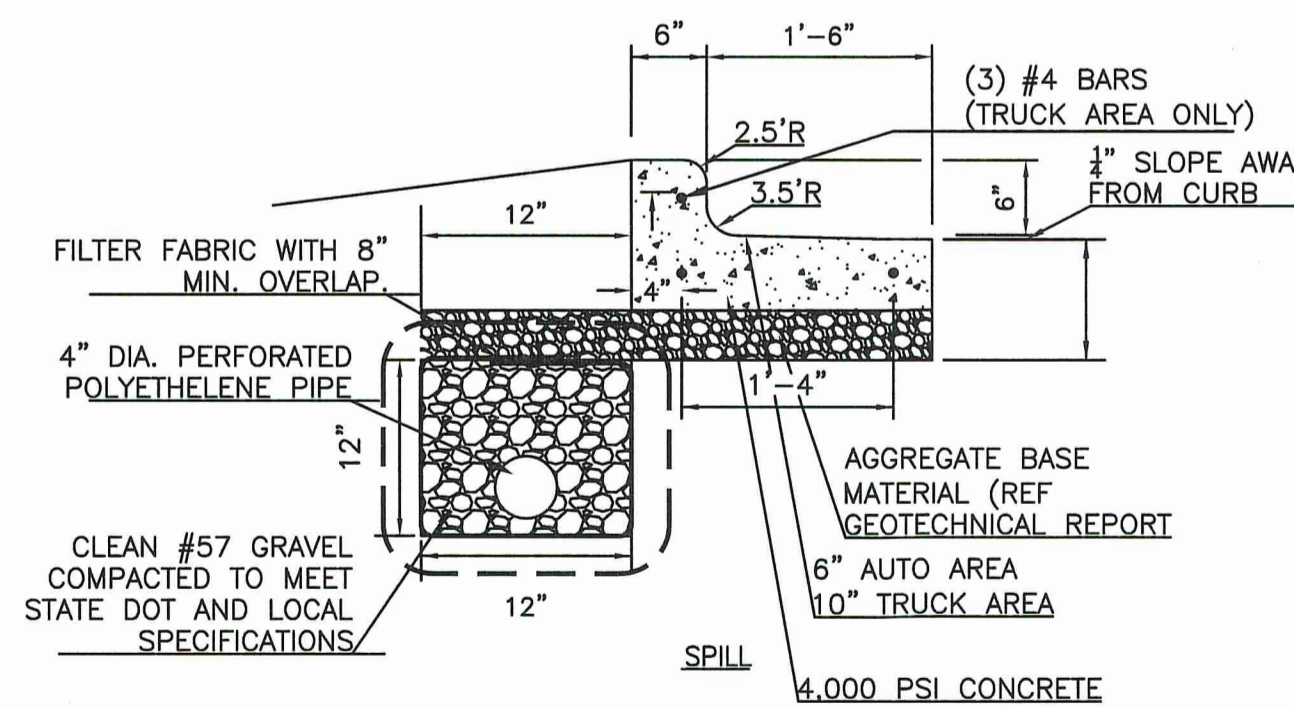
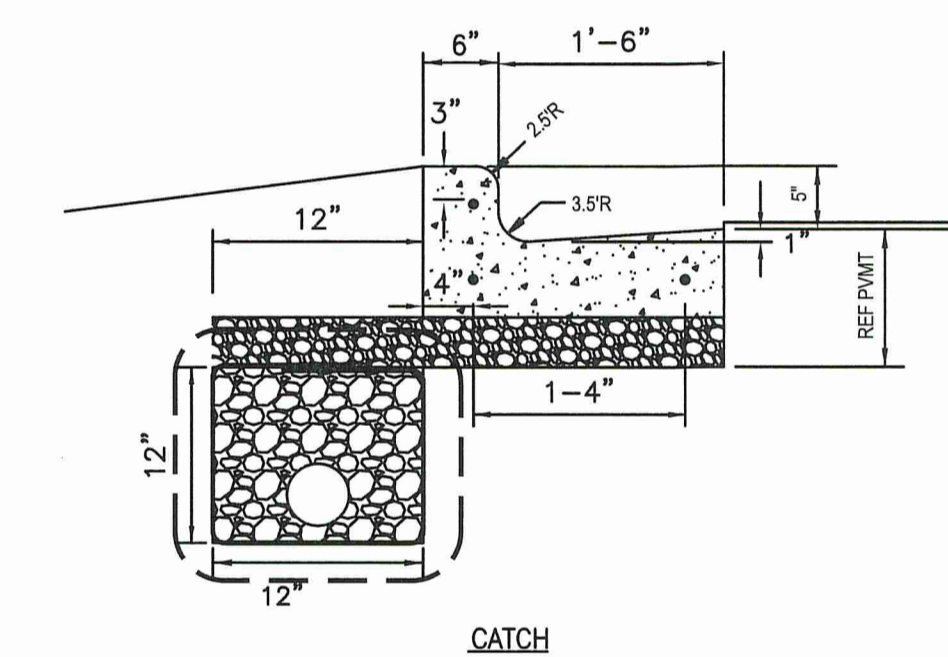

CONCRETE CURB AND GUTTER DETAIL
N.T.S.

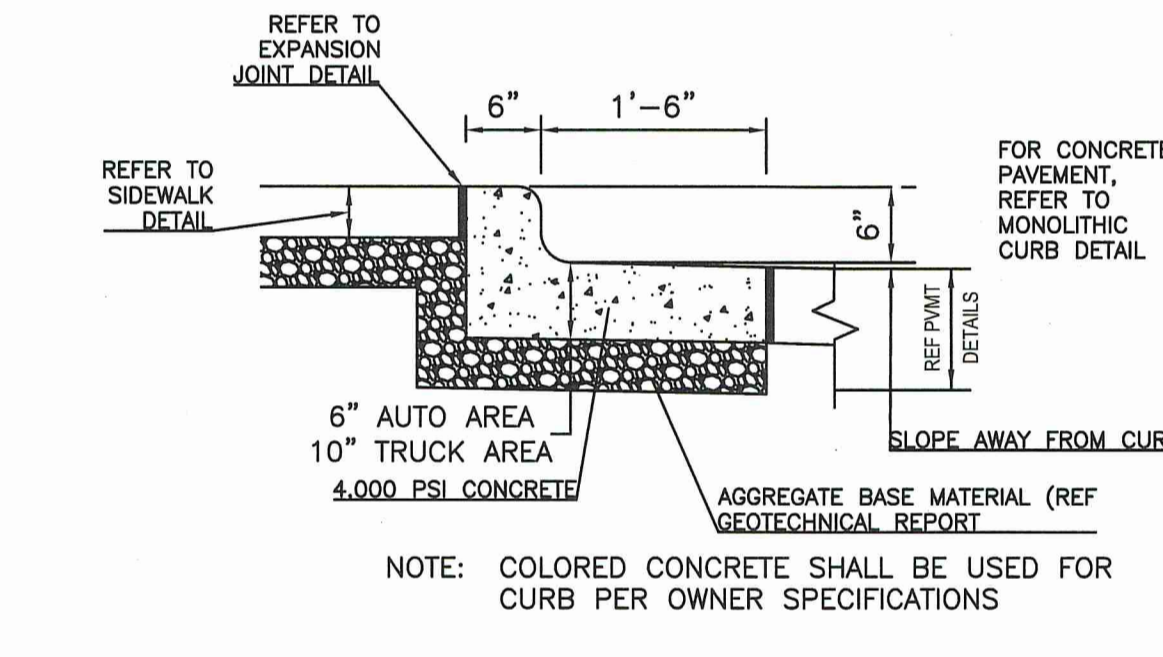

6" MONOLITHIC CONCRETE CURB DETAIL
N.T.S.

INSTALL UNDERDRAIN 20 FEET EACH SIDE OF CURB INLETS AND CURB CUTS AS SHOWN ON PLAN. DAYLIGHT INTO STORM STRUCTURE, DETENTION BASIN OR ADJACENT LANDSCAPE AREA TO PROVIDE POSITIVE DRAINAGE

GENERAL JOINTING NOTES:

1. NOTES AND DETAILS BASED ON ACI 330.2R-17 AND 330.R-8 GUIDELINES. ALL RECOMMENDATIONS SHOULD BE CONFIRMED ON A PROJECT BY PROJECT BASIS WITH THE CIVIL AND/OR GEOTECHNICAL ENGINEER. IF THE DETAILS AND RECOMMENDATIONS PROVIDED DO NOT COMPLY WITH THE STANDARDS OF THE LATEST INDUSTRY STANDARDS, OR THE STANDARDS ESTABLISHED BY THE AUTHORITY HAVING JURISDICTION, THIS SHOULD BE BROUGHT TO THE IMMEDIATE ATTENTION OF THE OWNER'S REPRESENTATIVE.
2. CONSTRUCTION AND TRANSVERSE JOINTS SHALL BE RE-SAWN AND ALL SAW LAITANCE VACCUMED FROM THE JOINT ONCE BOTH SIDES ARE POURED.
3. PAVEMENT JOINTS OF ANY TYPE SHOULD EXTEND THROUGH ANY CURB AND GUTTER.
4. CONCRETE CONTRACTOR SHALL SUBMIT THE CONCRETE MIX TO THE OWNER'S REPRESENTATIVE FOR REVIEW AND APPROVAL.
5. A SCALED DRAWING OF THE JOINTING PLAN FOR THE PAVEMENTS AND CURBS SHOULD BE SUBMITTED BY THE CONTRACTOR FOR REVIEW BY THE CIVIL AND GEOTECHNICAL ENGINEERS.

JOINT SPACING FOR UNREINFORCED CONCRETE (FROM ACI 330.2R-17 TABLE 4.4.4 & ACI 330.R-8 TABLE 3.5)	
PAVEMENT THICKNESS (IN)	MAXIMUM SPACING (FT)
4 - 4.5	10
5 - 5.5	12.50
6 OR GREATER	15

GENERAL JOINTING NOTES
N.T.S.



Know what's below.
Call before you dig.



THIS DRAWING IS NOT VALID WITHOUT AN ORIGINAL BLUE INK SIGNATURE AND ORIGINAL HANDWRITTEN DATE OF A LICENSED PROFESSIONAL ENGINEER.

PAVEMENT DETAILS