

LEGEND FOR PROPOSED IMPROVEMENTS

- PROPERTY LINE/ R.O.W.
- PROPOSED CURB AND GUTTER
- C.O. ○ PROPOSED CLEANOUT
- PROPOSED MANHOLE
- PROPOSED WATER
- PROPOSED ELECTRICAL
- PROPOSED COMMUNICATION
- PROPOSED STORM SEWER
- PROPOSED PUBLIC WATER
- PROPOSED PUBLIC SEWER
- PROPOSED EASEMENT
- PROPOSED FORCE MAIN
- LIMITS OF DISTURBANCE/ CONSTRUCTION/WATERSHED AREA

EXISTING LEGEND

- SUBJECT PROPERTY BOUNDARY LINE
- ADJACENT BOUNDARY LINES
- OLD WIRE FENCE
- "40" LINES
- LIMITS OF EASEMENT
- BURIED FIBER OPTIC LINE
- OVERHEAD UTILITY LINES
- MAJOR CONTOUR
- MINOR CONTOUR
- DRAINAGE PIPE
- SIGNIFICANT DRAINAGE FLOWLINE
- APPROXIMATE FLOOD ZONE LOCATION
- NO HIGHWAY ACCESS
- PAINT STRIPE
- 1/2" IRON REBAR SET
- IRON PIN FOUND
- FENCE CORNER FOUND
- UTILITY POLE
- APR AS PER SURVEY
- APR AS PER RECORD
- ROW RIGHT-OF-WAY
- CONTOUR ELEVATION
- RCP REINFORCED CONCRETE PIPE
- CMP CORRUGATED METAL PIPE
- ⊗ ROAD SIGN POST
- ▨ EXISTING ROADWAY OR DRIVEWAY

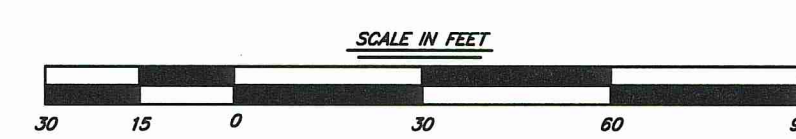
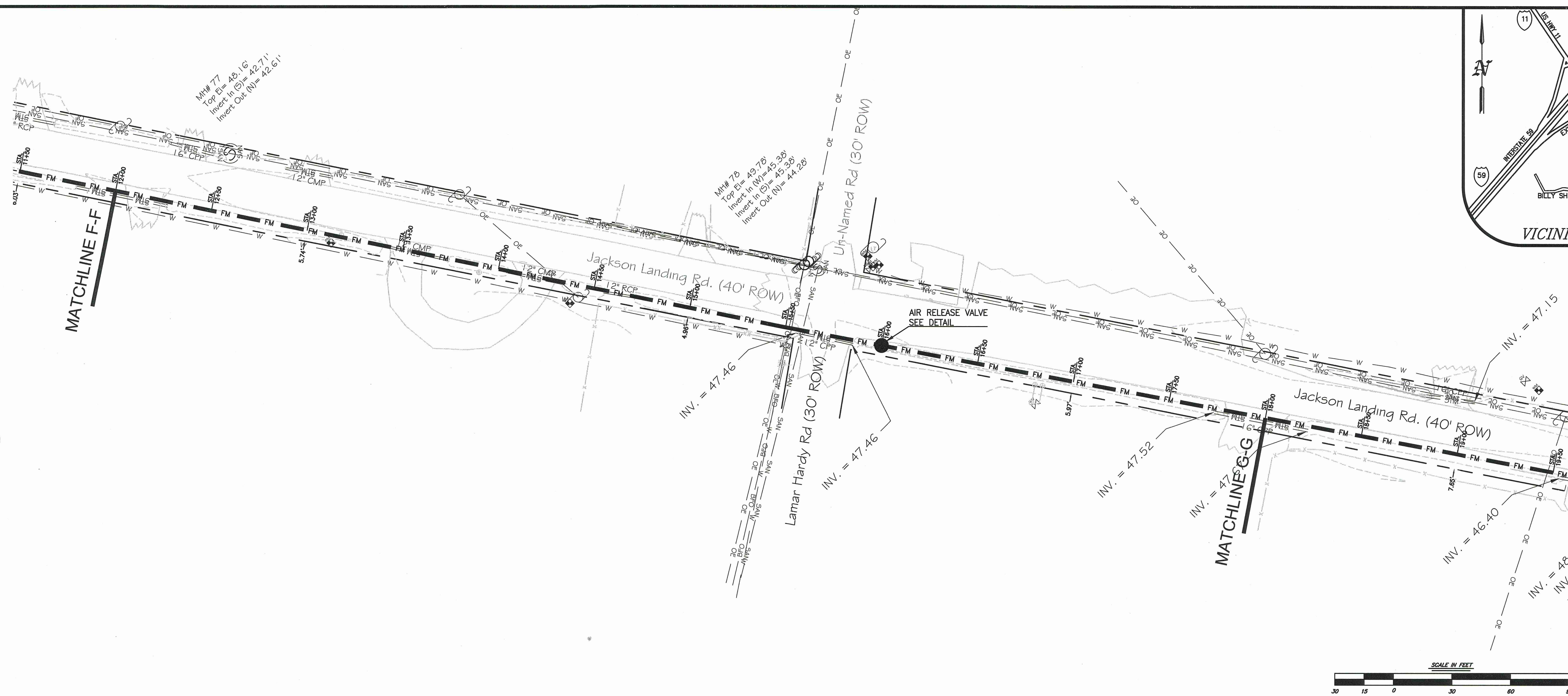

**PLAN
PROFILE**

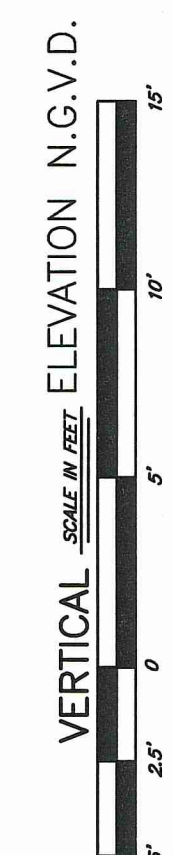
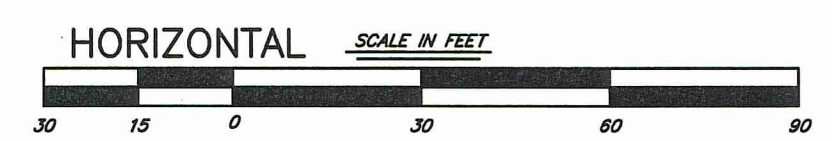
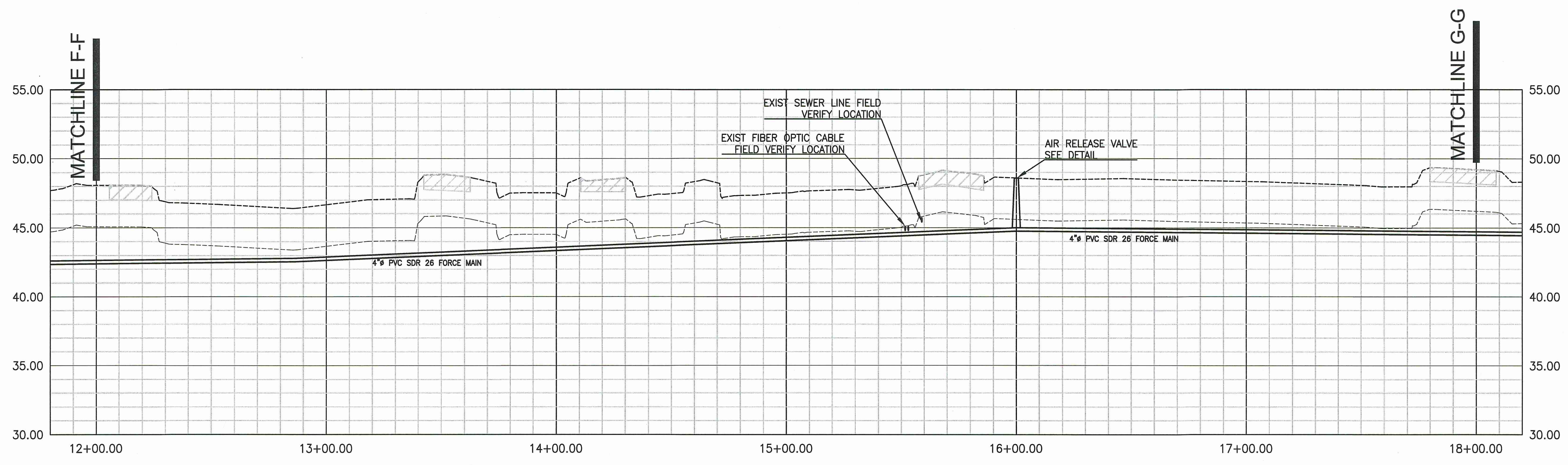

RC 200325
 File: 200325v7 Uext
 Drawn: DMT
 Date: 03-01-2023

CERTIFICATE OF AUTHORIZATION
 RESOURCE CONSULTING, LLC
 E-0696
 STATE OF MISSISSIPPI

RESOURCE CONSULTING
 CIVIL ENGINEERING
 6700 Jefferson Highway - Resource Suite 4A
 Baton Rouge, Louisiana 70806
 ResourceConsulting@hotmail.com
 Tel: (225) 761-9909, Fax: (225) 766-6672

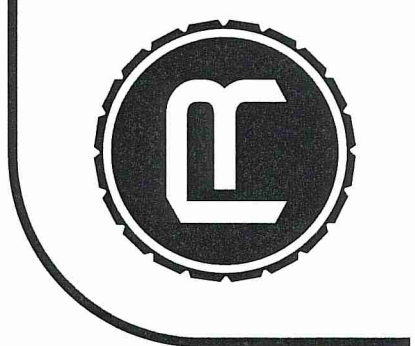

NICHOLSON WATER AND SEWER ASSOCIATION
 INTERSTATE 59 EXIT 1 @ MS HWY 607
 PEARL RIVER COUNTY, MISSISSIPPI

FORCE MAIN EXTENSION

U4.3



THIS DRAWING IS NOT VALID WITHOUT AN ORIGINAL BLUE INK SIGNATURE AND ORIGINAL HANDWRITTEN DATE OF A LICENSED PROFESSIONAL ENGINEER.

