

Plotted By: Ibbis, Seth Sheet: Loves MDT - Layout C4 - February 23, 2022 09:48:15am k:\BIR - IPTO\142362033 - Loves Pearl River MS\CAD\4 - ROADWAY LAYOUT.dwg
 This document, together with the concepts and designs presented herein, is intended only for the specific purpose and client for which it was prepared. Reuse of and improper reliance on this document without written authorization and adaptation by Kimley-Horn and Associates, Inc. shall be without liability to Kimley-Horn and Associates, Inc.

ALIGNMENT DATA US11/US607				
POINT	STATION	NORTHING	EASTING	DIRECTION
BEGIN POINT	100+00.00	354289.502	714632.487	S34°00'53"E
PI #1	105+55.65	353828.931	714943.320	S34°09'37"E
PI #2	108+80.84	353559.840	715125.920	S34°34'42"E
END POINT	115+42.69	353014.906	715501.540	-

ALIGNMENT DATA I59 NB RAMP				
POINT	STATION	NORTHING	EASTING	DIRECTION
BEGIN POINT	200+00.00	353169.735	714725.320	N58°06'44"E
END POINT	205+51.84	353461.248	715193.880	-

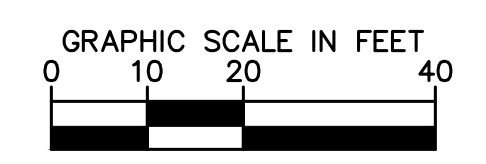
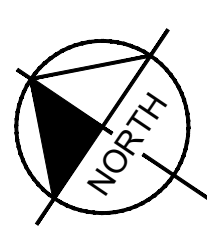
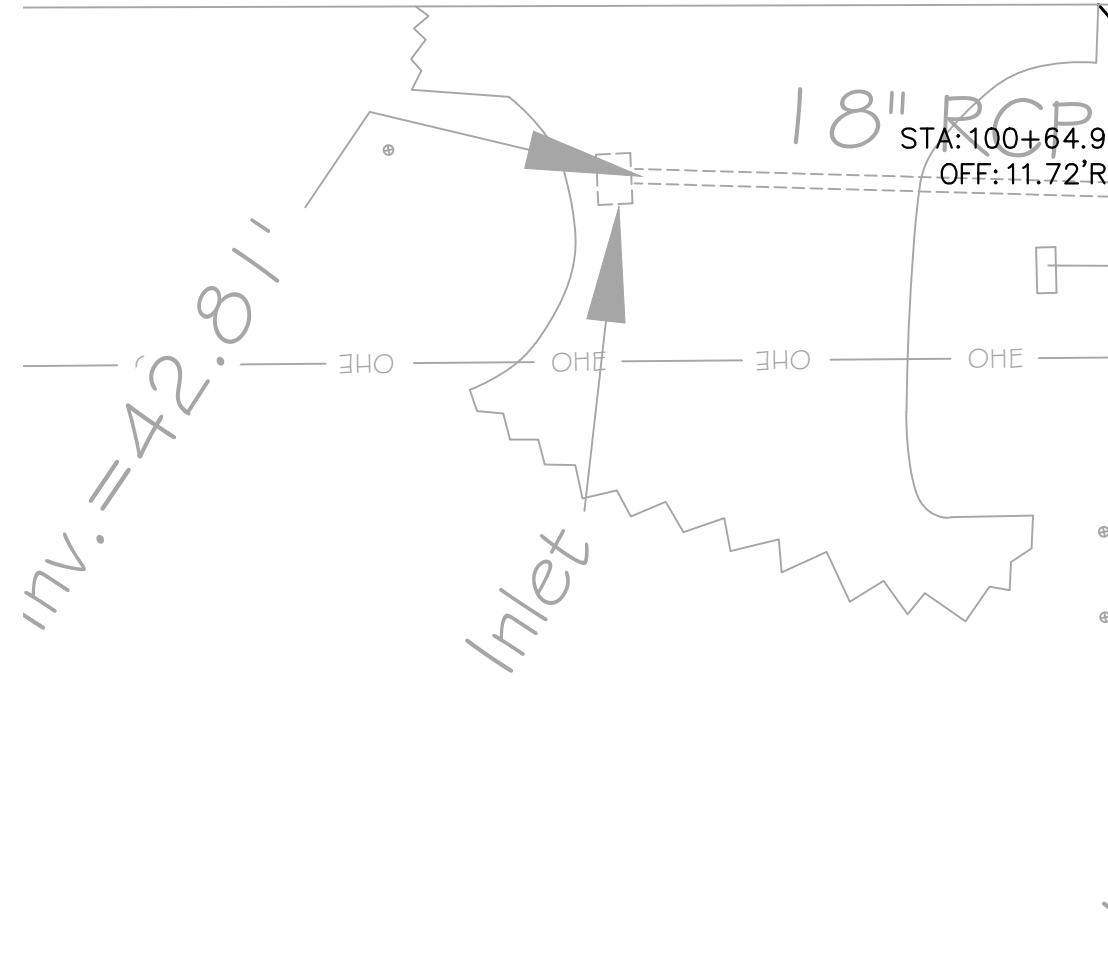
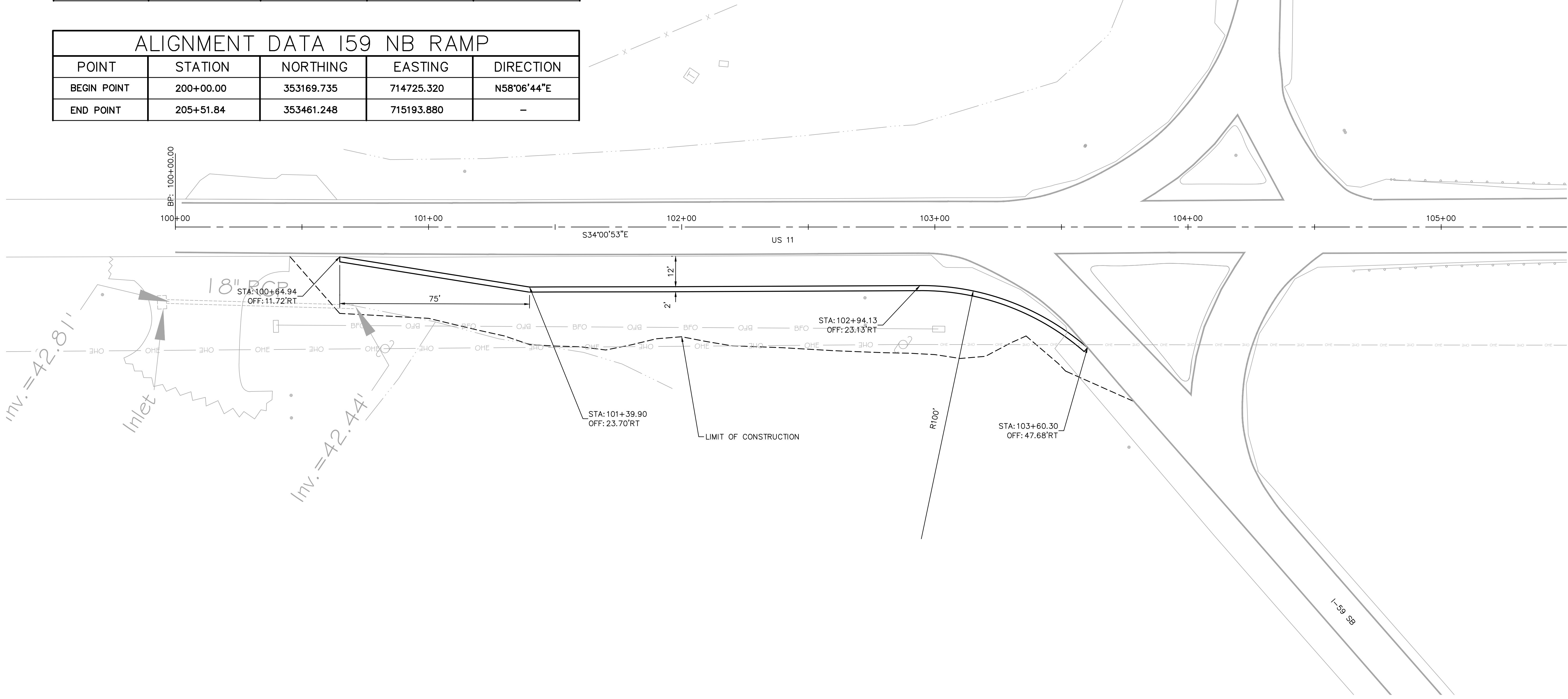

NOTE:
 1. CONTRACTOR TO COORDINATE WITH THE MISSISSIPPI DEPARTMENT OF TRANSPORTATION (MDOT) FOR ANY UTILITY RELOCATIONS WITHIN MDOT RIGHT-OF-WAY OR EASEMENTS. ALL PERMITTING WILL BE THE RESPONSIBILITY OF THE CONTRACTOR

No.	REVISIONS	DATE	BY

Kimley»Horn
 © 2010 KIMLEY-HORN AND ASSOCIATES, INC.
 420 N 20TH ST, SHIPT TOWER STE 2200, BIRMINGHAM, AL 35203
 PHONE: 205-558-5831
 WWW.KIMLEY-HORN.COM



KHA PROJECT	142362033
DATE	2/2022
SCALE	AS SHOWN
DESIGNED BY	BST
DRAWN BY	BST
CHECKED BY	CBB

ROADWAY LAYOUT
I-59 SB

LOVE'S TRAVEL STOP
TRAFFIC SIGNAL DESIGN
 PREPARED FOR
MDOT

PICAYUNE MS

SHEET NUMBER
C4