

PLUMBING LEGEND

LINE TYPE/SYMBOL	DESCRIPTION	LINE TYPE/SYMBOL	DESCRIPTION
SS	SANITARY SEWER	---	VENT LINE
OW	OIL WASTE	AIR	COMPRESSED AIR
FD-X/SD-X	FLOOR DRAIN/ SHOWER DRAIN	---	DOMESTIC HOT WATER
FS-X	FLOOR SINK	---	DOMESTIC HOT WATER RETURN
CO-4	WALL CLEAN OUT	---	DOMESTIC COLD WATER
CO-X	FLOOR/YARD CLEAN OUT	NAT	LOW PRESSURE GAS
M	WATER/GAS METER	WHA-C	WATER HAMMER ARRESTOR
GPM	GALLONS PER MINUTE	---	WALL HYDRANT OR HOSE BIBB (WH/HB)
---	BACKFLOW PREVENTER	---	LINE CAP
UT-1/ SB-1	UTILITY BOX/ SUPPLY BOX	---	CIRCUIT SOLVER
A.F.F.	FINISHED FLOOR ELEVATION	---	UNION

PLUMBING FIXTURE SCHEDULE

MARK	FIXTURE	COLD	HOT	WASTE	VENT	DESCRIPTION	NOTES
EWC-1	ELECTRIC WATER COOLER	1/2"	1/2"	2"	1-1/2"	ELKAY EZS8, WALL-MOUNTED, BARRIER FREE, FRONT AND SIDE PUCH ACTUATOR BARS, STAINLESS STEEL BOWL, FLEXIBLE POLYESTER ELASTOMER SAFETY BUBBLER AND GALVANIZED STEEL FRONT AND SIDES, CHILLER WITH CAPACITY OF 8.0 GALLONS PER HOUR, 50 F DRINKING WATER AT 80 F INLET TEMPERATURES 90 F ROOM TEMPERATURE, 120-VOLT, 3.7 FULL LOAD AMPS, PROVIDE WITH MCGUIRE #2165CC COMPRESSION ANGLE STOP VALVE WITH RISER AND ESCUTCHEON, MCGUIRE #8872CF 1-1/4" 17 GAUGE TUBULAR CHROME PLATED BRASS ADJUSTABLE P-TRAP AND WASTE ARM WITH CLEANOUT PLUG AND ESCUTCHEON, ELKAY #LKAPREZL ACCESSORY APRON, AND SUITABLE CARRIER WITH STANCHIONS TO FLOOR.	1, ADA ACCESSIBLE
L-1	LAVATORY	1/2"	1/2"	2"	1-1/2"	ELKAY ELU1511, 18 GAUGE 17" X 13" OVAL UNDER-MOUNT STAINLESS STEEL LAVATORY, FAUCET - ZURN Z7440-XL-FC, AERATOR - 0.5 GPM VANDAL RESISTANT, MIXING VALVE - ZURN ZW3870XLT (ASSE 1070), SUPPLY - MCGUIRE #H165LKN3, DRAIN - ZURN Z8743NOF-PC, P-TRAP - MCGUIRE #8872C, COVERING - MCGUIRE #PW2000VC, UNIT SHALL BE ADA COMPLIANT.	1, ADA ACCESSIBLE
MSK-1	MOP BASIN	3/4"	3/4"	3"	2"	FIAT MSB-2424-3 24"X24" MOLDED STONE MOP BASIN, MOP BASIN, FAUCET - T&S BRASS #B-0665-BSTP WITH BUILT-IN STOPS AND SPRING CHECKS AND POLISHED CHROME FINISH, BRACKET - FIAT #832-AA, GUARD - GIAT #1239-BB, MOP HANGER - FIAT #889-CC, SPLASH PANEL - FIAT #MSG, DRAIN GASKET - FIAT #QDC3XH.	1
SK-1	SINK BY OWNER	3/4"	3/4"	2"	1-1/2"	ELKAY B1C24X24X, STAINLESS STEEL, FAUCET - ELKAY LK940AT08T4H, AERATOR - 0.5 GPM, SUPPLY - MCGUIRE #H165LKN3, DRAIN, MCGUIRE #15WC-LO, TRAP - MCGUIRE #8872C.	1, ADA ACCESSIBLE
WC-4	WATER CLOSET	3/4"	---	4"	2"	AMERICAN STANDARD CADET PRO MODEL 215AA, 1.28 GALLON FLUSH TANK - MANUAL FLUSH, TANK: 4188A, 104.020, BOWL: 3517A, 101.020, SEAT: AMERICAN STANDARD #5910.110 (EXTRA HEAVY DUTY) SUPPLY: MCGUIRE #LPH185K (CONTRACTOR PROVIDED) UNIT SHALL BE ADA COMPLIANT.	1, ADA ACCESSIBLE
YH-1	YARD HYDRANT	3/4"	---	---	---	CORNING 903 SELF DRAINING, NON-FREEZING POST HYDRANT WITH 12 FT. LONG RUBBER HOSE, TURN POST HYDRANT TO HAVE HOSE END TOWARD EXIT SIDE OF ISLAND LOCATED AT THE EDGE OF BUMPER, WRAP ALL POST YARD HYDRANT BELOW GRADE WITH 12" EXPANSION JOINT MATERIAL.	1,2
YH-2	YARD HYDRANT	3/4"	---	---	---	FREEZEFLOW 2132S (SANITARY TYPE), ASSE 1057 SANITARY YARD HYDRANT SUPPLIED WITH 1011 BACKFLOW PREVENTER, WAGON WHEEL TURN HANDLE HOSE BIB AND PAIL HOOK, SELF DRAINING, NON-FREEZING TYPE, WRAP ALL POST YARD HYDRANTS BELOW GRADE WITH 12" EXPANSION JOINT MATERIAL, BURIAL DEPTH 2 FT.	1
EW-1	EYE WASH	---	1/2"	1-1/2"	1-1/4"	BRADLEY S19-224EW, WALL MOUNTED, GALVANIZED STEEL PIPE, CHROME PLATED BRASS VALVE, YELLOW PLASTIC BOWL WITH DUST COVER, 304 SS HANDLE, PROVIDE P-TRAP AND TAILPIECE WHERE APPLICABLE ON PLANS.	1
ETMV	EMERGENCY THERMOSTATIC MIXING VALVE	1/2"	1/2"	---	---	BRADLEY S19-2000, HEAVY CAST BRONZE BODY VALVE, ROUGH BRONZE FINISH, BIMETAL THERMOSTAT OR THERMAL MOTOR, INTEGRAL CHECK STOPS AND VANDAL RESISTANT LIMIT STOP SET AT 85 F. MINIMUM FLOW RATE 1.0 GPM.	1

NOTES:
 1. FIXTURE SHALL BE PROVIDED BY LOVES, CONTRACTOR INSTALLED. CONTRACTOR TO PROVIDE ALL ACCESSORIES THAT ARE REQUIRED FOR FULL INSTALLATION OF THESE PLUMBING FIXTURES (SUCH AS: INSULATION, ANGLE VALVES, P-TRAPS, ETC.)
 2. CONTRACTOR SHALL PAINT THE HEAD AND NOZZLE ASSEMBLY YELLOW AND LABEL THE HYDRANT WITH A 12" YELLOW FIELD & 1-1/4" BLACK LETTERS WITH THE FOLLOWING PHRASE: "CAUTION : NONPOTABLE WATER, DO NOT DRINK" AND INCLUDE PICTOGRAPH AS REQUIRED BY PLUMBING CODE.
 3. NOT ALL FIXTURES LISTED MAY BE USED ON PLANS.

SPECIALTY PLUMBING FIXTURE SCHEDULE

MARK	FIXTURE	MANUFACTURER	MODEL	DESCRIPTION
FD-1	FLOOR DRAIN	WATTS	FD12-R-6R	ASME A112.21.1M, ON GRADE PVC TWO PIECE BODY WITH ADJUSTABLE 6" DIAMETER SATIN NICKEL BRONZE STRAINER, AND 2" OUTLET.
FD-2	FLOOR DRAIN	WATTS	FD12-R-6R-GNB	ASME A112.21.1M, ON GRADE PVC TWO PIECE BODY WITH ADJUSTABLE 6" DIAMETER SATIN NICKEL BRONZE STRAINER WITH ROUND FUNNEL, AND 3" OUTLET.
FD-3	FLOOR DRAIN	WATTS	FD12-R-6R-HNB	ASME A112.21.1M, ON GRADE PVC TWO PIECE BODY WITH ADJUSTABLE 6" DIAMETER SATIN NICKEL BRONZE STRAINER WITH OVAL FUNNEL, AND 4" OUTLET.
FD-4	FLOOR DRAIN	WATTS	FD6-4NH-UP	ASME A112.21.1M, CAST IRON FLOOR DRAIN WITH SECURED GRATE, 4" NO HUB, VANDAL PROOF SCREWS.
SD-1	SHOWER DRAIN	JAY R. SMITH	2005-SS-CR8M	ASME A112.21.1M, ON GRADE CAST IRON TWO PIECE BODY WITH DOUBLE DRAINAGE FLANGE, WEEP HOLES, AJUSTABLE 6" SQUARE STAINLESS STEEL STRAINER, AND 2" OUTLET SIZE.
FS-1	FLOOR SINK	WATTS	FS-740-1-150-FC	12"X12" SQUARE LACQUERED CAST IRON BODY WITH INTEGRAL SEEPAGE PAN, EPOXY COATED INTERIOR, 8" DEEP SUMP, ALUMINUM DOME STRAINER, CLAMP COLLAR, HALF GRATE, AND SATIN NICKEL-BRONZE STRAINER W / 4" OUTLET.
FS-2	FLOOR SINK	WATTS	FS-740-1-150-FC	12"X12" SQUARE LACQUERED CAST IRON BODY WITH INTEGRAL SEEPAGE PAN, EPOXY COATED INTERIOR, 8" DEEP SUMP, ALUMINUM DOME STRAINER, CLAMP COLLAR, HALF GRATE, AND SATIN NICKEL-BRONZE STRAINER W / 3" OUTLET.
CO-1	EXTERIOR CLEANOUT	JAY R. SMITH	4250	HEAVY DUTY DURACOAT CAST IRON BODY WITH DOUBLE FLANGE HOUSING AND SCORIATED CAST IRON COVER WITH LIFTING DEVICES SECURED WITH COUNTERSUNK SCREWS.
CO-2	EXTERIOR CLEANOUT	JAY R. SMITH	4221	HEAVY DUTY CAST IRON BODY AND FRAME WITH ROUND ADJUSTABLE TOP, AND SCORIATED CAST IRON COVER SECURED WITH COUNTERSUNK SCREWS.
CO-3	INTERIOR CLEANOUT	JAY R. SMITH	4140	LACQUERED CAST IRON BODY WITH ANCHOR FLANGE, REVERSIBLE CLAMPING COLLAR, THREADED TOP ASSEMBLY AND ROUND GASKETED SCORED COVER IN SERVICE AREAS AND ROUND GASKETED DEPRESSED COVER TO ACCEPT FLOOR FINISH IN FINISHED FLOOR AREA.
CO-4	INTERIOR CLEANOUT	JAY R. SMITH	4422	LINE TYPE WITH LACQUERED CAST IRON BODY AND ROUND EPOXY COATED GASKETED COVER, AND ROUND STAINLESS STEEL ACCESS COVER SECURED WITH MACHINE SCREW.
HD-1	HUB DRAIN	---	---	HUB DRAIN SAME AS SANITARY WASTE PIPING MATERIAL UNLESS NOTED OTHERWISE ON PLANS. END PIPE 2" AFF.
RD-1	ROOF DRAIN	WATTS	RD-300	COATED CAST IRON BODY, BOTTOM OUTLET, NO-HUB ROOF DRAIN WITH CAST OR DUCTILE IRON DOME, MEMBRANE CLAMP, ADJUSTABLE EXTENSION (OR EXTENSION SIZED FOR ROOF INSULATION), SUMP RECIEVER AND UNDERDECK CLAMP.

NOTES:
 1. NOT ALL FIXTURES LISTED MAY BE USED ON PLANS.
 2. ALL FLOOR DRAINS, FLOOR SINKS, AND ROOF DRAINS SHALL BE PROVIDED AND INSTALLED BY THE PLUMBING CONTRACTOR.

WATER HEATER SCHEDULE

MARK	MANUFACTURER/MODEL	LOCATION	TYPE	RECOVERY RATE 100°F DELTA T	(AMP)	ELECTRICAL VOLTS/PH	INPUT LOAD (KW)	PHYSICAL TANK SIZE (GAL.)	FLUE SIZE (IN.)	NOTES
DWH-1	BRADFORD WHITE LD-30L3-5	TIRE SHOP	ELEC. STORAGE	16	19.2	208/3	4	30		1-5

NOTES:
 1. OWNER PROVIDED FOR CONTRACTOR INSTALLATION.
 2. PROVIDE WITH THERMAL EXPANSION TANK HAVING 0.2 GALLONS OF ACCEPTANCE VOLUME.
 3. PROVIDE WITH HEAT TRAP FITTINGS.
 4. PROVIDE WATTS WM-26 RESTRAINT SYSTEM.
 5. MIXING VALVE RECIRCULATION PUMP RCP-1; TACO 009-BF5.

PUMP SCHEDULE

MARK	MANUFACTURER/ MODEL	TYPE	WORKING FLUID	GPM	DISCHARGE PRESSURE (FT)	MOTOR HP	VOLTS/PH	NOTES
SP-1	ZOELLER MIGHTY MATE 53	SUBMERSIBLE SUMP PUMP	OIL/WATER	10	17	1/3	115/1	1-2
SP-2	ZOELLER M267	SUBMERSIBLE SUMP PUMP	WATER	40	15	1/2	115/1	1-3

NOTES:
 1. PROVIDE WITH DISCHARGE CHECK VALVE AND DECOUPLING UNION.
 2. OWNER PROVIDED AND CONTRACTOR INSTALLED.
 3. PROVIDE WITH STAINLESS STEEL CABLE TO LIFT PUMP.

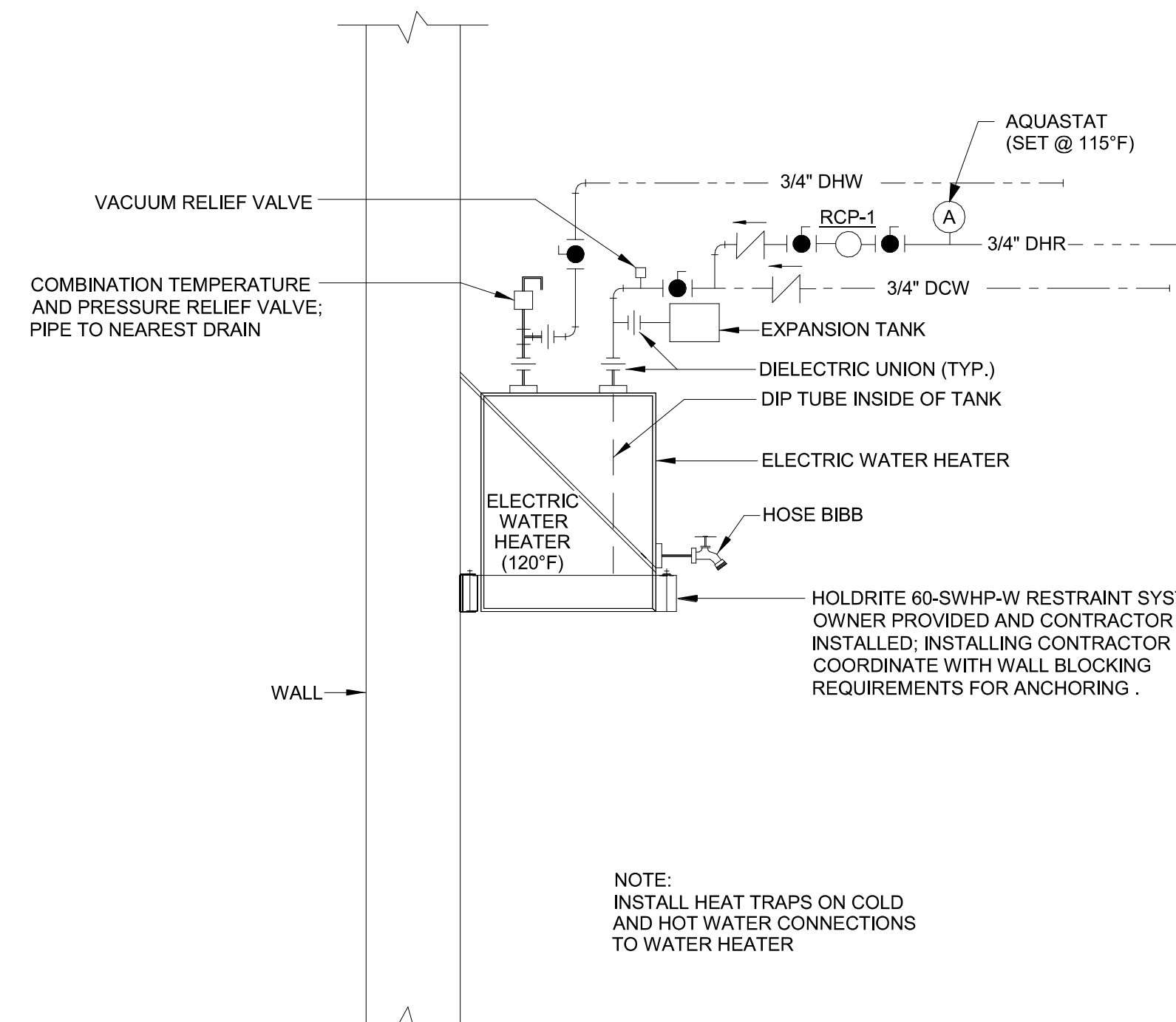

1 WALL MOUNTED ELECTRIC WATER HEATER
NTS

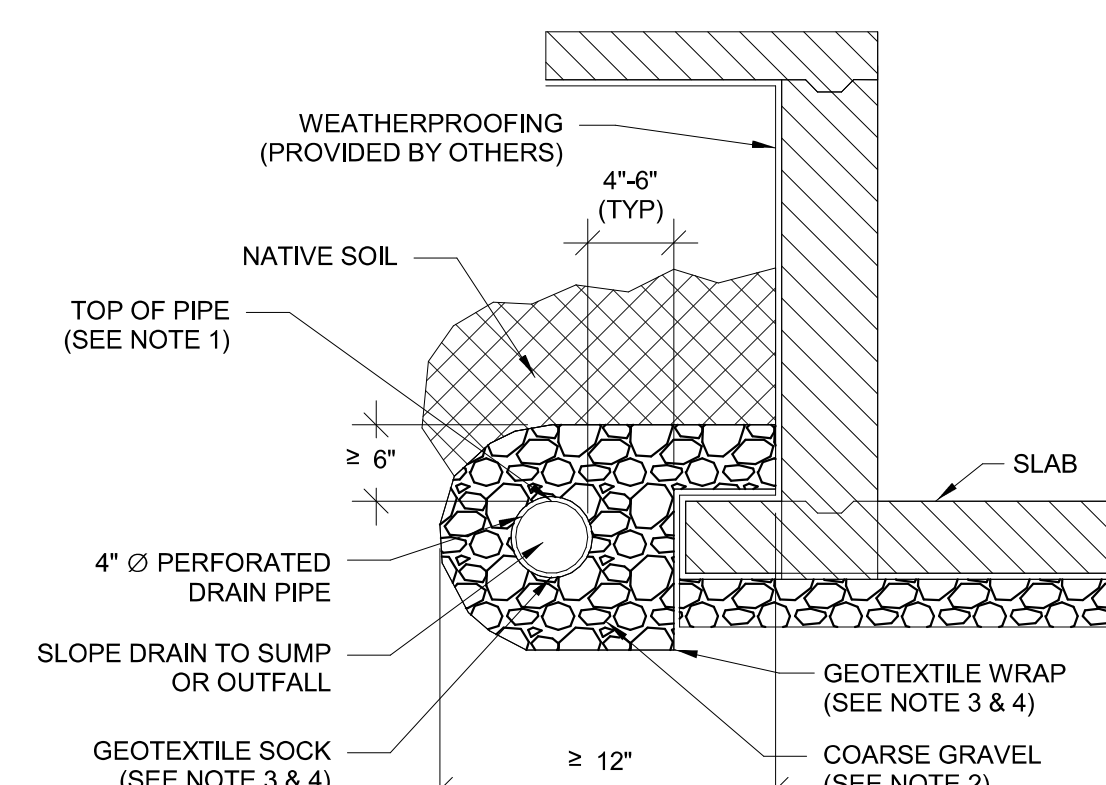

2 FOUNDATION & SUBSURFACE DRAIN INSTALLATION
NTS

- NOTES:
 1. TOP OF PERFORATED PIPE MUST BE AT OR BELOW THE TOP OF FOOTING.
 2. BACKFILL MUST BE SIZED AT LEAST ONE SIEVE SIZE (ROCK SIZE) LARGER THAN DIMENSIONS OF PERFORATIONS. OTHERWISE A GEOTEXTILE WRAP AROUND THE PIPE IS REQUIRED.
 3. FOR NATIVE SOIL WITH HIGH SAND CONTENT, A GEOTEXTILE BETWEEN THE BACKFILL AND NATIVE SOIL SHOULD BE USED. FOR NATIVE SOIL WHERE THE CLAY CONTENT EXCEEDS 50% OR THE SILT CONTENT EXCEEDS 40%, A GEOTEXTILE IS NOT REQUIRED AROUND THE PIPE.
 4. FOR NATIVE SOIL WITH LESS THAN 50% PASSING THE NO. 200 SIEVE, THE APPARENT OPENING SIZE (AOS) OF THE FABRIC SHOULD BE AT LEAST A NO. 30 SIEVE. FOR NATIVE SOIL WITH MORE THAN 50% PASSING THE NO. 200 SIEVE, THE AOS OF THE FABRIC SHOULD BE AT LEAST A NO. 50 SIEVE.

HFA
 HARRISON FRENCH & ASSOCIATES, LTD.
 t 479.273.7780
 1705 S. Walton Blvd., Suite 3
 Bentonville, Arkansas 72712
 www.hfa-ac.com

STIPULATION FOR REUSE
 THESE DRAWINGS ARE PREPARED FOR
 USE ON A SPECIFIC PROJECT AT
 THE LOCATION AND DATE SPECIFIED
 HEREON. ANY REUSE OF THESE
 DRAWINGS FOR ANY OTHER PROJECT
 WITHOUT THE WRITTEN CONSENT OF
 HARRISON FRENCH & ASSOCIATES,
 L.P. IS STRICTLY PROHIBITED.
 ANY REUSE OF THESE DRAWINGS
 WITHOUT THE WRITTEN CONSENT OF
 HARRISON FRENCH & ASSOCIATES,
 L.P. IS STRICTLY PROHIBITED.
 THE LAW.

Loves
 STORE NUMBER: 860
 I-59, EXIT 1
 NICHOLSON, MS 39466
 JOB NUMBER: 03-23-30009
 SPEEDCO_4 BAY

ISSUE BLOCK

CHECKED BY: JKR
 DRAWN BY: PRC
 DOCUMENT DATE: 2/7/2023
 PROTO: SPEEDCO_4 BAY
 PROTO CYCLE: Q4 - 2022

REG. I. SCHULTERMAN
 LICENSED PROFESSIONAL
 ENGINEER
 MISSISSIPPI

2023.02.07 13:36:06-0600

PLUMBING SCHEDULES

SHEET: SDP401

R:\2023\13-36-06-0600\CAD\DWG\PLUMBING\SDP401.dwg
 C:\Users\jrcrawford\Documents\2023\New\Projects\Lowes_Nicholson_MS_MEP_SPEEDCO_4B_Q1_MPA_Power_Chronwin.vr
 R:\2023\13-36-06-0600\CAD\DWG\PLUMBING\SDP401.dwg