



Structural Inspection

December 10, 2018

For: Karl Holzenthal
616 Jefferson Ave. Apt 3
Brooklyn, NY. 11221

Ref: 129 Nottingham Drive
Slidell, La.

Construction:

One-story, wood frame, brick veneer, ceramic, wood flooring with a composition shingle roof on a conventional foundation.

Scope:

This inspection is limited to a visual inspection of the shell of the home, including the interior and exterior foundation of the home. No inspection of the mechanical or electrical systems was performed. This report is as outlined by the National Academy of Building Inspection Engineers and is not an explanation of cause, effect, or engineering.

History:

Dammon Engineering was contacted to conduct a structural inspection of the referenced home due a previous inspection that noted elevation differences in the foundation.

Findings:

Upon inspection, a zip level was used to verify the floor height conditions. The level was set up at the front of the living room at zero inches and measured throughout the home. It is important to note that all floor height conditions vary due to ceramic height and wood flooring height.

An overall visual inspection of the exterior of the home was conducted and several items were noted. There is a hairline crack in the brick veneer on the left side of the home that runs from the middle of the wall down to the foundation along with other hairline cracks but these cracks do not go into the foundation. Hairline cracks in the brick veneer on the front of the home were seen as well but do not go into the foundation. There are hairline cracks in the brick veneer on the right side of the home but do not go into the foundation. Some of these cracks have been repaired in the past.

This inspection is limited to the apparent visual conditions of the structural components of this building. It does not cover, nor attempts to cover, any components, items, and/or conditions which, by their nature or location, are concealed or are difficult or hazardous to inspect, or which require the moving of furniture, flooring materials, rugs, fixtures, appliances, or any component-part nailed, bolted, or screwed down or shut. No opinions are expressed regarding conditions which could be discovered only by the disassembly of any component parts, special testing, or removal of any concealing objects.

Inspections are made under normal weather conditions, and are not opinions of the conditions of the property and/or structure which may exist under unusual weather conditions, such as, but not limited to floods, heavy rains or snows, high winds, temperature extremes, or any act of God. Specific hazardous wastes, toxic substances, toxic mold, air and water quality, communicable diseases, asbestos, soil, environmental, radon, carbon monoxide, formaldehyde, building code and termite conditions are not included in this report unless otherwise stipulated.

This report is not a warranty or guarantee of the property inspected, but it is our opinion of its condition at the time inspected. Our liability shall be limited to reimbursement of the total cost of inspection.

Conclusion:

It is important to note that all foundations settle. Usually, everything settles together and the fastest rate of settlement occurs in the first year after construction. By the fifth or sixth year the settlement has exponentially slowed to where there is little danger that something will happen unless caused by weather, expansion & contraction, tree roots, improper drainage, etc. The brick wall is a veneer only and does not provide any structural support.

Recommendation:

The cracks in the brick veneer do not appear to have compromised the structural integrity of the home. It is my opinion that the structural integrity of this home is currently sound, but the foundation will expand and contract with the ground movement and any standing water around the foundation. It is recommended when there is more than a 3" elevation difference (tripping hazard) to have the home stabilized with screw pilings.

Items to be addressed are as follows:

- 1) Seal the cracks in the brick veneer with a non-shrinking grout, to prevent insects from entering the home.
- 2) Gutters and down spouts are needed to direct the rainwater away from the foundation and out to the yard. Existing down spouts need to be directed away from the foundation/patio and into the yard.

Sincerely,

Brian Mistich

Brian Mistich, P.E.



This inspection is limited to the apparent visual conditions of the structural components of this building. It does not cover, nor attempts to cover, any components, items, and/or conditions which, by their nature or location, are concealed or are difficult or hazardous to inspect, or which require the moving of furniture, flooring materials, rugs, fixtures, appliances, or any component-part nailed, bolted, or screwed down or shut. No opinions are expressed regarding conditions which could be discovered only by the disassembly of any component parts, special testing, or removal of any concealing objects.

Inspections are made under normal weather conditions, and are not opinions of the conditions of the property and/or structure which may exist under unusual weather conditions, such as, but not limited to floods, heavy rains or snows, high winds, temperature extremes, or any act of God. Specific hazardous wastes, toxic substances, toxic mold, air and water quality, communicable diseases, asbestos, soil, environmental, radon, carbon monoxide, formaldehyde, building code and termite conditions are not included in this report unless otherwise stipulated.

This report is not a warranty or guarantee of the property inspected, but it is our opinion of its condition at the time inspected. Our liability shall be limited to reimbursement of the total cost of inspection.

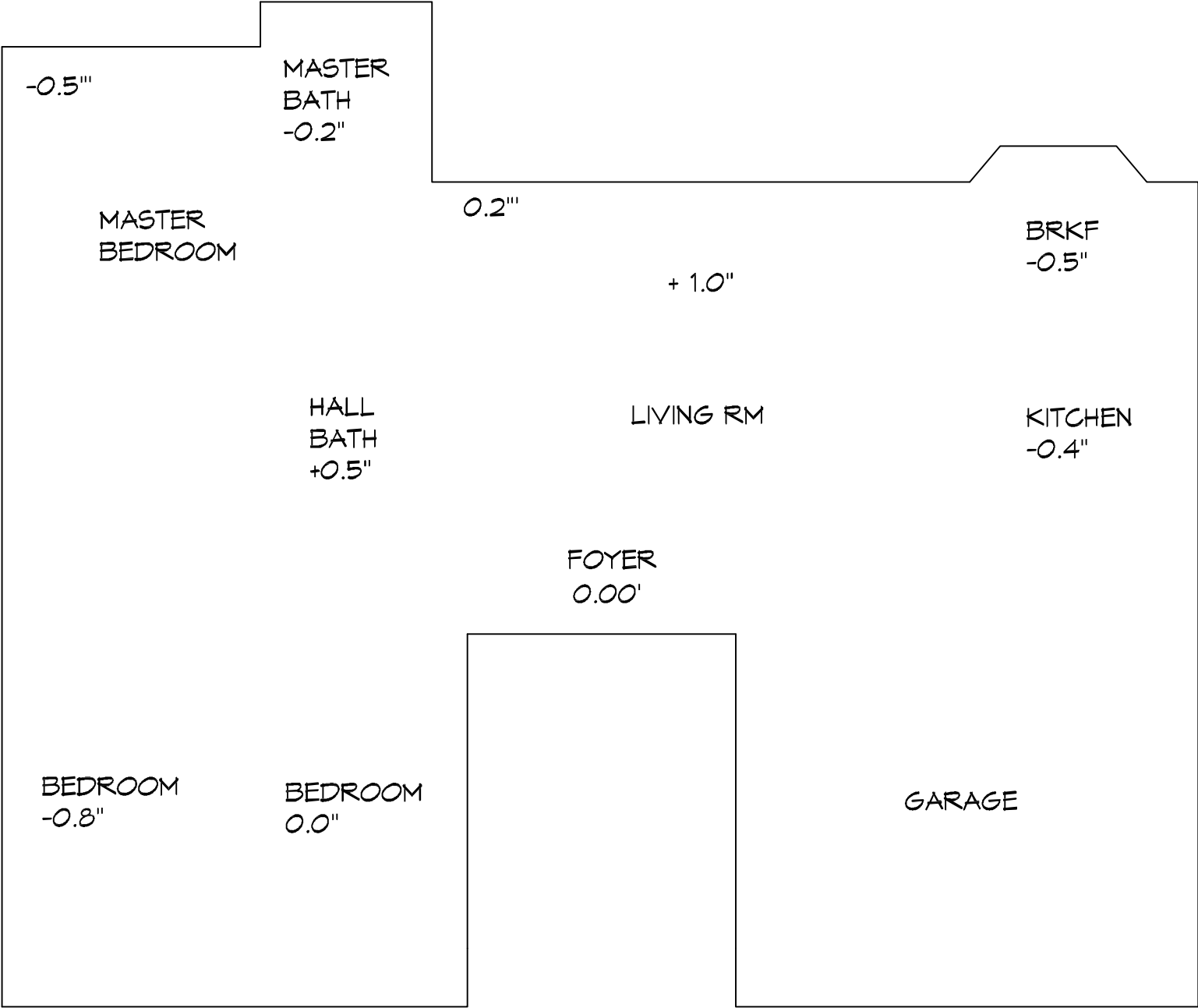



DAMMON ENGINEERING, INC.

554 Old Spanish Trail Slidell, LA 70458

Invoice

Date	Invoice #
12-10-2018	2018

Ship To	
Karl Holzenthal 616 Jefferson Ave. Apt 3 Brooklyn, NY. 11221	
RE:	129 Nottingham Drive

PROJECT NO.:	2018
--------------	------

Description	Qty	Rate	Amount
Structural Inspection		\$500.00	\$500.00
Thank you for allowing us to be of service!		Total Amount Due: \$500.00	