

1/2" REBAR  
 1' LENGTH  
 PLACED 6" IN  
 EXISTING SLAB  
 4' APART

RAT-WALL  
 8" X 8" BELOW  
 HEIGHT OF  
 GRADE

REBAR  
 SUSPENDED IN  
 MIDDLE OF RAT-  
 WALL USING  
 BALLING WIRE  
 TO FORM

THREADED  
 ANCHOR  
 BOLTS PINCED-  
 APPROXIMATELY  
 EVERY 4'

DO NOT  
 CARRY FORM  
 IN BETWEEN  
 APRON & SLAB

SCREW STAKES  
 TO FORM  
 BACK FILL FORM  
 WITH EXCESS  
 FILL DIRT

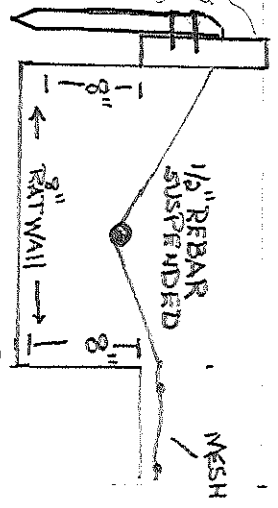

1/4" GRADE WITH WIRE MESH  
 ADD AT LEAST 2" OF SAND  
 AND COMPACT

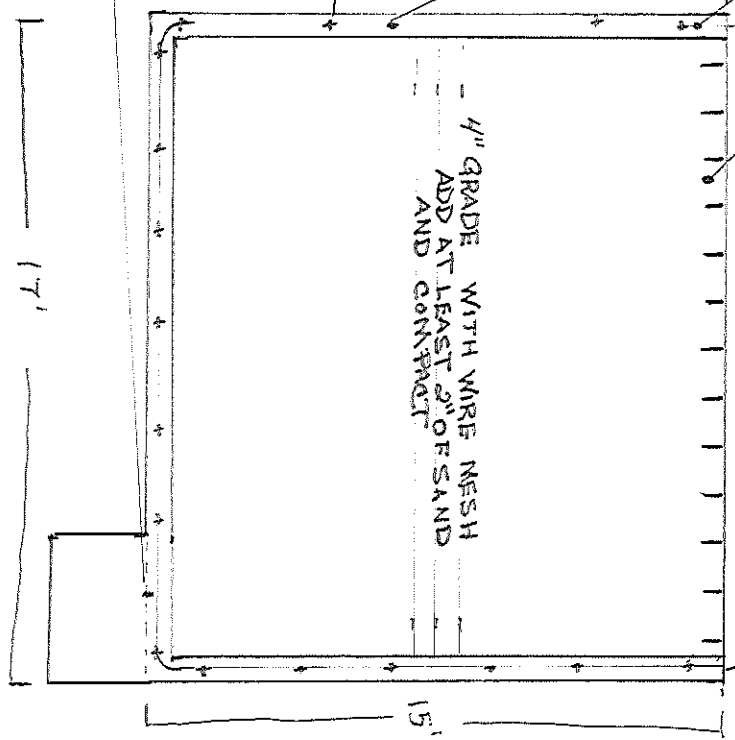

Footing View

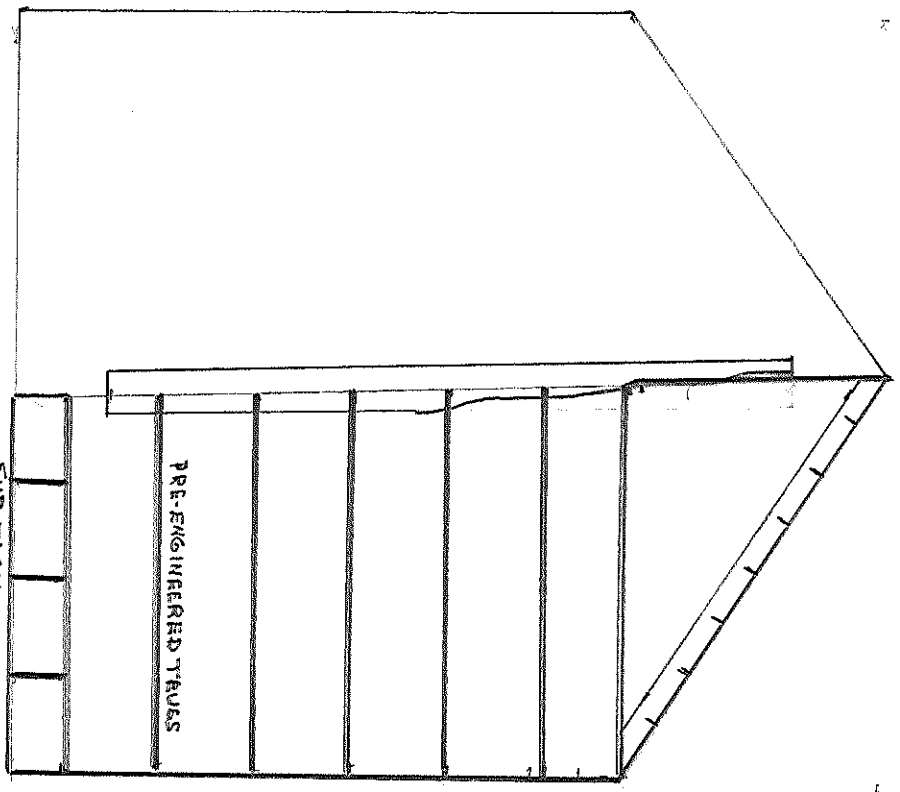

PRE-ENGINEERED TRUSSES  
 SUB FACIALS ON GRADE  
 BLOCKS

ANNALORO 1/4" = 1'  
 FOOTINGS  
 2 of 2  
 ROOF SECTION