

50'-0"

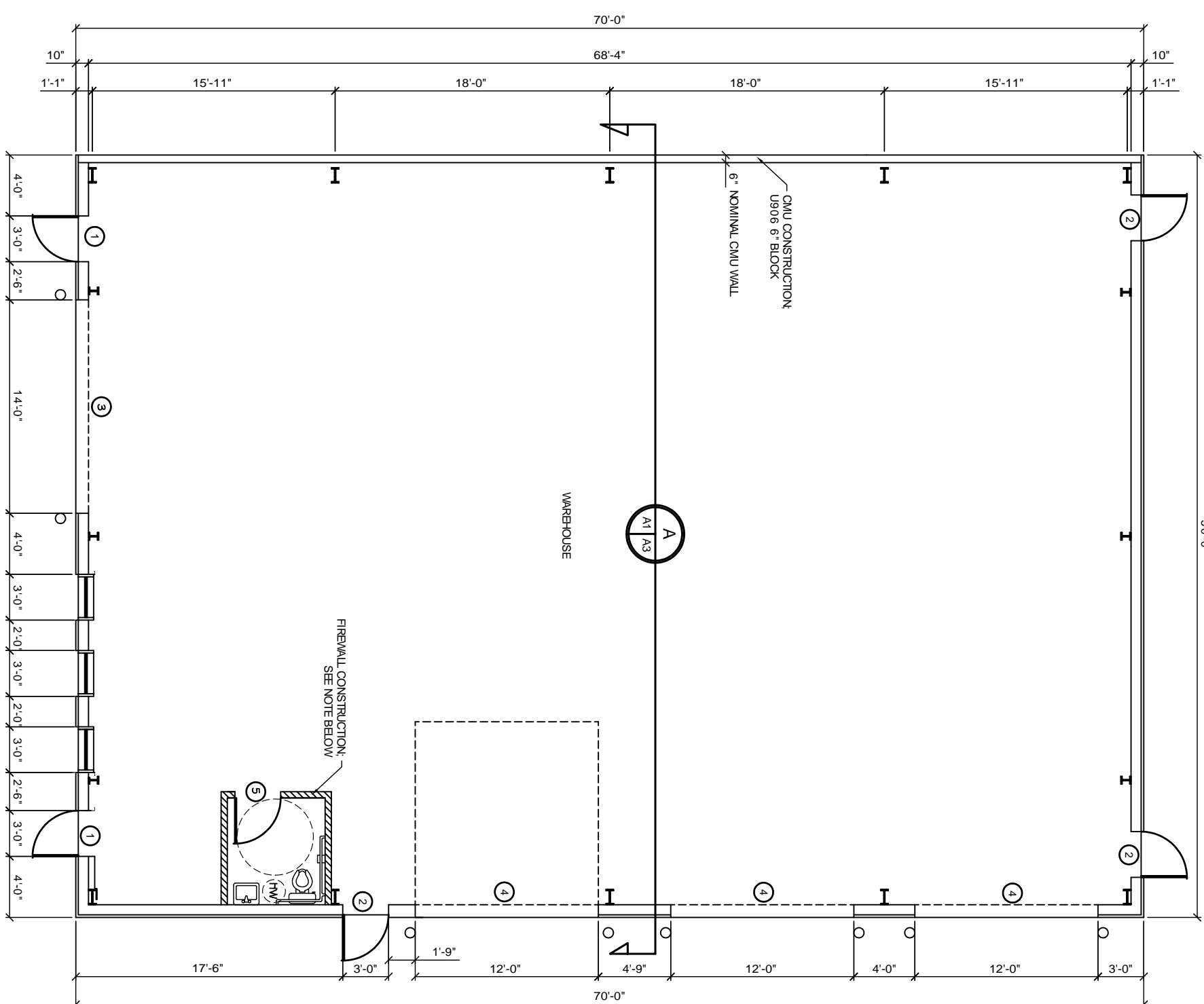

- FIREWALL CONSTRUCTION TYPICAL SHALL BE GA WP 1072. DEMISE TO ROOF DECK

FLOOR PLAN
SCALE 1/4" = 1'-0"



TYPE	FRAME	GLASS	TILES	ACCESSORIES	REMARKS
WINDOW	A 4/0x5/0				
	B 4/0x5/0				
		FIXED			
		S. HUNG			
		D. HUNG			
		HORIZ SLIDE			
		STEEL			
		ALUMINUM			
		WOOD			
		TINTED			
		PLAIN			
		TEMPERED			
		WIREGLASS			
		NONE			
		2/2			
		2/4			
		6/6			
		8/8			
		ALARM			
		SCREEN			
		SHUTTER			
		NONE			

GENERAL NOTES

- INSULATION AND INSULATION ASSEMBLIES SHALL MEET THE REQUIREMENTS OF SECTION 7.9. CONCEALED INSULATION SHALL HAVE A FLAME SPREAD OF 0-25 AND SMOKE DEVELOPED INDEX OF 0-450. EXCEPT THAT IN COMBUSTIBLE (WOOD FRAME) CONSTRUCTION.
- FACING SHALL COMPLY WITH IBC 2006.
- PROVIDE 5x8" LANDING, LEVEL WITH FINISHED FLOOR. OUTSIDE EXTERIOR DOORS. THRESHOLDS SHALL BE NOT MORE THAN 1/2" IN HEIGHT AND SHALL BE BEVELLED IF MORE THAN 1/4".
- DIMENSIONS ARE TO CENTERLINE FACE OF STUDS, CENTER OF COLUMNS, OR FACE OF VENER.
- CONTRACTOR TO VERIFY ALL SITE CONDITIONS, BUILDING LOCATIONS, AND DIMENSIONS PRIOR TO CONSTRUCTION.
- MATERIALS SHALL BE NEW AND U.L. LISTED.
- NO WORK SHALL BE CONCEALED UNTIL APPROVED BY LOCAL INSPECTORS.
- CONSTRUCTION SHALL COMPLY WITH ALL PARISH, STATE, AND LOCAL CODES.
- CONTRACTOR TO GUARANTEE WORK FOR ONE YEAR.
- CONTRACTOR SHALL FURNISH WATER AND POWER FROM EXISTING SOURCES.
- EXTERIOR CAULKING SHALL BE DOWN CORNING 790 SILICONE. INSTALL IN ACCORDANCE WITH MANUFACTURER RECOMMENDATION WITH ARCH-OWNER TO SELECT COLOR. INTERIOR CAULKING TO BE EQUAL TO DAP PAINTABLE LATEX WITH SILICONE.
- PAINT GRADE TO SHALL BE SHERWIN WILLIAMS OR EQUIVALENT. ALL WORK TO RECEIVE 3 COATS. COLOR SELECTION BY OWNER.
- PROVIDE CLEANUP ON A REGULAR BASIS. NO TRASH STORED IN BUILDING.
- ALL BATT INSULATION SHALL HAVE A CLASS "A" (0-25) FLAME SPREAD IN COMPLIANCE WITH APPLICABLE CODE.
- USE 6" STUDS, OR 4" STAGGERED STUDS AT ALL PLUMBING WALLS.
- PROVIDE GALVANIZED METAL PAN WITH DRAIN AT WATER HEATER LOCATION.
- ALL CORNERS SHALL BE PROPERLY BRACED FOR WIND LOADS. A 48" SHEATHING SHALL BE PROVIDED EVERY 20 FEET OF WALL LENGTH.
- FLOORING SHALL BE NON-SLIP.
- INTERIOR LOCKS ON DOORS IN MEANS OF EGRESS SHALL NOT REQUIRE THE USE OF A KEY. SPECIAL KNOWLEDGE OR SPECIAL DEVICE TO OPEN IN THE DIRECTION OF EGRESS. ALL DOORS SHALL HAVE LEVER TYPE HANDLES.
- INTERIOR WALLS AND CEILINGS SHALL HAVE A FLAME SPREAD OF 0-200 AND A SMOKE DEVELOPMENT RATING OF 0-450.
- ALL WORK SHALL COMPLY WITH THE LATEST EDITION OF ALL LOCAL, STATE, AND NATIONAL CODES COVERING THE TYPE OF WORK BEING PERFORMED.
- PROVIDE PORTABLE FIRE EXTINGUISHERS IN ACCORDANCE WITH NFPA 101. SEE APPENDIX "E" OF NFPA 101 FOR DISTRIBUTION OF EXTINGUISHERS.
- ALL FIRE WALLS SHALL EXTEND TIGHT TO ROOF SHEATHING, AND BE SEALED WITH AN APPROVED FIRE CAULK.
- ALL ELECTRICAL, MECHANICAL, AND PLUMBING MATERIALS PENETRATING FIRE WALLS SHALL BE FIRE CALKED. PENETRATIONS THROUGH RATED CONSTRUCTION SHALL BE SEALED WITH A MATERIAL CAPABLE OF PREVENTING THE PASSAGE OF FLAMES AND HOT GASES WHEN TESTED IN ACCORDANCE WITH ASTM E-814.
- SERVICE COUNTER SHALL HAVE A HOP ACCESSIBLE WRITING SURFACE. MAX 36" FROM F.F. (ADAAG MANUAL 1998, PG-135)

FINISH SCHEDULE

NAME	FLOOR	BASE	WALLS	CEILING	REMARKS
OFFICE	CARPET				
BATHROOMS	CONCRETE				
WAREHOUSE	LVCT				
	NONE				
	CERAMIC TILE				
	CERAMIC TILE				
	RUBBER WALL BASE				
	WOOD BASE				
	NONE				
			GYPSUM BOARD		
				2'x2' LAY-IN PANELS	
				GYPSUM BOARD	
				CEILING HEIGHT TO	
				CEILING HEIGHT TO	

PROVIDE MOISTURE RESISTANT TYPE GYP. BD. IN ALL DAMP AREAS INCLUDING AT FUTURE BATHROOMS.

DOOR & HARDWARE SCHEDULE

NO.	TYPE	FRAME	HINGE	LOCK	ACCESSORIES	REMARKS
1	DOOR - EXTERIOR	SOLID WOOD				
2		HOLLOW METAL				
3		SLIDING				
4		STOREFRONT				
5		CASED OPENING				
6		STEEL				
7		ALUMINUM				
8		WOOD				
9		CASED OPENING				
10		DBL SWING				
11		BUTT 1-1/2 PR				
12		BURGLERPRF				
13		FIXED				
14		PASSAGE				
15		PRIVACY				
16		DEADBOLT				
17		KEYED HANDLE				
18		OFFICE/ENTRANCE				
19		PUSH PULL				
20		THRESHOLD				
21		WEATHERSTRIP				
22		DOOR STOP				
23		ALARM				
24		SILENCER				
25		CLOSER				
26	DOOR - INTERIOR					
27						

- DOOR & HARDWARE NOTES:**
- ALL GLAZING TO BE LAMINATED SAFETY GLASS.
 - DOOR HINGES TO BE STANLEY FULL MORITSE STANDARD WEIGHT. BALL BEARING HINGES, STAINLESS STEEL WITH DARK BRONZE FINISH @ EXTERIOR & MATCHING DARK BRONZE FINISH ON STANDARD STEEL @ INTERIOR.
 - PROVIDE LEVER HANDLE ADA APPROVED LOCKSETS WITH MATCHING DARK BRONZE FINISH TO BE SELECTED BY OWNER.
 - COORDINATE KENING SCHEDULE WITH OWNER.
 - DOOR STOPS TO BE EQUAL TO VES NO. 436 OR 437. AS REQUIRED IN MATCHING DARK BRONZE FINISH.
 - WEATHER-STRIP & THRESHOLD FINISH TO COMPLEMENT OTHER HARDWARE.
 - DOORS MARKED 1 & 2 TO BE EQUAL TO ACADIAN MILLWORK & SUPPLY, MANDEVILLE, LA. SERIES 40000. 1 3/4" THICK WITH WOOD SPECIES TO BE SELECTED BY OWNER.
 - WINDOWS MARKED 4* TO BE EQUAL TO ACADIAN MILLWORK & SUPPLY, MANDEVILLE, LA. SERIES 43000. 1 3/4" THICK, FIXED WITH WOOD SPECIES SELECTED BY OWNER.

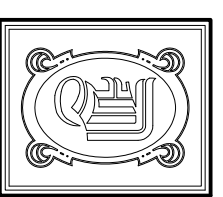

DAMMON ENGINEERING, INC.

CHIEF ENGINEER
EMMETT DAMMON, P.E.
CHIEF ARCHITECT
ROBERT WILTSE

1095 FLORIDA AVENUE
SUDELL, LA. 70458
OFFICE: 985-649-5332
FAX: 985-641-5950

WWW.DAMMONENGINEERING.COM
WEBSITE:
EMAIL:
DAMMONENG@BELL.SOUTH.NET

ARCHITECTURE
ENGINEERING
STUDIES
PLANNING
INVESTIGATION
EXPERT WITNESS

**NEW OFFICE/
WAREHOUSE**

ROSS & MIKE GIUSTELLA
TAOS STREET
SUDELL, LA

FLOOR
PLAN

REV:

SCALE AS NOTED

JOB#: 1572

DATE 5-9-08

SHEET

A-1

OF