

DAMMON ENGINEERING, INC.

CHIEF ENGINEER
EMMETT DAMMON, P.E.

CHIEF ARCHITECT
ROBERT WILTSE

1095 FLORIDA AVENUE
SLIDELL, LA. 70458
OFFICE: 985-649-5832
FAX: 985-641-5950

WEBSITE:
WWW.DAMMONENGINEERING.COM

EMAIL:
DAMMONENG@BELLSOUTH.NET

ARCHITECTURE
ENGINEERING
STUDIES
PLANNING
INVESTIGATION
EXPERT WITNESS

TENANT BUILD-OUT

J D PLAZA
345 GAUSE
BOULEVARD
WEST
SLIDELL, LA

ELECTRICAL LIGHTING PLAN

REV:

SCALE: AS NOTED

JOB#: 2070

DATE: 06-25-10

SHEET 9

E-2

OF 10

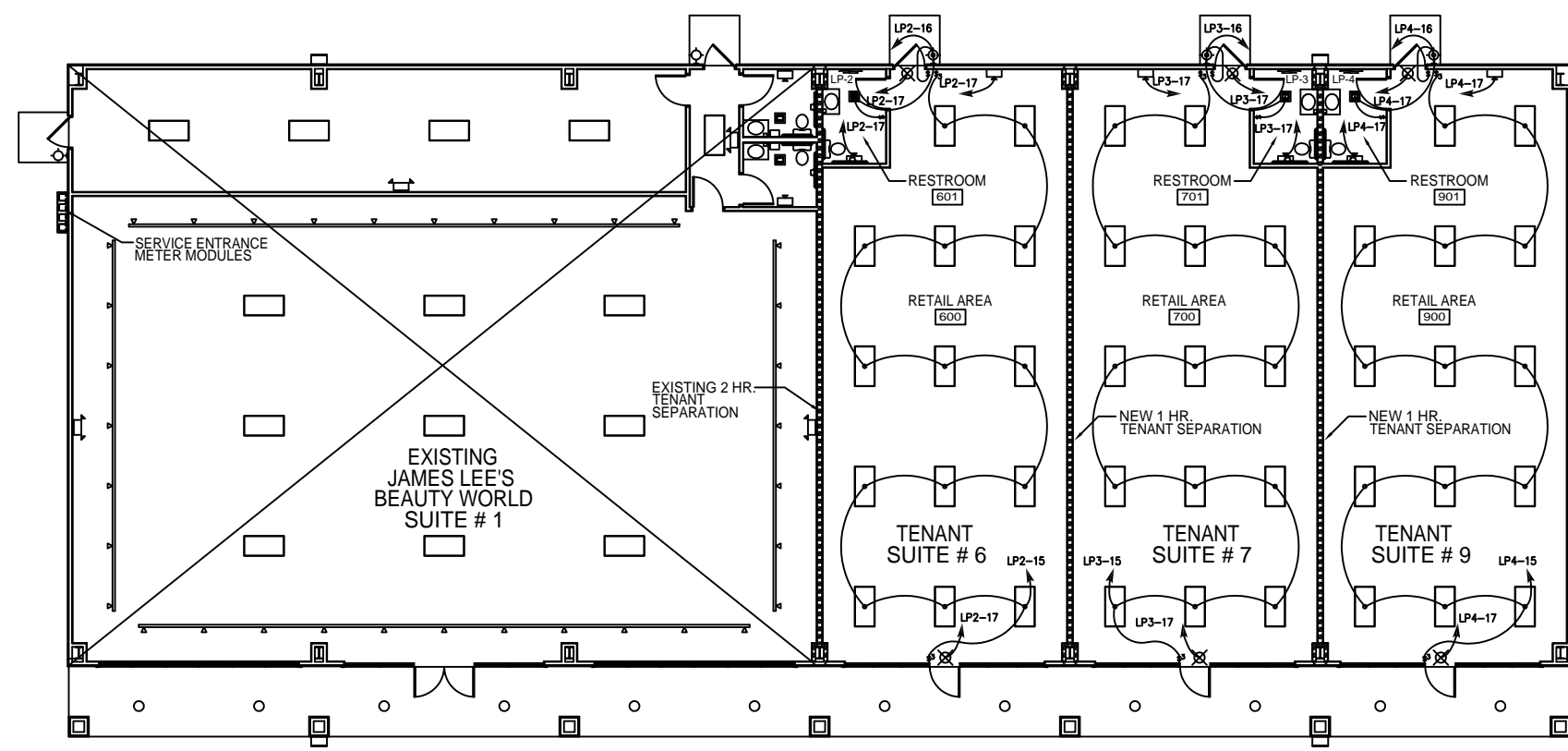

- LEGEND**
- 2x4' FLUORESCENT LIGHT (3 BULB), 3 BULBS @ 32 w EA. = 96 w PER LIGHT
 - EXHAUST FANLIGHT COMBO (90 w EA.)
 - EXIT LIGHT w/90 MIN. BATTERY BACK-UP (.92 w EA.)
 - EMERGENCY LIGHT w/90 MIN. BATTERY BACKUP (10.82 w EA.)
 - WALL MOUNTED EXTERIOR LIGHT FIXTURE (90 w EA.)
 - SWITCH
 - 3 WAY SWITCH
 - POWER PANEL
 - FIRE-RATED TENANT SEPARATION WALL

CLECO Power LLC - Electrical Load Summary

Project Name: James Lee's J D Plaza - Tenant Build-out-Suites 6, 7, & 9
 Project Address: 345 Gause Boulevard
 City / Town: Slidell, Louisiana

Intended Use: Retail Shopping Center
 Requested Service: 120/240 Volts 1 Phase 4 Wires
 Service Entrance Size: 600 Amps
 HVAC Tonnage: 15.00 Tons (Suites 6, 7, & 9)
 Largest Motor: N/A HP (Note: Motors above 20 hp may require reduced Voltage starting and are never recommended for use with 120/240V, 3 Q, 4W services.)

Total Building Square Footage: 9,000 Square Feet
 Individual Unit Square Footage: N/A Square Feet (Multiple Occupancy)
 Individual Unit Designation: N/A (Multiple Occupancy)

LOAD SOURCE	1φ - kVA	3φ - kVA	or	1φ - kW	3φ - kW
Building Lighting (Suites 6, 7, & 9)	4,374	-	or	-	-
Electric Water Heating (Suites 6, 7, & 9)	21,600	-	or	-	-
Heat Pumps	-	-	or	-	-
Supplemental Heat System	-	-	or	-	-
Air Conditioning Condensing Units (A/C-6, 7, & 9)	28,800	-	or	-	-
Electrical Heating (Primary) - AHUs-6,7, & 9)	45,000	-	or	-	-
Cooking	-	-	or	-	-
Refrigeration	-	-	or	-	-
Receptacles (Standard)(Suites 6, 7, & 9)	8,160	-	or	-	-
Receptacles (Computer)	-	-	or	-	-
Total Motors (Exclude HVAC)	-	-	or	-	-
Parking Lot / Exterior Lighting (Suites 6, 7, & 9)	270	-	or	-	-
Miscellaneous - Junction Boxes (Suites 6, 7, & 9)	576	-	or	-	-
Other (Specify)	-	-	or	-	-

ELECTRICAL LIGHTING PLAN
SCALE: 1/8"=1'

PANEL: LP-2 VOLTAGE: 120/240V, 150A 1φ, 3W, MLO
 LOCATION: J D PLAZA, SUITE #6 RESTROOM
 FEEDER SOURCE: CLECO

CMT. NO.	THRU SIZE	LOAD DESCRIPTION		BREAKER		LOAD (VA)	AS	BS	LOAD		BREAKER		LOAD DESCRIPTION	THRU SIZE	CMT. NO.
		LOCATION	LOCATION	AMP	POLE				VA	POLE	AMP	LOCATION			
1	#6	AHU #6	2500	60	2	5000			2500	2	30	AHU #6	#6	2	
3	#6	10 KW	5000			5000			2500	2	30	5 KW	#6	4	
5	#6	A/C COMPRESSOR #6	4800	40	2	4800			3600	2	30	WATER HEATER	#6	6	
7	#6	5 TON	4800			4800			3600			20 GALLON	#6	8	
9	#12	RETAIL AREA 600 RECEPTACLES	960	20	1	960			1280	1	20	RETAIL AREA 600 RECEPTACLES	#12	10	
11	#12	RESTROOM GFI RECEPTACLE	180	20	1	180			180	1	20	RECEPTACLE AT DECK ABOVE RESTROOM	#12	12	
13	#12	WEATHERPROOF GFI RECEPTACLE	180	20	1	180			180	1	20	JUNCTION BOX FOR WALL-MTD. EXT. SIGNS ON BUILDING FRONT	#12	14	
15	#12	RETAIL AREA 600 2x4 FLUORESCENT LIGHTS	1344	20	1	1344			180	1	20	RESTROOM & EXTERIOR DOOR LIGHTS	#12	16	
17	#12	EMERGENCY & EXIT LIGHTS	24	20	1	24			-	1	20	SPARE	#12	18	
19	#12	SPARE	-	20	1	-			-	1	20	SPARE	#12	20	
21	#12	SPARE	-	20	1	-			-	1	20	SPARE	#12	22	
23	#12	SPARE	-	20	1	-			-	-	-	SPARE	-	24	
25	-	SPACE	-	-	-	-			-	-	-	SPACE	-	26	
27	-	SPACE	-	-	-	-			-	-	-	SPACE	-	28	
29	-	SPACE	-	-	-	-			-	-	-	SPACE	-	30	
31	-	SPACE	-	-	-	-			-	-	-	SPACE	-	32	
33	-	SPACE	-	-	-	-			-	-	-	SPACE	-	34	
35	-	SPACE	-	-	-	-			-	-	-	SPACE	-	36	
37	-	SPACE	-	-	-	-			-	-	-	SPACE	-	38	
39	-	SPACE	-	-	-	-			-	-	-	SPACE	-	40	
41	-	SPACE	-	-	-	-			-	-	-	SPACE	-	42	

TOTAL CONNECTED LOAD (VA)=36,280
 AS=18,516 BS=17,744
 SOLID NEUTRAL NEUTRAL WIRE (N) GROUND BUS GROUND WIRE (G)

PANEL: LP-3 VOLTAGE: 120/240V, 150A 1φ, 3W, MLO
 LOCATION: J D PLAZA, SUITE #7 RESTROOM
 FEEDER SOURCE: CLECO

CMT. NO.	THRU SIZE	LOAD DESCRIPTION		BREAKER		LOAD (VA)	AS	BS	LOAD		BREAKER		LOAD DESCRIPTION	THRU SIZE	CMT. NO.
		LOCATION	LOCATION	AMP	POLE				VA	POLE	AMP	LOCATION			
1	#6	AHU #7	2500	60	2	5000			2500	2	30	AHU #7	#6	2	
3	#6	10 KW	5000			5000			2500	2	30	5 KW	#6	4	
5	#6	A/C COMPRESSOR #7	4800	40	2	4800			3600	2	30	WATER HEATER	#6	6	
7	#6	5 TON	4800			4800			3600			20 GALLON	#6	8	
9	#12	RETAIL AREA 600 RECEPTACLES	960	20	1	960			1280	1	20	RETAIL AREA 600 RECEPTACLES	#12	10	
11	#12	RESTROOM GFI RECEPTACLE	180	20	1	180			180	1	20	RECEPTACLE AT DECK ABOVE RESTROOM	#12	12	
13	#12	WEATHERPROOF GFI RECEPTACLE	180	20	1	180			180	1	20	JUNCTION BOX FOR WALL-MTD. EXT. SIGNS ON BUILDING FRONT	#12	14	
15	#12	RETAIL AREA 700 2x4 FLUORESCENT LIGHTS	1344	20	1	1344			180	1	20	RESTROOM & EXTERIOR DOOR LIGHTS	#12	16	
17	#12	EMERGENCY & EXIT LIGHTS	24	20	1	24			-	1	20	SPARE	#12	18	
19	#12	SPARE	-	20	1	-			-	1	20	SPARE	#12	20	
21	#12	SPARE	-	20	1	-			-	1	20	SPARE	#12	22	
23	#12	SPARE	-	20	1	-			-	-	-	SPACE	-	24	
25	-	SPACE	-	-	-	-			-	-	-	SPACE	-	26	
27	-	SPACE	-	-	-	-			-	-	-	SPACE	-	28	
29	-	SPACE	-	-	-	-			-	-	-	SPACE	-	30	
31	-	SPACE	-	-	-	-			-	-	-	SPACE	-	32	
33	-	SPACE	-	-	-	-			-	-	-	SPACE	-	34	
35	-	SPACE	-	-	-	-			-	-	-	SPACE	-	36	
37	-	SPACE	-	-	-	-			-	-	-	SPACE	-	38	
39	-	SPACE	-	-	-	-			-	-	-	SPACE	-	40	
41	-	SPACE	-	-	-	-			-	-	-	SPACE	-	42	

TOTAL CONNECTED LOAD (VA)=36,280
 AS=18,516 BS=17,744
 SOLID NEUTRAL NEUTRAL WIRE (N) GROUND BUS GROUND WIRE (G)

PANEL: LP-4 VOLTAGE: 120/240V, 150A 1φ, 3W, MLO
 LOCATION: J D PLAZA, SUITE #9 RESTROOM
 FEEDER SOURCE: CLECO

CMT. NO.	THRU SIZE	LOAD DESCRIPTION		BREAKER		LOAD (VA)	AS	BS	LOAD		BREAKER		LOAD DESCRIPTION	THRU SIZE	CMT. NO.
		LOCATION	LOCATION	AMP	POLE				VA	POLE	AMP	LOCATION			
1	#6	AHU #9	2500	60	2	5000			2500	2	30	AHU #9	#6	2	
3	#6	10 KW	5000			5000			2500	2	30	5 KW	#6	4	
5	#6	A/C COMPRESSOR #9	4800	40	2	4800			3600	2	30	WATER HEATER	#6	6	
7	#6	5 TON	4800			4800			3600			20 GALLON	#6	8	
9	#12	RETAIL AREA 600 RECEPTACLES	960	20	1	960			1280	1	20	RETAIL AREA 600 RECEPTACLES	#12	10	
11	#12	RESTROOM GFI RECEPTACLE	180	20	1	180			180	1	20	RECEPTACLE AT DECK ABOVE RESTROOM	#12	12	
13	#12	WEATHERPROOF GFI RECEPTACLE	180	20	1	180			180	1	20	JUNCTION BOX FOR WALL-MTD. EXT. SIGNS ON BUILDING FRONT	#12	14	
15	#12	RETAIL AREA 900 2x4 FLUORESCENT LIGHTS	1344	20	1	1344			180	1	20	RESTROOM & EXTERIOR DOOR LIGHTS	#12	16	
17	#12	EMERGENCY & EXIT LIGHTS	24	20	1	24			-	1	20	SPARE	#12	18	
19	#12	SPARE	-	20	1	-			-	1	20	SPARE	#12	20	
21	#12	SPARE	-	20	1	-			-	1	20	SPARE	#12	22	
23	#12	SPARE	-	20	1	-			-	-	-	SPACE	-	24	
25	-	SPACE	-	-	-	-			-	-	-	SPACE	-	26	
27	-	SPACE	-	-	-	-			-	-	-	SPACE	-	28	
29	-	SPACE	-	-	-	-			-	-	-	SPACE	-	30	
31	-	SPACE	-	-	-	-			-	-	-	SPACE	-	32	
33	-	SPACE	-	-	-	-			-	-	-	SPACE	-	34	
35	-	SPACE	-	-	-	-			-	-	-	SPACE	-	36	
37	-	SPACE	-	-	-	-			-	-	-	SPACE	-	38	
39	-	SPACE	-	-	-	-			-	-	-	SPACE	-	40	
41	-	SPACE	-	-	-	-			-	-	-	SPACE	-	42	

TOTAL CONNECTED LOAD (VA)=36,280
 AS=18,516 BS=17,744
 SOLID NEUTRAL NEUTRAL WIRE (N) GROUND BUS GROUND WIRE (G)