

**DAMMON ENGINEERING, INC.**

CHIEF ENGINEER  
EMMETT DAMMON, P.E.

CHIEF ARCHITECT  
ROBERT WILTSE

1095 FLORIDA AVENUE  
SLIDELL, LA. 70458  
OFFICE: 985-649-5832  
FAX: 985-641-5950

WEBSITE:  
WWW.DAMMONENGINEERING.COM  
EMAIL:  
DAMMONENG@BELLSOUTH.NET

ARCHITECTURE  
ENGINEERING  
STUDIES  
PLANNING  
INVESTIGATION  
EXPERT WITNESS

TENANT BUILD-OUT

J D PLAZA  
345 GAUSE  
BOULEVARD  
WEST  
SLIDELL, LA

ELECTRICAL LIGHTING PLAN

REV:

SCALE: AS NOTED

JOB#: 2070

DATE: 06-29-10

SHEET 7

**E-2**

OF 8

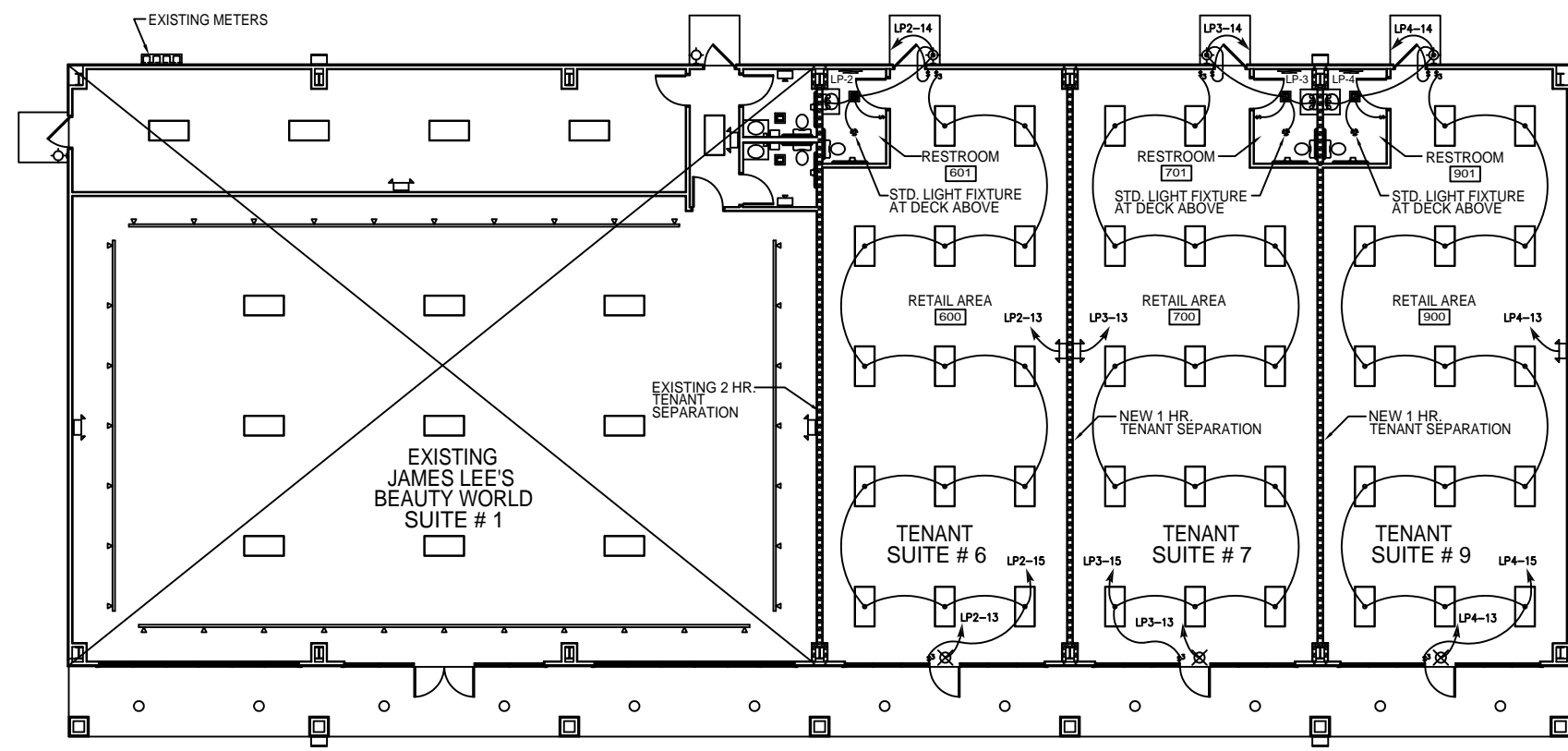

- LEGEND**
- 2x4' FLUORESCENT LIGHT (3 BULB), 3 BULBS @ 32 w EA. = 96 w PER LIGHT
  - EXHAUST FANLIGHT COMBO (90 w EA.)
  - THREE BULB HOLLYWOOD LIGHT FIXTURE (300w EA.)
  - STANDARD BULB FIXTURE AT DECK ABOVE (100w)
  - EXIT LIGHT w/90 MIN. BATTERY BACK-UP (.92 w EA.)
  - EMERGENCY LIGHT W/ 90 MIN. BATTERY BACKUP (10.82 w EA.)
  - WALL MOUNTED EXTERIOR LIGHT FIXTURE (90 w EA.)
  - SWITCH
  - 3 WAY SWITCH
  - POWER PANEL
  - FIRE-RATED TENANT SEPARATION WALL

**CLECO Power LLC - Electrical Load Summary**

Project Name: James Lee's J D Plaza - Tenant Build-out-Suites 6, 7, & 9  
 Project Address: 345 Gause Boulevard  
 City / Town: Slidell, Louisiana

Intended Use: Retail Shopping Center  
 Requested Service: 120/240 Volts 1 Phase 4 Wires  
 Service Entrance Size: 600 Amps  
 HVAC Tonnage: 15.00 Tons (Suites 6, 7, & 9)  
 Largest Motor: N/A HP (Note: Motors above 20 hp may require reduced Voltage starting and are never recommended for use with 120/240V, 3 Q, 4W services.)

Total Building Square Footage: 9,000 Square Feet (Existing)  
 Total Buildout Square Footage: 4,500 Square Feet (Interior)  
 Individual Unit Square Footage: N/A Square Feet (Multiple Occupancy)  
 Individual Unit Designation: N/A (Multiple Occupancy)

LOAD SOURCE	1Ø - kVA	3Ø - kVA	or	1Ø - kW	3Ø - kW
Building Lighting (Suites 6, 7, & 9)	5,538	-	or	-	-
Electric Water Heating (Suites 6, 7, & 9)	21,600	-	or	-	-
Heat Pumps	-	-	or	-	-
Supplemental Heat System	-	-	or	-	-
Air Conditioning Condensing Units (A/C-6, 7, & 9)	28,800	-	or	-	-
Electrical Heating (Primary) - AHUs-6,7, & 9)	45,000	-	or	-	-
Cooking	-	-	or	-	-
Refrigeration	-	-	or	-	-
Receptacles (Standard)(Suites 6, 7, & 9)	6,720	-	or	-	-
Receptacles (Computer)	-	-	or	-	-
Total Motors (Exclude HVAC)	-	-	or	-	-
Parking Lot / Exterior Lighting (Suites 6, 7, & 9)	270	-	or	-	-
Miscellaneous - Junction Boxes (Suites 6, 7, & 9)	576	-	or	-	-
Other (Specify)	-	-	or	-	-

**ELECTRICAL LIGHTING PLAN**  
SCALE: 1/8"=1'

PANEL: LP-2 VOLTAGE: 120/240V, 200A 1Ø, 3W, MLO  
 LOCATION: J D PLAZA, SUITE #6 RESTROOM SURFACE MOUNTED W/EQUIPMENT GND BAR  
 FEEDER SOURCE: CLECO

CMT. NO.	THRU SIZE	LOAD DESCRIPTION	BREAKER		LOAD (VA)	AS BS	BREAKER		LOAD (VA)	THRU SIZE	CMT. NO.
			AMP	POLE			AMP	POLE			
1	#6	AHU #6 10 KW	60	2	5000		2	30	2500	#6	2
3	#6	AHU #6 10 KW	60	2	5000		2	30	2500	#6	4
5	#6	A/C COMPRESSOR #6 5 TON	40	2	4800		2	30	3600	#6	6
7	#6	A/C COMPRESSOR #6 5 TON	40	2	4800		2	30	3600	#6	8
9	#12	RETAIL AREA 600 RECEPTACLES	20	1	800		1	20	960	#12	10
11	#12	RESTROOM & EXTERIOR GFI RECEPTACLES, DECK ABOVE RECEPTACLE	20	1	480		1	20	192	#12	12
13	#12	EMERGENCY & EXIT LIGHTS	20	1	12		1	20	560	#12	14
15	#12	RETAIL AREA 600 2x4 FLUORESCENT LIGHTS	20	1	1344		-	20	SPARE	#12	16
17	#12	SPARE	20	1	-		-	20	SPARE	#12	18
19	#12	SPARE	20	1	-		-	20	SPARE	#12	20
21	#12	SPARE	20	1	-		-	20	SPARE	-	22
23	-	SPACE	-	-	-		-	-	SPACE	-	24
25	-	SPACE	-	-	-		-	-	SPACE	-	26
27	-	SPACE	-	-	-		-	-	SPACE	-	28
29	-	SPACE	-	-	-		-	-	SPACE	-	30
31	-	SPACE	-	-	-		-	-	SPACE	-	32
33	-	SPACE	-	-	-		-	-	SPACE	-	34
35	-	SPACE	-	-	-		-	-	SPACE	-	36
37	-	SPACE	-	-	-		-	-	SPACE	-	38
39	-	SPACE	-	-	-		-	-	SPACE	-	40
41	-	SPACE	-	-	-		-	-	SPACE	-	42

TOTAL CONNECTED LOAD (VA)=36,168  
 AS=18,252 BS=17,916

PANEL: LP-3 VOLTAGE: 120/240V, 200A 1Ø, 3W, MLO  
 LOCATION: J D PLAZA, SUITE #7 RESTROOM SURFACE MOUNTED W/EQUIPMENT GND BAR  
 FEEDER SOURCE: CLECO

CMT. NO.	THRU SIZE	LOAD DESCRIPTION	BREAKER		LOAD (VA)	AS BS	BREAKER		LOAD (VA)	THRU SIZE	CMT. NO.
			AMP	POLE			AMP	POLE			
1	#6	AHU #7 10 KW	60	2	5000		2	30	2500	#6	2
3	#6	AHU #7 10 KW	60	2	5000		2	30	2500	#6	4
5	#6	A/C COMPRESSOR #7 5 TON	40	2	4800		2	30	3600	#6	6
7	#6	A/C COMPRESSOR #7 5 TON	40	2	4800		2	30	3600	#6	8
9	#12	RETAIL AREA 700 RECEPTACLES	20	1	800		1	20	960	#12	10
11	#12	RESTROOM & EXTERIOR GFI RECEPTACLES, DECK ABOVE RECEPTACLE	20	1	480		1	20	192	#12	12
13	#12	EMERGENCY & EXIT LIGHTS	20	1	12		1	20	560	#12	14
15	#12	RETAIL AREA 700 2x4 FLUORESCENT LIGHTS	20	1	1344		-	20	SPARE	#12	16
17	#12	SPARE	20	1	-		-	20	SPARE	#12	18
19	#12	SPARE	20	1	-		-	20	SPARE	#12	20
21	#12	SPARE	20	1	-		-	20	SPARE	-	22
23	-	SPACE	-	-	-		-	-	SPACE	-	24
25	-	SPACE	-	-	-		-	-	SPACE	-	26
27	-	SPACE	-	-	-		-	-	SPACE	-	28
29	-	SPACE	-	-	-		-	-	SPACE	-	30
31	-	SPACE	-	-	-		-	-	SPACE	-	32
33	-	SPACE	-	-	-		-	-	SPACE	-	34
35	-	SPACE	-	-	-		-	-	SPACE	-	36
37	-	SPACE	-	-	-		-	-	SPACE	-	38
39	-	SPACE	-	-	-		-	-	SPACE	-	40
41	-	SPACE	-	-	-		-	-	SPACE	-	42

TOTAL CONNECTED LOAD (VA)=36,168  
 AS=18,252 BS=17,916

PANEL: LP-4 VOLTAGE: 120/240V, 200A 1Ø, 3W, MLO  
 LOCATION: J D PLAZA, SUITE #9 RESTROOM SURFACE MOUNTED W/EQUIPMENT GND BAR  
 FEEDER SOURCE: CLECO

CMT. NO.	THRU SIZE	LOAD DESCRIPTION	BREAKER		LOAD (VA)	AS BS	BREAKER		LOAD (VA)	THRU SIZE	CMT. NO.
			AMP	POLE			AMP	POLE			
1	#6	AHU #9 10 KW	60	2	5000		2	30	2500	#6	2
3	#6	AHU #9 10 KW	60	2	5000		2	30	2500	#6	4
5	#6	A/C COMPRESSOR #9 5 TON	40	2	4800		2	30	3600	#6	6
7	#6	A/C COMPRESSOR #9 5 TON	40	2	4800		2	30	3600	#6	8
9	#12	RETAIL AREA 900 RECEPTACLES	20	1	800		1	20	960	#12	10
11	#12	RESTROOM & EXTERIOR GFI RECEPTACLES, DECK ABOVE RECEPTACLE	20	1	480		1	20	192	#12	12
13	#12	EMERGENCY & EXIT LIGHTS	20	1	12		1	20	560	#12	14
15	#12	RETAIL AREA 900 2x4 FLUORESCENT LIGHTS	20	1	1344		-	20	SPARE	#12	16
17	#12	SPARE	20	1	-		-	20	SPARE	#12	18
19	#12	SPARE	20	1	-		-	20	SPARE	#12	20
21	#12	SPARE	20	1	-		-	20	SPARE	-	22
23	-	SPACE	-	-	-		-	-	SPACE	-	24
25	-	SPACE	-	-	-		-	-	SPACE	-	26
27	-	SPACE	-	-	-		-	-	SPACE	-	28
29	-	SPACE	-	-	-		-	-	SPACE	-	30
31	-	SPACE	-	-	-		-	-	SPACE	-	32
33	-	SPACE	-	-	-		-	-	SPACE	-	34
35	-	SPACE	-	-	-		-	-	SPACE	-	36
37	-	SPACE	-	-	-		-	-	SPACE	-	38
39	-	SPACE	-	-	-		-	-	SPACE	-	40
41	-	SPACE	-	-	-		-	-	SPACE	-	42

TOTAL CONNECTED LOAD (VA)=36,168  
 AS=18,252 BS=17,916

**E-2**

OF 8